

BARR GAZETAS

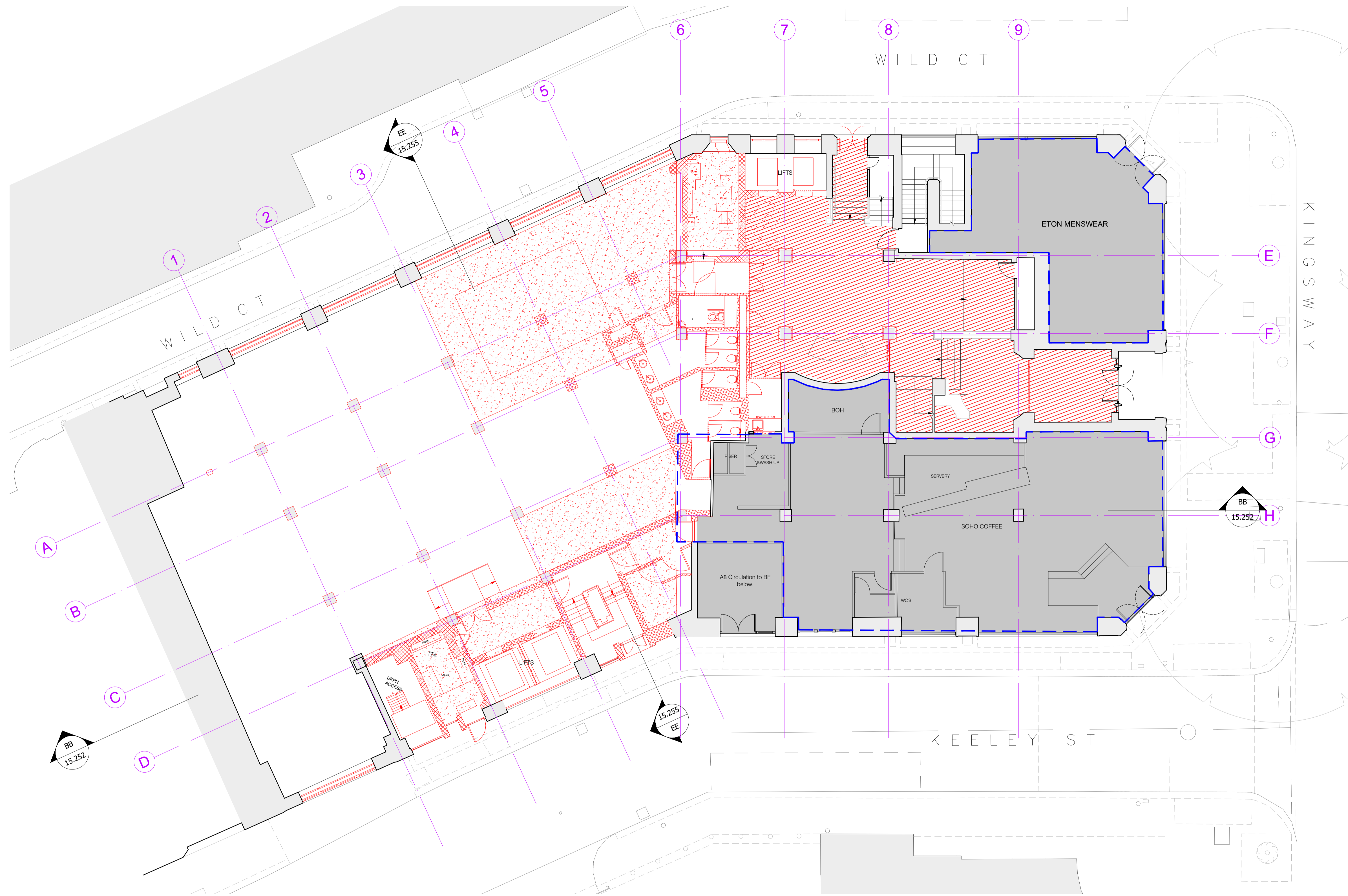

- KEY:
- Existing walls
 - Demolition and strip out
 - Demolition and strip out
 - Strip out of finishes and concrete column encasement to reveal existing steel column
 - Structural floor slab demolition. Refer to SE information.
 - Remove modern marble floor finish in this area. Including modern marble cladding on walls and columns.
 - Not in scope
 - A1 and A3 Demise

GENERAL NOTE:
All modern (non-original) finishes, fixtures, fittings and linings to be removed from walls, floors and ceilings throughout.

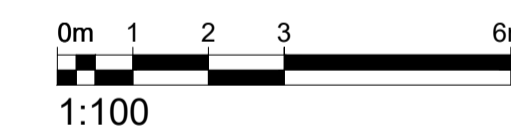

P4	For Planning	AC	28.11.19
Rev.	Description	By	Date

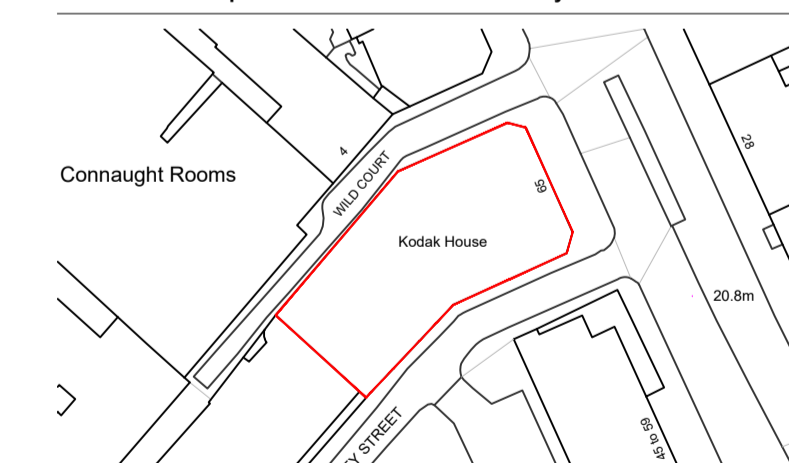

Client
Kings Keeley Limited C/o Clearbell Capital LLP
Project
65 Kingsway - Base Scheme

Status	Purpose of issue	RIBA stage		
S2	For Planning	2		
Project No.	Drawn	Checked	Scale	Rev.
1914	FB	TJ	1:100 @ A1 1:200 @ A3	P4

Drawing No.
1914-BG-01-00-DR-A-15.202

Do not scale from this drawing. The Contractor is to take and check all dimensions on site before work commences. Discrepancies must be reported to the Architect. Subcontractors must verify all dimensions on site before making a shop drawing or commencing manufacturing. This drawing is copyright. ©
© Copyright Barr Gazetas Ltd.
A 10 Heddon Street, London, W1B 4BG
T 0207 638 5981
W www.barrgazetas.com

01 Demolition Ground Floor Plan
1:100@A1, 1:200@A3