

## Simon Pryce Arboriculture

Client:  
Mr & Mrs Eringer

Site:  
91 Redington Road, Hampstead,  
London, NW3 7RR

Title:  
Trees and proposed building work -  
existing site

Date: 4 November 2019

Ref: 19/087      Rev:

Scale: 1:100 at A4

CP House,  
Otterspool Way,  
Watford,  
WD25 8HP  
tel 01923 467600  
[info@simonpryce.co.uk](mailto:info@simonpryce.co.uk)  
[www.simonpryce.co.uk](http://www.simonpryce.co.uk)

Original drawing:  
Provided by Derek Lofty Associates

Root protection areas [RPAs] are  
colour coded according to retention category  
from BS5837:2012, Trees in relation to  
demolition, design and construction:

- A = green
- B = blue
- C = grey
- U = red - dashed - also used to denote dead  
trees with no RPA
- Tree protection = mid blue
- Crown spreads = mid green

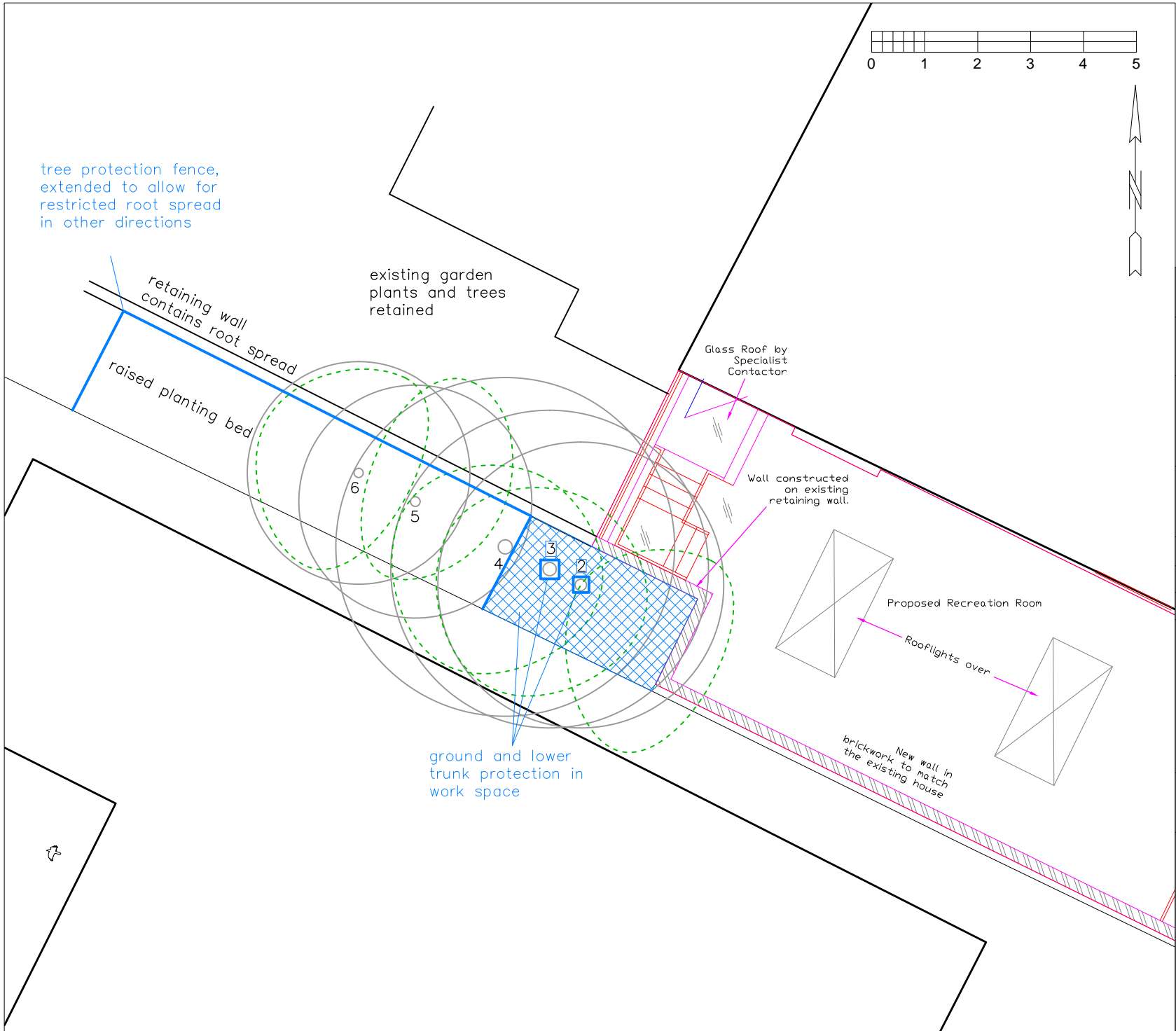

**Simon Pryce Arboriculture**

Client:  
Mr & Mrs Eringer

Site:  
91 Redington Road, Hampstead,  
London, NW3 7RR

Title:  
Trees and conversion of garage -  
proposed site and tree protection plan

Date: 4 November 2019

Ref: 19/087      Rev:

Scale: 1:100 at A4

CP House,  
Otterspool Way,  
Watford,  
WD25 8HP  
tel 01923 467600  
[info@simonpryce.co.uk](mailto:info@simonpryce.co.uk)  
[www.simonpryce.co.uk](http://www.simonpryce.co.uk)

Original drawing:  
Provided by Derek Lofty Associates

Root protection areas [RPAs] are colour coded according to retention category from BS5837:2012. Trees in relation to design, demolition and construction:

- A = green
- B = blue
- C = grey
- U = red - dashed - also used to denote dead trees with no RPA
- Tree protection = mid blue
- Crown spreads = mid green