

University College London

Wayfinding & Signage

IOE Strategy

Endsleigh Gardens

August 2019

External Entrances

9-11 Endsleigh Gardens

Site Location Plan

Location: EX10
Sign Type: ST3a – 440 x 600mm

Existing Sign



Proposed montage

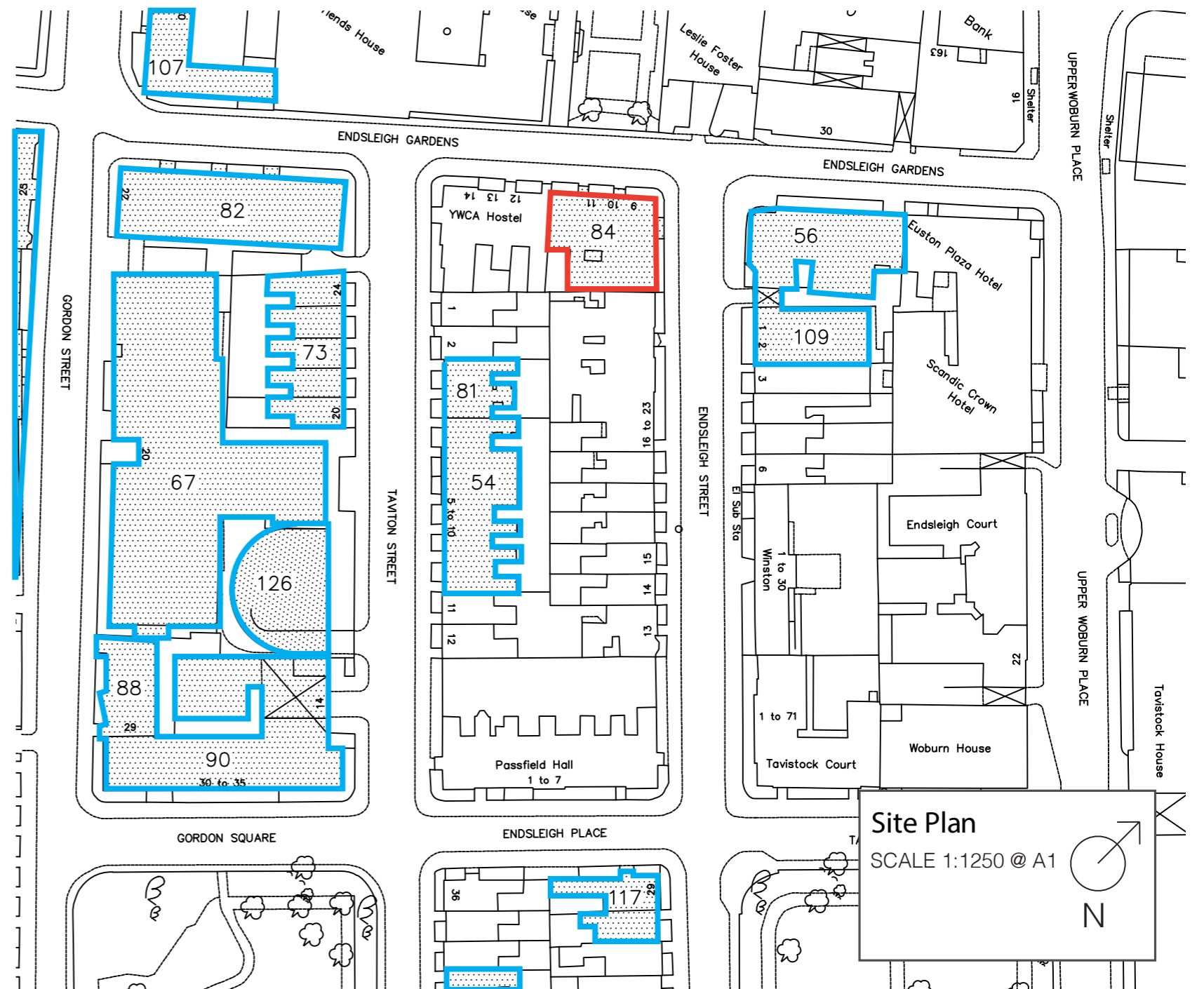

External Entrances 9-11 Endsleigh Gardens

Site Location Plan

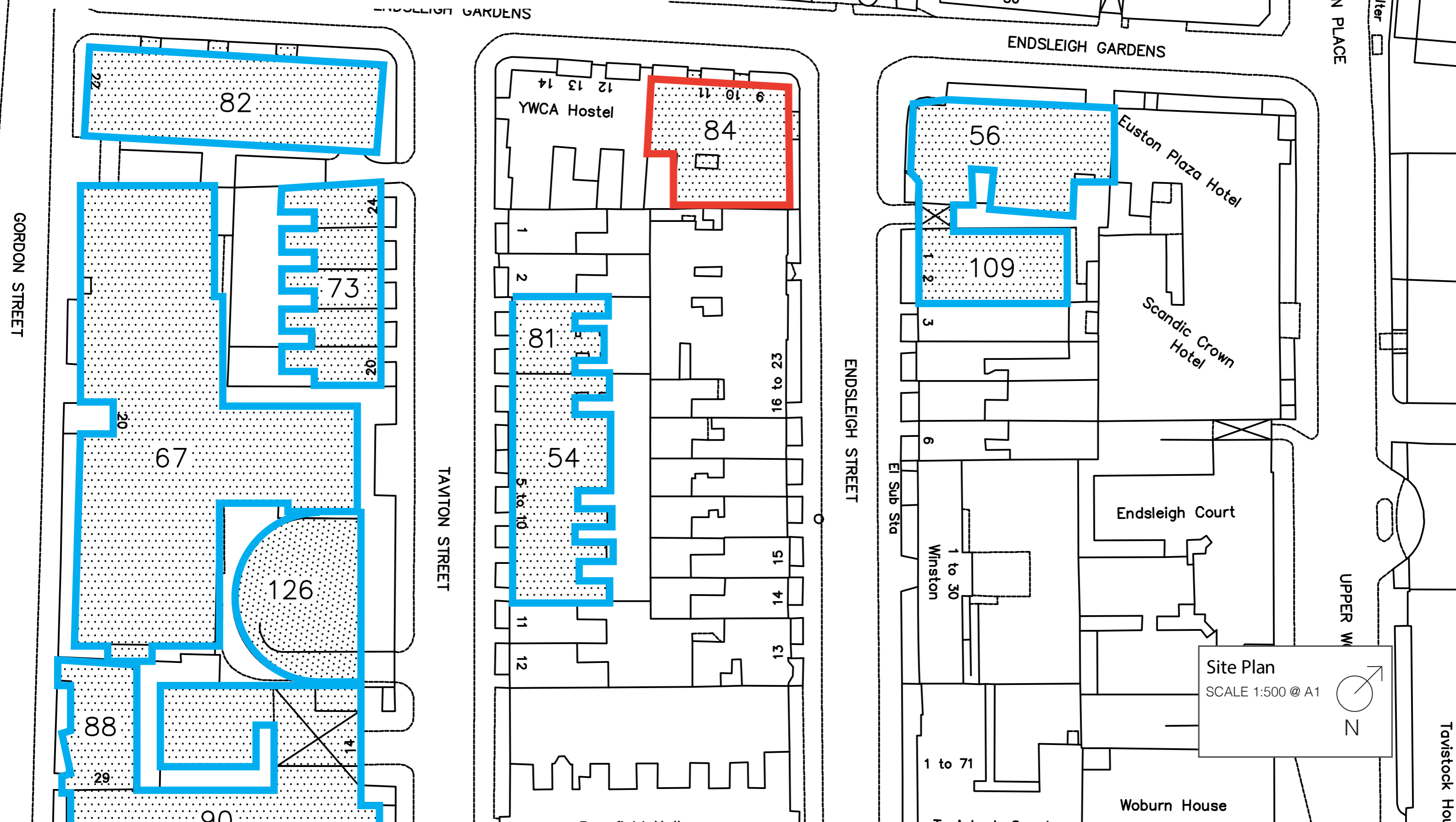

External Entrances

9-11 Endsleigh Gardens

Site Plan

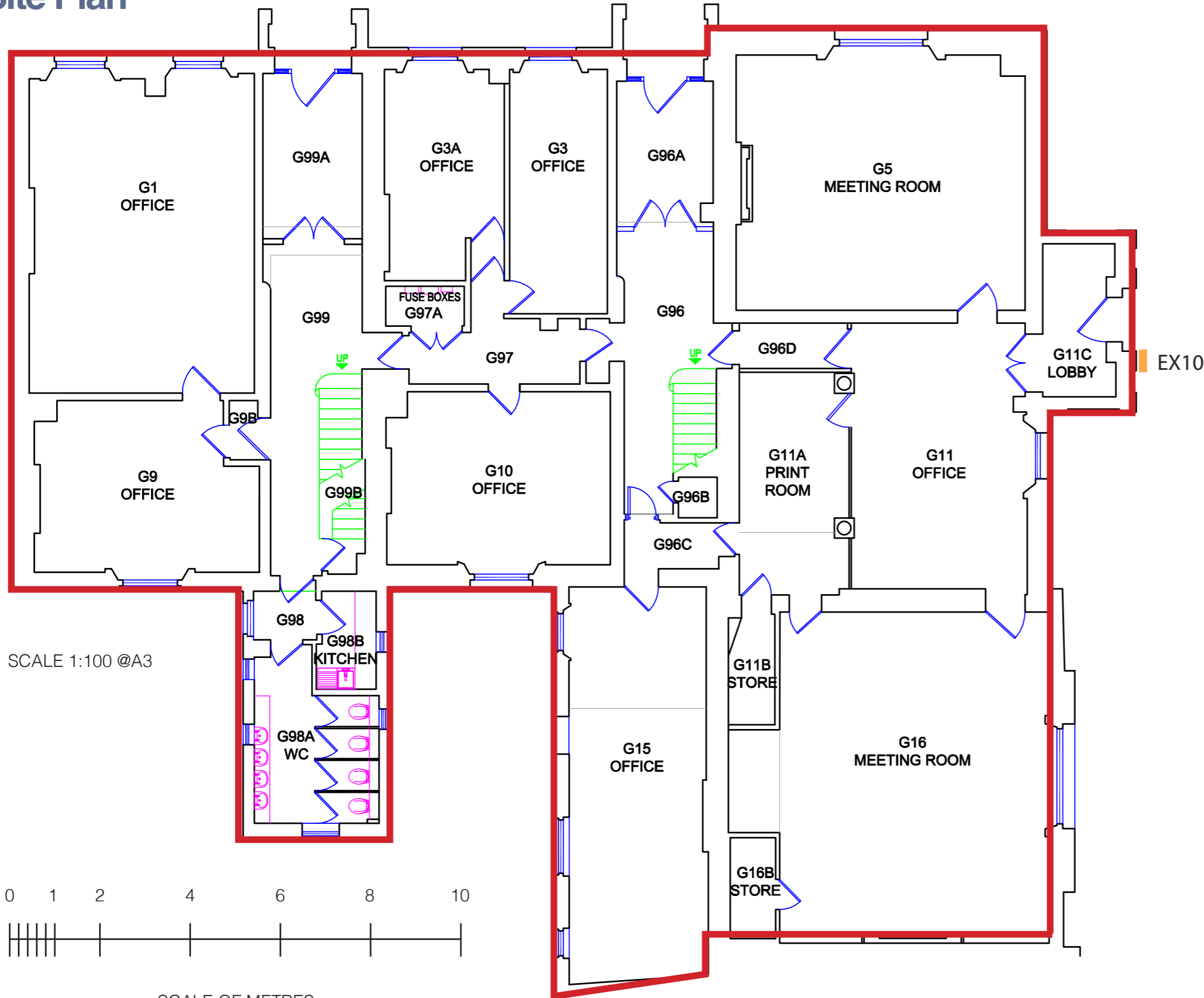

SCALE 1:100 @A3



SCALE OF METRES

Sign EX10

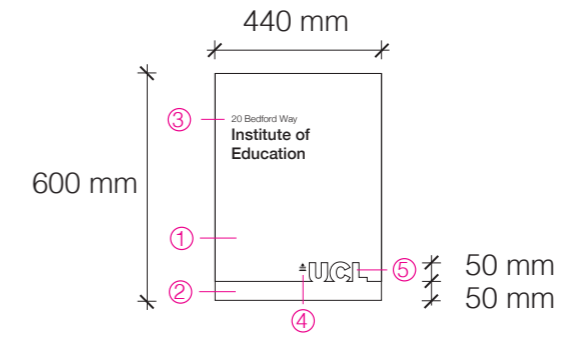

SCALE 1:20

① 3MM ALUMINIUM FRET-CUT UPPER TRAY, POLYESTER POWDER COATED BLACK (GLOSS FINISH), MOUNTED ON TO UNDER-TRAY / CARRIER PANEL.

② 3MM ALUMINIUM UNDER-TRAY / CARRIER PANEL, POLYESTER POWDER COATED TO SPECIFIED COLOUR (MID SHEEN FINISH).

③ SCREEN PRINTED TEXT IN WHITE (TYPICAL SHOWN).

④ SCREEN PRINTED LOGO IN WHITE.

⑤ FRET CUT "UCL" LETTERS IN UPPER TRAY, EXPOSING UNDER-TRAY / CARRIER PANEL UNDERNEATH.

Mid Tone Stone

Pantone 7530
BS 08 B 21

Conservation Areas
default colour

Light Stone

Pantone 7528
BS 08 B 17

Conservation Areas
Portland Stone

External Entrances Sign Schedule

Schedule of proposed wayfinding signs, with budget costs.

Sign No	Address/location	Sign type	Size	Budget Cost ex. VAT
EX10	9-11 Endsleigh Gardens	ST3a	440 x 600	tbc