

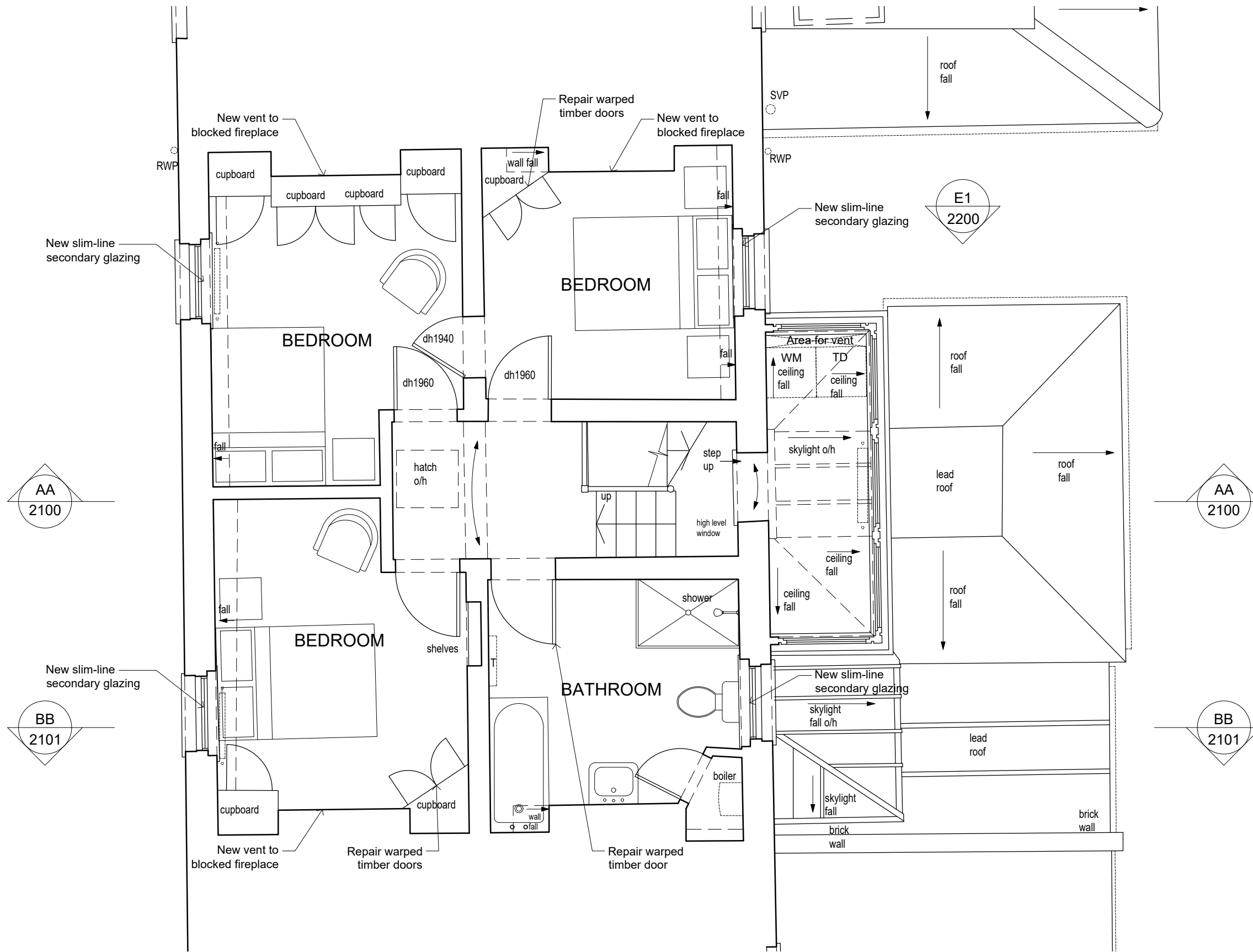

**GENERAL NOTES**

1. Shading indicates new construction
2. Windows to be overhauled and refurbished throughout. Draught stripping to be installed where possible
3. Slim-line secondary glazing to be installed to all sash windows
4. General redecoration throughout
5. Throughout the ground floor; lay new 7mm floating engineered floorboards over existing floorboards (no impact on existing doors or skirting boards)



Purpose of Issue:  
**FOR\_PLANNING**

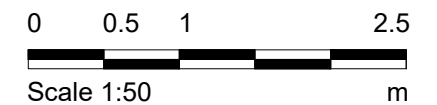

- Notes**
1. Any dwg format drawing is to be read in conjunction with and at the scale of the accompanying pdf.
  2. Where colours other than black or grey are used, the drawing must be plotted in colour.
  3. For status 'C' (Construction) drawings all dimensions are to be checked on site by the contractor, scaling is for Local Authority purposes only.
  4. Unless otherwise indicated, all dimensions are in millimeters.
  5. All information on this drawing is to be read in conjunction with the relevant Donald Insall Associates specification and trade contractors' drawings and information by specialists.
  6. In the event of any discrepancy, please contact us immediately.
  7. This drawing may contain survey information by others and is to be used solely for the purposes for which it was issued.
  8. These are uncontrolled documents issued for information purposes only. If you have any queries regarding the drawings, please contact DIA immediately.
  9. Please note DIA cannot be held responsible for any errors arising from changes made to an uncontrolled dwg file.

- Drawing Status**
- F Feasibility
  - S Sketch Design
  - P Planning
  - B Building Control
  - D Design Development
  - M Measurement
  - T Tender
  - C Construction
  - R Record

Rev	Date	Dwn	Auth	Revision
3	22-10-19	ERH	AXT	ISSUED FOR PLANNING
2	25-09-19	ERH	AXT	Issued for comment
1	30-08-19	ERH	AXT	Updates following client comments
0	01-08-19	ERH	AXT	Initial Issue

**Donald Insall Associates**  
Chartered Architects and Historic Building Consultants

12 Devonshire Street  
London W1G 7AB  
(+44) 020 7245 9888  
london@insall-architects.co.uk

3 St Martin's Almshouses, London

Project	STMA3.01	No	2001
Scale (A3)	1:50	Status	3P
		Revision	3

First Floor Plan  
As Proposed

**GENERAL NOTES**

1. Shading indicates new construction
2. Windows to be overhauled and refurbished throughout. Draught stripping to be installed where possible
3. Slim-line secondary glazing to be installed to all sash windows
4. General redecoration throughout
5. Throughout the ground floor; lay new 7mm floating engineered floorboards over existing floorboards (no impact on existing doors or skirting boards)

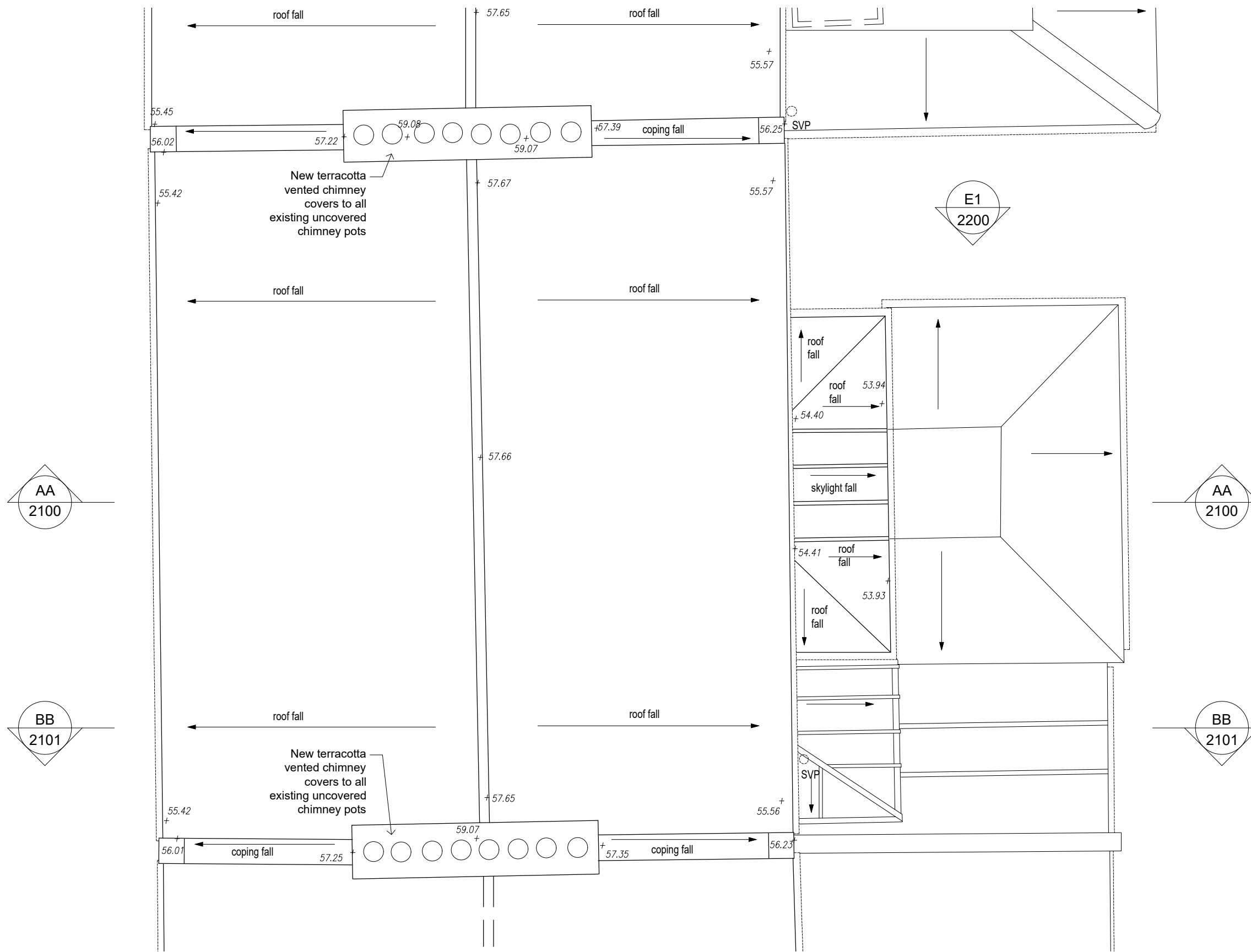

Purpose of Issue:  
**FOR\_PLANNING**

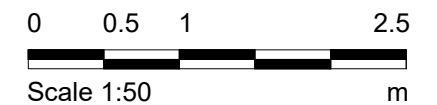

**Notes**

1. Any dwg format drawing is to be read in conjunction with and at the scale of the accompanying pdf.
2. Where colours other than black or grey are used, the drawing must be plotted in colour.
3. For status 'C' (Construction) drawings all dimensions are to be checked on site by the contractor, scaling is for Local Authority purposes only.
4. Unless otherwise indicated, all dimensions are in millimeters.
5. All information on this drawing is to be read in conjunction with the relevant Donald Insall Associates specification and trade contractors' drawings and information by specialists.
6. In the event of any discrepancy, please contact us immediately.
7. This drawing may contain survey information by others and is to be used solely for the purposes for which it was issued.
8. These are uncontrolled documents issued for information purposes only. If you have any queries regarding the drawings, please contact DIA immediately.
9. Please note DIA cannot be held responsible for any errors arising from changes made to an uncontrolled dwg file.

**Drawing Status**

F Feasibility  
S Sketch Design  
P Planning  
B Building Control  
D Design Development  
M Measurement  
T Tender  
C Construction  
R Record

Rev	Date	Dwn	Auth	Revision
2	22-10-19	ERH	AXT	ISSUED FOR PLANNING
1	25-09-19	ERH	AXT	Issued for comment
0	30-08-19	ERH	AXT	Initial Issue

**Donald Insall Associates**  
Chartered Architects and Historic Building Consultants

12 Devonshire Street  
London W1G 7AB  
(+44) 020 7245 9888  
london@insall-architects.co.uk

3 St Martin's Almshouses, London

Roof Plan  
As Proposed

Project	STMA3.01	No	2002
Scale (A3)	1:50	Status	3P
		Revision	2

**GENERAL NOTES**

1. Shading indicates new construction
2. Windows to be overhauled and refurbished throughout. Draught stripping to be installed where possible
3. Slim-line secondary glazing to be installed to all sash windows
4. General redecoration throughout
5. Throughout the ground floor; lay new 7mm floating engineered floorboards over existing floorboards (no impact on existing doors or skirting boards)

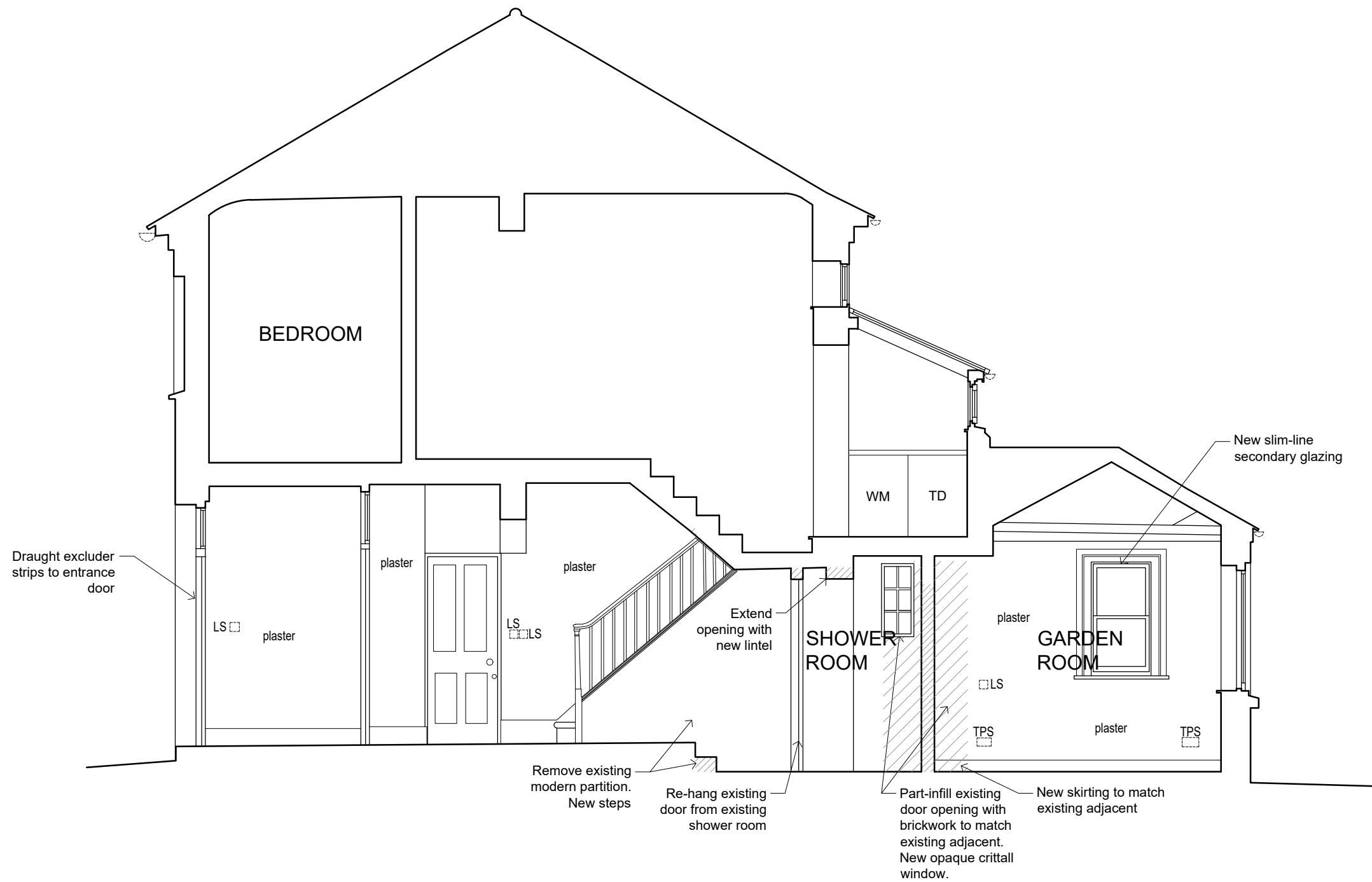

Purpose of Issue:  
**FOR\_PLANNING**

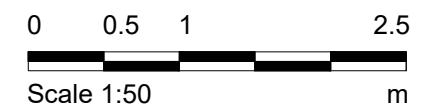

- Notes**
1. Any dwg format drawing is to be read in conjunction with and at the scale of the accompanying pdf.
  2. Where colours other than black or grey are used, the drawing must be plotted in colour.
  3. For status 'C' (Construction) drawings all dimensions are to be checked on site by the contractor, scaling is for Local Authority purposes only.
  4. Unless otherwise indicated, all dimensions are in millimeters.
  5. All information on this drawing is to be read in conjunction with the relevant Donald Insall Associates specification and trade contractors' drawings and information by specialists.
  6. In the event of any discrepancy, please contact us immediately.
  7. This drawing may contain survey information by others and is to be used solely for the purposes for which it was issued.
  8. These are uncontrolled documents issued for information purposes only. If you have any queries regarding the drawings, please contact DIA immediately.
  9. Please note DIA cannot be held responsible for any errors arising from changes made to an uncontrolled dwg file.

**Drawing Status**

F Feasibility  
S Sketch Design  
P Planning  
B Building Control  
D Design Development  
M Measurement  
T Tender  
C Construction  
R Record

Rev	Date	Dwn	Auth	Revision	Rev	Date	Dwn	Auth	Revision
					2	22-10-19	ERH	AXT	ISSUED FOR PLANNING
					1	25-09-19	ERH	AXT	Issued for comment
					0	30-08-19	ERH	AXT	Initial Issue

**Donald Insall Associates**  
Chartered Architects and Historic Building Consultants

12 Devonshire Street  
London W1G 7AB  
(+44) 020 7245 9888  
london@insall-architects.co.uk

3 St Martin's Almshouses, London

Section AA As Proposed	Project <b>STMA3.01</b>	No <b>2100</b>
	Scale (A3) <b>1:50</b>	Status <b>3P</b>
		Revision <b>2</b>

**GENERAL NOTES**

1. Shading indicates new construction
2. Windows to be overhauled and refurbished throughout. Draught stripping to be installed where possible
3. Slim-line secondary glazing to be installed to all sash windows
4. General redecoration throughout
5. Throughout the ground floor; lay new 7mm floating engineered floorboards over existing floorboards (no impact on existing doors or skirting boards)

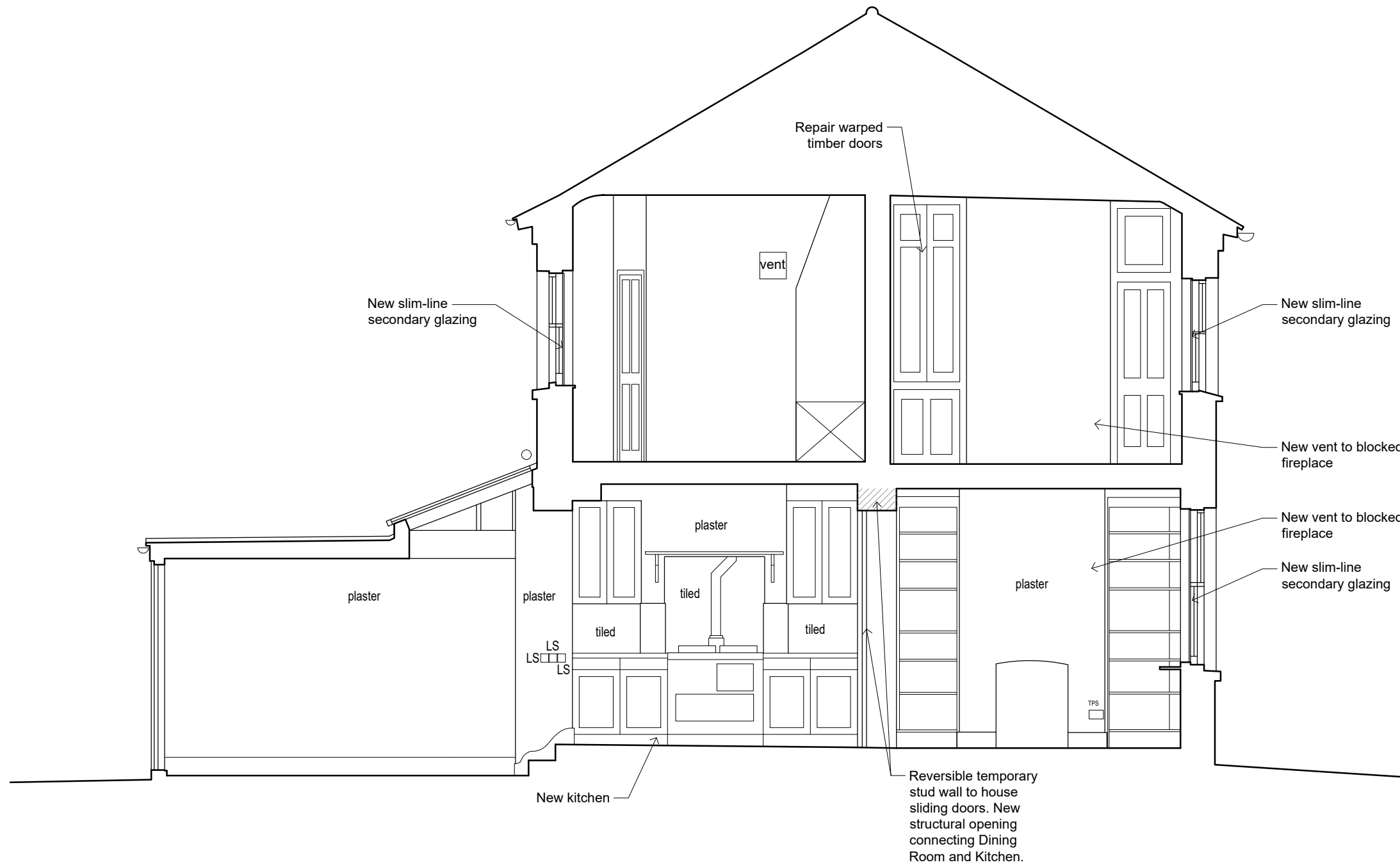

Purpose of Issue:  
**FOR\_PLANNING**

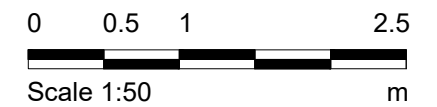

- Notes**
1. Any dwg format drawing is to be read in conjunction with and at the scale of the accompanying pdf.
  2. Where colours other than black or grey are used, the drawing must be plotted in colour.
  3. For status 'C' (Construction) drawings all dimensions are to be checked on site by the contractor, scaling is for Local Authority purposes only.
  4. Unless otherwise indicated, all dimensions are in millimeters.
  5. All information on this drawing is to be read in conjunction with the relevant Donald Insall Associates specification and trade contractors' drawings and information by specialists.
  6. In the event of any discrepancy, please contact us immediately.
  7. This drawing may contain survey information by others and is to be used solely for the purposes for which it was issued.
  8. These are uncontrolled documents issued for information purposes only. If you have any queries regarding the drawings, please contact DIA immediately.
  9. Please note DIA cannot be held responsible for any errors arising from changes made to an uncontrolled dwg file.

**Drawing Status**

F Feasibility  
S Sketch Design  
P Planning  
B Building Control  
D Design Development  
M Measurement  
T Tender  
C Construction  
R Record

Rev	Date	Dwn	Auth	Revision	Rev	Date	Dwn	Auth	Revision
					2	22-10-19	ERH	AXT	ISSUED FOR PLANNING
					1	25-09-19	ERH	AXT	Issued for comment
					0	30-08-19	ERH	AXT	Initial Issue

**Donald Insall Associates**  
Chartered Architects and Historic Building Consultants

12 Devonshire Street  
London W1G 7AB  
(+44) 020 7245 9888  
london@insall-architects.co.uk

3 St Martin's Almshouses, London

Section BB  
As Proposed

Project	STMA3.01	No	2101
Scale (A3)	1:50	Status	3P
		Revision	2

**GENERAL NOTES**

1. Shading indicates new construction
2. Windows to be overhauled and refurbished throughout. Draught stripping to be installed where possible
3. Slim-line secondary glazing to be installed to all sash windows
4. General redecoration throughout
5. Throughout the ground floor; lay new 7mm floating engineered floorboards over existing floorboards (no impact on existing doors or skirting boards)

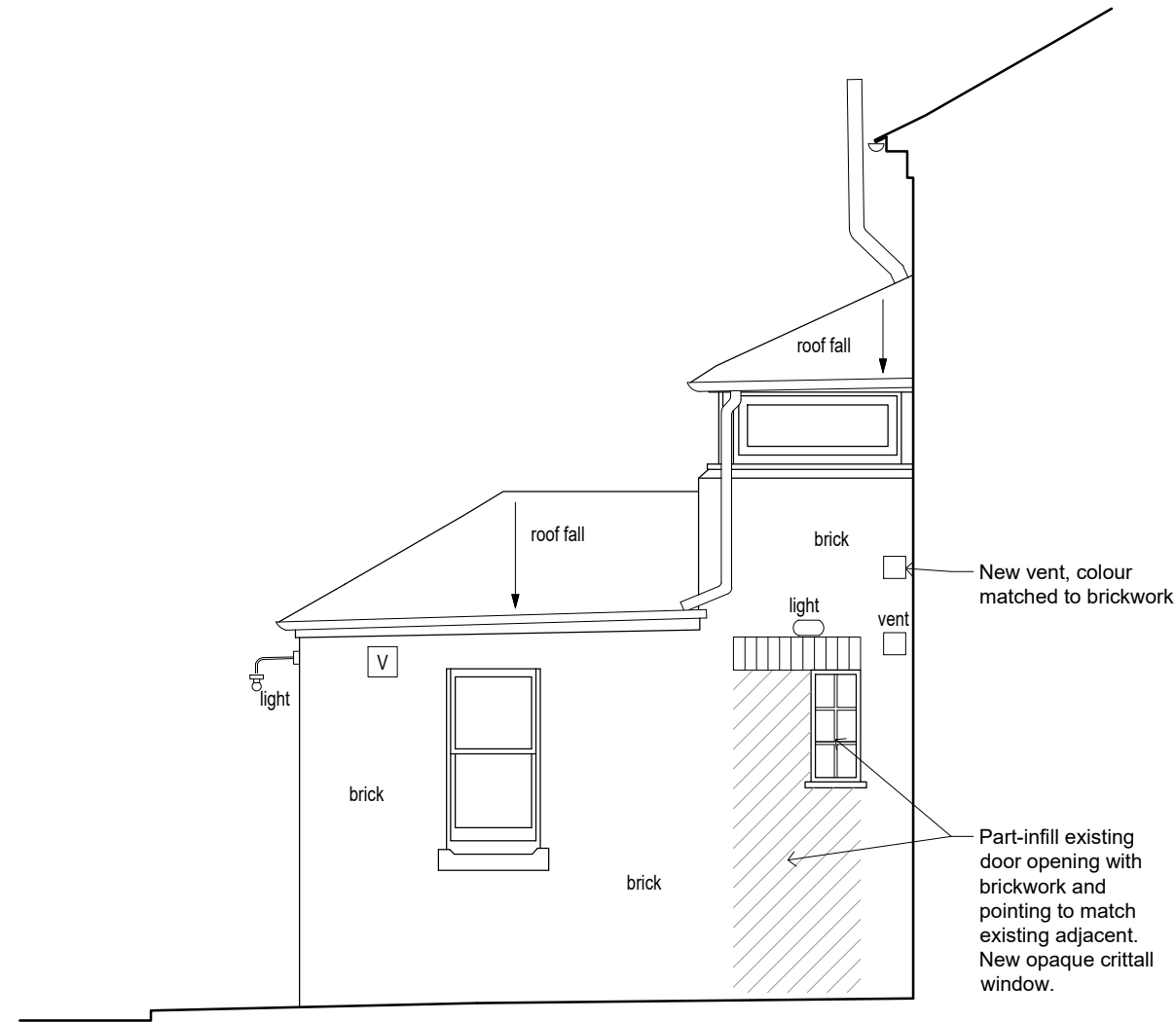

Purpose of Issue:  
**FOR\_PLANNING**

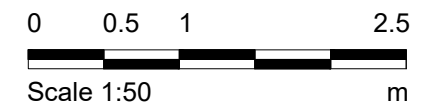

**Notes**

1. Any dwg format drawing is to be read in conjunction with and at the scale of the accompanying pdf.
2. Where colours other than black or grey are used, the drawing must be plotted in colour.
3. For status 'C' (Construction) drawings all dimensions are to be checked on site by the contractor, scaling is for Local Authority purposes only.
4. Unless otherwise indicated, all dimensions are in millimeters.
5. All information on this drawing is to be read in conjunction with the relevant Donald Insall Associates specification and trade contractors' drawings and information by specialists.
6. In the event of any discrepancy, please contact us immediately.
7. This drawing may contain survey information by others and is to be used solely for the purposes for which it was issued.
8. These are uncontrolled documents issued for information purposes only. If you have any queries regarding the drawings, please contact DIA immediately.
9. Please note DIA cannot be held responsible for any errors arising from changes made to an uncontrolled dwg file.

© 2019 DONALD INSALL ASSOCIATES LTD

Rev	Date	Dwn	Auth	Revision
2	22-10-19	ERH	AXT	ISSUED FOR PLANNING
1	25-09-19	ERH	AXT	Issued for comment
0	30-08-19	ERH	AXT	Initial Issue

**Donald Insall Associates**  
Chartered Architects and Historic Building Consultants

12 Devonshire Street  
London W1G 7AB  
(+44) 020 7245 9888  
london@insall-architects.co.uk

3 St Martin's Almshouses, London

Elevation 1 As Proposed	Project <b>STMA3.01</b>	No <b>2200</b>
	Scale (A3) <b>1:50</b>	Status <b>3P</b>
		Revision <b>2</b>