

Flat 3, 10 Lyndhurst Gardens NW3 5NR

Planning application and listed building consent

Window document
7th November 2019 - Revision 3

Project: Flat 3, Full replacement of the existing windows with histoglass MONO single glazing and obscured new side window

Document: Proposed Floor Plans, Elevations and Window Identification, photo report

Date: 07/11/19

To accompany the application for listed building consent for the replacement of windows and an additional window to be added at Flat 3, 10 Lyndhurst Gardens, NW3 5NR

WINDOW
IDENTIFICATION
PLAN

X - Window Number - existing windows



Proposed new window

- Re-wiring the property throughout to meet modern standards
- Painting to internal walls throughout
Red dotted lines indicate existing walls to be removed
All windows to be replaced with histoglass. MONO single glazing. With 1 new side window to be obscured.

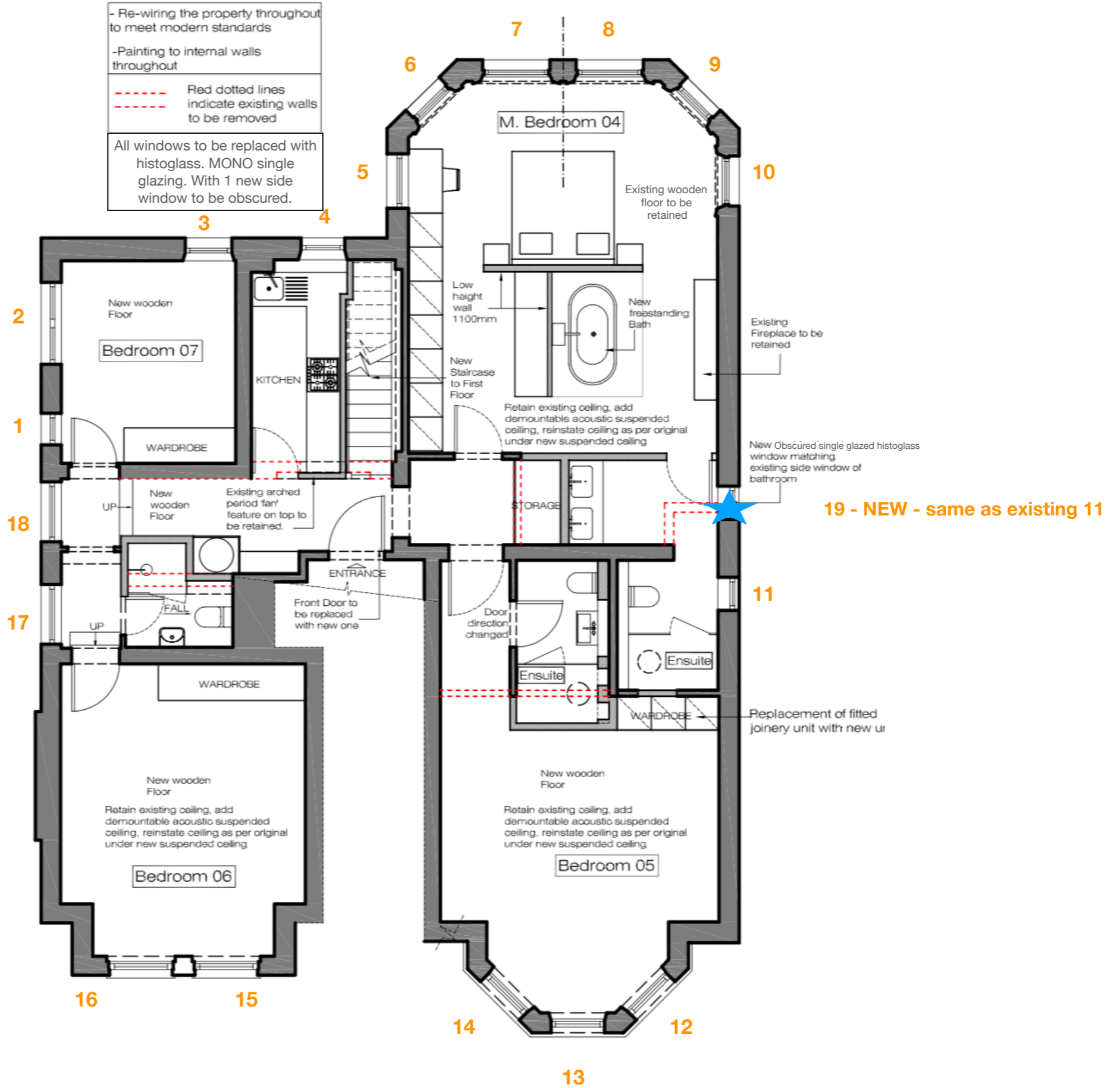

Proposed plan PA-01-00-Rev 1

PHOTOS of
WINDOWS

Front exterior windows



Front exterior windows



Side exterior windows



11 and new 19



2. 1. 18. 17

Rear exterior windows



EXTERNAL
ELEVATIONS
DRAWINGS

Project: Flat 3, 10 Lyndhurst Gardens, NW3 5NR

Document: Existing Side Elevation

Date: 07/11/19



Approved window for flat below, ref. 2017/5205/P and 2017/5366/L



Project: Flat 3, 10 Lyndhurst Gardens, NW3 5NR

Document: Proposed Side Elevation

Date: 07/11/19

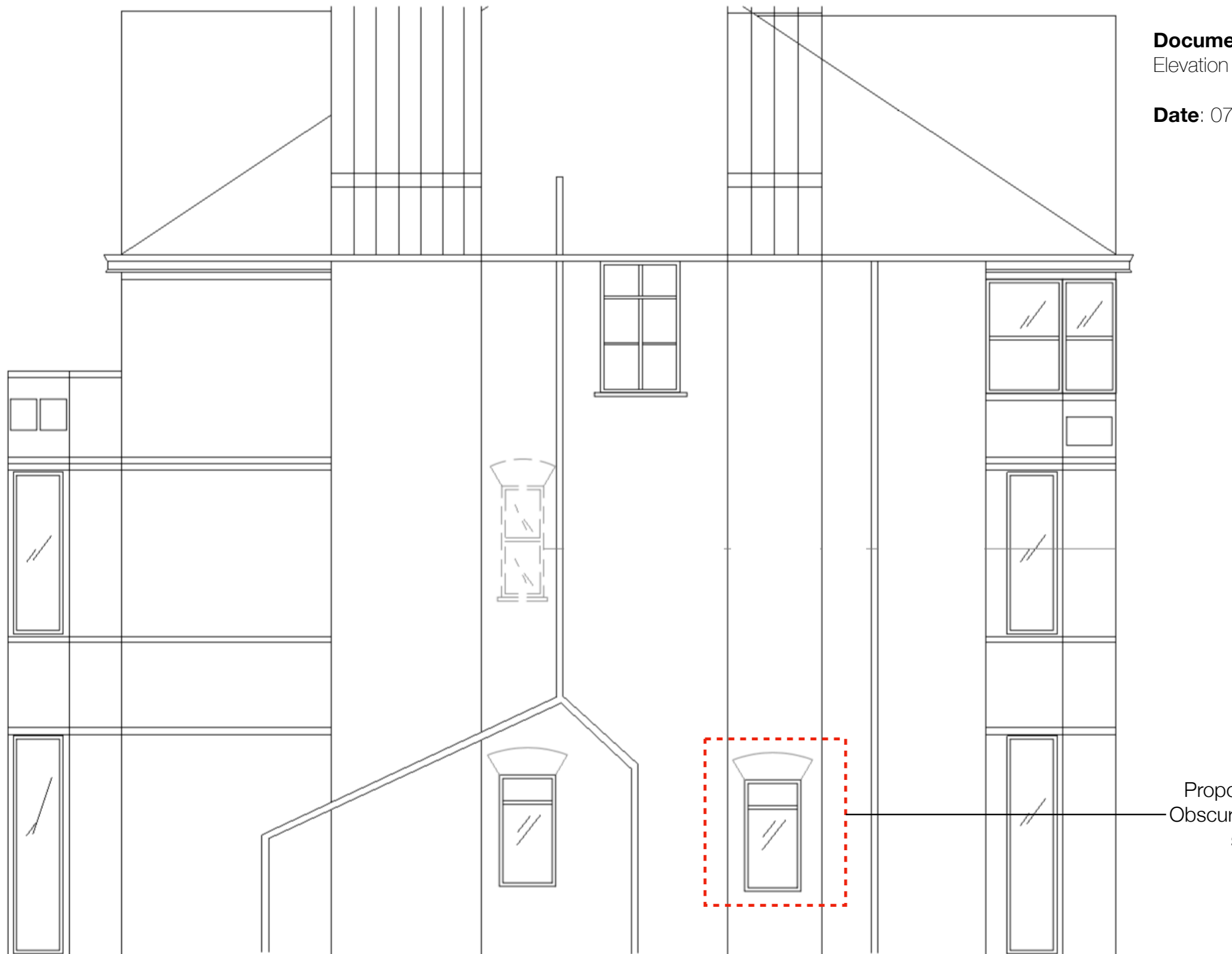

Proposed New Window
Obscured histoglass mono
single glazed

0 M 1 M 5 M 10 M

Project: Flat 3, 10 Lyndhurst
Gardens, NW3 5NR

Document: Existing Side
Elevation

Date: 07/11/19



0 M 1 M 5 M 10 M

Project: Flat 3, 10 Lyndhurst Gardens, NW3 5NR

Document: Existing Front Elevation

Date: 07/11/19



Windows to be replaced with
histoglass mono single glazed
and top decorative glass
panels to be retained.

0 M 1 M 5 M 10 M

Project: Flat 3, 10 Lyndhurst Gardens, NW3 5NR

Document: Existing Back Elevation

Date: 07/11/19



0 M 1 M 5 M 10 M

WINDOW
SIZES
With type and
quantities

Window types and sizes

Histoglass - Mono Single Glazing
Retaining the top decorative existing glass panels

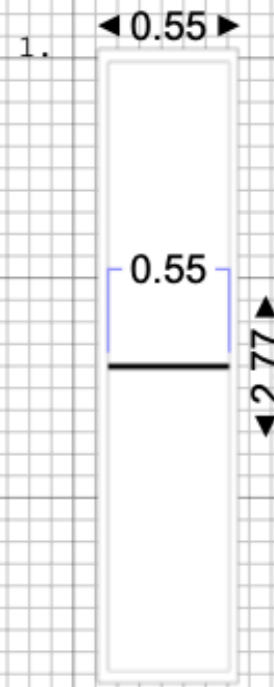

Sash

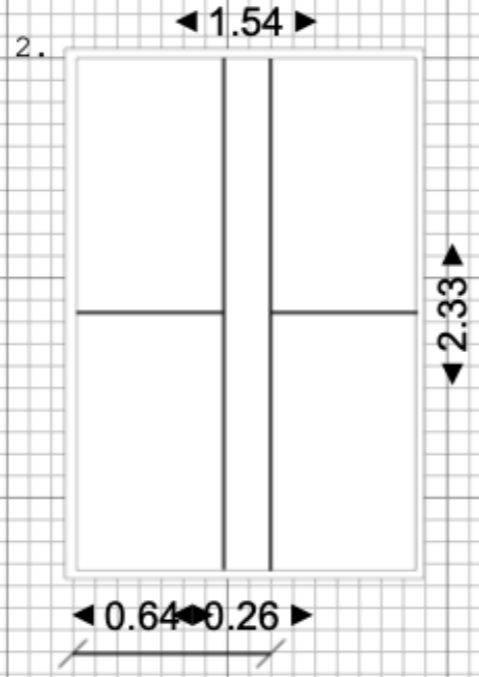

Double sash

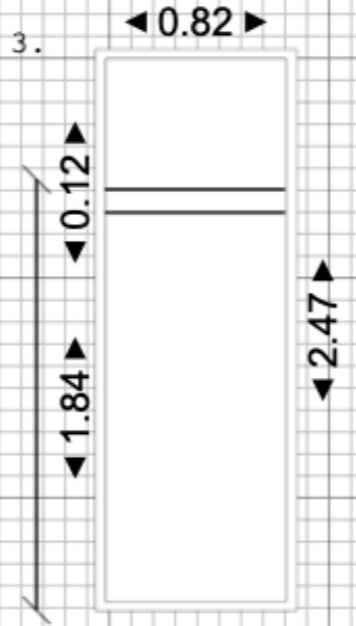

Casement

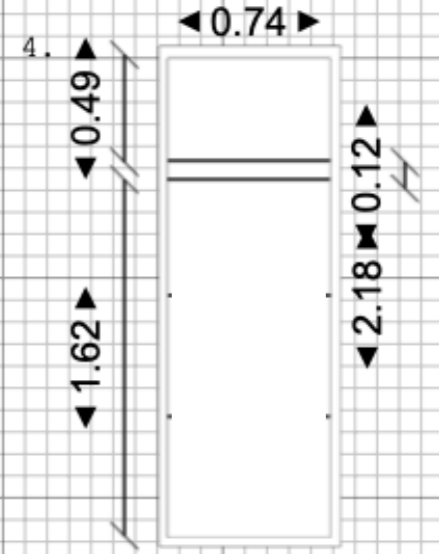

Casement

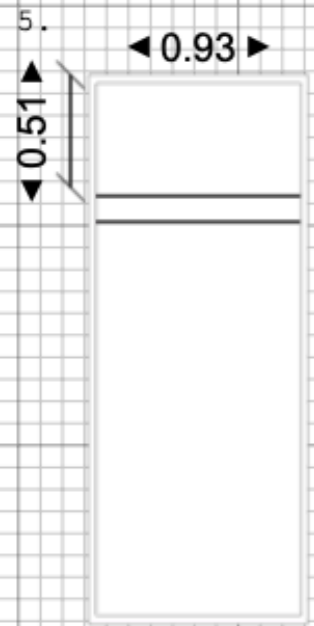

Casement

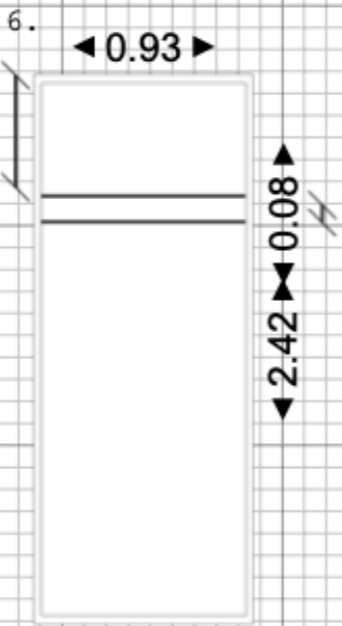

Casement

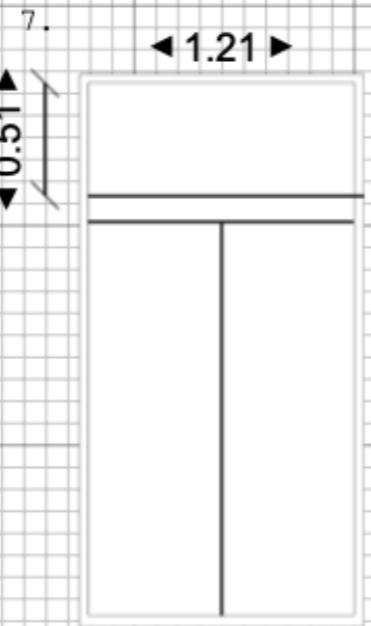

Split Casement

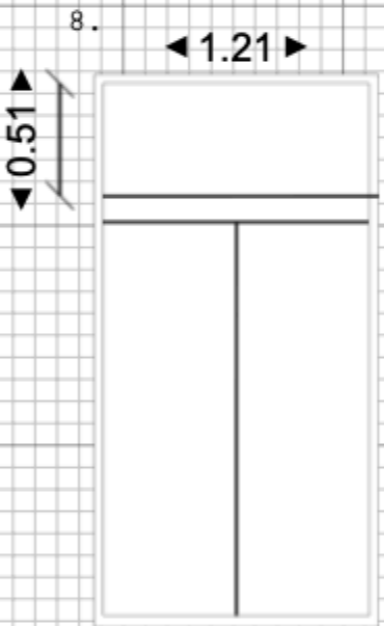

Split Casement

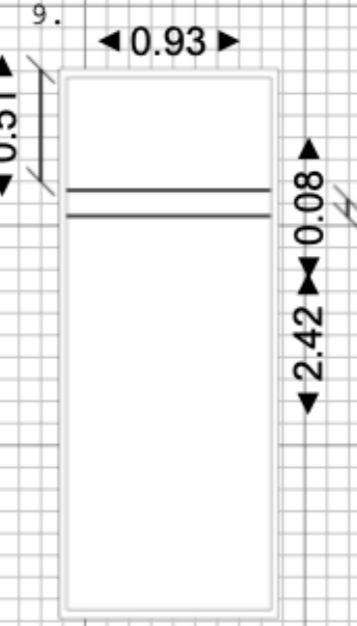

Casement

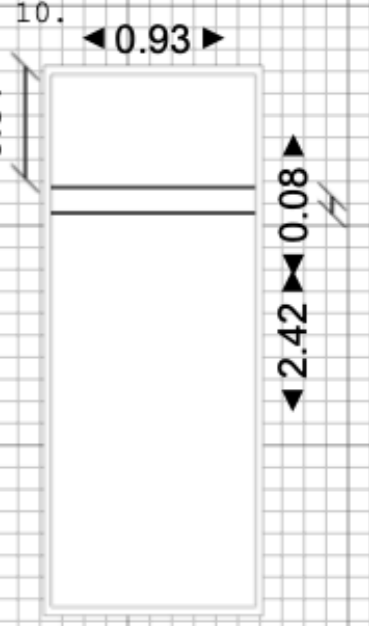

Casement

Site:	Flat 3, 10 Lyndhurst Gardens	Drawing:	Windows 1-10	Project:	Madhvani	Drawn:	Molly Fern	Notes:	NW3 Interiors Ltd
Title:	External/Internal Window Drawings	Scale:	1:10	Date:	15/08/2019	Rev:	A		

Window types and sizes

Histoglass - Mono Single Glazing
Retaining the top decorative existing glass panels

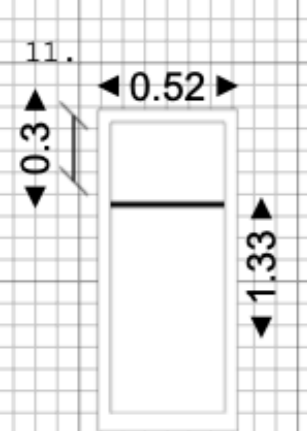

Casement

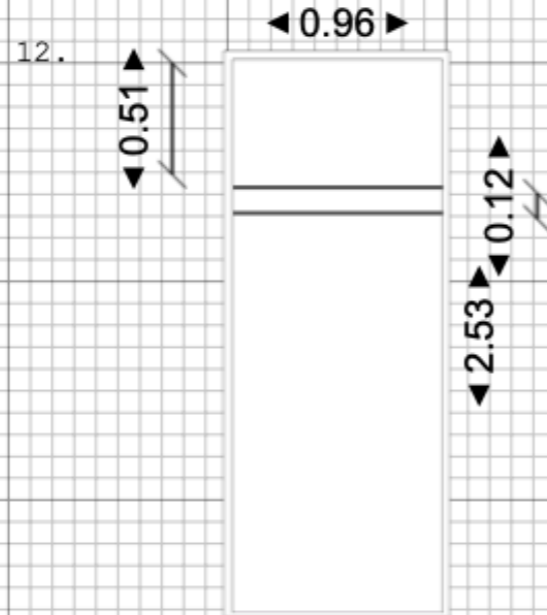

Casement

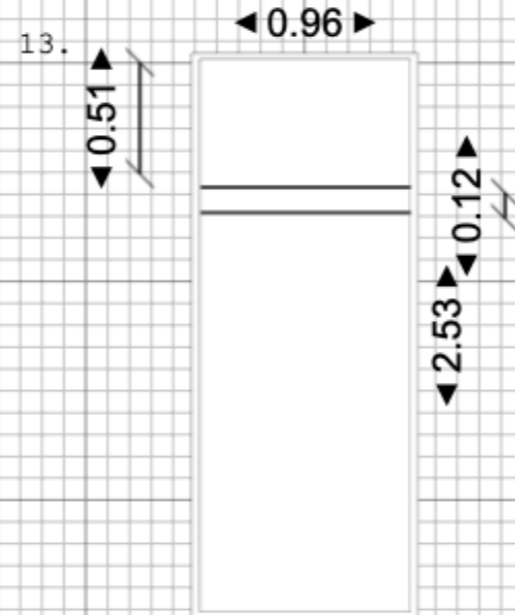

Casement

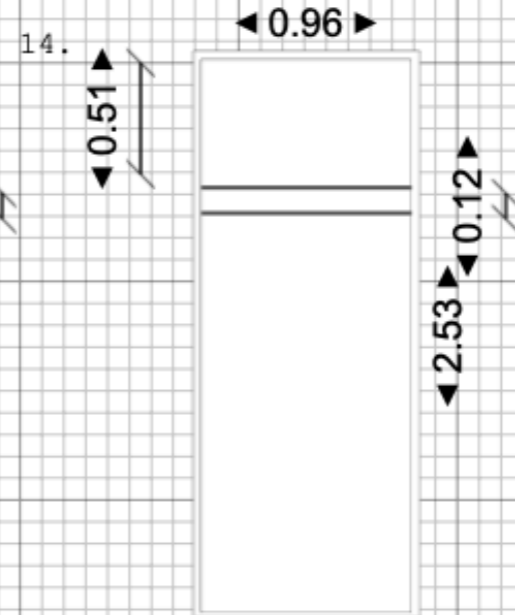

Casement

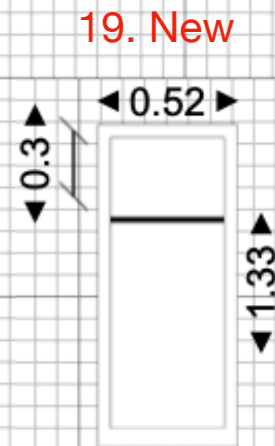

19. New

Casement Same as existing number 11 - Obscured glass

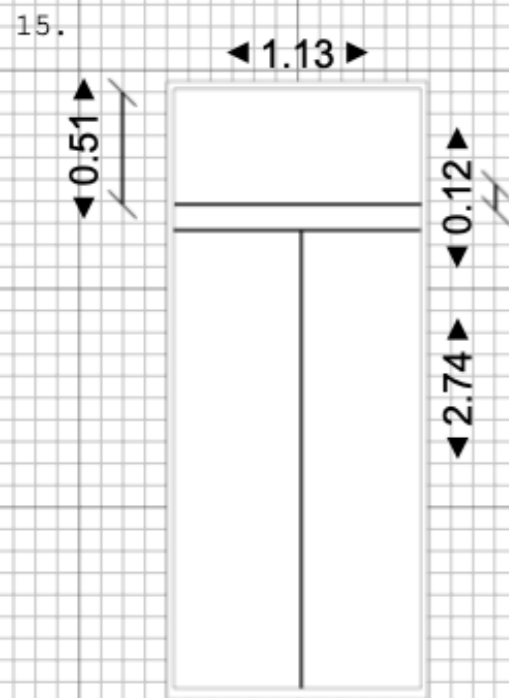

Split Casement

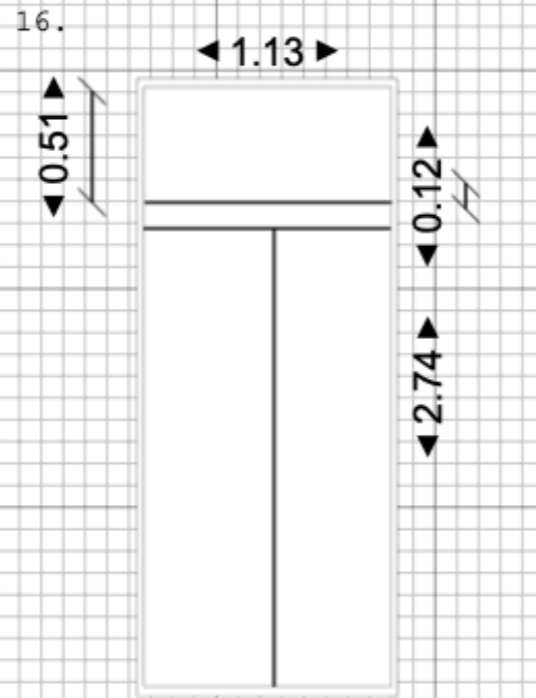

Split Casement

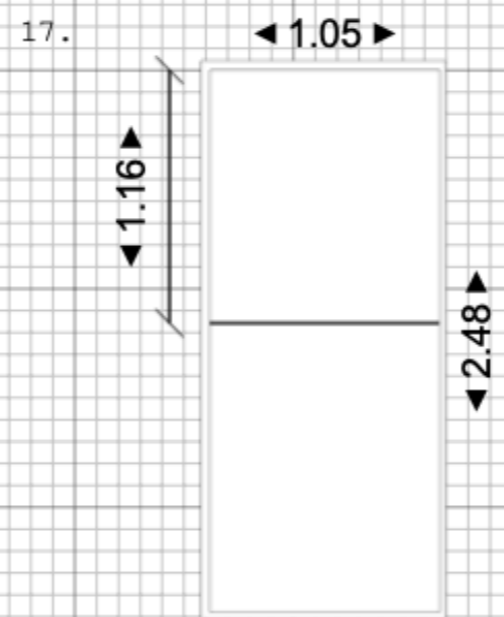

Sash

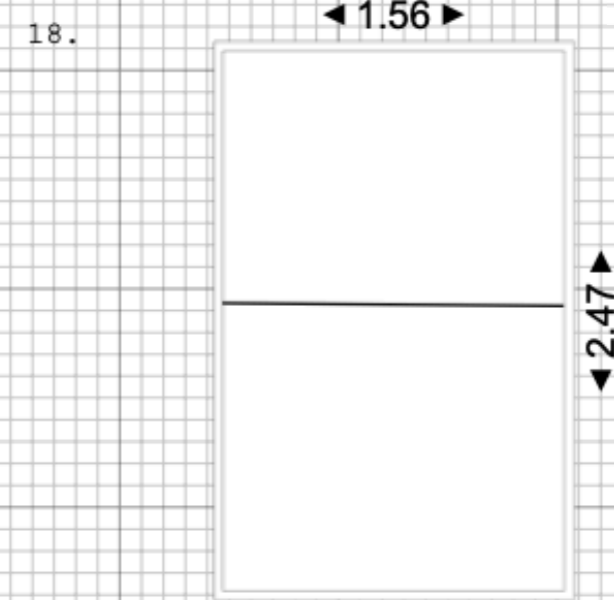

Sash

Site:	Flat 3, 10 Lyndhurst Gardens	Drawing:	Windows 10-18	Project:	Madhvani	Drawn:	Molly Fern	Notes:	NW3 Interiors Ltd
Title:	External/Internal Window Drawings	Scale:	1:10	Date:	15/08/2019	Rev:	A		

Window types quantities existing and one new proposed

Windows Flat 3 Type	Window quantity	Numbers co-ordinating with floor plan
Sash	3	1, 17, 18
Double Sash	1	2
Casement	4	3,4,5,6,9,10,12,13,14
Casement with central split	4	7,8,15,16
Small casement	1	11
New window	1	19
Total	<u>18</u>	<u>19 (with new)</u>

Technical drawings - windows

HISTOGLASS MONO TM
Insulating Laminated Glazing

Build up with Genuine Hand Drawn Glass (9mm)

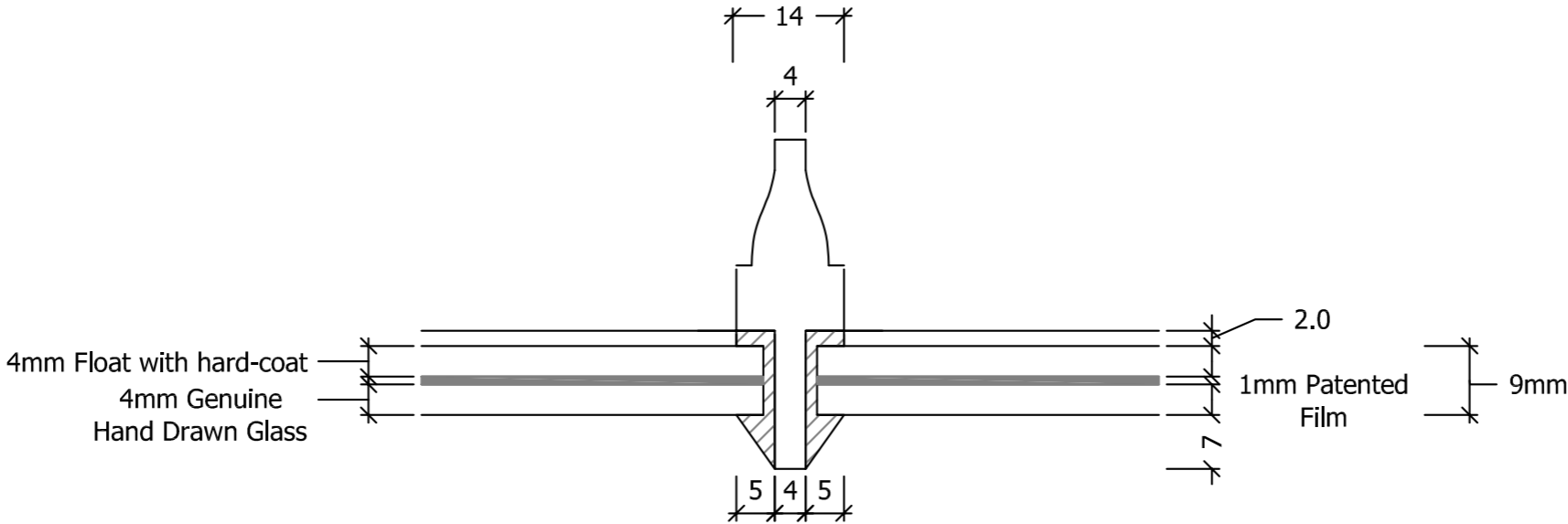

Flat 3, 10 Lyndhurst Gardens NW3 5NR
Planning application and listed building consent

Window document