

THIS DRAWING MUST BE READ IN CONJUNCTION WITH OTHER ARCHITECTS, CONSULTANTS, SUB-CONTRACTORS AND SPECIALIST DRAWINGS.

ALL DIMENSIONS ARE IN MILLIMETRES UNLESS STATED OTHERWISE.

ALL DIMENSIONS ARE TO BE VERIFIED ON SITE AND CONFIRMED BY THE CONTRACTOR BEFORE COMMENCEMENT OF CONSTRUCTION.

IF THIS DRAWING EXCEEDS THE QUANTITIES TAKEN IN ANY WAY, THE ARCHITECTS ARE TO BE INFORMED BEFORE THE WORK IS PUT IN HAND.

Rev	Date	Revision	By	Chk
A	06.11.19	Service floor boxes added	ANM	RJY
B	25.11.19	Section A-A omitted Section C-C added	ANM	RJY

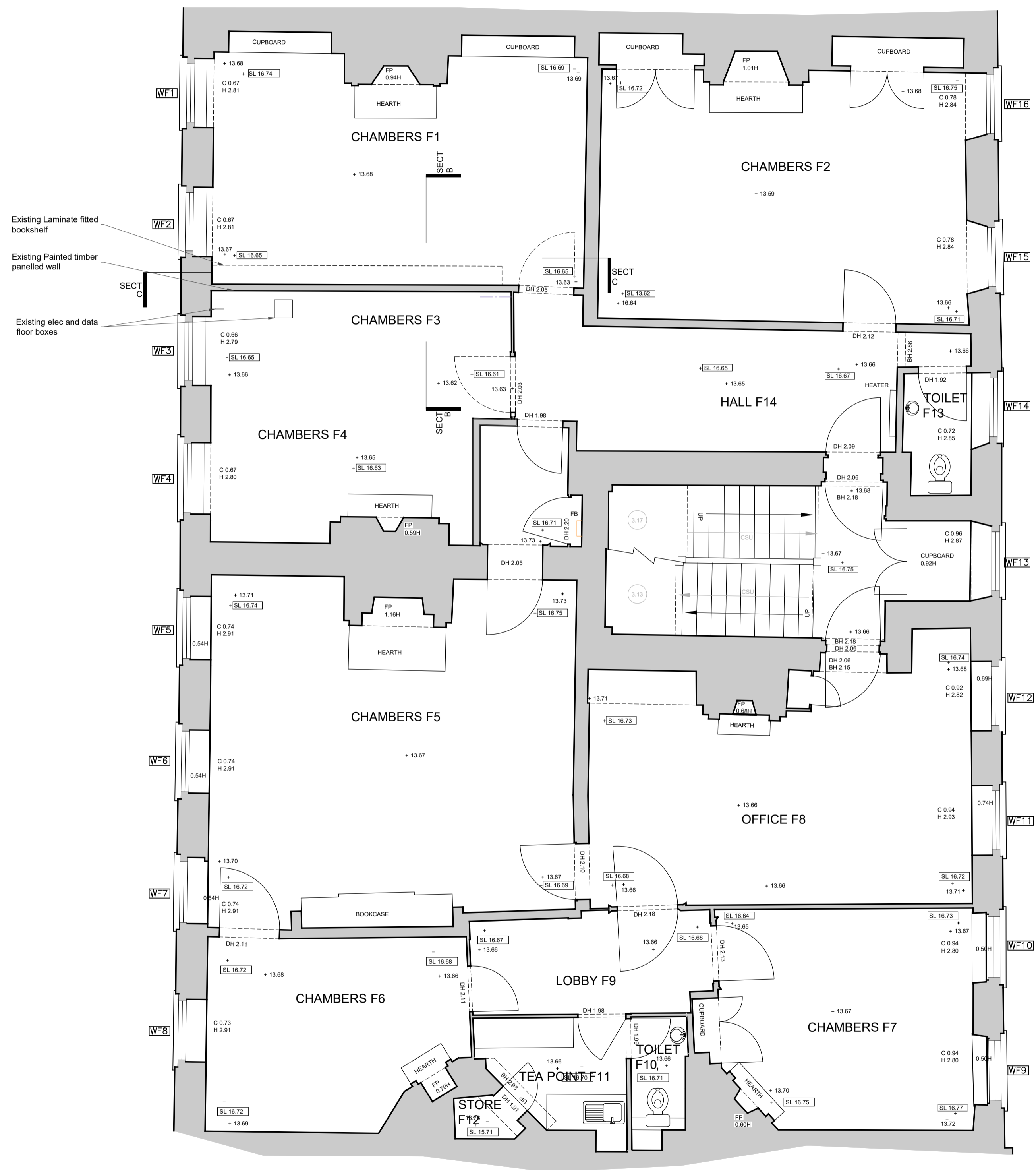

First Floor Plan as existing scale 1:50

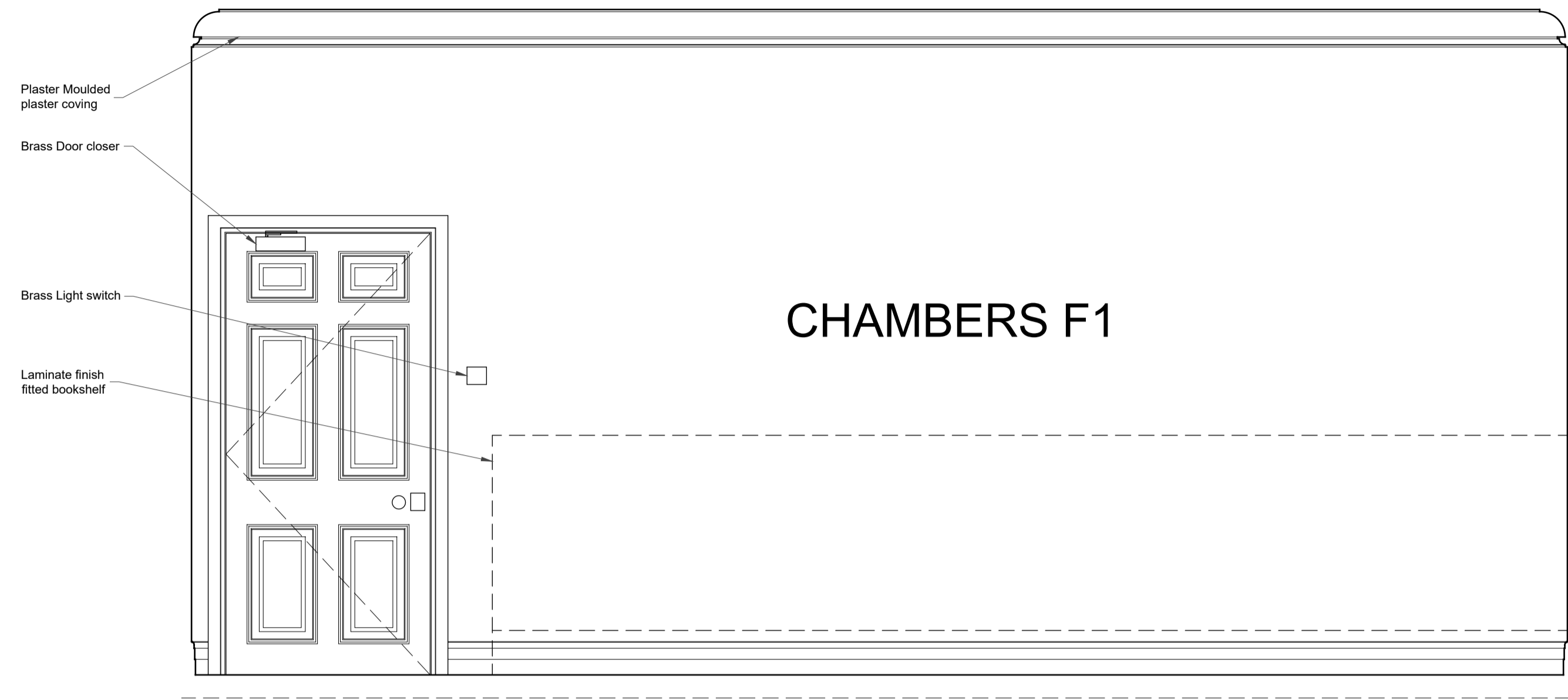

Section C-C, as existing looking south scale 1:20

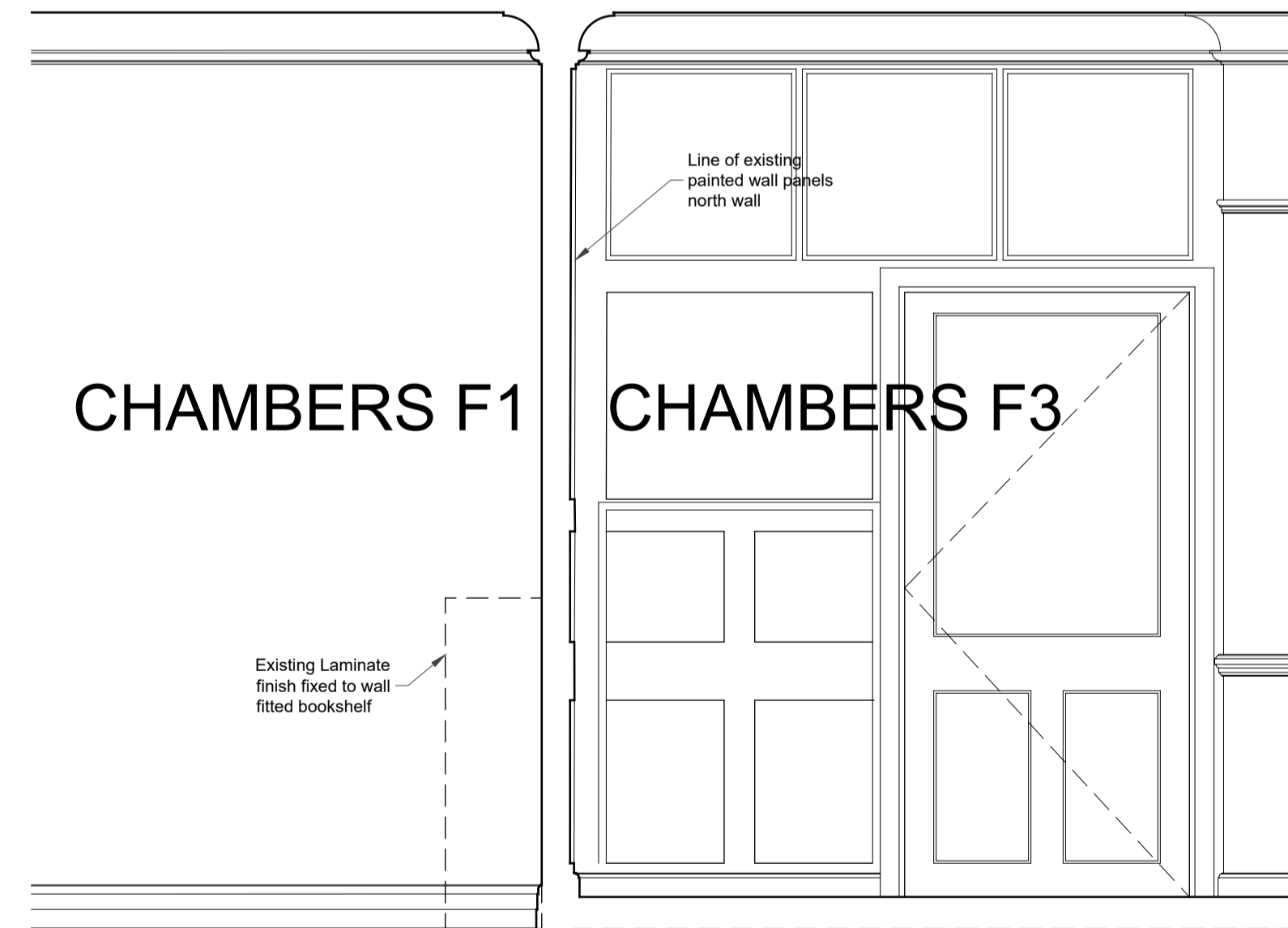

Section B-B, as existing looking east scale 1:20

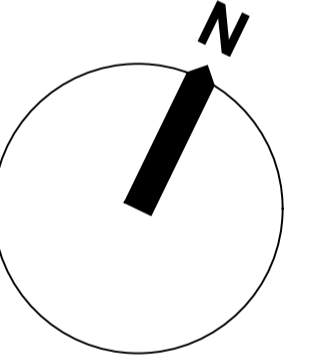

Gilmore Hankey Kirke Limited ©
5 Port House, Square Rigger Row,
Plantation Wharf, London SW11 3TY

Tel: +44 (0)20 7471 8000

Email: mail@ghkarchitects.co.uk
Web: www.ghkarchitects.co.uk

Client
South Square

Project Name
No 1 Gray's Inn- First Floor
Acoustic upgrade to Chambers F1 & F3
Drawing
Floor Plan, elevation and part section
As Existing

Scale 1:50 & 1:20 @ A1

Drawn by ANM 17/06/2019
Checked by RJY 17/06/2019

Project No. Drawing No Revision

HK 2253 001.001 B