

GENERAL NOTES:
 PLANNING & BUILDING CONTROL MAY REQUEST ADDITIONAL INFORMATION. CONTRACTOR, SUB-CONTRACTOR OR SUPPLIER TO REPORT ANY ERRORS, OMISSIONS OR DISCREPANCIES AND IS RESPONSIBLE FOR REQUESTING ANY ADDITIONAL INFORMATION FOR CORRECT EXECUTION OF THE WORKS. ANY VARIATIONS TO THE DRAWINGS MUST OBTAIN PRIOR APPROVAL.

CONTRACTOR, SUB-CONTRACTOR OR SUPPLIER TO VERIFY ALL DIMS ON SITE PRIOR TO ANY WORKS OR SHOP DRAWING PREPARATION.

ANY AFFECT TO COST & PROGRAMME (+VE & -VE) ARISING OUT OF ALTERATIONS TO THE PROPOSED WORKS SHOWN ON THIS DRAWING MUST BE NOTIFIED TO THE ARCHITECT/QUANTITY SURVEYOR.

ALL COMPONENTS, MATERIALS, WORKMANSHIP & HEALTH & SAFETY TO COMPLY WITH CURRENT, RELEVANT BRITISH STANDARDS, COP & APPROPRIATE MANUFACTURERS RECOMMENDATIONS.

DO NOT SCALE FROM THIS DRAWING. WORK FROM THE INDICATED DIMENSIONS ONLY. ANY DISCREPANCIES REPORTED ALL DIMENSIONS ARE MILLIMETERS UNLESS OTHERWISE STATED.

METERAGE REQUIRED TO BE CONFIRMED BY MANUFACTURER WITH ALL MATERIALS TO BE SUITABLE FOR CONTRACT USE.

THIS DRAWING & DESIGN IS COPYRIGHT & PROPERTY OF SHOG STUDIO & ANY USE, REPRODUCTION OR DISCLOSURE IS SUBJECT TO PRIOR CONSENT.

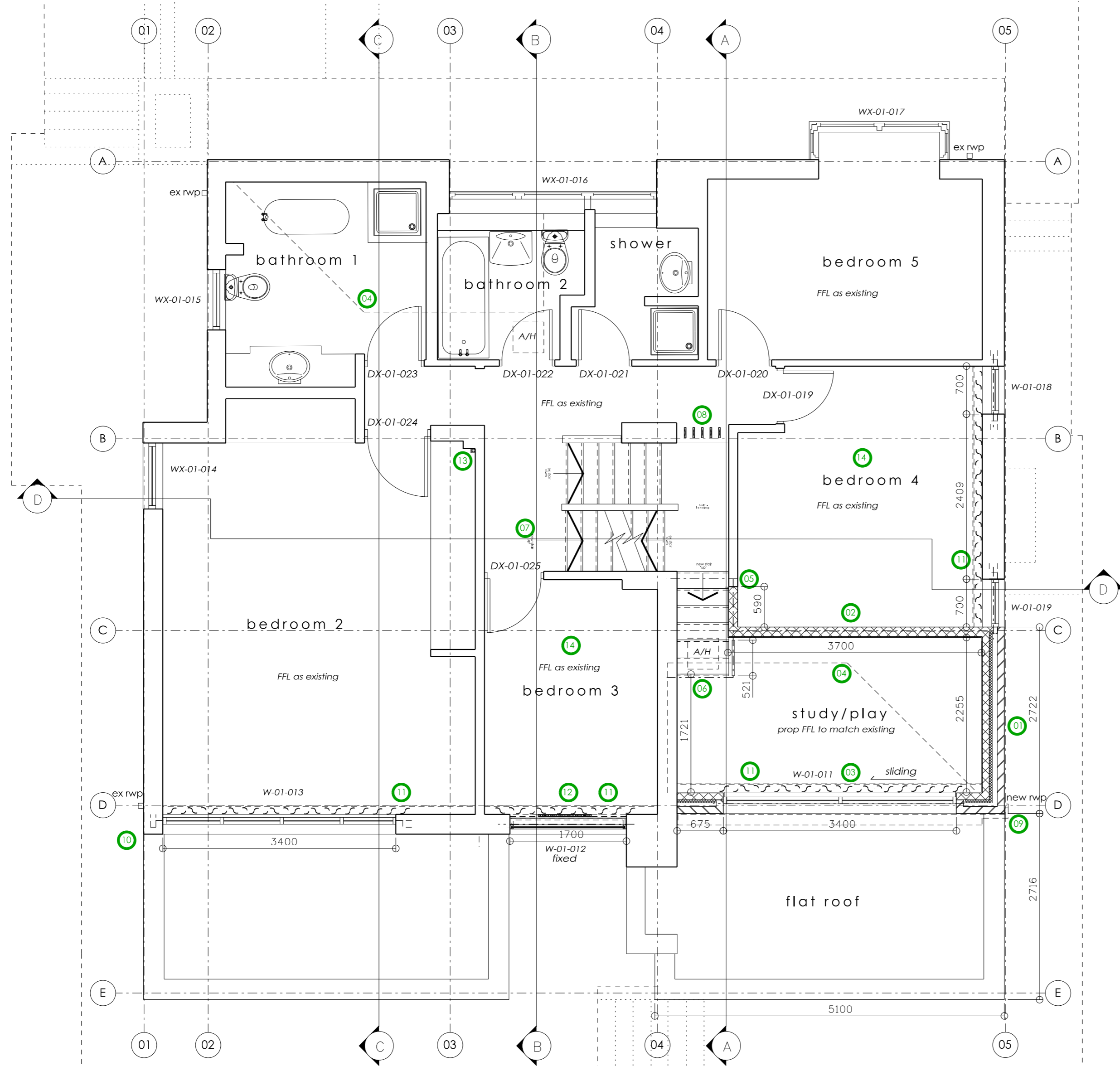

- NOTES:
- 1 New cavity wall construction to consist of 102mm facing brickwork outer leaf to match existing, 100mm cavity with 40mm kingspan K106 to internal leaf with min 10mm residual cavity requirement (60mm available). 100mm thermalite shield blockwork internal leaf with 12.5mm p/board dot/dab internally. Cavity can be reduced to suit ex condition but residual cavity to be maintained.
 - 2 100mm blockwork with p/board & skim both sides.
 - 3 See dwg P17-25-03-007 for demolition.
 - 4 Proposed balcony outline dotted above.
 - 5 Existing cavity wall & window removed to create new opening/access to study/play room.
 - 6 New staircase to match existing.
 - 7 New staircase to 2nd floor to match existing with matching handrail design/detail up to the 2nd floor level only.
 - 8 Existing timber handrail removed & new 25 x 150mm slatted timber oak feature added with max 99mm gap up to u/s of 1st floor ceiling level.
 - 9 flat roof to discharge into new rwp from roof.
 - 10 green roof drainage into new rwp to replace ex pvc rwp discharging into ex gully.
 - 11 Silent gliss curtain track system fixed to 25mm thick sw support for white painted finish, concealed by discreet 100mm p/board pelmet downstand with 9mm MDF hidden back-board support.
 - 12 Vertical 25mm siberian larch timber sliding sunscreen - distressed/natural/knotted to detail.
 - 13 50x50mm p/board allocation to corner of new bedroom to allow new cable routing.
 - 14 loose furniture/fixtures removed by client prior to works commencement.

REV	DATE	BY	DETAIL
T1	07.03.19	GH	TENDER

TENDER ISSUE

Shog Studio

80A Beversbrook Road
 London N19 4QH

Tel: +44(0)20 3566 6943
 www.shogstudio.com
 Company Number 10249485

PROJECT TITLE 3, FITZROY CLOSE, LONDON, CAMDEN, N6 6JT	
DRAWING TITLE PROPOSED FIRST FLOOR PLAN	
CLIENT MR M. CLACK & MS L. FRY	
PROJECT NO. P17-025	DRAWN BY DATE GH 07.12.2018
DRAWING NO. 03-03-003	SCALE A2@1:50

