

FLOORING SPECIFICATION:

MAIN CONTRACTOR TO SUPPLY AND FIT ALL FLOORING SPECIFICATIONS PRESENT ON DRAWING
ALL FLOORS TO BE LAID TO THE MANUFACTURERS RECOMMENDATIONS INCLUDING FLOOR PREPARATIONS
ENSURE ALL FLOORING LAYERS ARE STRIPPED OUT READY FOR NEW WHERE INDICATED

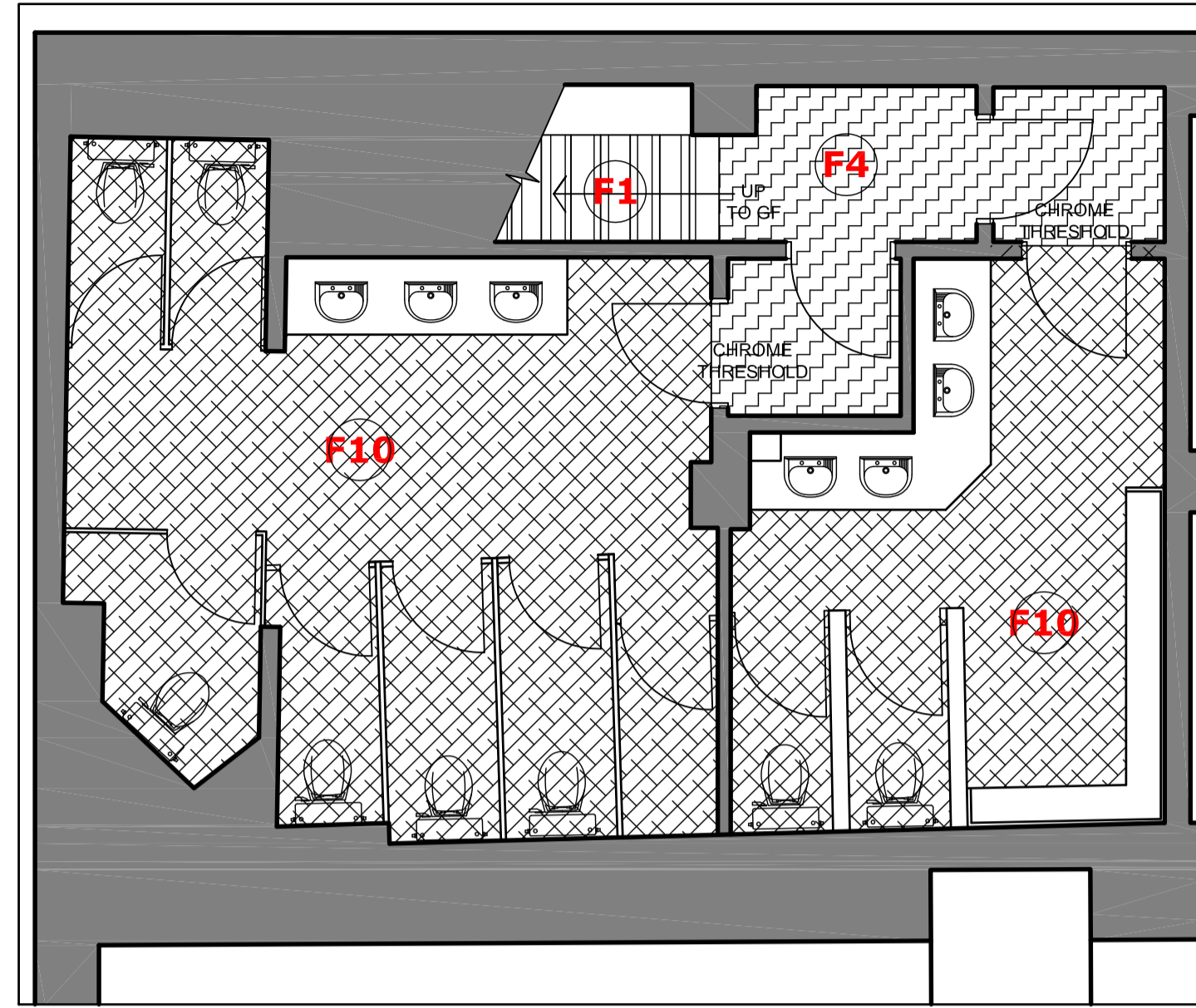

BASEMENT FLOOR

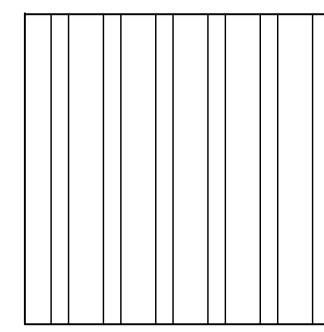

F1

STRIP, STAIN & LACQUER
EXISTING TIMBER FLOOR
STAIN:TBC

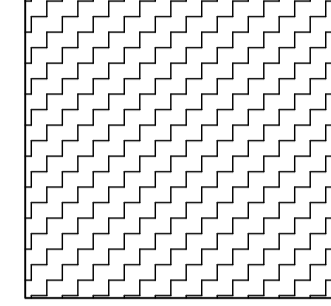

F4

NEW LOBBY MATTING
REF: JAYMART ZIGAZIGA
NIGHTSHADOW

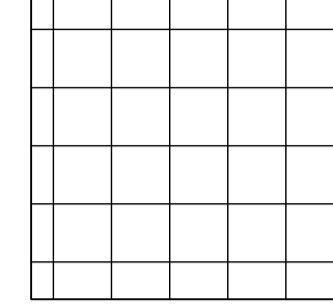

F7

NEW FEATURE TILING
REF: CTD TILES, CAJA
HARMONY, HAVANA WHITE
CONTACT: JOHN LANNIN
07920799100
WITH DARK GREY GROUT

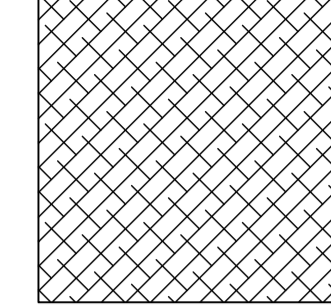

F10

NEW TILED FLOORING
TO TOILETS
REF:NOVEDADES LILLE
2016 URBAN SHARK -
18487 - N/60.7X60.7/R

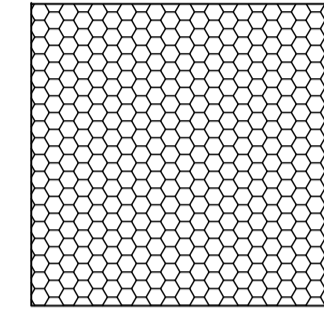

F2

RETAIN EXISTING
MOSAIC TILED FLOOR
ALLOW TO CLEAN

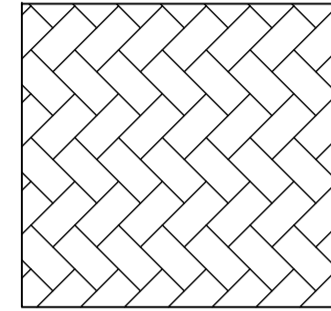

F5

NEW FORBO FLOORING
REF: SURESTEP WOOD
18792-DARK OAK

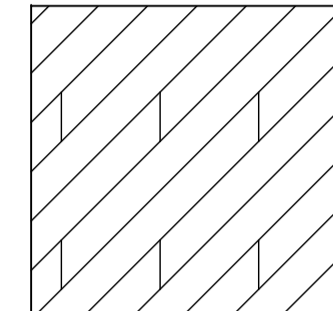

F8

NEW TIMBER FLOOR
REF:JACK EVIE
BRINDLEY ROAD WIDE
WIDTH PLANK

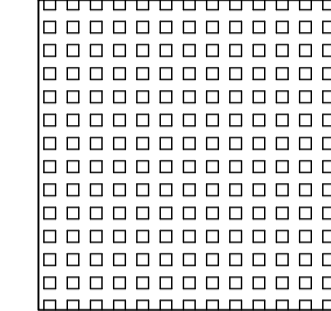

F11

NEW FEATURE TILE
REF: TBC

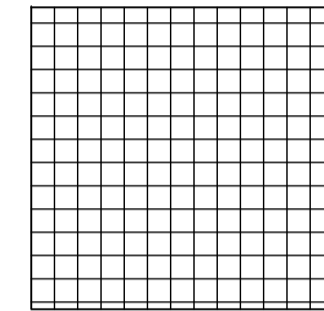

F3

NEW ENTRANCE
FLOORING TILE
REF: TBC

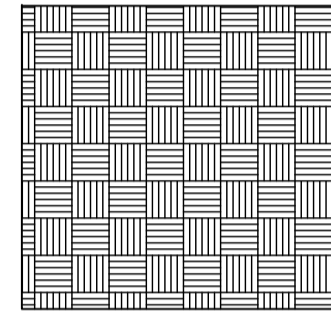

F6

NEW ENTRANCE TILE
REF:TBC

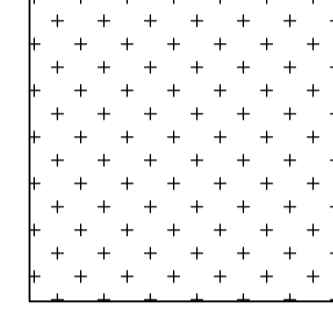

F9

NEW BACK OF HOUSE
FLOORING
REF: ALTRO
STRONGHOLD 30,
DOLPHIN

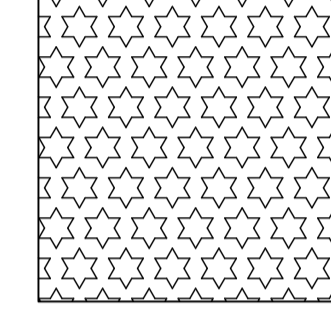

F11

NEW FEATURE
EXTERNAL TILE
REF: CTD VARENNA
EXTERNAL GRADE TILE

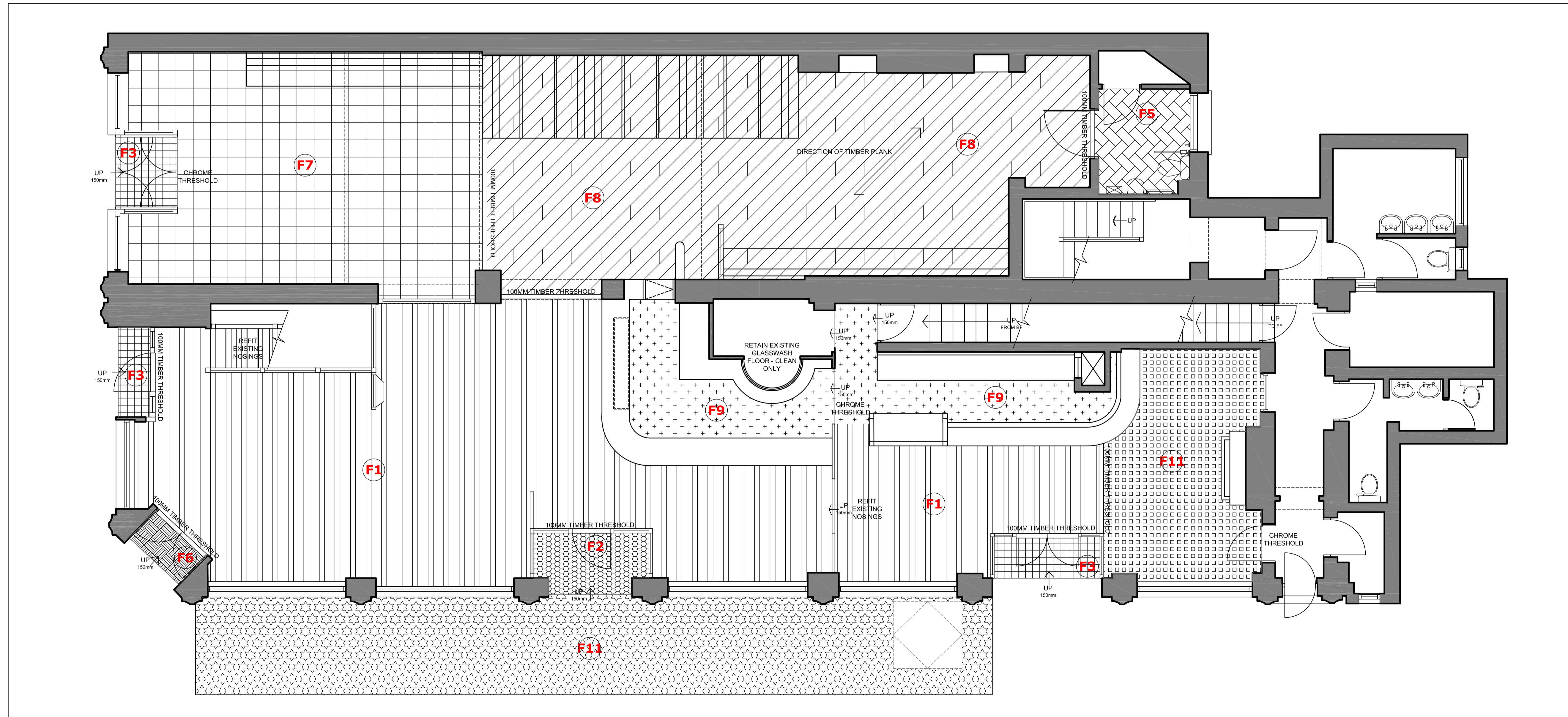
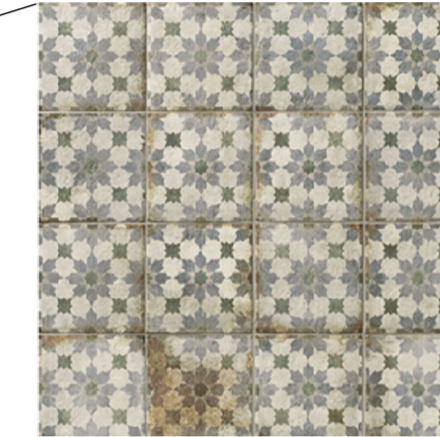

Revision
**A- EXTERNAL FLOOR TILE SHOWN-
24-10-219**

Tel: 01924 252482
Email: studio@spatialized.com
Web: www.spatialized.com

1 NAVIGATION COURT
CALDER PARK
WAKEFIELD
WF2 7BJ

MITCHELLS & BUTLERS PLC
27 FLEET STREET
BIRMINGHAM
B3 1JP

**Mitchells
& Butlers**

Title **PROPOSED FLOORING LAYOUT**

Address **THE ROCKET
120 EUSTON ROAD
LONDON
NW1 2AL**

Date SEP'19	Revision A
Drawn LH	Job No 15-19-1020
Scale 1:50 @ A1	Dwg No 10

Copyright - This drawing & design and all the information contained therein is the sole copyright of Spatialized Ltd - and reproduction in any form is forbidden unless permission is obtained in writing.
CONTRACTORS PLEASE NOTE:
1. Warning: no dimensions are to be scaled from this drawing. All Contractors must visit site and be responsible for taking & checking all dimensions relative to this work. The designer must be advised of any discrepancies in writing.
2. Any discrepancies between drawings & specifications should be reported to the Designer prior to any work commencing.
3. All fixtures and fittings should be fitted/installed in line with industry standards and comply with HSE, CDM, COSHH and the regulations outlined by any other regulatory body applicable.