

**1** PROPOSED GROUND FLOOR PLAN  
1:50 @ A1 - 1:100 @ A3

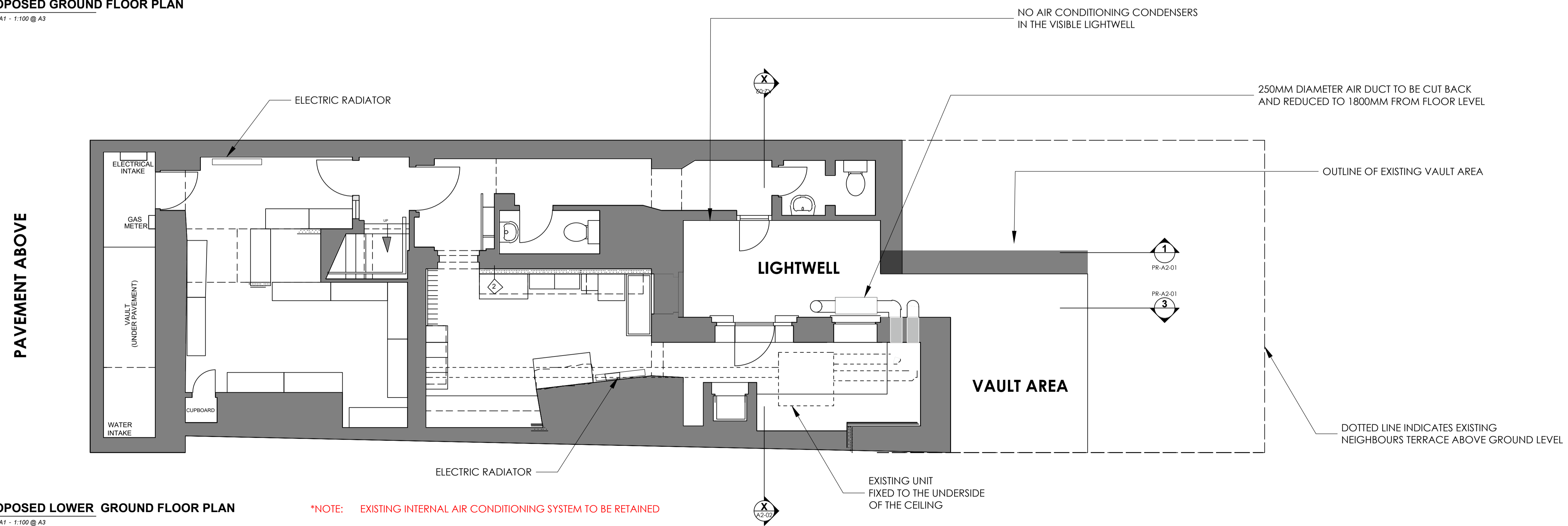

**2** PROPOSED LOWER GROUND FLOOR PLAN  
1:50 @ A1 - 1:100 @ A3

\*NOTE: EXISTING INTERNAL AIR CONDITIONING SYSTEM TO BE RETAINED

REV	COMMENT	AUTH	DATE
1			
2			
3			

© COPYRIGHT REMAINS WITH INK ASSOCIATES LTD.  
THIS DRAWING IS ISSUED ON THE CONDITION THAT IT IS NOT REPRODUCED, RETAINED OR DISCLOSED TO ANY UNAUTHORIZED PERSON EITHER WHOLLY OR IN PART WITHOUT THE CONSENT IN WRITING OF INK ASSOCIATES LTD.  
THIS DRAWING REMAINS THE INTELLECTUAL PROPERTY OF INK ASSOCIATES LTD. (00089944) DO NOT SCALE FROM THIS DRAWING. ALL MEASUREMENTS ARE IN MILLIMETERS UNLESS STATED OTHERWISE. THE GENERAL CONTRACTOR (GCC) IS RESPONSIBLE TO VERIFY DIMENSIONS ON SITE PRIOR TO MANUFACTURE. ANY DIMENSIONAL DISCREPANCIES ARE TO BE REPORTED TO INK ASSOCIATES LTD IMMEDIATELY. THE GENERAL CONTRACTOR (GCC) IS TO PRODUCE A FULL SET OF SCALED CONSTRUCTION DRAWINGS FOR CONSTRUCTION AND APPROVAL PRIOR TO MANUFACTURE. THE CONTRACTOR IS TO ENSURE STRUCTURAL STABILITY OF ALL INSTALLATION DETAILS AND ELEMENTS. ALWAYS REFER TO RELATED DRAWINGS WHEN CONSIDERING INFORMATION CONTAINED WITHIN THIS DRAWING. ALL WORKS CARRIED OUT ON SITE ARE TO BE IN ACCORDANCE WITH ALL CURRENT AND RELEVANT LOCAL BUILDING REGULATIONS AND CONSTRUCTION DESIGN MANAGEMENT (CDM) REGULATIONS. ALL MATERIALS & SURFACE FINISHES USED ON SITE ARE TO BE IN ACCORDANCE WITH APPROPRIATE FIRE RATINGS AS STIPULATED BY BUILDING CONTROL AND THE LOCAL FIRE OFFICER.

DATE CREATED <b>23.10.2019</b>	PROJECT TITLE <b>38 LAMB'S CONDUIT STREET, LONDON</b>
DRAWN BY <b>ME</b>	CLIENT <b>J CREW</b>
CHECKED BY <b>SWB</b>	PROJECT NO. <b>JC-001</b>
SCALE / SHEET SIZE <b>AS STATED</b>	PRINT DATE <b>24/10/2019</b>

DRAWING TITLE <b>PROPOSED GROUND AND LOWER GROUND PLANS</b>		DWG NO.	SUFFIX	REV
<b>PR-A1-01</b>				<b>1</b>