

SVPs RUN TO SOFFIT OF NORTH FACADE

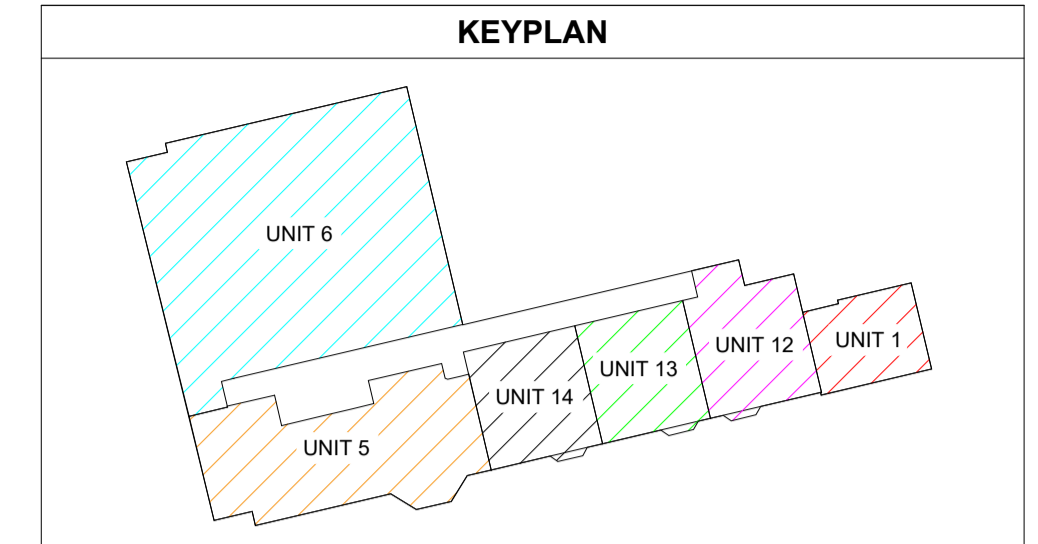

- NOTES**
- 1.00 ALL BELOW GROUND & EXTERNAL DRAINAGE PIPEWORK & MANHOLES BY MAIN CONTRACTOR.
  - 2.00 THE BELOW GROUND DRAINAGE SYSTEM SHALL BE A RODDING POINT SYSTEM IN ACCORDANCE WITH BSEN 752 PARTS 1-7.
  - 3.00 THE CONTRACTOR SHALL ENSURE THAT EVERY ASPECT OF THE SYSTEM IS RODDABLE.
  - 4.00 THE CONTRACTOR SHALL ENSURE THAT ALL GULLEYS ARE SYPHON BELL TYPE.
  - 5.00 MINIMUM BELOW SLAB PIPEWORK FALLS : - WC BRANCHES 1:80  
- OTHER BRANCHES 1:40
  - 6.00 THE MECHANICAL CONTRACTOR SHALL INCLUDE FOR FINAL CONNECTIONS TO ALL SANITARY FITTINGS.
  - 7.00 CLEANING EYES & ACCESS DOORS FOR MAINTENANCE SHALL BE PROVIDED AT EVERY CHANGE IN DIRECTION.
  - 8.00 THE MECHANICAL CONTRACTOR SHALL INCLUDE FOR ALL TRAPS AT SANITARY FITTINGS.
  - 9.00 FINAL CONNECTIONS TO WASH HAND BASINS SHALL BE Ø32mm BUT CONNECTIONS TO SOIL PIPE SHALL BE Ø50mm.
  - 10.00 FINAL CONNECTIONS TO WASHING MACHINES SHALL BE Ø40mm BUT CONNECTIONS TO SOIL PIPE SHALL BE Ø50mm.
  - 11.00 FINAL CONNECTIONS TO WATER CLOSETS SHALL BE Ø100mm.
  - 12.00 SWEEP ENTRY FITTING AT CONNECTION BETWEEN Ø32mm WASTE FROM W.H.B. AND Ø50mm COMMON WASTE.
  - 13.00 EACH W.C. SHALL HAVE INDIVIDUAL Ø22mm OVERFLOW TO DISCHARGE TO FLOOR WITH BEND.
  - 14.00 FIRE SLEEVES TO BE INSTALLED ON ALL PIPEWORK PASSING THRO' SLAB OR FIRE RATED WALL.
  - 15.00 ALL EXPOSED WASTE PIPEWORK, WASTE TRAPS, COLD, HOT & MAINS PIPEWORK TO BE CHROME PLATED.
  - 16.00 ROOF VENT TILE BY MAIN CONTRACTOR, CONNECTED BY MECHANICAL CONTRACTOR.
  - 17.00 ALL SOILS AND VENT PIPES PENETRATING FIRE WALLS TO BE COMPLETE WITH INTUMESCENT FIRE COLLARS.
  - 18.00 POSITIONS OF KITCHEN APPLIANCES TO BE CONFIRMED.
  - 19.00 ALL SVPs LOCATIONS AND DETAILS TO BE AGREED. SVPs TO ADDED TO DRAWING FOLLOWING CONFIRMATION OF COORDINATION.

**SOILS & WASTES SCHEDULE OF SYMBOLS**

	PIPEWORK BELOW GROUND, INTERNAL
	PIPEWORK BELOW GROUND, EXTERNAL
	PIPEWORK IN AT HIGH LEVEL
	PIPEWORK AT LOW LEVEL
	MANHOLE
	CLEANING EYE
	SOIL VENT PIPE
	TRAPPED WASTE CONNECTION
	DISHWASHER
	WASH HAND BASIN
	BATH
	WASHING MACHINE
	SHOWER
	WATER CLOSET

SCHEDULE OF PIPE SIZE CONNECTIONS TO SOILS AND WASTE OUTLETS - Part 1 of 1  
L18051 - BELSIZE PARK FIRESTATION

OUTLET REF.	DESCRIPTION	WASTE PIPEWORK SIZE
WHB	WASH HAND BASIN	ø32mm
SHW	SHOWER	ø40mm
WC	WATER CLOSET	ø100mm
WM	WASHING MACHINE	ø40mm
DW	DISH WASHER	ø40mm
SINK	SINK	ø40mm

NOTE: ARCHITECTURAL DRAWING USED FOR COMPILATION OF IN2 DRAWING. ARCHITECTURAL DRAWING REVISION : DATE RECEIVED : 14.06.2019

STATUS	DATE	DESCRIPTION	DRN	ENG	APP	REV
S4	17.09.2019	CONSTRUCTION ISSUE	JDT	IPG	BF	C2
S4	19.06.2019	CONSTRUCTION ISSUE	JDT	IPG	BF	C1



PROJECT  
**BELSIZE PARK FIRESTATION**

CLIENT  
**PLATINUM LAND**

DRAWING TITLE  
**MECHANICAL SERVICES INSTALLATION  
GROUND FLOOR LEVEL  
SOILS & WASTE SERVICES LAYOUT**

SCALE 1:100 @ A1  
1:200 @ A3

SIZE **A1**

PROJECT REF: **L18051**

DRAWING No. **L18051-IN2-00-00-DR-M-4001**

STATUS  
**S4**

REVISION  
**C1**