

# 41007

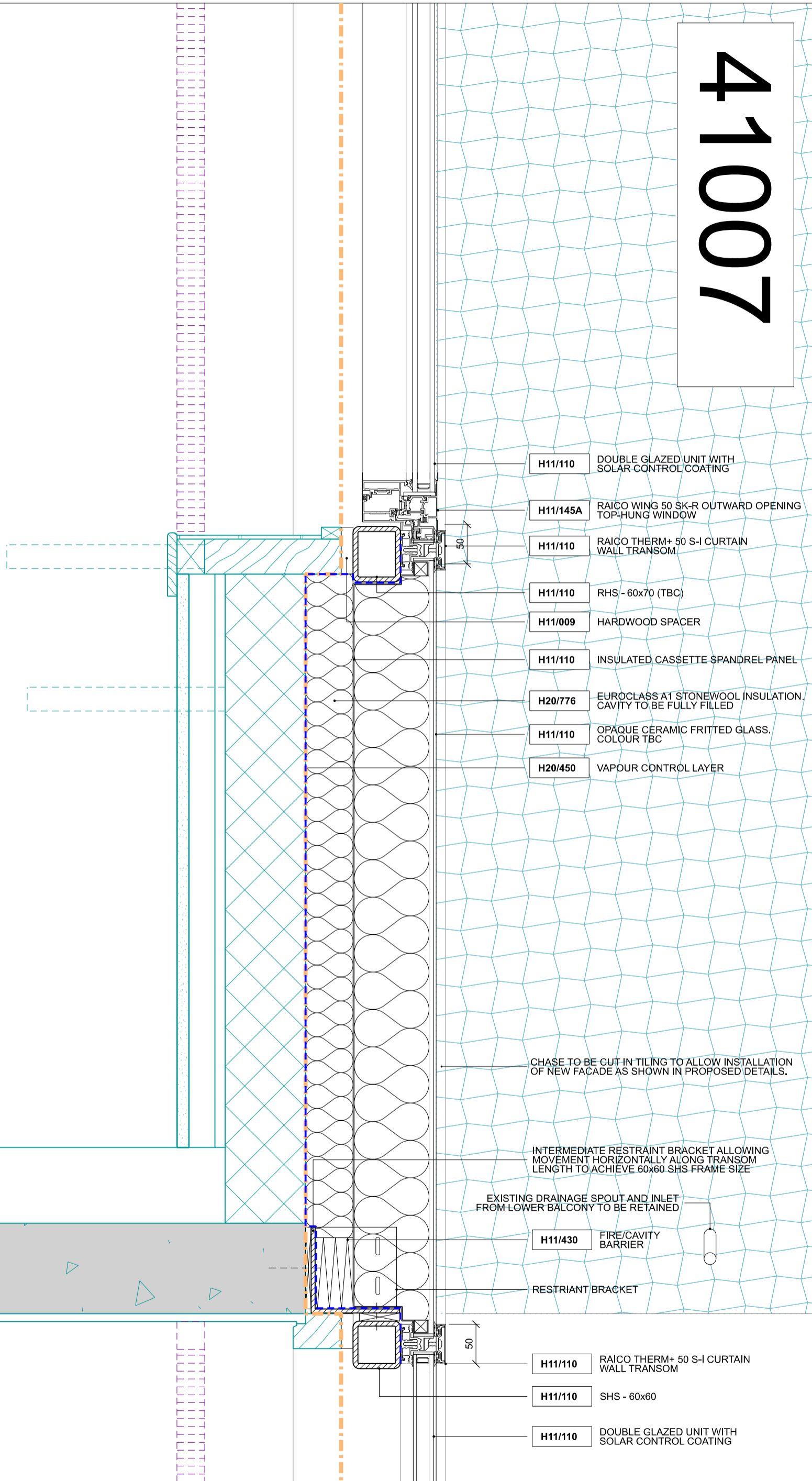

KITCHEN WINDOWS - FIXED GLAZING. AS EXISTING. CAPPING FRAMING BONDED TO FIXED GLAZING TO RESTORE APPEARANCE OF HISTORIC OPENING RHYTHM.

STEEL SECTION SIZES AND CONNECTIONS TO STRUCTURE TO BE CONFIRMED FOLLOWING SURVEY WITH SPECIALIST FACADE CONTRACTOR & STRUCTURAL ENGINEER. MINIMUM EDGE DISTANCES TO BE PROVIDED AT ALL LOCATIONS.

NO CONTINUOUS VOIDS ALLOWED IN EXTERNAL WALL CONSTRUCTION. EUROCLASS A1 STONEWOOL INSULATION TO FILL ALL POTENTIAL VOIDS IN FACADE CONSTRUCTION, IF IN DOUBT ASK THE ARCHITECT.

REPLACE DAMAGED AND CRACKED TILES. CLEAN AND REGROUT AREA OF TILING SHOWN TO ALL FACES OF PROJECTING BALCONIES. TO EXTENT SHOWN. FOR APPROXIMATE EXTENT OF TILING REPAIRS REQUIRED, PLEASE REFER TO DRAWINGS 11035 & 11036.

PLEASE ALSO REFER TO DOCUMENT 652-MICA-CH-ZZ-RP-A-70010 WHICH DESCRIBES THE CONDITION OF THE EXISTING BALCONIES AND DRAWING 12035 WHICH OUTLINES THE SCOPE.

DO NOT SCALE FROM THIS DRAWING. CONTRACTOR TO CHECK ALL DIMENSIONS ON SITE. ANY DISCREPANCIES TO BE REPORTED TO THE ARCHITECT IMMEDIATELY.

NOTES	REVISIONS															
<ul style="list-style-type: none"> <li>Existing Building (Original Parts - These Elements May Have Been Modified)</li> <li>Existing Building - Elements Added by Tenants (These Elements Are Likely To Vary In Each Flat)</li> <li>Extent of works to tiling (elevation). For description of work, refer to specification XXXXX. Please note that pattern shown on the drawing is indicative.</li> <li>Extent of tiling works (plan and section)</li> <li>Tiling works required to internal walls of balconies if existing adjacent tiles are within this zone (4 tiles wide)</li> </ul>	<ul style="list-style-type: none"> <li>Scope Line</li> <li>Proposed</li> </ul> <table border="1"> <thead> <tr> <th>REV</th> <th>DATE</th> <th>DESCRIPTION</th> </tr> </thead> <tbody> <tr> <td>P1</td> <td>09.07.19</td> <td>PRELIMINARY</td> </tr> <tr> <td>P2</td> <td>07.08.19</td> <td>EOC COMMENTS INCORPORATED</td> </tr> <tr> <td>P3</td> <td>21.10.19</td> <td>PLANNING CONDITION DISCHARGE</td> </tr> <tr> <td>P4</td> <td>23.10.19</td> <td>CHANGES TO NOTES</td> </tr> </tbody> </table>	REV	DATE	DESCRIPTION	P1	09.07.19	PRELIMINARY	P2	07.08.19	EOC COMMENTS INCORPORATED	P3	21.10.19	PLANNING CONDITION DISCHARGE	P4	23.10.19	CHANGES TO NOTES
REV	DATE	DESCRIPTION														
P1	09.07.19	PRELIMINARY														
P2	07.08.19	EOC COMMENTS INCORPORATED														
P3	21.10.19	PLANNING CONDITION DISCHARGE														
P4	23.10.19	CHANGES TO NOTES														

COPYRIGHT MICA ARCHITECTS LLP ©

JOB **Centre Point**  
Centre Point House Facade

**MICA**

123 Camden High Street London NW1 7JR  
T: 020 7284 1727 F: 020 7267 7826  
Info@micaarchitects.com www.micaarchitects.com

**PRELIMINARY**

TITLE **Proposed Detail - Section**  
Curtain Walling/ Blockwork- Living Room

652-MICA-CH-ZZ-DR-A-41007 P4

CHECKED	DRAWN	SCALE	SIZE	REV DATE
JK	HB	1:5	A3	23.10.19