

Copyright: All rights reserved. This drawing must not be reproduced without permission.

Only the original drawing should be relied upon. Contractors, subcontractors and suppliers must verify all dimensions on site before commencing any work or making any shop drawings.

All shop drawings to be submitted to the architect for comment prior to fabrication.

This drawing is to be read in conjunction with the Architect's specification, bills of quantities / schedules, structural, mechanical & electrical drawings and all discrepancies are to be reported to the architect.

Do not scale from this drawing. Dimensions are in millimetres unless otherwise stated.

revision / date / amendments	First Issue
- / 26/01/18 /	1. Tender Addendum (1). Indication of 4 post truss fixed at stage level for integrated automatic retractable acoustic baffles and integrated lighting rig.
A / 23/03/18 /	2. Tender Addendum (2). New AHU + Attenuator over stage to be hung to existing relocated secondary beams in Flytower.
B / 12/04/18 /	- Door and window numbers updated
C / 01/06/18 /	Listed Building Application 1. Indication of 4 post truss fixed at stage level for integrated automatic retractable acoustic baffles and integrated lighting rig. 2. New AHU + Attenuator over stage to be hung to existing relocated secondary beams in Flytower.
D / 05/07/18 /	1. Updated stage 4 fit out interior and kitchen layouts. 2. Built-out column omitted on retail side
E / 31/07/18 /	G.7. Refer to Basement drawing. WCs vents to run through to roof and boxed out as part of joinery. G.8. Ventilation grille opening below window WG-26 G.9. Basement Ventilation plant to Bin Store
F / 15/08/18 /	Colour coding added to revised drawing Rev E
G / 22/01/19 /	Following sub-basement extension there is a requirement for smoke ventilation with a new smoke vent outlet on Bayham Street.
H / 29/01/19 /	1. Retrospective Planning for Dome Propping up works. Ref: 2019/0695/L
I / 29/05/19 /	Proposed Dome Truss LBC Application
J / 12/07/19 /	Proposed Dome LBC Application
K / 30/10/19 /	1. Permanent Dome Truss. 2. Dome Front Pier PFCs. 3. Replacement of Dome Copper Roof 1. Following review of PFC location, PFCs to be chased into wall and concealed.

**LEGEND**

- Proposed Works
- Existing Building Fabric KOKO née Camden Palace Theatre (1900)
- Existing Building Fabric Hope & Anchor (approx. 1850)
- Existing Building Fabric Bayham Place (from 1875)
- Existing Modern Building Fabric Bayham Place (from 2006)
- Building Fabric to be demolished
- Demolition of Flooring / Elevation / Wall
- Proposed Excavation
- Remove and retain in alternate location
- Retain and protect existing
- Retain, make good, ease and adjusted
- Means of escape Route
- Private Members Route
- Koko Customer Route
- Public Route
- Artist Route
- ▬ Proposed Riser
- ▬ Proposed Risers Above
- RM.4-06 Room Number
- DG-02 Door Number
- W4-05 Window Number
- Hope & Anchor Demise
- Koko Demise
- 1 Bayham Street & 65 Bayham Place Demise

30.10.19

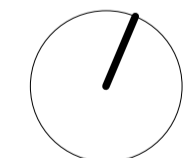

0 1 2 3 4 5 6 7 8m

**PLANNING**

Archer Humphryes Architects

Basement  
Central House  
142 Central Street  
London, United Kingdom  
EC1V 8AR  
T: +44 (0) 20 7251 8555

project title		KOKO + Hope & Anchor + Bayham Place, Camden, London	
drawing title	1:100 A11 13.04.17	scale	date
drawing number	AHA/KCC/GA/100	drawn	checked
		FR/PC	DA
		revision	K

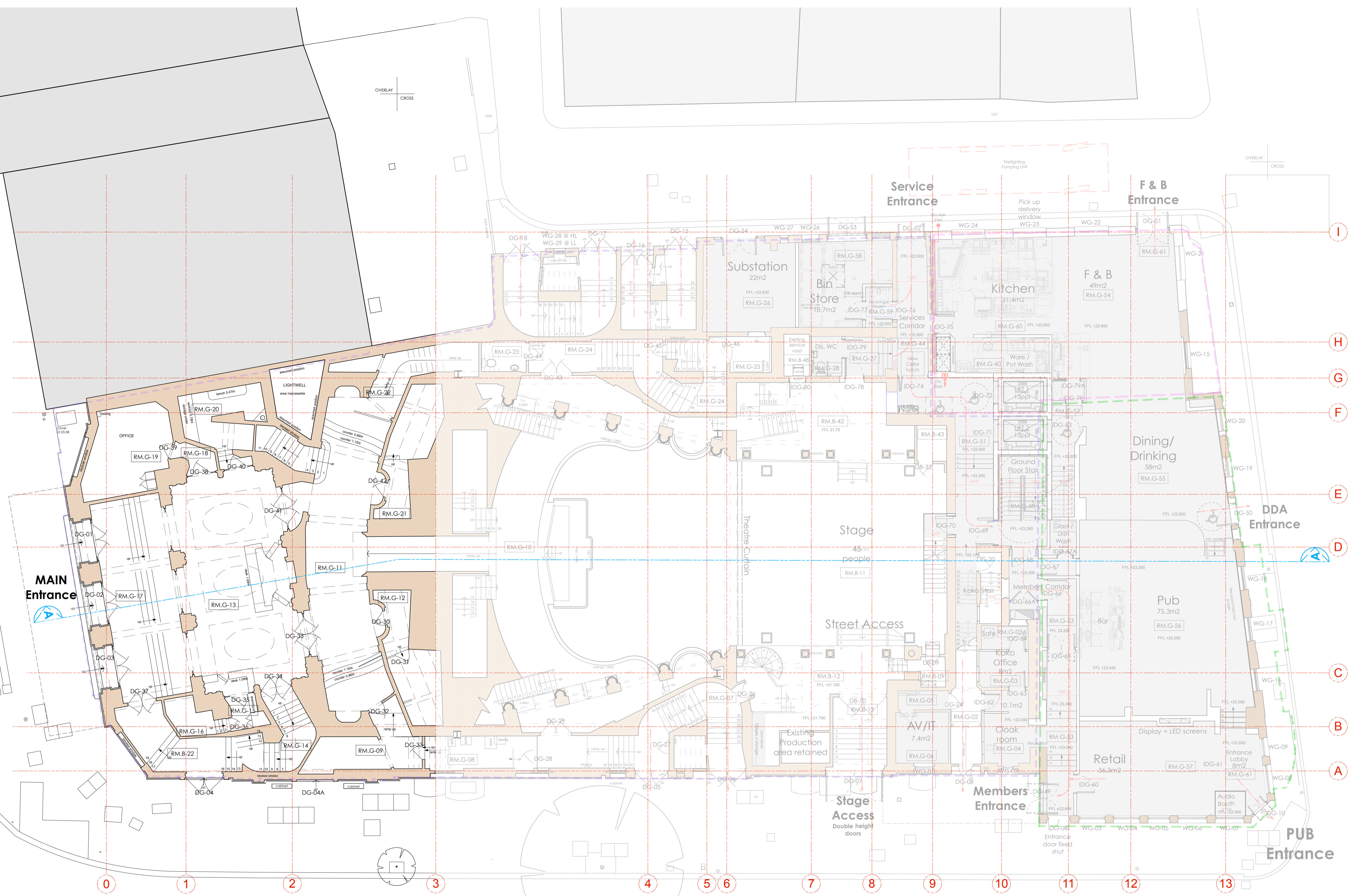

REFER TO RETROSPECTIVE PLANNING APPLICATION REF: 2019/4009/L