

Copyright: All rights reserved. This drawing must not be reproduced without permission.

Only the original drawing should be relied upon. Contractors, subcontractors and suppliers must verify all dimensions on site before commencing any work or making any shop drawings.

All shop drawings to be submitted to the architect for comment prior to fabrication.

This drawing is to be read in conjunction with the Architect's specification, bills of quantities / schedules, structural, mechanical & electrical drawings and all discrepancies are to be reported to the architect.

Do not scale from this drawing. Dimensions are in millimetres unless otherwise stated.

revision / date / amendments

- / 26/01/18 /	- First Issue
A / 02/02/18 /	- Addition of acoustic wall near bar in Jazz bar
B / 01/03/18 /	1. Indicative location of AHU + attenuator over stage. 2. Window numbers updated in line with window schedule.
C / 23/03/18 /	1. Tender Addendum (1). Indication of 4 post truss fixed at stage level for integrated automatic retractable acoustic baffles and integrated lighting rig. 2. Tender Addendum (2). New AHU + Attenuator over stage to be hung to existing relocated secondary beams in Flytower.
D / 12/04/18 /	- Window and door numbers updated
E / 01/06/18 /	1. Indication of 4 post truss fixed at stage level for integrated automatic retractable acoustic baffles and integrated lighting rig. 2. New AHU + Attenuator over stage to be hung to existing relocated secondary beams in Flytower.
F / 05/07/18 /	- Updated stage 4 fit out interior and kitchen layouts.
G / 31/07/18 /	2.2. Alteration to ventilation Strategy to allow higher ceiling heights 2.3. Alteration to ventilation Strategy to allow higher ceiling heights 2.4. Alteration to ventilation Strategy 2.5. New Sash Windows to facade 2.7. Louver added to elevation for ventilation to WC's
H / 15/08/18 /	Colour coding added to revised drawing RevG
I / 29/01/19 /	Retrospective Planning for Dome Propping up works. Ref: 2019/0695/L
J / 29/05/19 /	Proposed Dome LBC Application for 1. Permanent Dome Truss. 2. Dome Front Pier PFCs. 3. Replacement of Dome Copper Roof
K / 30/10/19 /	1. Following review of PFC location, PFCs to be chased into front piers and concealed. PFC size 400 w x 200 D x 10 T.

LEGEND

- Proposed Works
- Existing Building Fabric KOKO née Camden Palace Theatre (1900)
- Existing Building Fabric Hope & Anchor (approx. 1850)
- Existing Building Fabric Bayham Place (from 1875)
- Existing Modern Building Fabric Bayham Place (from 2006)
- Building Fabric to be demolished
- Demolition of Flooring / Elevation / Wall
- Proposed Excavation
- Remove and retain in alternate location
- Retain and protect existing
- Retain, make good, ease and adjusted
- Means of escape Route
- Private Members Route
- Koko Customer Route
- Public Route
- Artist Route
- ▬ Proposed Riser
- ▬ Proposed Risers Above
- RM.4.04 Room Number
- D4.02 Door Number
- W4.05 Window Number
- Hope & Anchor Demise
- Koko Demise
- 1 Bayham Street & 65 Bayham Place Demise
- Blue Roof
- Original brickwork exposed

30.10.19

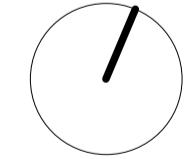

PLANNING

Archer Humphryes Architects

Basement
Central House
142 Central Street
London, United Kingdom
EC1V 8AR
T: +44 (0) 20 7251 8555

project title		KOKO + Hope & Anchor + Bayham Place Camden, London	
drawing title	scale	date	
Proposed Second Floor Plan	1:100 A11	13.04.17	
drawing number	drawn	checked	
AHA/KKG/GA/102	FR/PC	DA	
	revision		
	K		

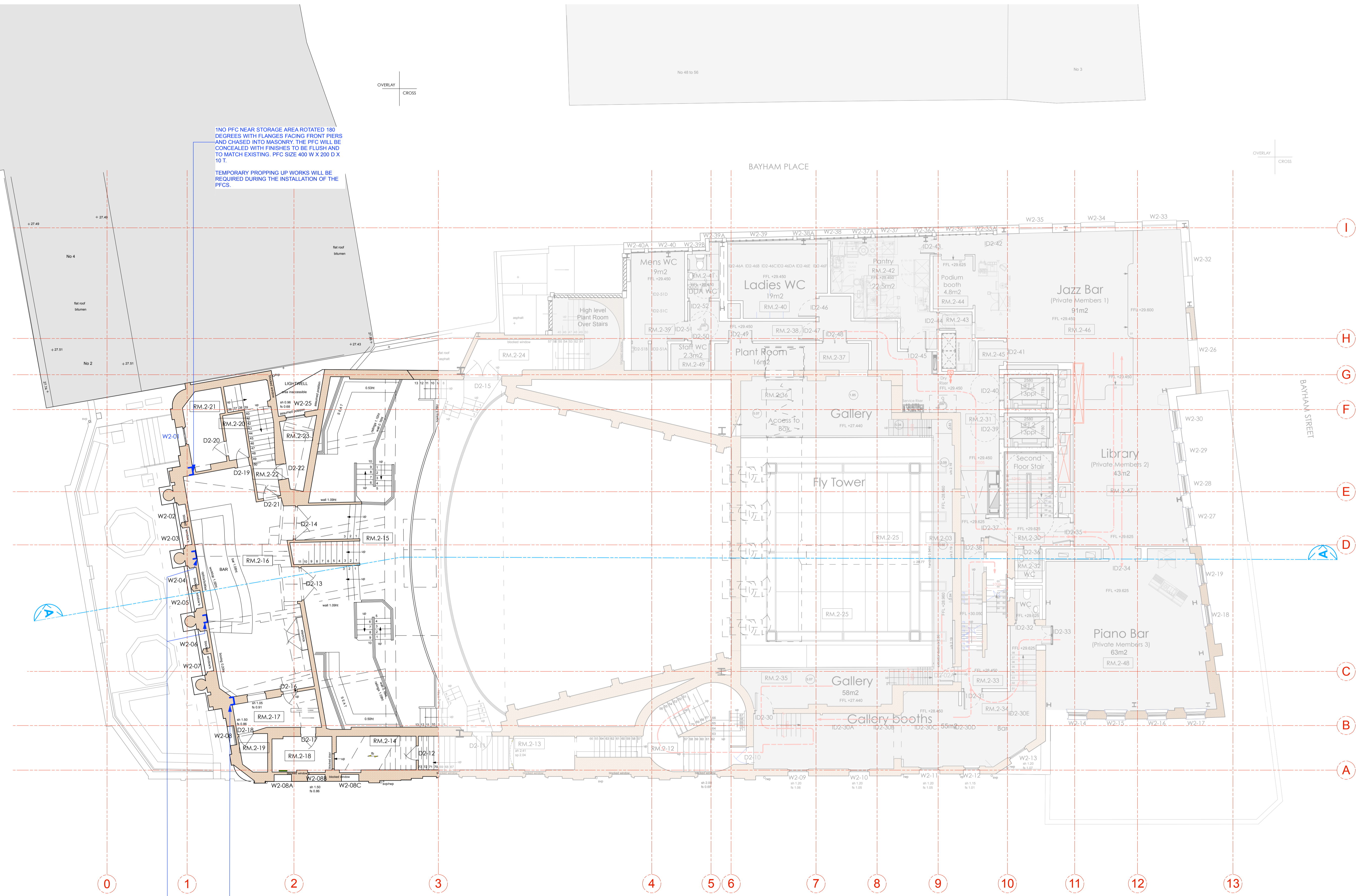

1NO PFC NEAR STORAGE AREA ROTATED 180 DEGREES WITH FLANGES FACING FRONT PIERS AND CHASED INTO MASONRY. THE PFC WILL BE CONCEALED WITH FINISHES TO BE FLUSH AND TO MATCH EXISTING. PFC SIZE 400 W X 200 D X 10 T.
TEMPORARY PROPPING UP WORKS WILL BE REQUIRED DURING THE INSTALLATION OF THE PFCs.

2NO CENTRAL PFCs ROTATED 180 DEGREES WITH FLANGES FACING FRONT PIERS AND CHASED IN VIA TWO X 20MM (APPROX) FULL HEIGHT SLOTS INTO MASONRY. THE PFCs ARE THEN PLACED INTO THE SLOTS ALLOWING FOR A FLUSH WALL FINISH WITH FINISHES TO MATCH EXISTING. PFC SIZE 400 W X 200 D X 10 T.
TEMPORARY PROPPING UP WORKS WILL BE REQUIRED DURING THE INSTALLATION OF THE PFCs.

REFER TO RETROSPECTIVE PLANNING APPLICATION REF: 2019/4009/L