

Virgin Media Way Leave Cover Sheet	Works Order Reference Number: 1146721-1949358_A	
	Type of works: Business Installation	
	Date of Issue:	09/11/2018
	Franchise:	Central Planning Office
	Work ID:	391789
Customer Site Details		
Customer Name:	BRITISH TRANSPORT POLICE	
Site/Building Name:	EB01 - BTP, Metro House	
Address:	EB01 - BTP, Metro House Camden Road Railway Station Camden Road LONDON GB, NW1 9LS	
Primary Contact:	Satish Patel	Contact Number(s): 0207 521 6313 / 0790\n/a
Secondary Contact:		Contact Number(s)
VM Planner:	Jamie Vardon	Contact Number(s): 01314775670
Brief Description of Civils Works(If Required)		
Civil Contractor:	Kelly (Network - London)	
Brief Description of Cables Works(If Required)		
Cable Contractor:	Kelly Comms (London)	
Landlord Details		
Name:		
Company Name:		
Address:		
Primary Contact:		Contact Number(s):
Additional Comments		
WAYLEAVE PACK		
Internal Use ONLY		
Cost Centre Code:	1034-21000-630658 / BBC01144983	
For Internal Use Only		

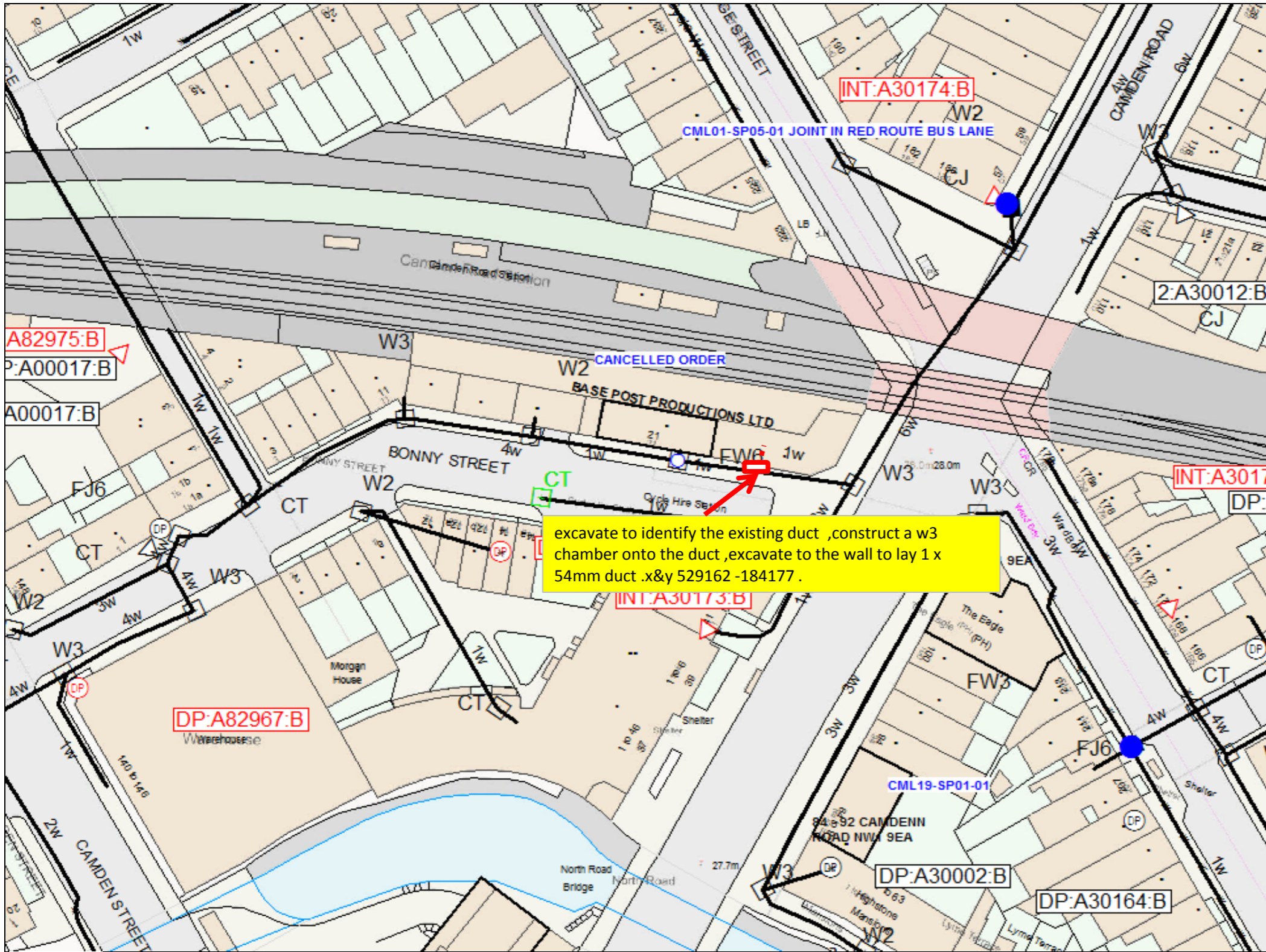

Our Reference:	1146721-1949358
Customer:	BRITISH TRANSPORT POLICE
Works Address:	EB01 - BTP, Metro House Camden Road Railway Station Camden Road LONDON GB, NW1 9LS

excavate to identify the existing duct ,construct a w3 chamber onto the duct ,excavate to the wall to lay 1 x 54mm duct .x&y 529162 -184177 .

Any modifications to the drawing or use of alternative items to those specified must be agreed with Virgin Media's local planning department

Reproduction from the Ordnance Survey map by Virgin Media with permission of Ordnance Survey on behalf of the Controller of Her Majesty's Stationary Office © Crown Copyright Virgin Media (100019209)

Planned	CIVILS	As-Built	Planned	FIBRE	As-Built
1w	Duct Path with number of ways	1w	xxx	Fibre Cable	xxx
□	Chamber with and without Equipment	□	xxx	National Network Fibre Cable	xxx
▽	Overground and Underground Cabinet	▽	○ xxx	Fibre Splice	○ xxx
②	Swept Tee and SID with number of feeds	②	○ xxx	National Network Fibre Splice	○ xxx
NN OO	National Network / Other Operator	NN OO			

Originator	#REF!
Contact Number	#REF!
Issue Date	#REF!
Office	#REF!
Line Manager	#REF!



Virgin Media
280 Bartley Way
Bartley Wood Business Park
Hook
Hampshire
RG27 9UP

Internal Use Only

1

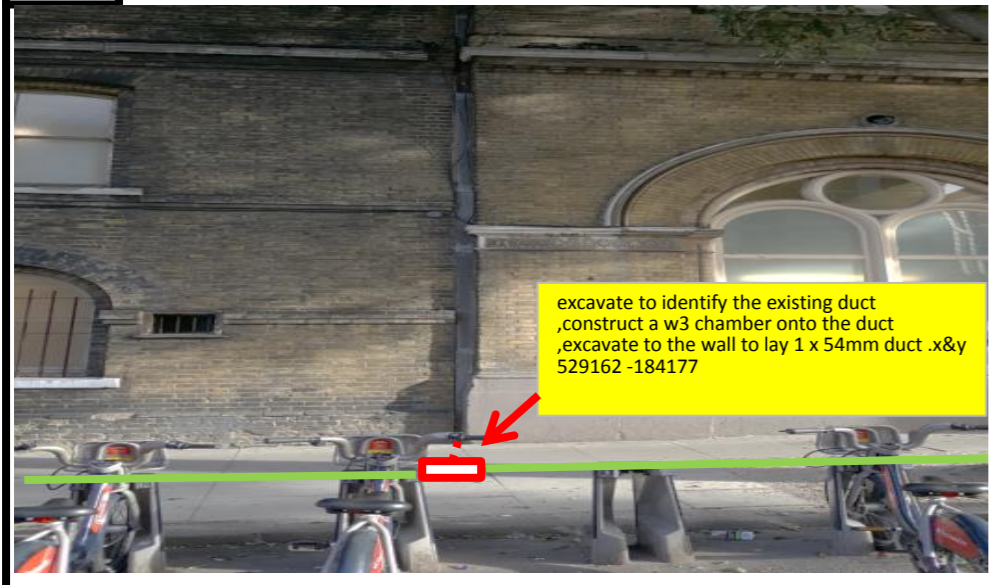

excavate to identify the existing duct
 ,construct a w3 chamber onto the duct
 ,excavate to the wall to lay 1 x 54mm duct .x&y
 529162 -184177

2



excavate to identify the existing duct
 ,construct a w3 chamber onto the duct
 ,excavate to the wall to lay 1 x 54mm

3



4

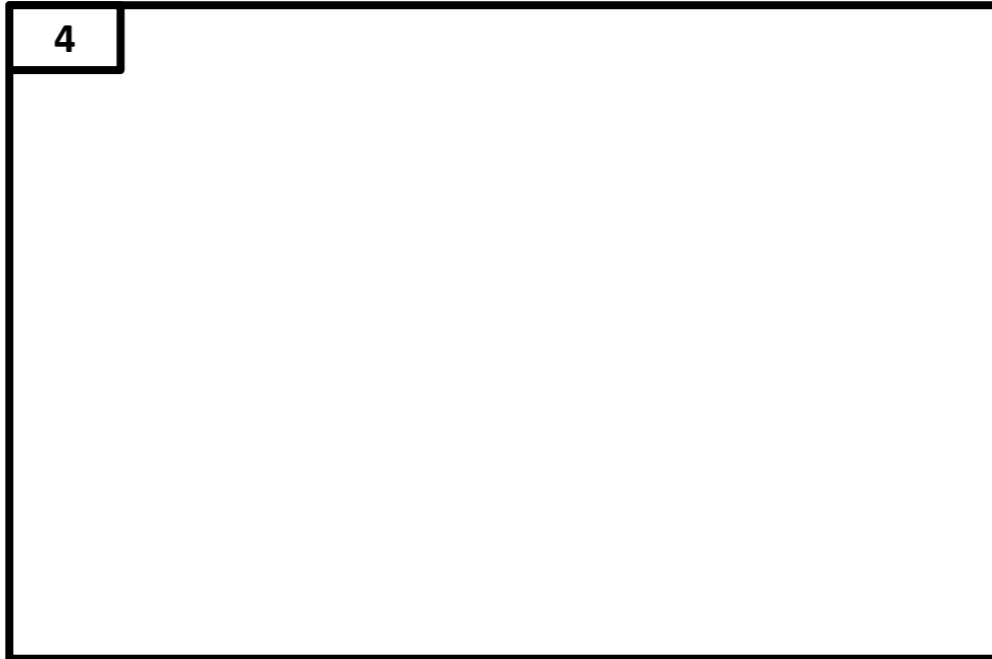

Our Reference:	1146721-1949358
Customer:	BRITISH TRANSPORT POLICE
Works Address:	EB01 - BTP, Metro House Camden Road Railway Station Camden Road LONDON GB. NW1 9LS

Work Point Reference Details	
No.	Description of exactly what activities should be carried out
1	Build new FW3 chamber over existing VM network duct and install new service duct with 90deg upturn at foot of customer building.
2	Build new FW3 chamber over existing VM network duct and install new service duct with 90deg upturn at foot of customer building.

Any modifications to the drawing or use of alternative items to those specified must be agreed with Virgin Media's local planning department

Reproduction from the Ordnance Survey map by Virgin Media with permission of Ordnance Survey on behalf of the Controller of Her Majesty's Stationary Office © Crown Copyright Virgin Media (100019209)

Planned	CIVILS	As-Built	Planned	FIBRE	As-Built
<u>1w</u>	Duct Path	<u>1w</u>	<u>xxx</u>	Fibre Cable	<u>xxx</u>
 	with number of ways	 	 	National Network Fibre Cable	
 	Chamber with and without Equipment	 	 	Fibre Splice	
 	Overground and Underground Cabinet	 	 	National Network Fibre Splice	
 	Swept Tee and SID with number of feeds	 			
 	National Network / Other Operator	 			

Originator	#REF!
Contact Number	#REF!
Issue Date	#REF!
Office	#REF!
Line Manager	#REF!



Virgin Media
 280 Bartley Way
 Bartley Wood Business Park
 Hook
 Hampshire
 RG27 9UP

Internal Use Only

Our Reference:	1146721-1949358
Customer:	BRITISH TRANSPORT POLICE
Works Address:	EB01 - BTP, Metro House Camden Road Railway Station Camden Road LONDON GB, NW1 9LS

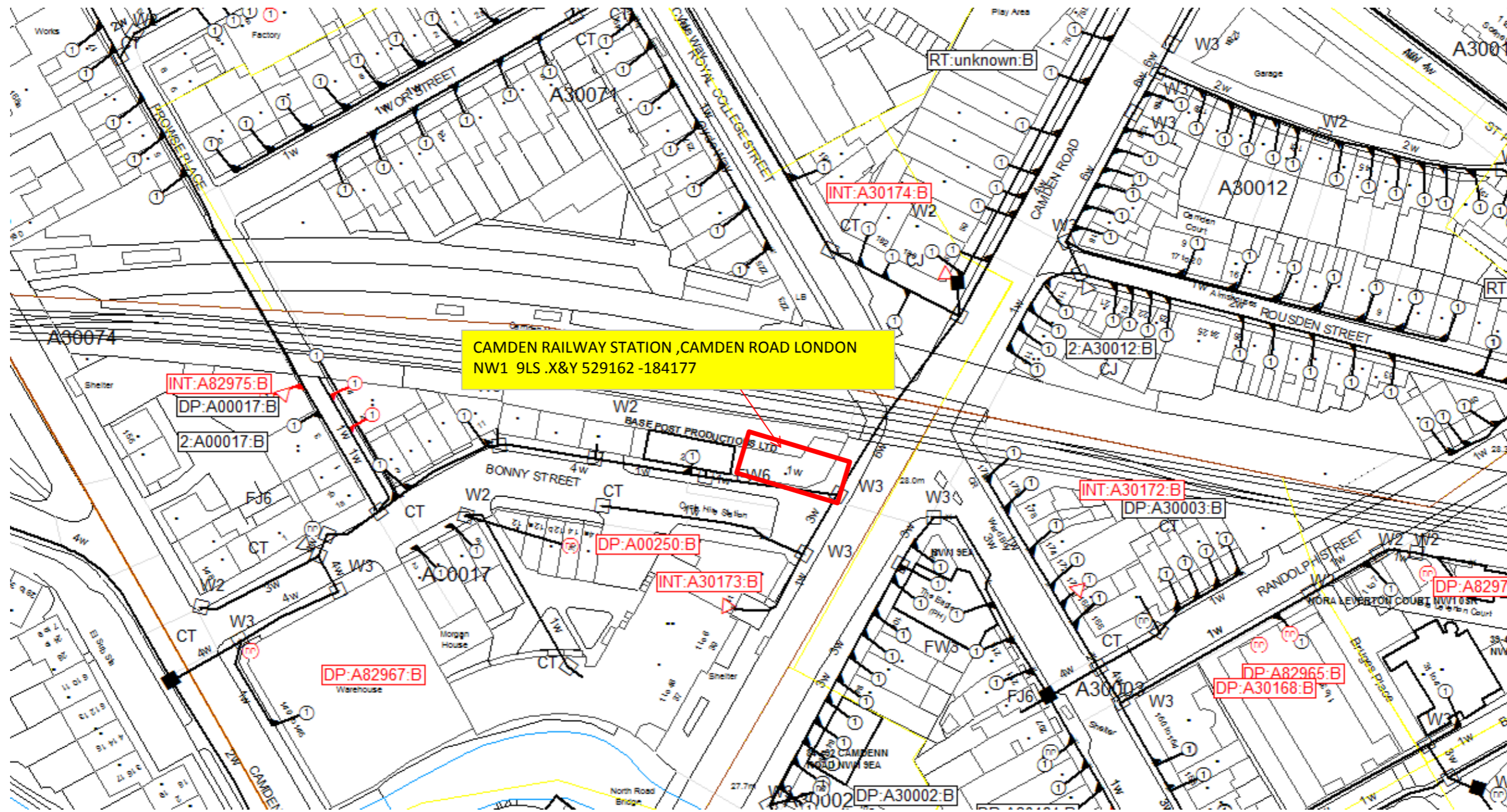

Any modifications to the drawing or use of alternative items to those specified must be agreed with Virgin Media's local planning department

Reproduction from the Ordnance Survey map by Virgin Media with permission of Ordnance Survey on behalf of the Controller of Her Majesty's Stationary Office © Crown Copyright Virgin Media (100019209)

Planned	CIVILS	As-Built	Planned	FIBRE	As-Built
1w	Duct Path with number of ways	1w	xxx	Fibre Cable	xxx
■ □	Chamber with and without Equipment	■ □	xxx	National Network Fibre Cable	xxx
▼ ●	Overground and Underground Cabinet	▼ ●	○ xxx	Fibre Splice	○ xxx
② ②	Swept Tee and SID with number of feeds	② ②	○ xxx	National Network Fibre Splice	○ xxx
NN OO	National Network / Other Operator	NN OO			

Originator	#REF!
Contact Number	#REF!
Issue Date	#REF!
Office	#REF!
Line Manager	#REF!



Virgin Media
280 Bartley Way
Bartley Wood Business Park
Hook
Hampshire
RG27 9UP

Internal Use Only

LDN - Camden Road Overground (BNS)

Type 2 Asbestos Survey Report – Copy 1

April 2009

S-26711 / B220409ME5



British Transport Police



Our Reference:	1146721-1949358
Customer:	BRITISH TRANSPORT POLICE
Works Address:	EB01 - BTP, Metro House Camden Road Railway Station Camden Road LONDON GB, NW1 9LS

Work Point Reference Details

No.	Description of exactly what activities should be carried out

<p>Any modifications to the drawing or use of alternative items to those specified must be agreed with Virgin Media's local planning department</p> <p>Reproduction from the Ordnance Survey map by Virgin Media with permission of Ordnance Survey on behalf of the Controller of Her Majesty's Stationary Office © Crown Copyright Virgin Media (100019209)</p>	<p>Planned 1w with number of ways</p> <p>■ □ Chamber with and without Equipment</p> <p>▼ ● Overground and Underground Cabinet</p> <p>② ② Swept Tee and SID with number of feeds</p> <p>NN OO National Network / Other Operator</p>	<p>CIVILS Duct Path</p> <p>As-Built 1w</p> <p>■ □ Chamber with and without Equipment</p> <p>▼ ● Overground and Underground Cabinet</p> <p>② ② Swept Tee and SID with number of feeds</p> <p>NN OO National Network / Other Operator</p>	<p>Planned xxx</p> <p>--- National Network Fibre Cable</p> <p>○ xxx Fibre Splice</p> <p>○ xxx National Network Fibre Splice</p>	<p>FIBRE Fibre Cable</p> <p>National Network Fibre Cable</p> <p>Fibre Splice</p> <p>National Network Fibre Splice</p>	<p>As-Built xxx</p> <p>--- National Network Fibre Cable</p> <p>○ xxx Fibre Splice</p> <p>○ xxx National Network Fibre Splice</p>	<p>Originator #REF!</p> <p>Contact Number #REF!</p> <p>Issue Date #REF!</p> <p>Office #REF!</p> <p>Line Manager #REF!</p>	 <p>Virgin Media 280 Bartley Way Bartley Wood Business Park Hook Hampshire RG27 9UP</p>
						Internal Use Only	

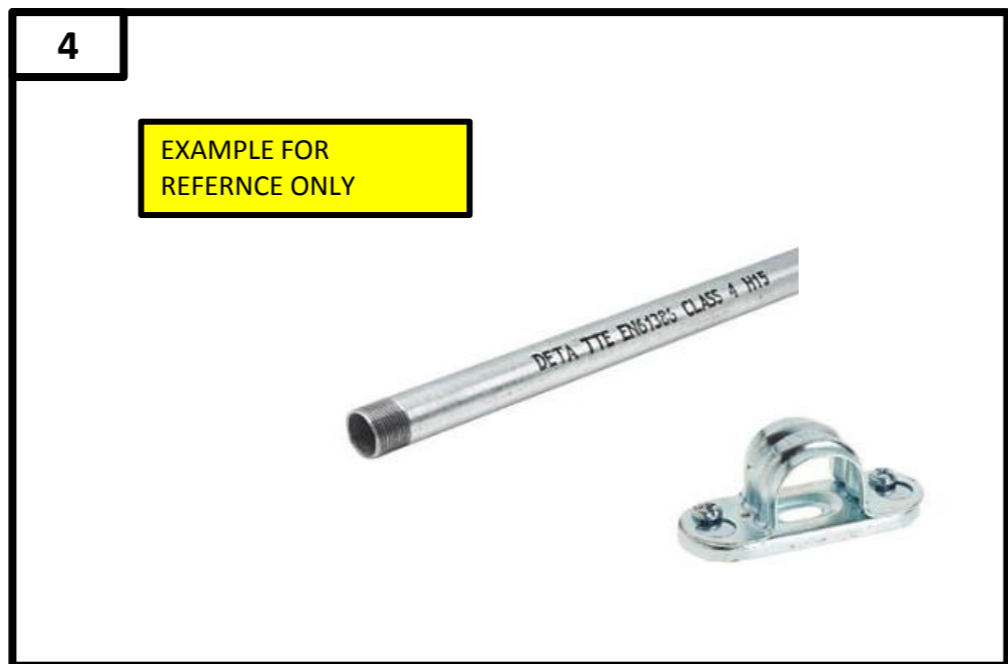
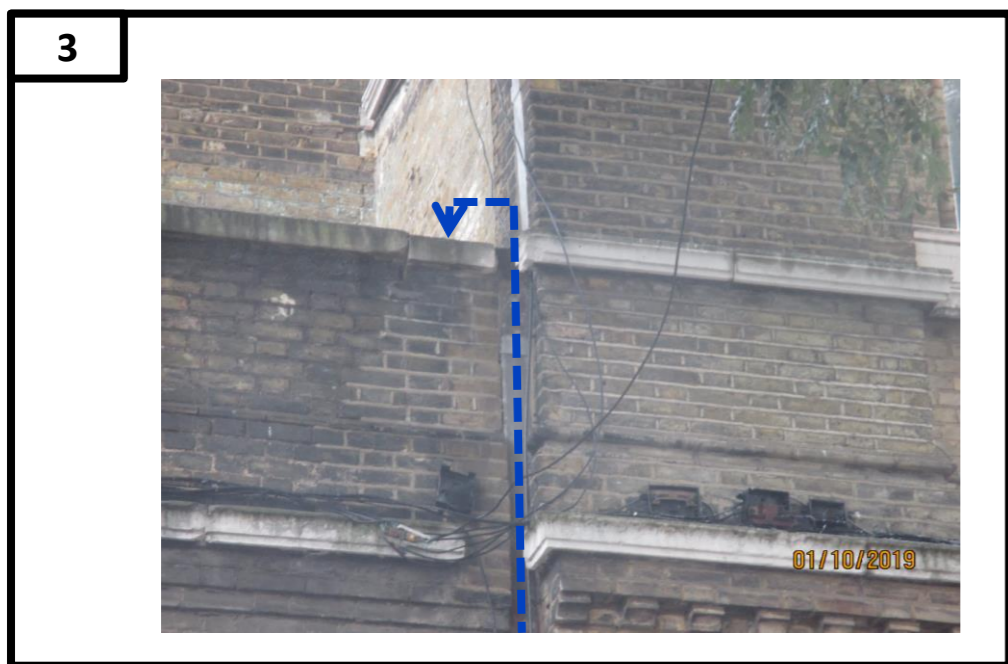
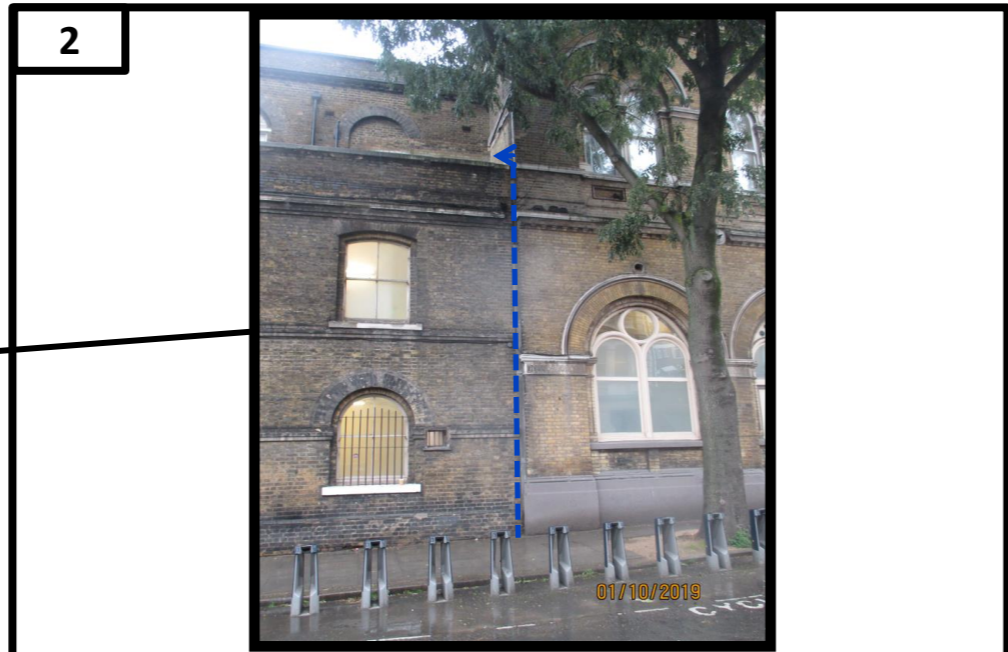

Our Reference:	1146721-1949358
Customer:	BRITISH TRANSPORT POLICE
Works Address:	EB01 - BTP, Metro House Camden Road Railway Station Camden Road LONDON GB. NW1 9LS

Work Point Reference Details

No.	Description of exactly what activities should be carried out
WP 1&2	CAMDEN ROAD STATION Virginmedia cable is to be run in 20mm galvanised tubing (photo 4) to provide protection and security as requested by British Transport Police. 20mm galvanised tubing to be fixed to the external wall of station. The 20mm galvanised tubing is to follow existing cables from ground to balcony.
WP 3	BALCONY CAMDEN ROAD STATION 20mm galvanised tubing to follow existing cable over wall and onto balcony where a hole is to be drilled adjacent to existing cable entry into the BTP offices see WP 7 from BTP offices.
20mm Galvanised tubing to be used with the option of painting it matt black. Camden conservation re-presentative Catherine Bond to advise.	

Any modifications to the drawing or use of alternative items to those specified must be agreed with Virgin Media's local planning department

Reproduction from the Ordnance Survey map by Virgin Media with permission of Ordnance Survey on behalf of the Controller of Her Majesty's Stationary Office © Crown Copyright Virgin Media (100019209)

Planned	CIVILS Duct Path with number of ways	As-Built	Planned	FIBRE Fibre Cable	As-Built
1w	with number of ways	1w	xxx	National Network Fibre Cable	xxx
■ □	Chamber with and without Equipment	■ □	xxx	Fibre Splice	xxx
▼ ●	Overground and Underground Cabinet	▼ ●	xxx	National Network Fibre Splice	xxx
② ②	Swept Tee and SID with number of feeds	② ②			
NN OO	National Network / Other Operator	NN OO			

Originator	#REF!
Contact Number	#REF!
Issue Date	#REF!
Office	#REF!
Line Manager	#REF!



Virgin Media
280 Bartley Way
Bartley Wood Business Park
Hook
Hampshire
RG27 9UP

Internal Use Only

Our Reference:	1146721-1949358
Customer:	BRITISH TRANSPORT POLICE
Works Address:	EB01 - BTP, Metro House Camden Road Railway Station Camden Road LONDON GB, NW1 9LS

Work Point Reference Details

No.	Description of exactly what activities should be carried out
WP 5&6	VIEW OF BALCONY FROM STATION
WP 7&8	BTP CHANGING ROOM Cable to enter adjacent to existing cable and follow route above ceiling

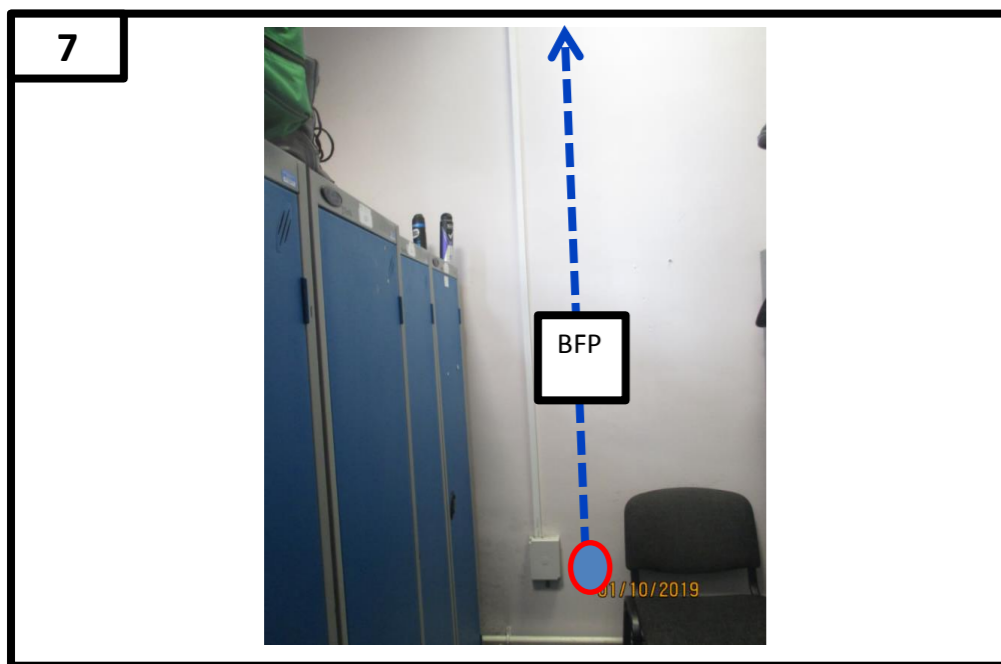
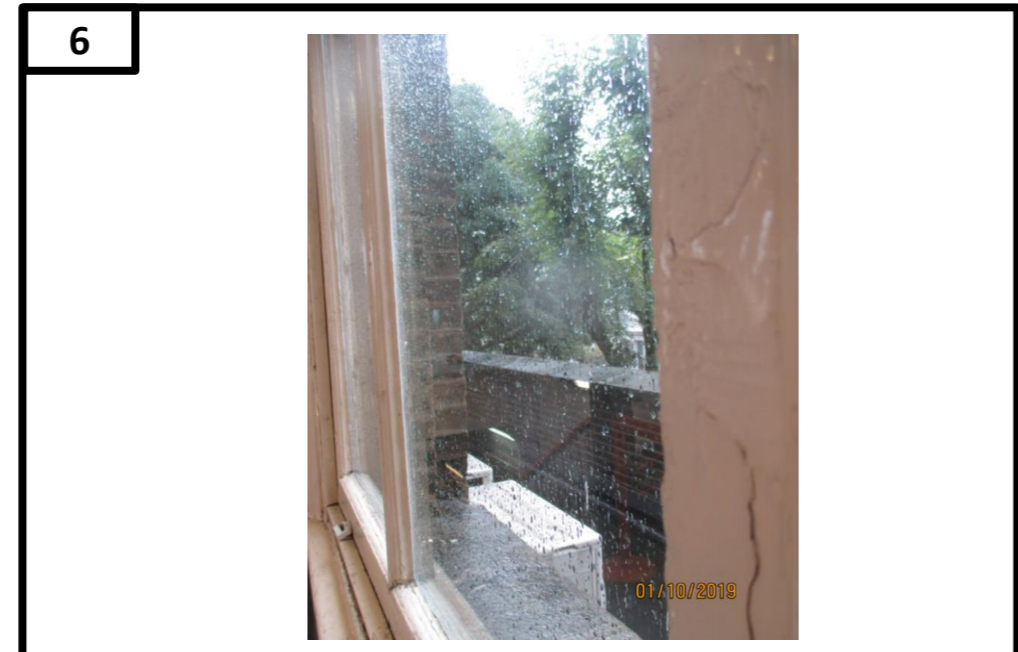

Any modifications to the drawing or use of alternative items to those specified must be agreed with Virgin Media's local planning department

Reproduction from the Ordnance Survey map by Virgin Media with permission of Ordnance Survey on behalf of the Controller of Her Majesty's Stationary Office © Crown Copyright Virgin Media (100019209)

Planned	CIVILS	As-Built	Planned	FIBRE	As-Built
1w	Duct Path	1w	xxx	Fibre Cable	xxx
with number of ways	with number of ways	with number of ways	with number of ways	with number of ways	with number of ways
■ □	Chamber with and without Equipment	■ □	■ □	National Network Fibre Cable	■ □
▽ ●	Overground and Underground Cabinet	▽ ●	○ ○	Fibre Splice	○ ○
② ②	Swept Tee and SID with number of feeds	② ②	○ ○	National Network Fibre Splice	○ ○
NN OO	National Network / Other Operator	NN OO	NN OO		

Originator	#REF!
Contact Number	#REF!
Issue Date	#REF!
Office	#REF!
Line Manager	#REF!



Virgin Media
280 Bartley Way
Bartley Wood Business Park
Hook
Hampshire
RG27 9UP

Internal Use Only

Our Reference:	1146721-1949358
Customer:	BRITISH TRANSPORT POLICE
Works Address:	EB01 - BTP, Metro House Camden Road Railway Station Camden Road LONDON GB. NW1 9LS

Work Point Reference Details

No.	Description of exactly what activities should be carried out
WP 9-12	BTP OFFICES Cable route above false ceiling to comms cabinet. Refer to Floor plan.

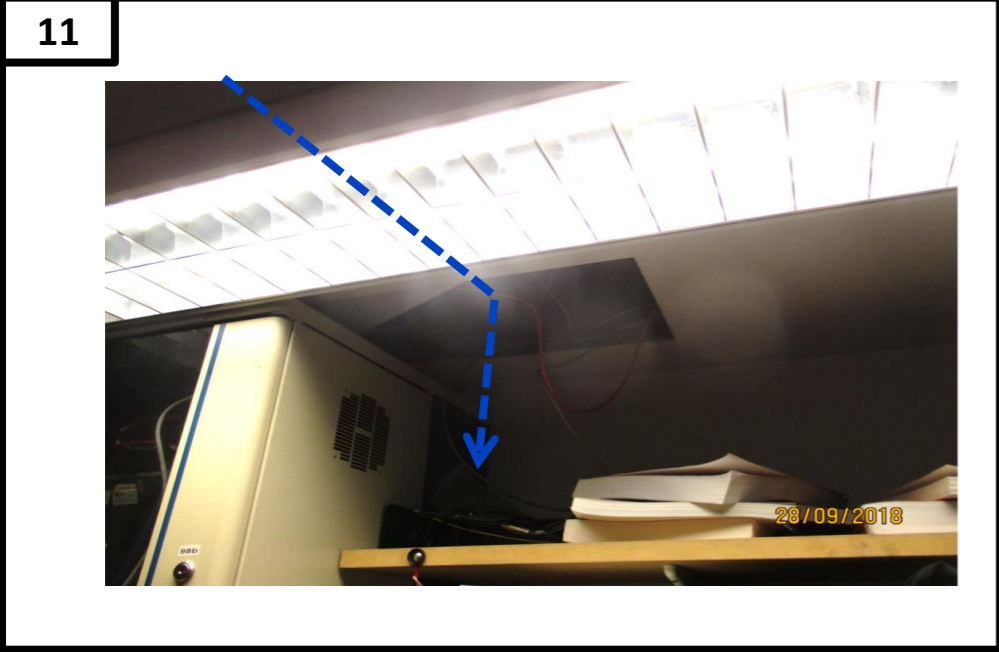
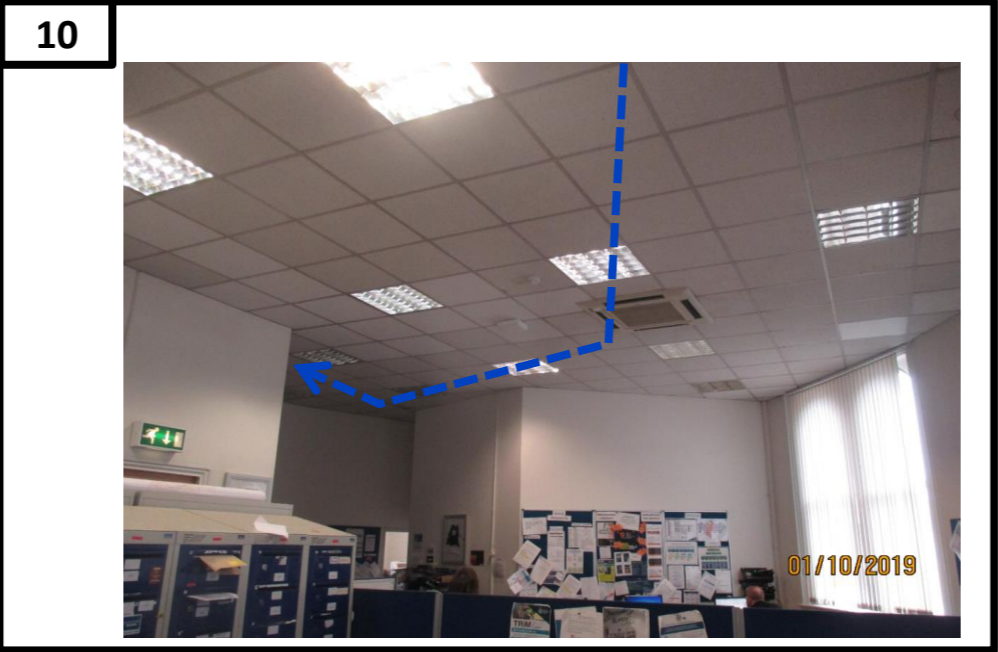

Any modifications to the drawing or use of alternative items to those specified must be agreed with Virgin Media's local planning department

Reproduction from the Ordnance Survey map by Virgin Media with permission of Ordnance Survey on behalf of the Controller of Her Majesty's Stationary Office © Crown Copyright Virgin Media (100019209)

Planned	CIVILS	As-Built	Planned	FIBRE	As-Built
1w	Duct Path with number of ways	1w	xxx	Fibre Cable	xxx
	Chamber with and without Equipment			National Network Fibre Cable	
	Overground and Underground Cabinet			Fibre Splice	
	Swept Tee and SID with number of feeds			National Network Fibre Splice	
	National Network / Other Operator				

Originator	#REF!
Contact Number	#REF!
Issue Date	#REF!
Office	#REF!
Line Manager	#REF!



Virgin Media
 280 Bartley Way
 Bartley Wood Business Park
 Hook
 Hampshire
 RG27 9UP

Internal Use Only

Our Reference:	1146721-1949358
Customer:	BRITISH TRANSPORT POLICE
Works Address:	EB01 - BTP, Metro House Camden Road Railway Station Camden Road LONDON GB, NW1 9LS

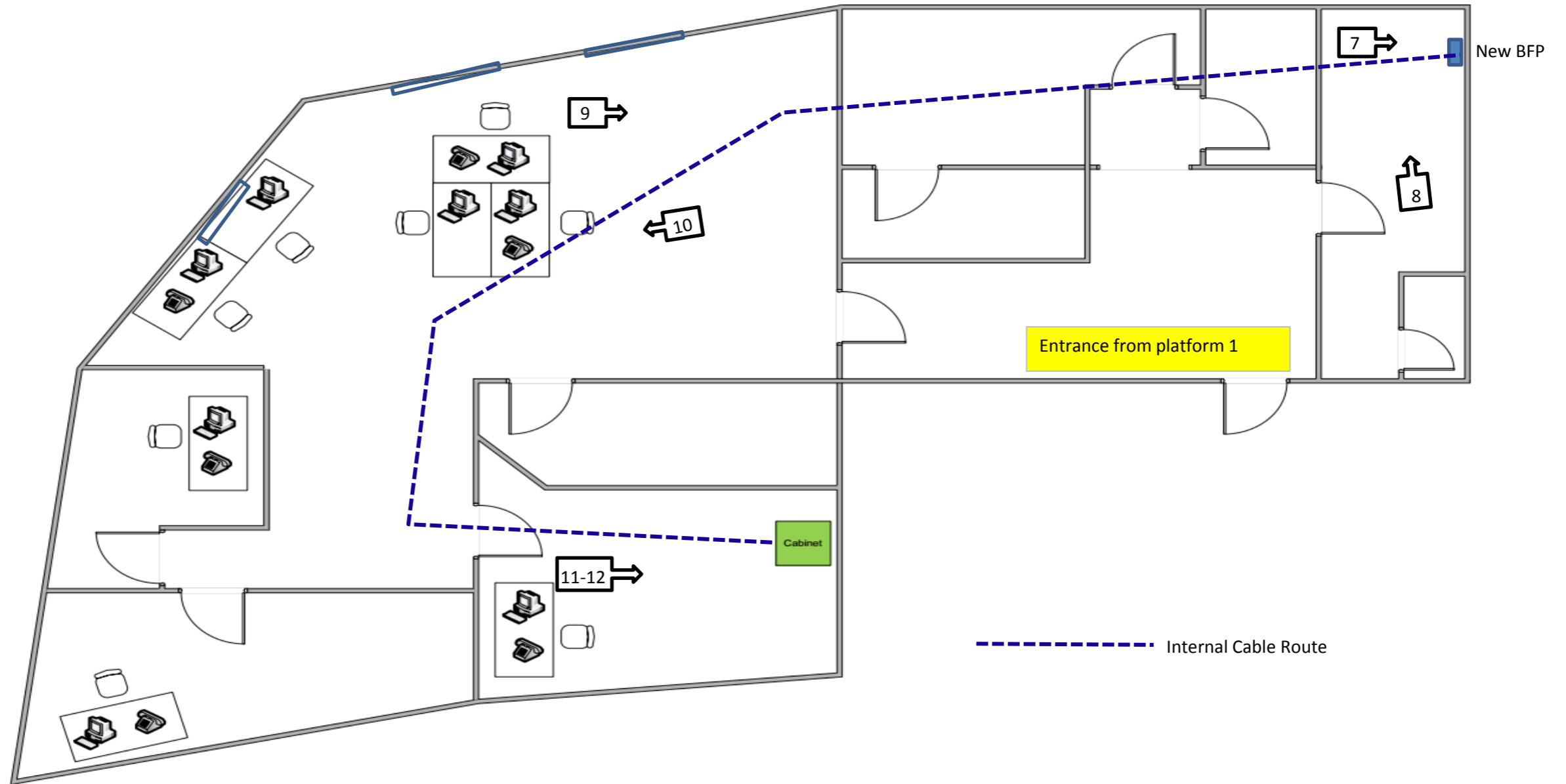

Any modifications to the drawing or use of alternative items to those specified must be agreed with Virgin Media's local planning department

Reproduction from the Ordnance Survey map by Virgin Media with permission of Ordnance Survey on behalf of the Controller of Her Majesty's Stationary Office © Crown Copyright Virgin Media (100019209)

Planned	CIVILS	As-Built	Planned	FIBRE	As-Built
1w	Duct Path with number of ways	1w	xxx	Fibre Cable	xxx
■ □	Chamber with and without Equipment	■ □	xxx	National Network Fibre Cable	xxx
▼ ●	Overground and Underground Cabinet	▼ ●	○ xxx	Fibre Splice	○ xxx
② ②	Swept Tee and SID with number of feeds	② ②	○ xxx	National Network Fibre Splice	○ xxx
NN OO	National Network / Other Operator	NN OO			

Originator	#REF!
Contact Number	#REF!
Issue Date	#REF!
Office	#REF!
Line Manager	#REF!



Virgin Media
280 Bartley Way
Bartley Wood Business Park
Hook
Hampshire
RG27 9UP

Internal Use Only