

General Notes

This drawing to be read in conjunction with all standard details and specifications. All dimensions to be verified on site. All works to comply with current building regulations.

NOTES

1. FOR STANDARD NOTES AND LEGEND REFER TO DRAWING NUMBER 4933-B1-52-P-104

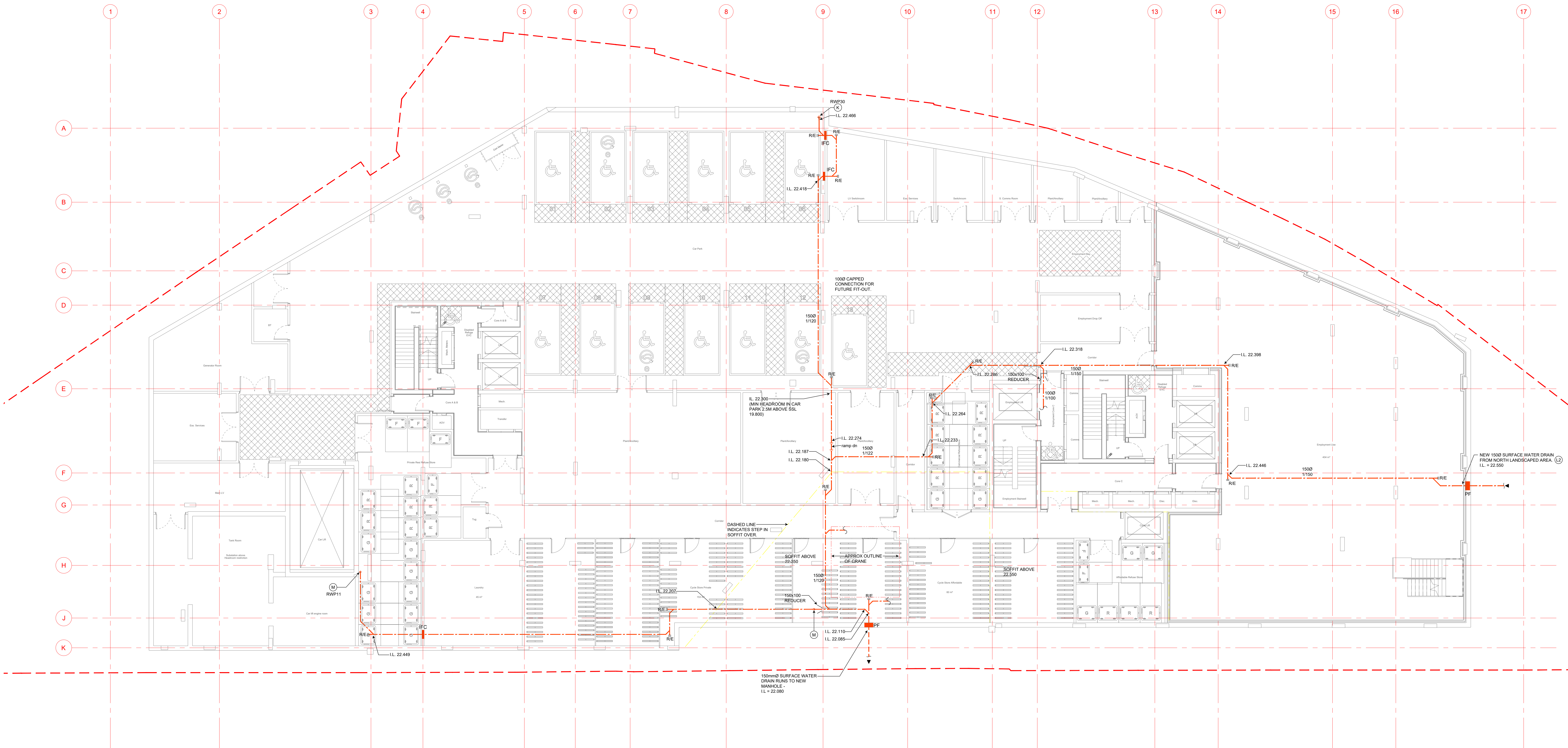

LEGEND

- Legend items: RWP FA & TB, RWP TB, SVP FA & TB CW ACCESS DOOR AT LL, VP RTA, STUB STACK CW ACCESS ON TOP DTB, SVP DTB CW ACCESS DOOR AT LL, SVP DFA TO HL & SETS OVER, WWP DFA & TB CW ACCESS DOOR AT LL, WWP DTB CW ACCESS DOOR AT LL, SVP DFA & CONNECTS TO HEADER @ HL, RWP DFA TO HL & SETS OVER, WWP DFA TO HL & SETS OVER, WWP DFA & CONNECTS TO HEADER @ HL, WWP DFA & CONNECTS TO HEADER @ HL, STUB STACK CAPPED OFF @ LL FOR EMPLOYMENT / COMMERCIAL USE DTB, WWP DFA & CONNECTS TO HEADER @ HL, FLOOR GULLY, BALCONY / ROOF RAINWATER OUTLET, RWP DISCHARGES ONTO ATTENUATED ROOF LANDSCAPED AREA, SVP F.A. & T.B. SECONDARY RELIEF VENT F.B. & T.A., W/P / S/P DFA TO HL & SETS OVER, VP RFB TO HL & SETS OVER, VP RFB TO DISCHARGE TO ATMOSPHERE CW BALCONY GUARD AND WEATHERING SLATE, SVP / WWP DFA TO HL AND SET OVER SECONDARY RELIEF VP HL & T.A., SVP / WWP DTB CW ACCESS DOOR AT LL SECONDARY RELIEF VP F.B. & T.A., SVP / WWP DTB & VP RTA CW ACCESS DOOR AT LL SECONDARY RELIEF VP RFB TO CONNECT TO SVP / WWP AT HL, SVP / WWP DTB & VP RTA CW ACCESS DOOR AT LL SECONDARY RELIEF VP RFB TO CONNECT TO SVP / WWP AT HL, SVP / WWP DTB & VP RTA / RISE TO HL AND OFFSET CW ACCESS DOOR AT LL, RWP DFA TO DISCHARGE ON TO LOWER ROOF, SVP / WWP DTB & VP RISE TO HL & OFFSET CW ACCESS DOOR AT LL, SECONDARY RELIEF VP RFB TO CONNECT TO SVP / WWP AT HL, W/P DFA TO HL & SETS OVER, VP RFB & T.A., VP RFB TO HL AND SETS OVER, WWP DTB & VP RISE TO HL AND OFFSET / RTA CW ACCESS DOOR AT LL, VP CAPPED AT HL FOR COMMUNITY SPACE, SVP DFA & CONNECTS TO HEADER @ HL, STUB STACK CW ACCESS ON TOP DTB CW VP RISE TO HL, W/P DFA & CONNECTS TO HEADER @ HL, W/P FROM FLOOR GULLY ABOVE CONNECT TO P TRAP AT HL & OFFSET, LIFT PIT DRAIN FOR FIRE FIGHTING LIFT, SECONDARY RELIEF VP RISE FROM LL T.A., PUMPED MAIN CAPPED AT HL FOR EXTENDING TO CONNECT TO PUMPED MAIN FROM SUMP AND PUMP UNIT DISCHARGE POINT, SUMP PUMP VENT PIPE CAPPED AT HL FOR EXTENDING TO CONNECT TO VENT PIPE FROM SUMP AND PUMP UNIT EXIT POINT, HALF ROUND GUTTER C/W RAINWATER DOWNPIPE DROP TO DISCHARGE ON TO LOWER ROOF C/W 600SQ PAVING SLAB TO PROTECT LOWER ROOF, RAINWATER OUTLET FROM UNDERSIDE OF LANDSCAPE PLANTER, RAINWATER PIPE FROM ROOF GUTTER OFFSET WITHIN ROOF CONSTRUCTION TO DROP WITHIN WALL CONSTRUCTION TO DISCHARGE ONTO LOWER ROOF LEVEL, SVP AT HL DROP TO LA TO CONNECT TO SUMP AND PUMP UNIT CW ACCESS DOOR AND ISOLATION VALVE AT LL, VP FROM SUMP AND PUMP UNIT RISE TO HL AND OFFSET, SVP / WWP DTB CW ACCESS DOOR AT LL SECONDARY RELIEF VP DOWN TO SVP / WWP AT MID LEVEL AND RISE TO HL, 50mm DIA BALCONY OVER FLOW DROP TB UNIVERSAL SOIL MANIFOLD (ELEPHANT'S FOOT) TO BE PROVIDED AND INSTALLED WITHIN 200mm THICK SCREED TO ACT AS BALCONY OVERFLOW

Rev Description

CONSTRUCTION ISSUE



www.cuddbentley.co.uk  
Ardmore  
101 Camley Street  
Camden  
London N1C 4JH  
020 7714 2020  
020 7714 2021  
020 7714 2022

ARDMORE

Project/Site Location

101 CAMLEY STREET  
CAMDEN

BASEMENT  
ABOVE SLAB PLANTER  
AND LANDSCAPE DRAINAGE

Table with columns: Date, Scale, Drawn, Checked, Revised, Date. Values: 1:100@a0, PH, RG, PH, Feb'17