

**NOTE:** PROTECTIVE FENCING SHOULD BE ERECTED AS PER THE TREE PROTECTION PLAN AT THE LINEAR DISTANCES SPECIFIED IN THE TREE SURVEY SCHEDULE PRIOR TO THE COMMENCEMENT OF ANY WORKS ON SITE

THE DEFAULT SPECIFICATION SHOULD CONSIST OF A VERTICAL AND HORIZONTAL SCAFFOLD FRAMEWORK, WELL BRACED TO RESIST IMPACTS, AS ILLUSTRATED IN FIGURE 2 ON THE TREE SURVEY REPORT

**NOTE:** INCURSION INTO THE RPA OF THE RETAINED TREE T1 IS ANTICIPATED. CONSEQUENTLY, ADDITIONAL GROUND PROTECTION MEASURES WILL BE REQUIRED

SUITABLE EXISTING HARD SURFACING THAT IS NOT PROPOSED FOR RE-USE AS PART OF THE FINISHED DESIGN SHOULD BE RETAINED TO ACT AS TEMPORARY GROUND PROTECTION DURING THE CONSTRUCTION AND, DEVELOPMENT RATHER THAN BEING REMOVED.

BRITISH STANDARDS 5837:2012 ADVISES THAT NEW TEMPORARY GROUND PROTECTION SHOULD BE CAPABLE OF SUPPORTING ANY TRAFFIC ENTERING OR USING THE SITE WITHOUT BEING DISTORTED OR CAUSING COMPACTION TO UNDERLYING SOIL AND FURTHER PROVIDES THE FOLLOWING NOTE:

FOR PEDESTRIAN MOVEMENTS ONLY, A SINGLE THICKNESS OF SCAFFOLD BOARDS PLACED EITHER ON TOP OF A DRIVEN SCAFFOLD FRAME, SO AS TO FORM A SUSPENDED WALKWAY, OR ON TOP OF A COMPRESSION RESISTANT LAYER (E.G. 100 MM DEPTH OF WOODCHIP), LAID ONTO A GEOTEXTILE MEMBRANE;

THE ERECTION OF PROTECTIVE FENCING AND/OR USE OF GROUND PROTECTION, PRIOR TO THE COMMENCEMENT OF ANY WORKS ON SITE, WILL ALLOW EXCAVATIONS AND GROUND WORKS TO TAKE PLACE WITHOUT ANY ADVERSE EFFECT AND/OR IMPACT ON THE RETAINED TREES.

TREE PROTECTION PLAN - THE TPP SHOULD BE READ IN CONJUNCTION WITH THE TREE SURVEY SCHEDULE IN ORDER TO ESTABLISH THE LINEAR RADIAL DISTANCES FOR THE ERECTION OF THE PROTECTIVE FENCING AND THE EXTENT OF GROUND PROTECTION MEASURES FROM THE RETAINED TREES.

PROTECTIVE FENCING SHOULD BE ERECTED AS PER THE TREE PROTECTION PLAN AT THE LINEAR DISTANCES SPECIFIED IN THE TREE SURVEY SCHEDULE PRIOR TO THE COMMENCEMENT OF ANY WORKS ON SITE

THE DEFAULT SPECIFICATION SHOULD CONSIST OF A VERTICAL AND HORIZONTAL SCAFFOLD FRAMEWORK, WELL BRACED TO RESIST IMPACTS, AS ILLUSTRATED IN FIGURE 2 ON THE TREE SURVEY REPORT

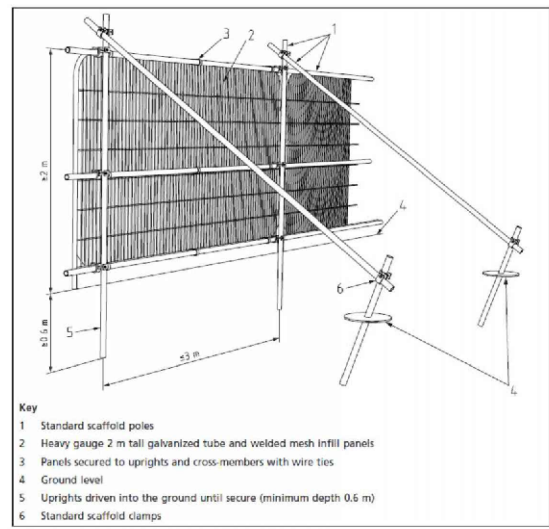

Key  
 1 Standard scaffold poles  
 2 Heavy gauge 2 m tall galvanized tube and welded mesh infill panels  
 3 Panels secured to uprights and cross-members with wire ties  
 4 Ground level  
 5 Uprights driven into the ground until secure (minimum depth 0.5 m)  
 6 Standard scaffold clamps

Default specification for protective barrier © British Standards Institute

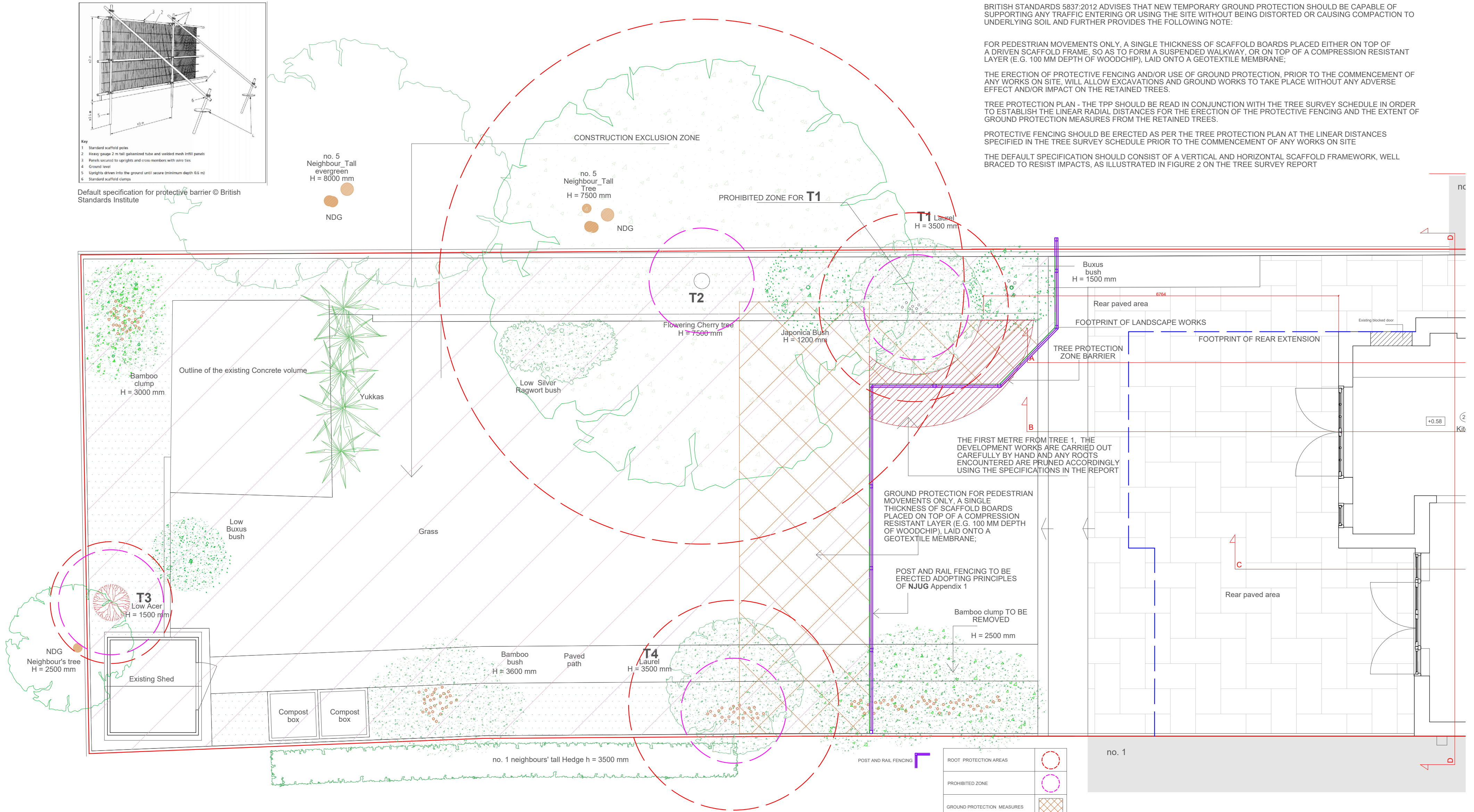

ROOT PROTECTION AREAS	
PROHIBITED ZONE	
GROUND PROTECTION MEASURES	
DIG AREAS CARRIED OUT BY HAND	
CONSTRUCTION EXCLUSION ZONE	

GEORGIA CASSELL ARCHITECT LONDON, ENGLAND TEL: 0204 411 2126 www.georgiacasell.com	scale: 1:50 @A2 date: 21.10.19	PROJECT ADDRESS: 3 Makepeace Avenue Highgate London, N6, GEL TREE PROTECTION PLAN Client: Carole and Dr. Richard Thomas Project No.: 018	DWG NO: 018/18 REV
---	-----------------------------------	---	-----------------------

TREE PROTECTION PLAN