

**PROPOSED ENTRANCE FLOOR PLAN D**

Existing Shower Room retained. New stairs beside party wall.  
Large open plan living room with kitchen at the back.

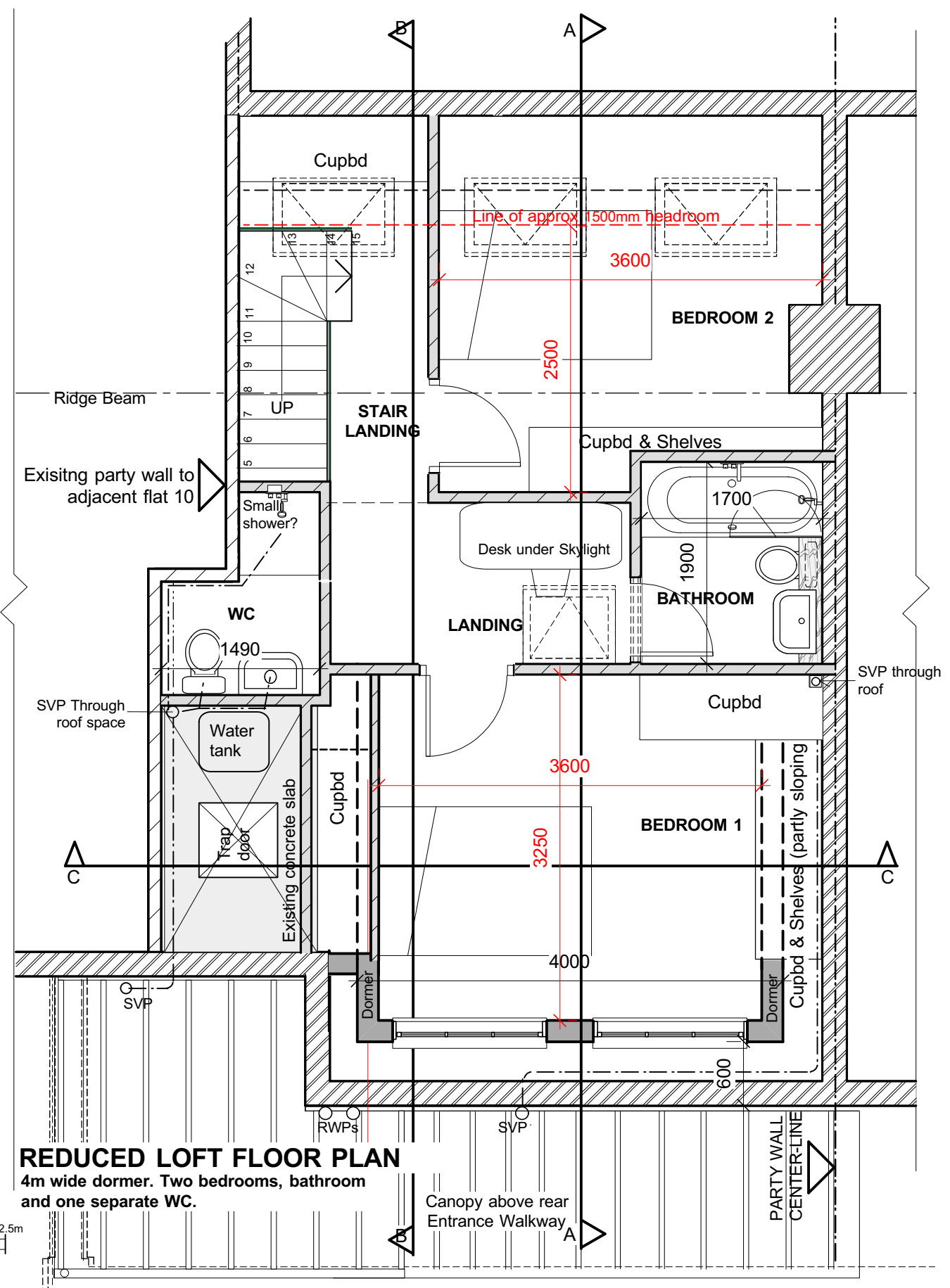
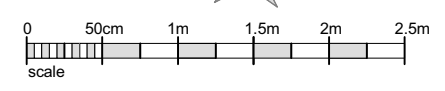

**REDUCED LOFT FLOOR PLAN**

4m wide dormer. Two bedrooms, bathroom and one separate WC.

Client  
**TOM McGEACHY**  
Project Flat 9, HILLFIELD MANSIONS,  
NW3 4QG



PATRICK MINNS ASSOCIATES  
6 St Mark's Crescent  
London NW1 7TS  
patrick@patrickminns.com  
Tel 07957 555 488

Drawing  
**PROPOSED FLOOR PLANS**

Revision

Scale  
**1:50@A3**  
Date  
**JUNE 2019**

Job No.  
**488**  
Drawing No.  
**08P2**  
Drawn By  
**PM**

- All Dimensions and Levels to be checked on Site
- This drawing must not be scaled
- Refer to drawings & specification prepared by the Structural engineer and specialist subcontractors
- Copyright reserved