

TOTAL COVERS : 06no.

EXTERNAL FURNITURE:

**EXTERIOR CHAIRS - 06no. total**  
 Pret Polypropylene Chairs  
 530d 570w 840h  
 from AEL solutions

**04no.** CC4226 Purple Red  
**02no.** CC4228 Black Grey  
**00no.** CC4227 Stone Grey

**TILTING HPL TABLES - 03no.**  
 600sq. 736h  
 pret MHPL6SGY laminated table top  
 on alu tilting base RAL 7015 slate  
 grey from AEL solutions

all external tables, chairs & canvas barriers to be moved inside the shop when the shop is closed.

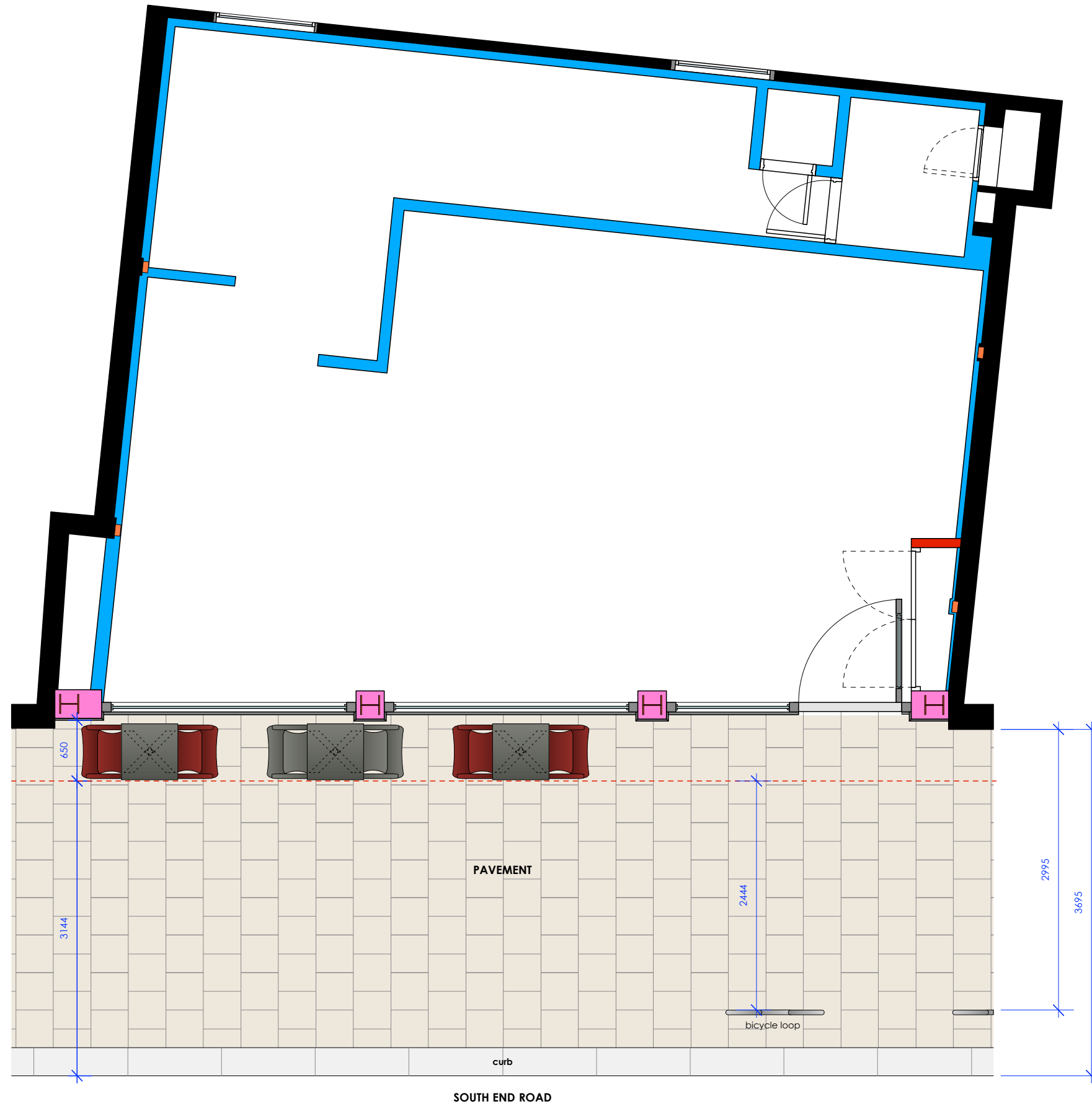

REVISIONS

- A: title block revised
- B: 1no. table and 2no. chairs removed. 6no. covers in total



LOCATION  
**HAMPSTEAD HEATH**  
 37 - 39 South End Road London NW3 2PY

TITLE  
**proposed external seating plan  
 planning**

DRAWING No.  
**TD19/PM103/PL01.3**

REVISION	DATE	SCALE @ A3
B	25.09.19	1:50

All dimensions to be confirmed on site by Contractor.  
 Structural works to be confirmed by Structural Engineer.  
 All elements to comply with statutory requirements.

Copyright Tanner Design Limited  
 2b/4b Gosport Street Lymington Hampshire S041 9BE  
 tel. 01590 689609 email. studio@tannerdesign.co.uk  
 www.tannerdesign.co.uk

TANNER

