

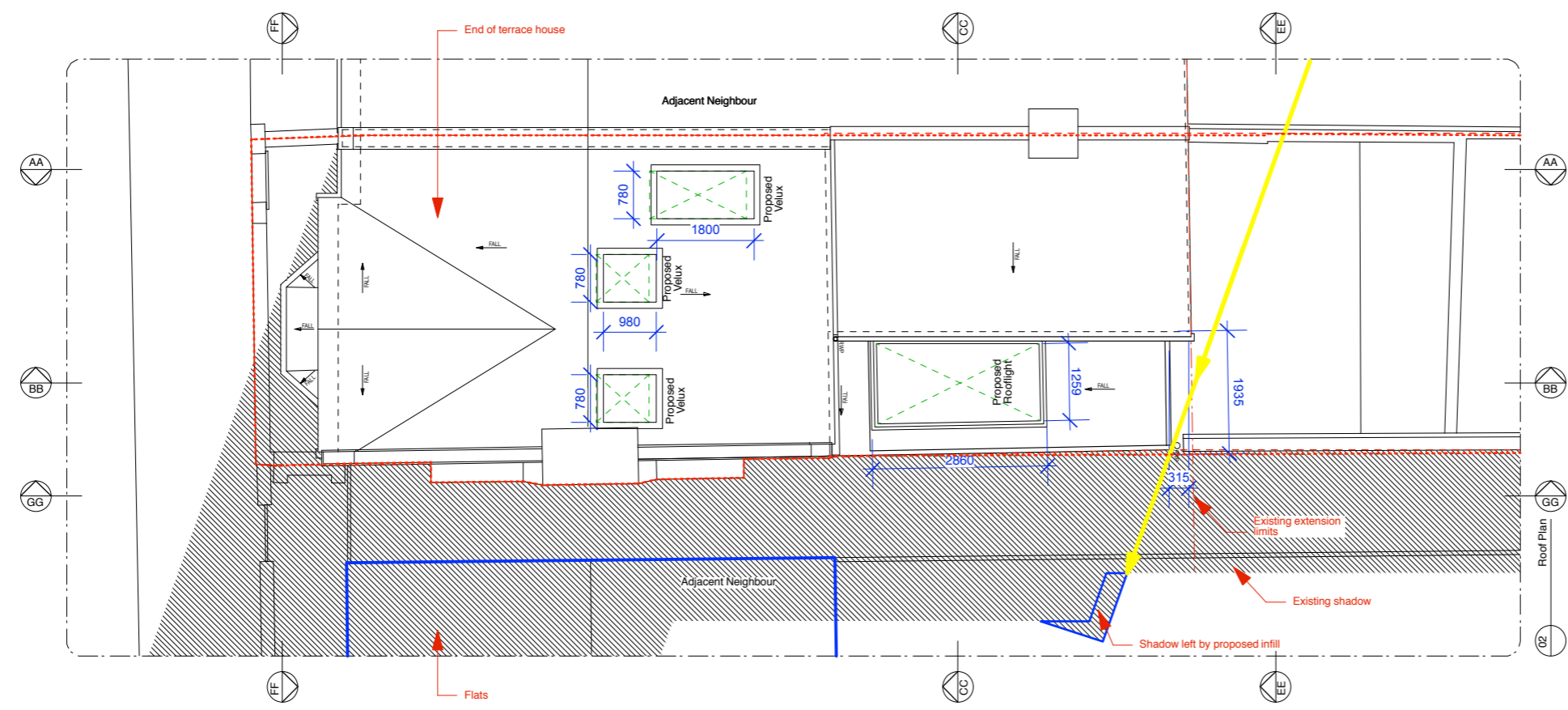

KEY:

- Existing structure
- Proposed elements
- Cupboards
- Roof lights above

Note:
All existing chimneys and chimney pots to be retained.
All new rooflights, windows and door to be for conservation area.



Rev	Issued	Status & Description	FPM / TB
-	12.08.19	Issued for Information	FPM / TB
			Drawn / Checked

Notes:
All dimensions to be checked on site prior to construction or fabrication of any element. Any discrepancies between figure dimensions reported to Architect for clarification prior to commencing work.
This drawing is to be read in conjunction with all consultants information.
Elements of services are indicated for coordination purposes. For full services layouts refer to Services Engineer's drawings and specification.
Elements of structure are indicated for coordination purposes. For full structural layouts refer to Structural Engineer's drawings and specification.
(C) Trevor Brown Architect Ltd. All rights described in chapter IV of the Copyright Designs and Patents Act 1988 have been asserted.



Job
Twisden Road
Address
23 Twisden Road NW5 1DL
Status
Information
Drawing title
Proposed Roof Plan
Scale
1:100@A3
Drawing number
126_sk
Revision
-