

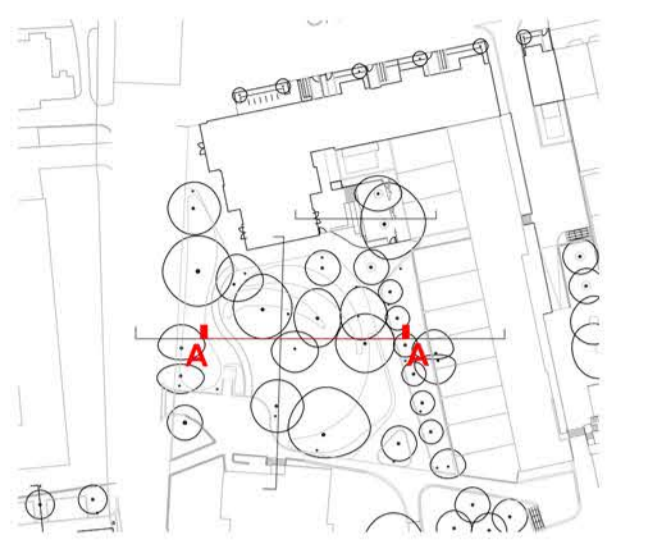

- NOTES:
1. This drawing is to be read in conjunction with all relevant contract documentation from the design team, with any conflicting information to be brought to the attention of Turkington Martin Landscape Architects in writing before commencing on site.
 2. The contractor is to check and verify all levels and dimensions before construction. Any discrepancies are to be brought to the attention of Turkington Martin Landscape Architects in writing before commencing on site.
 3. All dimensions in mm, unless otherwise stated.
 4. Do not scale from this drawing.
 5. All sub base and concrete design and specification to engineer's details. All diagrams provided here are purely indicative.
 6. Waterproofing of any element to be specified by others.
 7. All proprietary products shall be installed in accordance with manufacturers written instructions.
 8. Plant numbers are an indication only and plants should be ordered to suit site areas in accordance with scheduled plant densities.
 9. Any proposed plant substitution shall be agreed with the landscape architect prior to ordering.



Section AA

DATE	DRAWN	DESCRIPTION OF REVISION	REVISION LETTER	CHECKED BY
2014.03.14	TS	Filled trees removed to Glade	A	-

turkington martin

Studio 3.05 Chester House, Kennington Park
 1-3 Brixton Road, London, SW9 6DE
 T: (+44) 020 3567 1050
 E: studio@turkingtonmartin.com

CLIENT
Camden Council
 PROJECT TITLE
MAITLAND PARK ESTATE
 DRAWING TITLE
LANDSCAPE SECTIONS
 DRAWING STATUS
FOR INFORMATION

DRAWING SCALE: 1:50	DRAWN BY: AD	DRAWN DATE: 2014.03.14
PAPER SIZE: A1	CHECKED BY: TS	CHECKED DATE: 2014.03.14

DRAWING NUMBER : **122-LS07** REVISION : **A**
 Turkington Martin LANDSCAPE ARCHITECTS