







KEY

- Trees to be retained 
- Trees to be removed 
- Permanent Protective Barriers 
- Tree Protection Box 
- Ground protection to remain in situ for the duration of the build 
- Suggested Temporary Storage/ Site Office Areas 



Note remainder of driveway area is existing hard stand.
No further protection is required to the current hard standing, unless it is considered that required machinery will damage this hard stand. If so ground protection will be required to protect the whole area of existing hard stand.

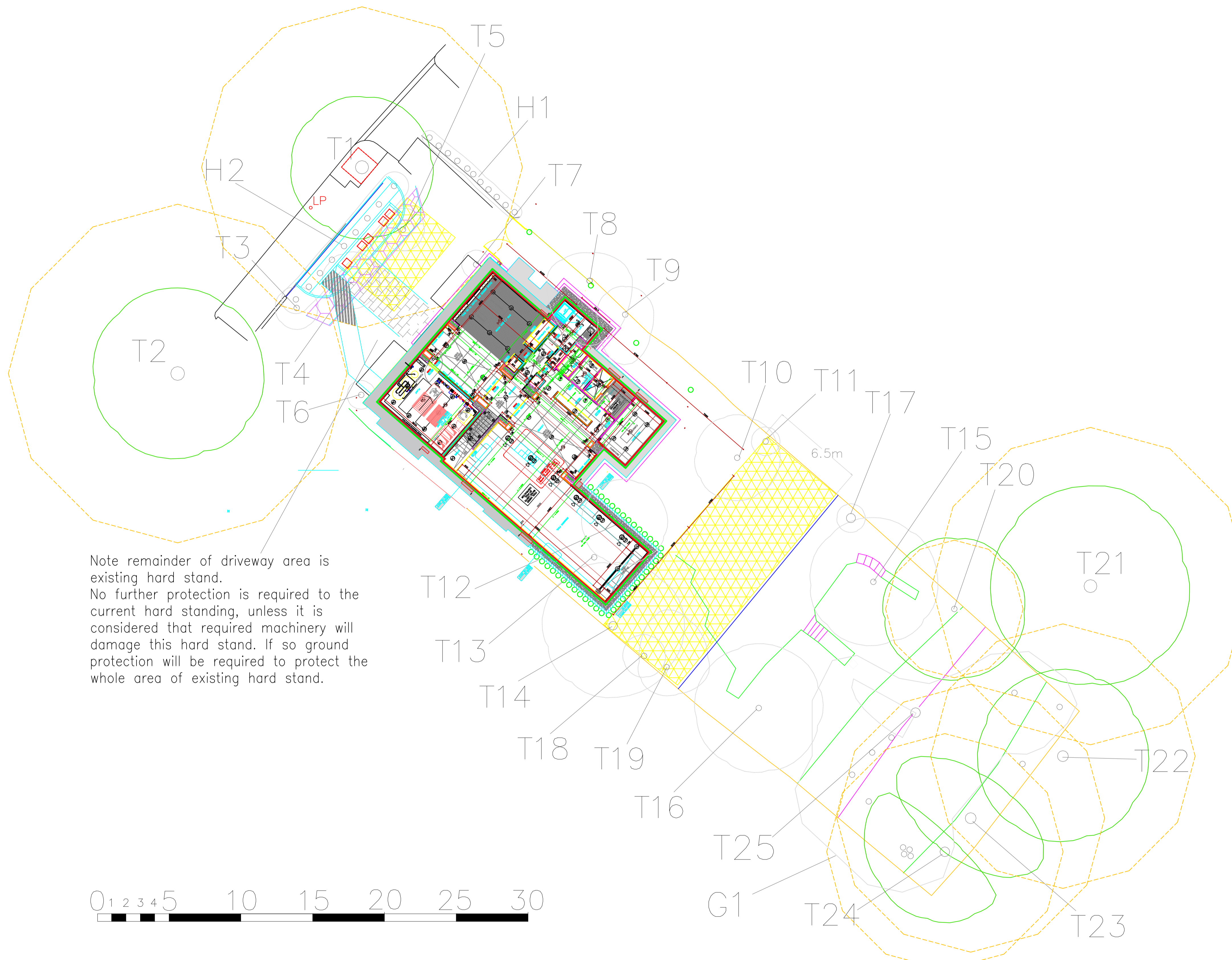

Status: FINAL
Notes:

Writtle Forest Consultancy Ltd
Redindye Farm, Ivy Barns Lane,
Margaretting, Ingatestone, Essex,
CM4 0PU.
Telephone : 01277 355970
Website : www.writtleforest.co.uk



Client: 8 Associates
Project: 24 Heath Drive , London NW3
Title: Tree Protection Plan
– Build Construction

Date: 01/10/19 Original Paper
Scale: 1:150 Size: A1
Drawn: Checked: Job Ref: 190806
Figure Number: 001 Rev: 004