

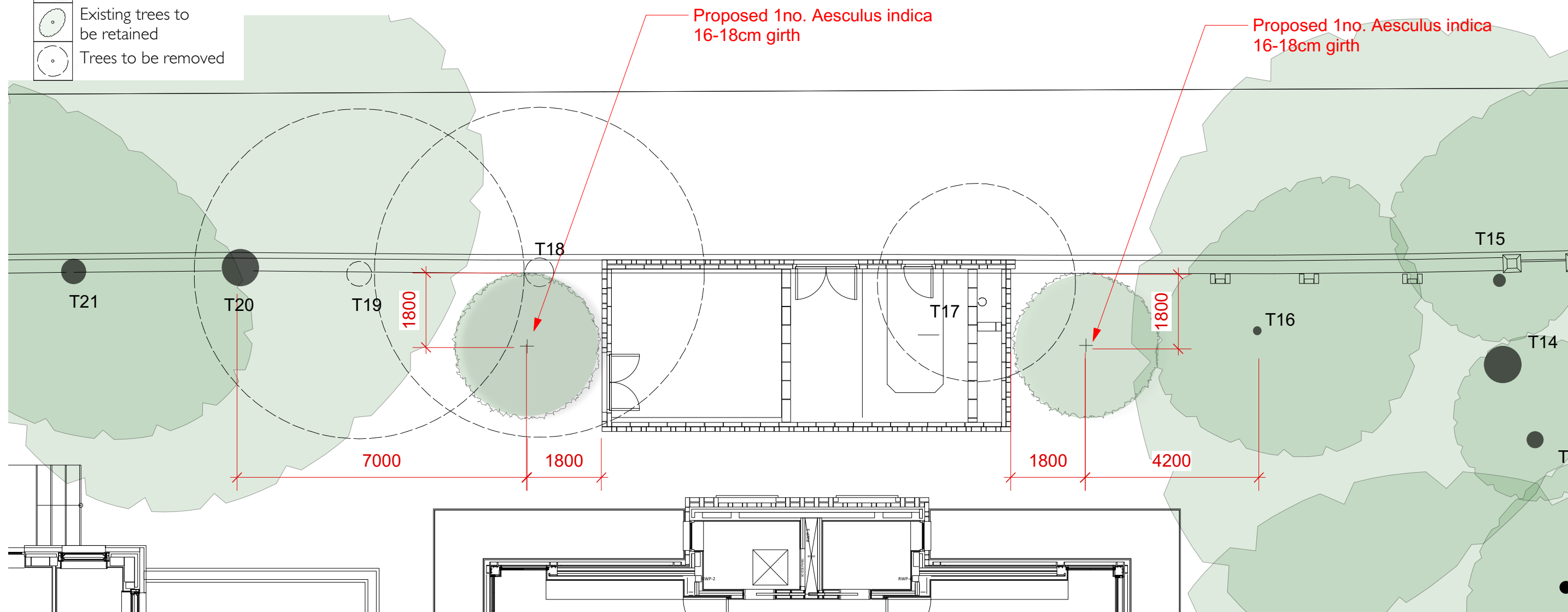

**Legend**

- Proposed trees
- Existing trees to be retained
- Trees to be removed

NB: Dimensions are indicative and exact tree location will be determined on site.



- It has been proposed to place two new trees of 16-18cm girth along the boundary of Queens Grove, to replace trees T18 & T19.
- To provide best opportunity of establishment, successful growth and ultimate form for the proposed trees, one specimen will be planted within the vicinity of the removed trees whilst the second specimen will be planted nearer T16, creating a more uniform frontage along Queens Grove.

## Prior to Planting

- BS8545 will be followed to ensure good practice with regards to all transplanted trees to enable them to grow and flourish, thereby making a long-term contribution to the landscape and streetscape in this instance.
- Several months before planting, a visual analysis of the soil in the areas where the proposed trees are to be planted will take place. A single spade of soil from these areas will be dug and examined to determine soil structure and water retention capabilities. Depending on the findings of this evaluation, soil ameliorants such as organic matter or grit may be added prior to planting.
- If it is determined that the soil is compacted, a drainage percolation test will be performed to ascertain whether there is a need to introduce any land drainage, localise drainage system or employ de-compaction methods such as an air spade to overcome this problem.
- In addition to the visual assessment, a sample of the soil will be sent to a laboratory to be analysed for its pH, nutrient content, potential toxicities and composition. Supplements may be added to the soil depending on the results of this test.

## Post-Planting Maintenance

- The trees will be watered by an automatic drip irrigation system. The system will be constantly monitored and regulated so the trees receive the correct amounts of water during the growing season.
- As part of the planting process, the area around the tree will be mulched to a depth of 50-100 mm of de-composted bark mulch excluding the root flare and base of the stem. This area will also be kept weed free and the mulch will be topped up annually to maintain the specified depth.
- Formative pruning will be carried out in accordance with BS 3998 as required in the initial years of planting until a permanent structurally sound scaffold system of branches typical of the species and appropriate to the site circumstances is produced.
- An annual assessment of health will also be carried out on the trees within the first few years of planting. This will include an assessment of the foliar appearance and girth development to inform the maintenance regime as well as checking for pests, diseases, soil capping, compaction and any external damage. Remedial action will be recommended following discovery.