

TP91008

| | | |
|---|---------|----------------------------|
| D | 21.4.80 | APPAS |
| E | 15.4.80 | GENERAL |
| F | 4.10.82 | FINAL |
| A | 17.4.80 | AS AT THIS LINE OF REMOVAL |

ROUGH OF CAMDEN
COUNTRY PLANNING ACTS
8 NOV 1991
NOT APPROVED
OF THE COUNCIL

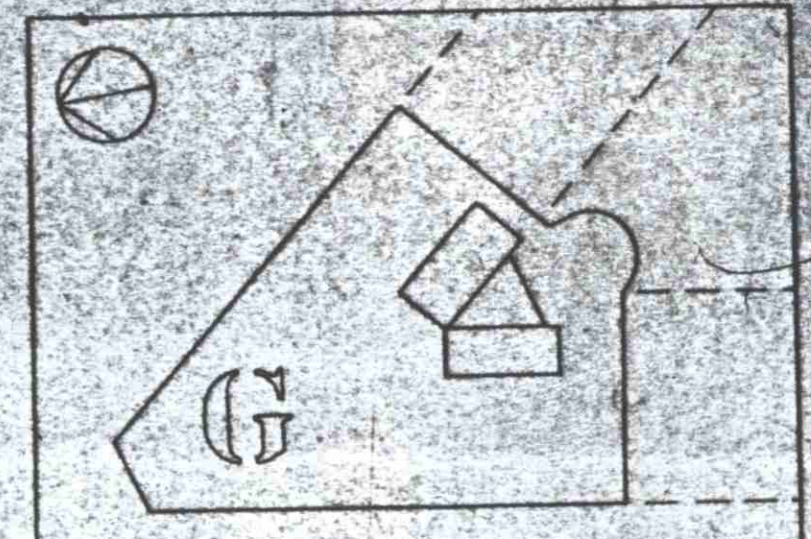

| | |
|--|--|
| TERRY FARRELL PARTNERSHIP | |
| Job | Title |
| COMYN CHING PHASE TWO B COMMERCIAL BUILDING | GENERAL ARRANGEMENT GROUND FLOOR PLAN |
| Date | Scale |
| 17.2.85 | 1:50 |
| Drawing no | |
| CC2B 202. G | |
| Do not scale. Check dimensions on site. This drawing copyright © Terry Farrell Partnership | |
| 1 FARRINGTON STREET LONDON W3M 4JW | |
| Architects - Designers - Planners | Telephone 01-467 8541 |