

X:\JOBS\10_KING'S CROSS_CENTRAL_T2\CAD\DRAWINGS\STAGE 4 - TENDER PACKAGE\100-100 SERIES - CA - SOFTWORKS\KXC-T2-001-L-4795-91-1102-01.DWG

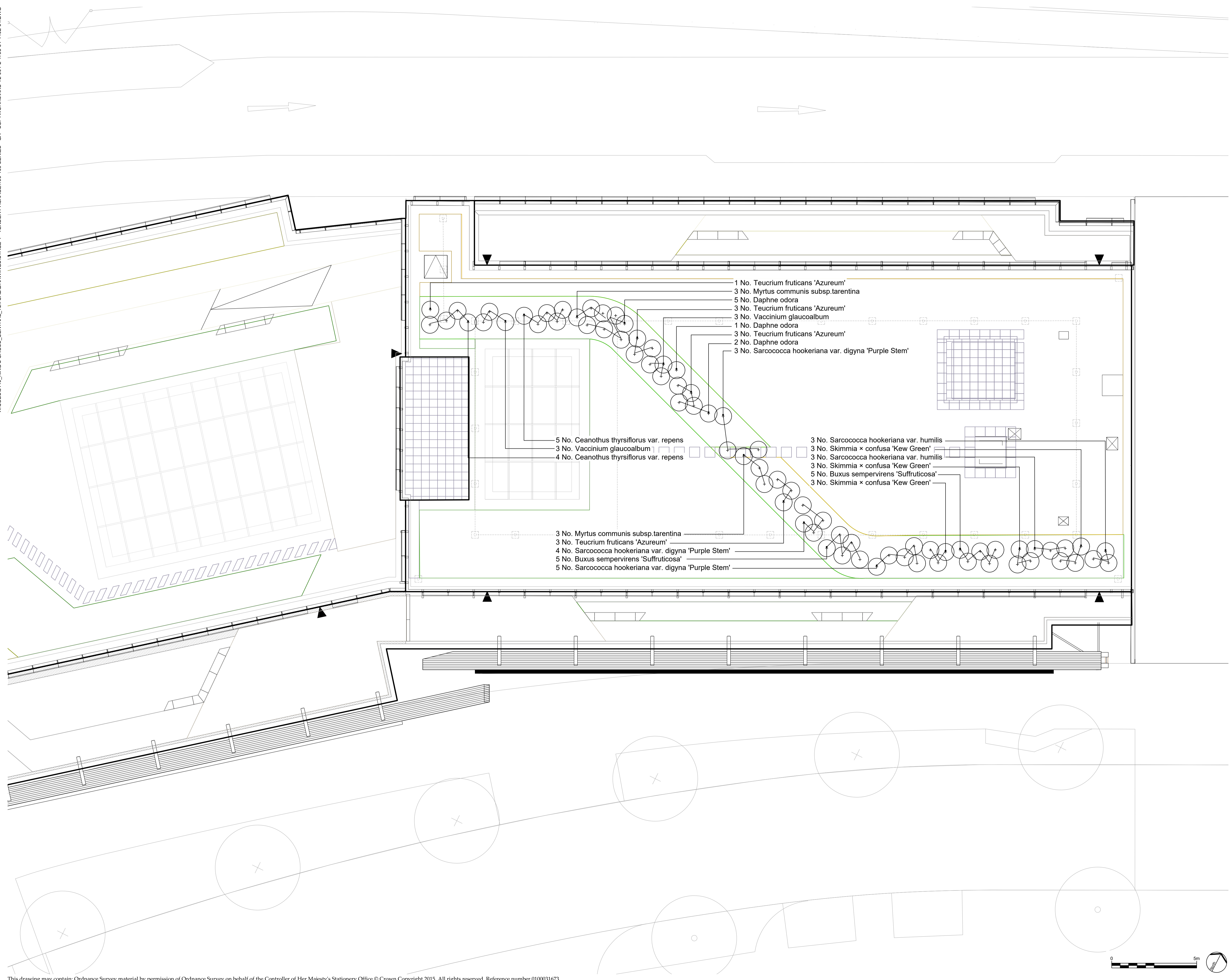

LEGEND

NOTES:

1. Refer to drawing KXC-T2-001-L-4795-20-1ZZ-01 for Roof Plan General Arrangement
2. Refer to drawing KXC-T2-001-L-4795-90-1ZZ-01 Hardworks General Arrangement (all terraces)
3. Refer to drawing KXC-T2-001-L-4795-91-1ZZ-01 for Softworks General Arrangement
4. Refer to drawing KXC-T2-001-L-4795-90-1ZZ1 for Edges General Arrangement
5. Refer to KXC-T2-001-L-4795-91-500 Series of drawings for typical Softworks Details
6. Refer to drawings KXC-T2-001-L-4795-91-700 Planting Schedules
7. For balustrade, grille, and access hatch details refer to Bennetts Associates information
8. For all lighting refer to Mike Grubb Studio information
9. For all roof services layouts and details refer to BAM information
10. For maintenance information and davit locations refer to REEF Associates information

- 1 No. *Teucrium fruticans* 'Azureum'
- 3 No. *Myrtus communis* subsp. *tarentina*
- 5 No. *Daphne odora*
- 3 No. *Teucrium fruticans* 'Azureum'
- 3 No. *Vaccinium glaucoalbum*
- 1 No. *Daphne odora*
- 3 No. *Teucrium fruticans* 'Azureum'
- 2 No. *Daphne odora*
- 3 No. *Sarcococca hookeriana* var. *digyna* 'Purple Stem'

- 5 No. *Ceanothus thyrsiflorus* var. *repens*
- 3 No. *Vaccinium glaucoalbum*
- 4 No. *Ceanothus thyrsiflorus* var. *repens*

- 3 No. *Sarcococca hookeriana* var. *humilis*
- 3 No. *Skimmia x confusa* 'Kew Green'
- 3 No. *Sarcococca hookeriana* var. *humilis*
- 3 No. *Skimmia x confusa* 'Kew Green'
- 5 No. *Buxus sempervirens* 'Suffruticosa'
- 3 No. *Skimmia x confusa* 'Kew Green'

- 3 No. *Myrtus communis* subsp. *tarentina*
- 3 No. *Teucrium fruticans* 'Azureum'
- 4 No. *Sarcococca hookeriana* var. *digyna* 'Purple Stem'
- 5 No. *Buxus sempervirens* 'Suffruticosa'
- 5 No. *Sarcococca hookeriana* var. *digyna* 'Purple Stem'

READ THIS FIRST

- Note for Contractors**
This drawing should be considered along with the risk information contained in the CDM Pre Construction Information. This information will include details of the SIGNIFICANT risks which LDA Design has identified which may arise from constructing their designs shown on this drawing. A Competent Contractor should be aware of the typical risks associated with doing this work.
- Note for Workers**
DO NOT START YOUR WORK unless you know the Risks and Controls relating to the work on this drawing (including SAFE SEQUENCES OF WORK and EQUIPMENT).
- Do not issue copies of parts of this drawing without the above Note for Workers (unless you are sure that the Workers can undertake the work safely).

T01	Stage 4 1st Issue	RA	10.05.16
P01	Stage 3	RA	25.11.15
REV.	DESCRIPTION		APP. DATE

LDA DESIGN

PROJECT TITLE
ROOF TERRACES, T2 KINGS CROSS

DRAWING TITLE
General Arrangement - Softworks - Trees & Shrubs
Block N2 - Level 10

ISSUED BY	London	T: 020 7467 1470
DATE	MAY 2016	DRAWN RC
SCALE	A1 1:100	CHECKED BE
STATUS	Tender	APPROVED RA

DWG. NO KXC-T2-001-L-4795-91-1102-01

No dimensions are to be scaled from this drawing.
All dimensions are to be checked on site.
Area measurements for indicative purposes only.

© LDA Design Consulting Ltd. Quality Assured to BS EN ISO 9001 : 2008
Sources Ordnance Survey