

**GENERAL NOTES:**  
 Install new cast radiators throughout. Pipework to reuse existing routes  
 Install new mechanical and electrical services  
 Install new fire alarm system including smokeheads, closers, emergency lighting and breakglass as required  
 Repair and redecorate walls, skirtings dado rails and joinery throughout  
 Repair and redecorate heritage ceilings where possible  
 Repair and redecorate all existing doors  
 Repair and make good chimney pieces

- ① New plasterboard ceiling
- ② Replace oval stair roof light with modern double glazed unit from Heritage Patent Glazing or equivalent approved
- ③ Install high quality new kitchen
- ④ Install new glazed wall to kitchen
- ⑤ Install high quality new utility room
- ⑥ Install new WC
- ⑦ Install new master bathroom
- ⑧ Install new bathroom
- ⑨ Install new wall to conceal cistern systems
- ⑩ Install full height wall tiling

- ⑪ Install tiled flooring to kitchen and utility room
- ⑫ Install tiled flooring to all bathrooms
- ⑬ Install new timber board flooring
- ⑭ Replace carpet
- ⑮ Install new fire door to flat entrance
- ⑯ Repair restore and redecorate window frames and shutters where necessary
- ⑰ Install thin profile secondary glazing to all windows by Storm Windows or equivalent approved
- ⑱ Additional twin rain water outlet
- ⑲ Replace fireplace hearth and surround with new tiles in keep with period
- ⑳ Install new door to bathrooms

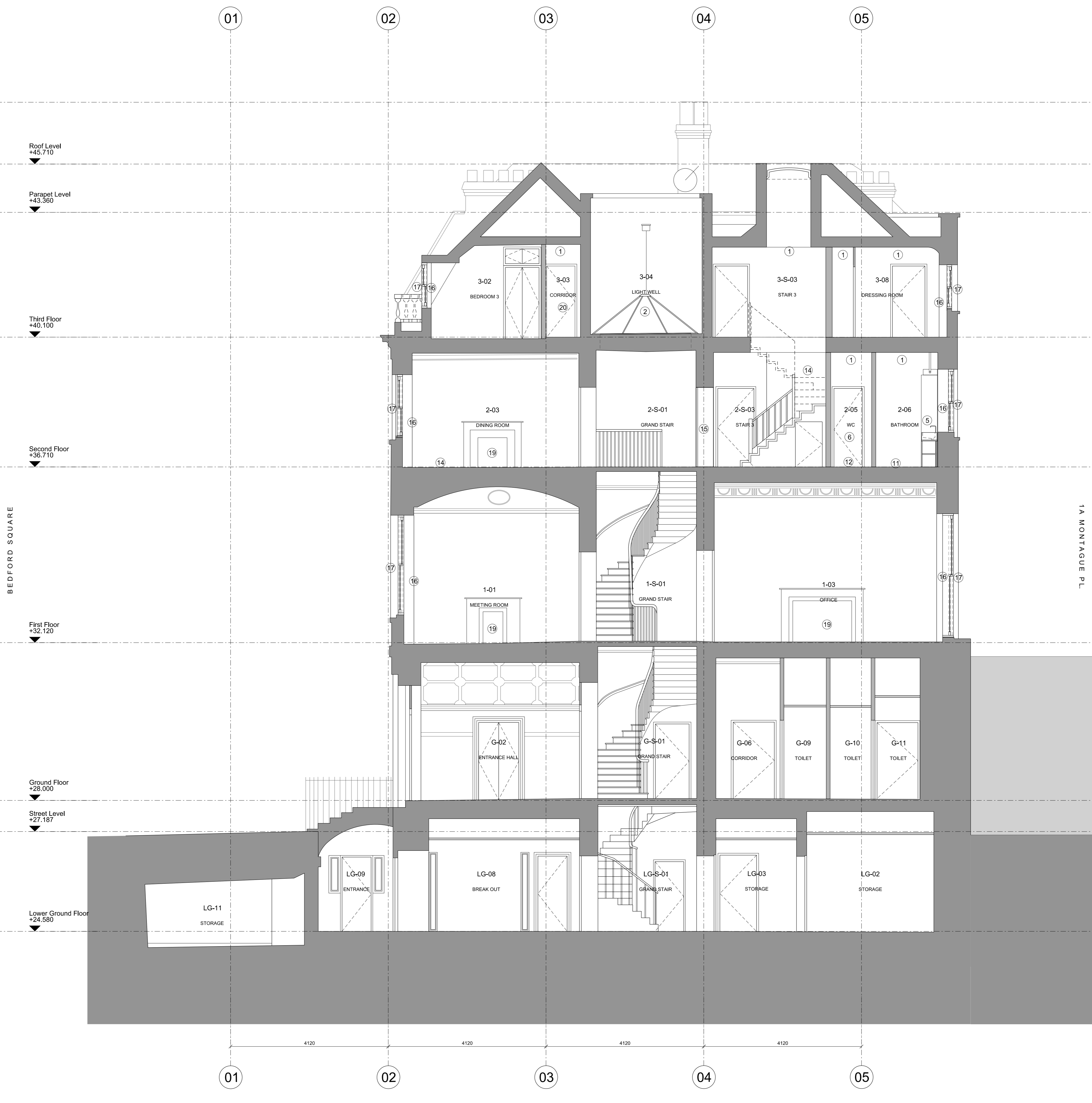

Revisions  
 \ 190916 Issued for Planning

By Chk  
 HG PB

Notes  
 0m 1m 5m

**NOTES:**  
 - No demolitions to be undertaken without agreed temporary works or propping design;  
 - All demolition dimensions and cut lines to be checked on site with any discrepancies brought to the attention of the CA or Architect before demolitions begin;  
 - Do not scale from drawing;  
 - Drawing to be printed in colour.

■ EXISTING FABRIC  
 ■ MODERN FABRIC

**BENNETTS ASSOCIATES**

1 Rawstorne Place, London EC1V 7NL  
 T +44 (0)207 5203300 • www.bennettsassociates.com  
 E mail@bennettsassociates.com

For Bennetts Associates' electronic information issue disclaimer - www.bennettsassociates.com/informationclaimers/

Project  
**No.10 Bedford Sq.**  
 DLT Entertainment

Project No. 1806

Drawing Title  
**Proposed Long Section Staircase**

Drawing Number  
**1806\_P20\_220**

Scale @ A3  
**1 : 100**

Scale @ A1  
**1 : 50**

Revision/Suitability  
 \

Revision Date  
**190916**

YY MM DD