

GENERAL NOTES:

Install new cast radiators throughout. Pipework to reuse existing routes

Install new mechanical and electrical services

Install new fire alarm system including smokeheads, closers, emergency lighting and breakglass as required

Repair and redecorate walls, skirtings dado rails and joinery throughout

Repair and redecorate heritage ceilings where possible

Repair and redecorate all existing doors

Repair and make good chimney pieces

- 1 New plasterboard ceiling
- 2 Replace ovular stair roof light with modern double glazed unit from Heritage Patent Glazing or equivalent approved
- 3 Install high quality new kitchen
- 4 Install new glazed wall to kitchen
- 5 Install high quality new utility room
- 6 Install new WC
- 7 Install new master bathroom
- 8 Install new bathroom
- 9 Install new wall to conceal cistern systems
- 10 Install full height wall tiling
- 11 Install tiled flooring to kitchen and utility room
- 12 Install tiled flooring to all bathrooms
- 13 Install new timber board flooring
- 14 Replace carpet
- 15 Install new fire door to flat entrance
- 16 Repair restore and redecorate window frames and shutters where necessary
- 17 Install thin profile secondary glazing to all windows by Storm Windows or equivalent approved
- 18 Additional twin rain water outlet
- 19 Replace fireplace hearth and surround with new tiles in keep with period
- 20 Install new door to bathrooms
- 21 Install faux door frame to create symmetry

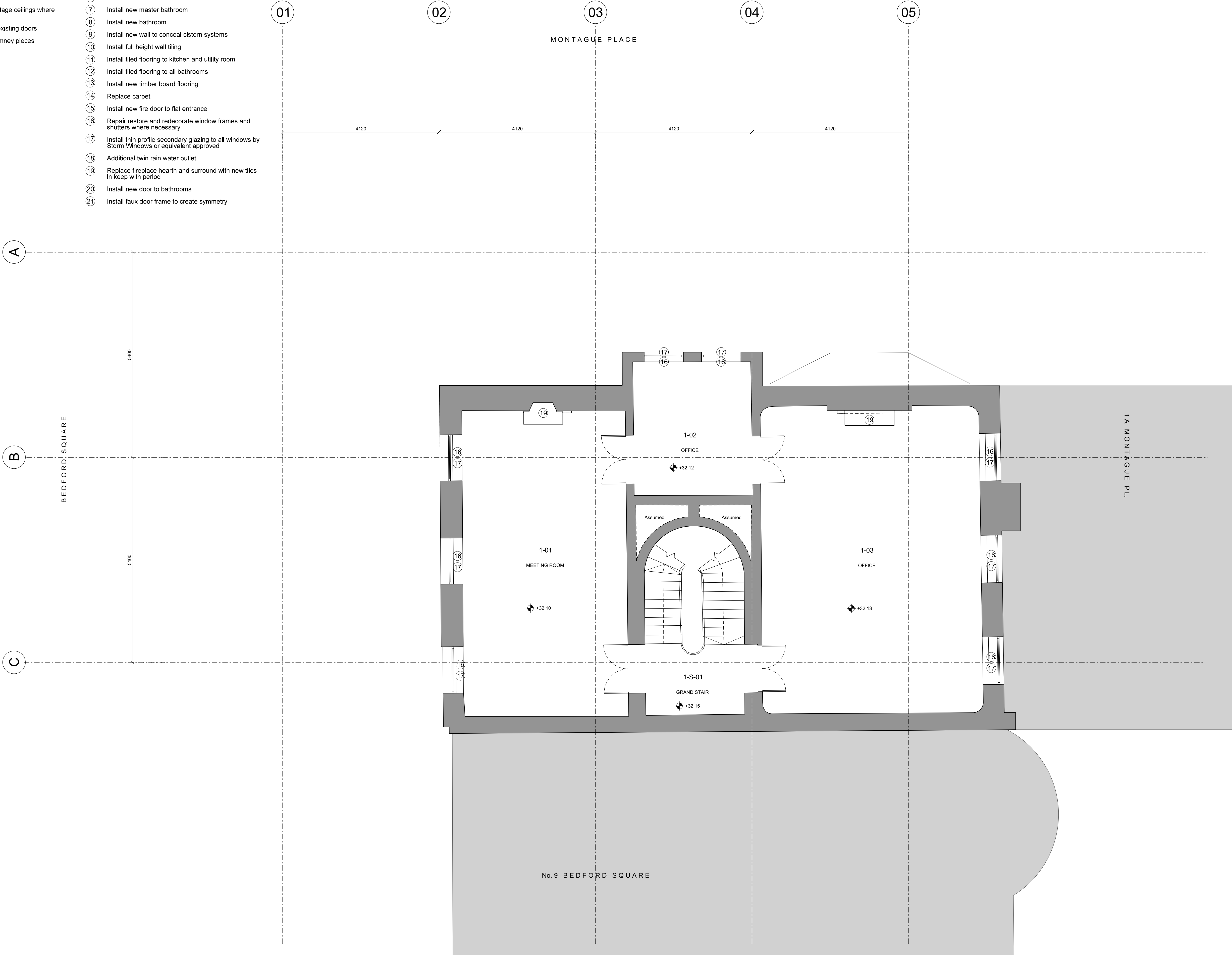

Revisions  
190916 Issued for Planning

By  
HG

Chk  
PB

Notes

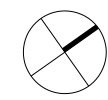

NOTES:

- No demolitions to be undertaken without agreed temporary works or propping design;
- All demolition dimensions and cut lines to be checked on site with any discrepancies brought to the attention of the CA or Architect before demolitions begin;
- Do not scale from drawing;
- Drawing to be printed in colour.

- EXISTING FABRIC
- MODERN FABRIC
- SITE BOUNDARY

## BENNETTS ASSOCIATES

1 Rawstorne Place, London EC1V 7NL  
T +44(0)207 5203300 • www.bennettsassociates.com  
E mail@bennettsassociates.com

For Bennetts Associates' electronic information issue disclaimer •  
www.bennettsassociates.com/information/disclaimer/

Project No. 1806

### No.10 Bedford Sq. DLT Entertainment

Drawing Title  
Proposed  
First Floor

Drawing Number  
1806\_P20\_101

Revision/Suitability  
1

Scale @ A3  
1 : 100

Scale @ A1  
1 : 50

Revision Date  
190916

YY MM DD