

- 1

Existing modern radiators and radiator covers to be removed
- 2

Modern servicing equipment to be removed
- 3

Modern post and partition to be removed
- 4

Existing kitchen ware, appliances and furniture to be removed
- 5

Existing sanitary ware, fixtures and appliances to be removed
- 6

Non original/non structural wall to be removed
- 7

Non original glass skylight to be removed
- 8

Non original timber flooring to be stripped out
- 9

Non original plasterboard ceilings to be stripped out
- 10

Non original tiled fireplace surround and hearth to be stripped out
- 11

Non original servicing hatch removed, and wall filled in
- 12

Non original existing doors to be removed and replaced
- 13

Non original beam to be explored and if possible stripped out

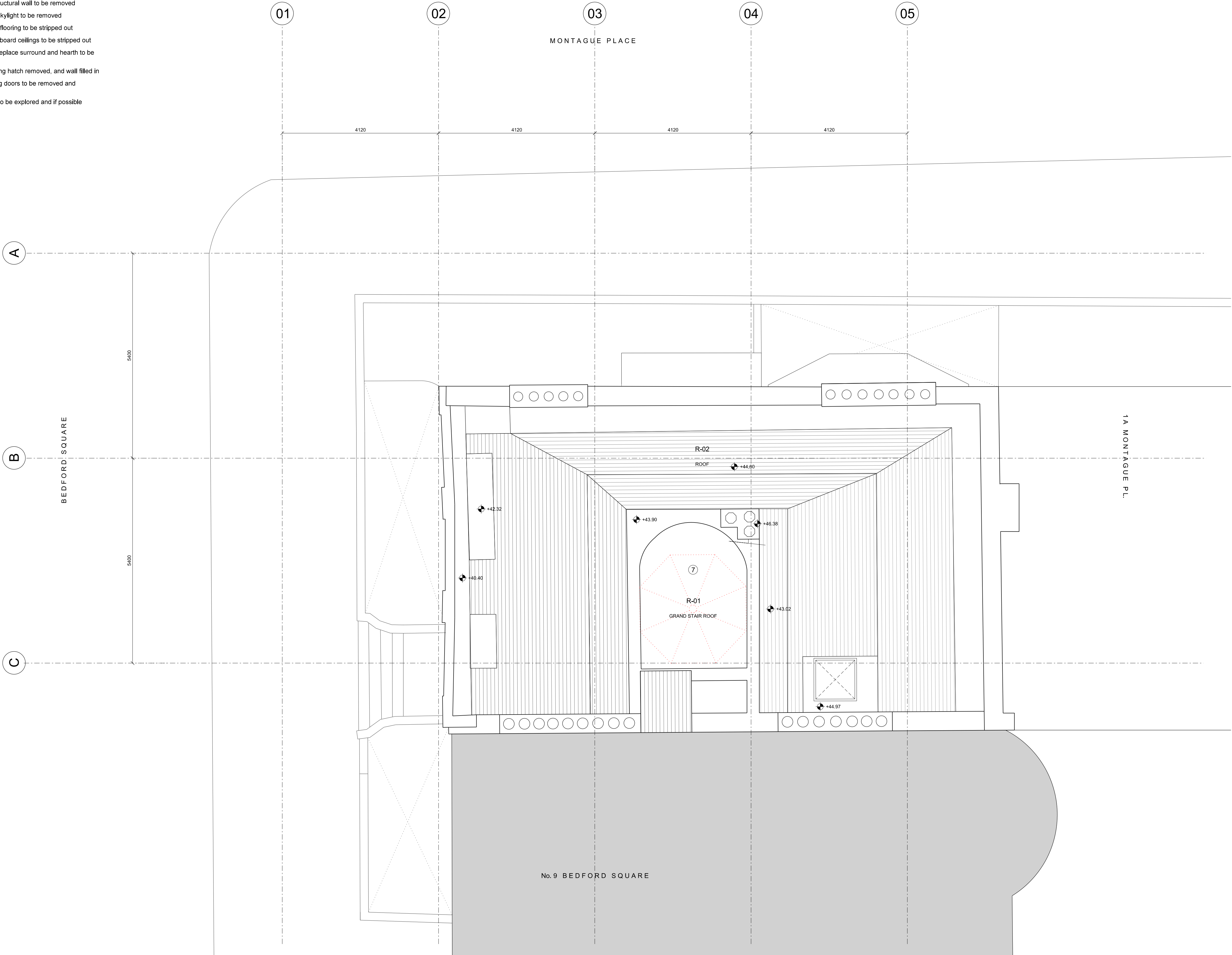

Revisions

\ 190916 Issued for Planning

By

HG

Chk

PB

Notes

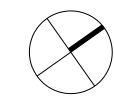

NOTES:

- No demolitions to be undertaken without agreed temporary works or propping design;
- All demolition dimensions and cut lines to be checked on site with any discrepancies brought to the attention of the CA or Architect before demolitions begin;
- Do not scale from drawing;
- Drawing to be printed in colour.

- DEMOLITION
- FLOOR DEMOLITION
- EXISTING FABRIC
- MODERN FABRIC
- SITE BOUNDARY

BENNETTS ASSOCIATES

1 Rawstorne Place, London EC1V 7NL
T +44(0)207 5203300 • www.bennettsassociates.com
E mail@bennettsassociates.com

For Bennetts Associates' electronic information issue disclaimer -
www.bennettsassociates.com/information/disclaimer/

Project

Project No. 1806

No.10 Bedford Sq.

DLT Entertainment

Drawing Title

Existing/Demolitions

Roof Plan

Drawing Number

1806_P12_104

Revision/Suitability

\

Scale @ A3

Scale @A1

Revision Date

1 : 100

1 : 50

190916

YY MM DD