

- EXTERNAL**
- Assumed Existing Concrete Lintel
 - Assumed Existing Solid Masonry Wall, with soldier course over window head Refer to proposed elevations for external repairs and making good
 - Gyproc ThermoLine SUPER insulation board Refer to 5450 & 5451
 - New DPC, 45-20-20/305 Bitumen based damp proof courses and/ cavity trays
 - Mumford & Wood Ltd Conservation Box Sash Window SPEC 25-50-95 / 125
 - Engineered Hardwood Frame; Painted; to match existing, adjacent. Ref spec 35-85-60/195 Water-borne paint system - type Exterior woodwork
 - Concealed trickle ventilation
 - Full standard weatherseal with Sashglide® acoustic weatherpile
 - Engineered Hardwood Sashes; Painted; to match existing
 - New secondary glazing, refer to window schedule 8311, 8312 and 8313 for type and 5450 for typical detail
 - Single Glazed Unit; to match existing
 - Toughened Laminated to Ground and Basement
 - Toughened to all other floors

1 Section: Typical Box Sash - Half Brick Reveal - Head Detail
1 : 2

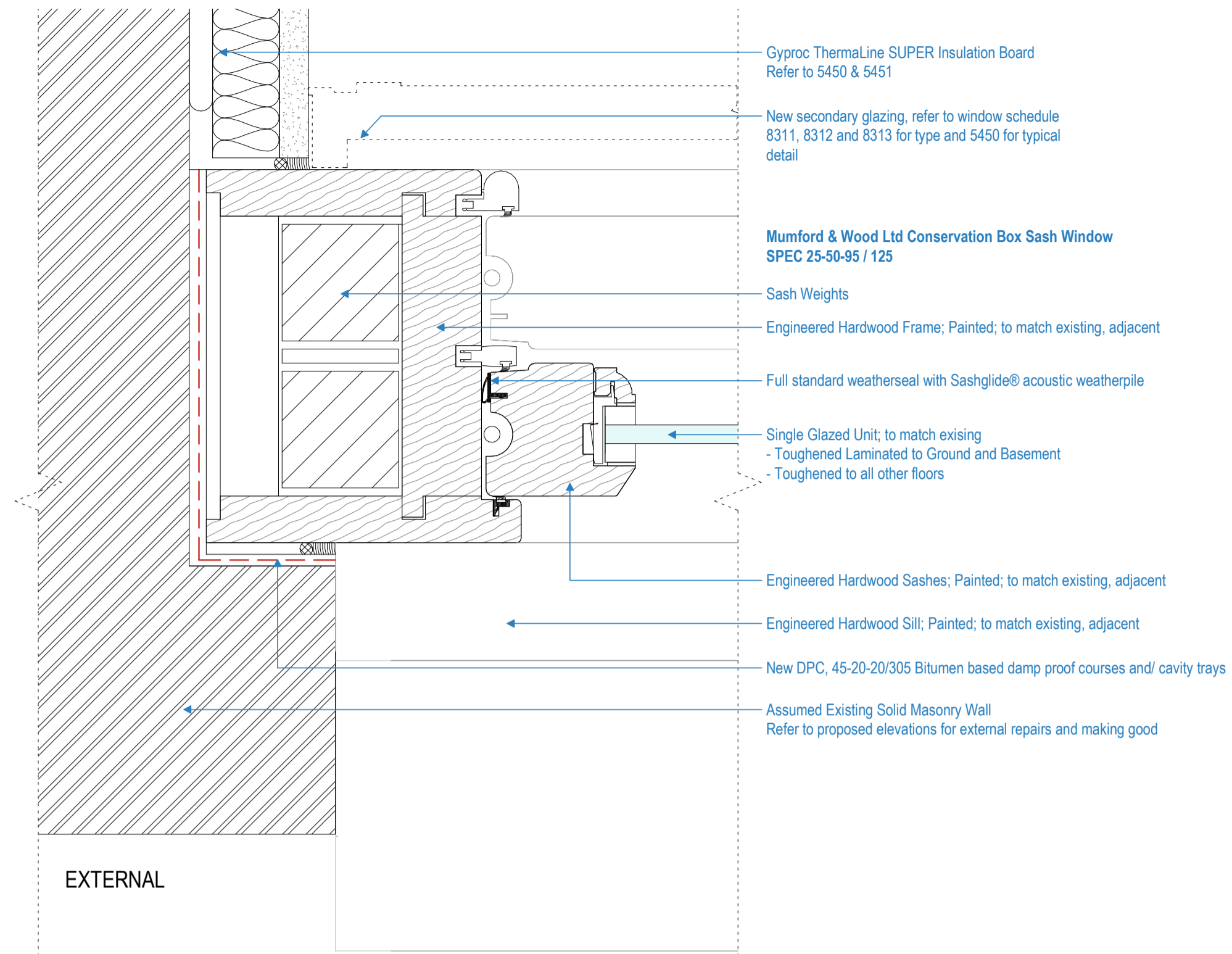

- Gyproc ThermoLine SUPER Insulation Board Refer to 5450 & 5451
- New secondary glazing, refer to window schedule 8311, 8312 and 8313 for type and 5450 for typical detail
- Mumford & Wood Ltd Conservation Box Sash Window SPEC 25-50-95 / 125
- Sash Weights
- Engineered Hardwood Frame; Painted; to match existing, adjacent
- Full standard weatherseal with Sashglide® acoustic weatherpile
- Single Glazed Unit; to match existing
 - Toughened Laminated to Ground and Basement
 - Toughened to all other floors
- Engineered Hardwood Sashes; Painted; to match existing, adjacent
- Engineered Hardwood Sill; Painted; to match existing, adjacent
- New DPC, 45-20-20/305 Bitumen based damp proof courses and/ cavity trays
- Assumed Existing Solid Masonry Wall Refer to proposed elevations for external repairs and making good

4 Plan: Typical Box Sash - Half Brick Reveal - Jamb Detail (left)
1 : 2

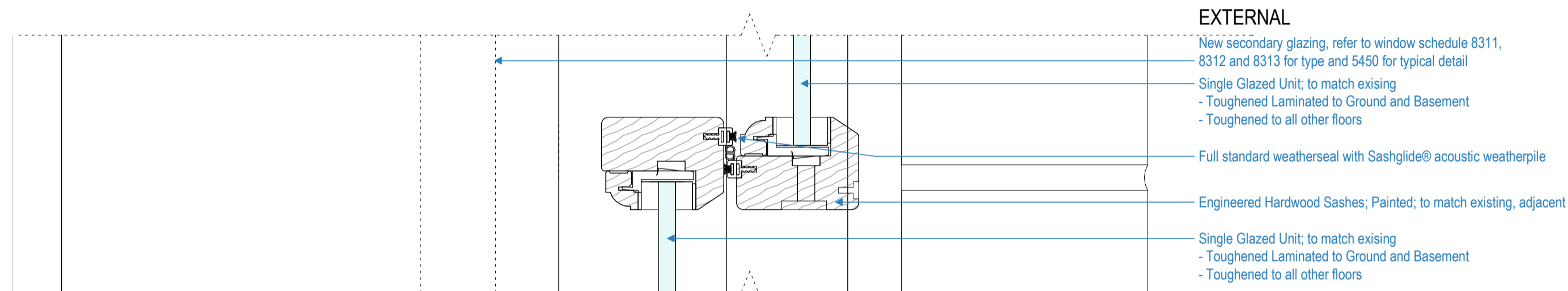

- EXTERNAL**
- New secondary glazing, refer to window schedule 8311, 8312 and 8313 for type and 5450 for typical detail
 - Single Glazed Unit; to match existing
 - Toughened Laminated to Ground and Basement
 - Toughened to all other floors
 - Full standard weatherseal with Sashglide® acoustic weatherpile
 - Engineered Hardwood Sashes; Painted; to match existing, adjacent
 - Single Glazed Unit; to match existing
 - Toughened Laminated to Ground and Basement
 - Toughened to all other floors

2 Section: Typical Box Sash - Half Brick Reveal - Intermediate Detail
1 : 2

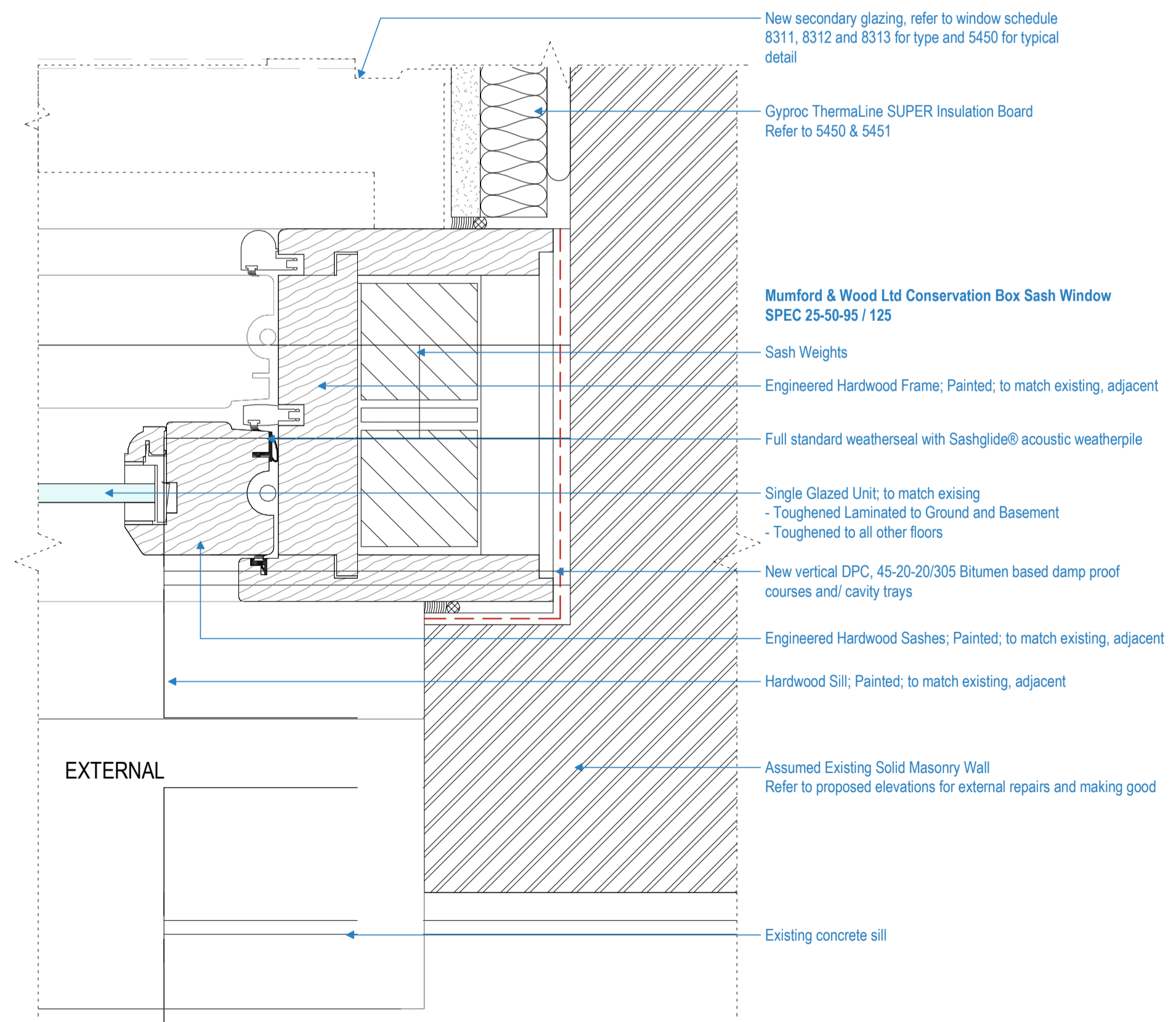

- New secondary glazing, refer to window schedule 8311, 8312 and 8313 for type and 5450 for typical detail
- Gyproc ThermoLine SUPER Insulation Board Refer to 5450 & 5451
- Mumford & Wood Ltd Conservation Box Sash Window SPEC 25-50-95 / 125
- Sash Weights
- Engineered Hardwood Frame; Painted; to match existing, adjacent
- Full standard weatherseal with Sashglide® acoustic weatherpile
- Single Glazed Unit; to match existing
 - Toughened Laminated to Ground and Basement
 - Toughened to all other floors
- New vertical DPC, 45-20-20/305 Bitumen based damp proof courses and/ cavity trays
- Engineered Hardwood Sashes; Painted; to match existing, adjacent
- Hardwood Sill; Painted; to match existing, adjacent
- Assumed Existing Solid Masonry Wall Refer to proposed elevations for external repairs and making good
- Existing concrete sill

5 Plan: Typical Box Sash - Half Brick Reveal - Jamb Detail (right)
1 : 2

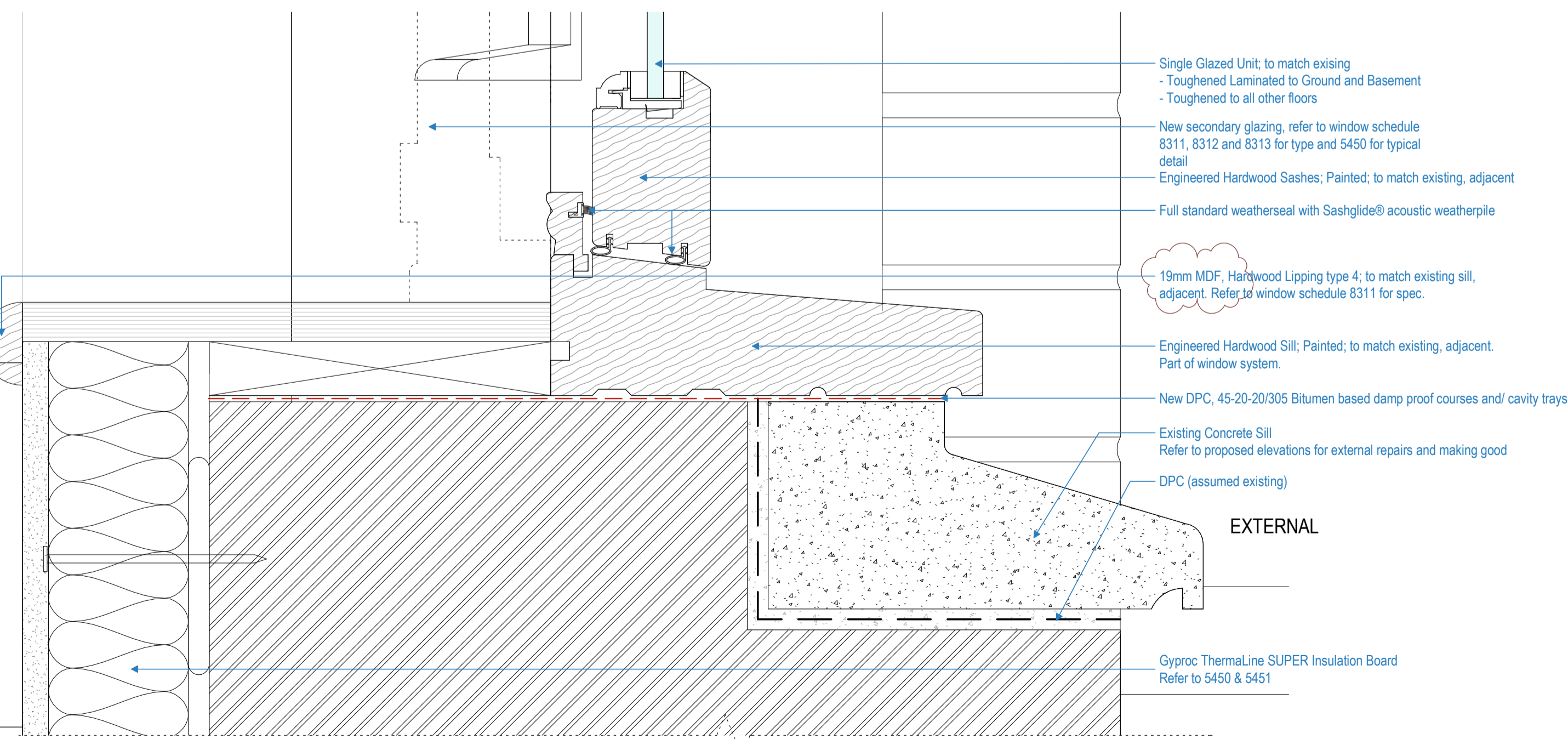

- Single Glazed Unit; to match existing
 - Toughened Laminated to Ground and Basement
 - Toughened to all other floors
- New secondary glazing, refer to window schedule 8311, 8312 and 8313 for type and 5450 for typical detail
- Engineered Hardwood Sashes; Painted; to match existing, adjacent
- Full standard weatherseal with Sashglide® acoustic weatherpile
- 19mm MDF, Hardwood Lipping type 4; to match existing sill, adjacent. Refer to window schedule 8311 for spec.
- Engineered Hardwood Sill; Painted; to match existing, adjacent. Part of window system.
- New DPC, 45-20-20/305 Bitumen based damp proof courses and/ cavity trays
- Existing Concrete Sill Refer to proposed elevations for external repairs and making good
- DPC (assumed existing)
- Gyproc ThermoLine SUPER Insulation Board Refer to 5450 & 5451

3 Section: Typical Box Sash - Half Brick Reveal - Sill Detail
1 : 2

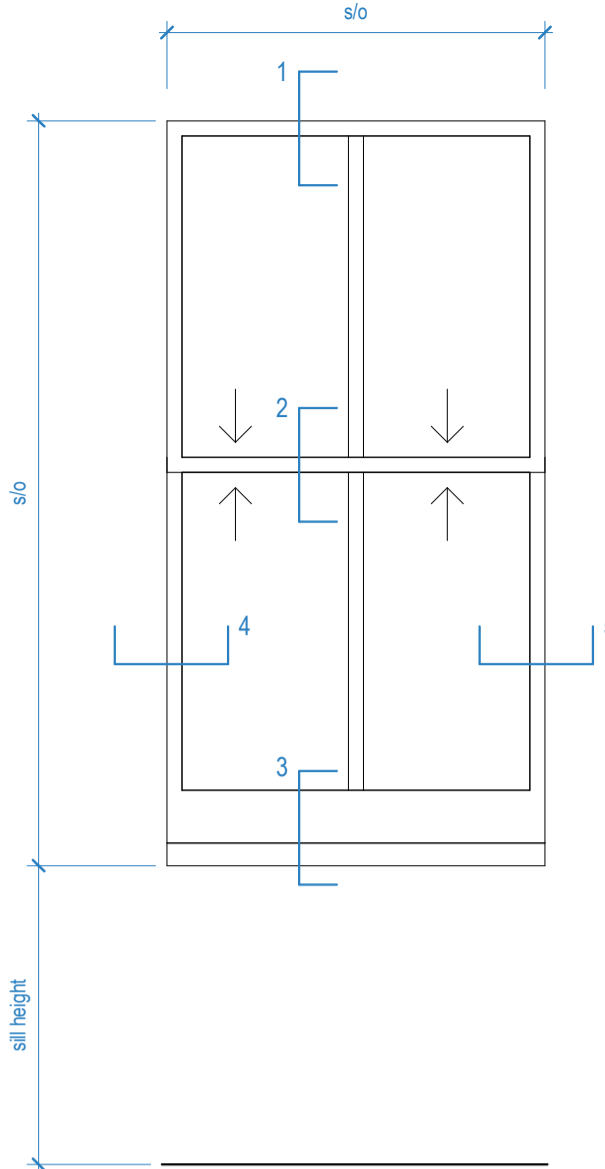

Typical Sash Timber Windows
New to match existing
Spec ref. 25-50-95 / 125

Notes:

- For approximate structural openings, see glazing schedule 8311-8313.
- Final measurements to be taken by manufacturer on site prior to manufacture.
- Glazing in critical locations to be safety glazing to comply with Building Regs Part K. Refer to Window Schedules Sheet 8311-8313 for window ironmongery types and all repairs required to existing. Detail drawings and samples of materials as appropriate to be submitted to and approved in writing by the LPA (Condition 4b) before work is begun.
-
-

Rev	Date	Details/ Amended by	Sign
C4	24.06.19	Updated construction issue	LM
C1	10.08.18	First Construction Issue	LM
A12	25.06.18	REVISED STAGE 4 ISSUE	LM
A7	07.02.18	STAGE 4 SUBMISSION/	AML
P1	27.11.17	Draft Stage 4 Issue / JB	LM

sonnemanntoon
architects

Quality House
6-9 Quality Court
Chancery Lane
London WC2A 1HP
United Kingdom

tel: +44 (0)20 7580 8881
email: info@st-arch.co.uk
web: www.st-arch.co.uk

© This drawing is copyright

Do not scale this drawing. Architect to be informed of all discrepancies in dimensions. Contractor to check all dimensions on site.

Project title
ITALIAN HOSPITAL

Drawing title
DETAILS: WINDOWS
Typical New Timber Sash Window

Scale Status Revision
1:2 @A1 CONSTR. C4

Drawing number
1615-ST-Q1-XX-DR-A-5320

