

Beams (Existing)	Floors (Existing)	Columns (Proposed)	Beams (Proposed)	Floors (Proposed)
ex. B1: Existing Steel Beam.	ex. FJF: Assumed Existing Filler Joist Floor. Span Assumed. ex. T1: Existing Timber Joist Floor	C1: 203 UC	B1: 203 UC	T1: Timber Joists or Light Gauge Steel (Metsec or Similar) with 2 No. Layers 12mm Plywood With Lapped & Staggered Joints.

Note

- All existing masonry walls assumed to be 215mm.
- All new internal partitions are assumed to be lightweight light gauge steel (Metsec or similar) or timber stud.
- All new external walls to be built up are assumed to be lightweight light gauge steel (Metsec or similar) with a brickslip or Corten finish.

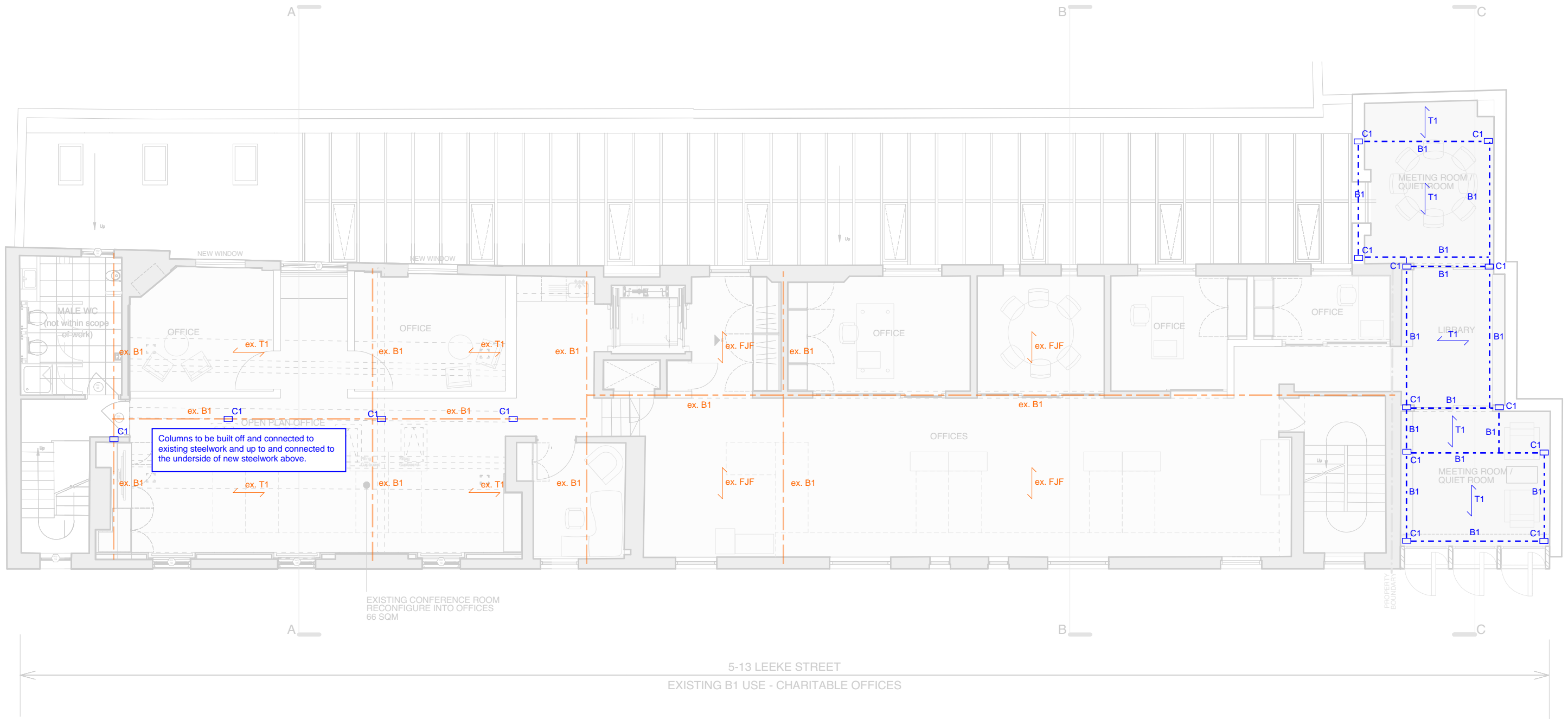

NOT FOR CONSTRUCTION

Rev	Date	Description	Drawn	Check
Drawing Status		Project No		
PRELIMINARY		180832		
Date	Drawn	Drawing No		
20.08.2019	JL	180832-SK-S-102		
Scale	Engineer	Revision		
1:100 @ A3	JL	P1		

conisbee
 Consulting Structural Engineers
 Consulting Civil Engineers

1-5 Offord St
 London N1 1DH
 Tel 020 7700 6666
 Fax 020 7700 6686
 design@conisbee.co.uk
 www.conisbee.co.uk

Project
5-13 Leeke Street

Title
SECOND FLOOR PLAN