

Foundations (Proposed)	Ground Beam (Proposed)	Columns (Proposed)	Floors (Proposed)
P1: 1500mm x 1500mm x 1500 dp mass concrete pad foundation	GB1: 254 UC wrapped in D49 mesh and encased in 750mm wide x 1500mm deep mass concrete strip footing.	C1: 203 UC	⊕ 200 RC Suspended Slab

**Note**

- All existing masonry walls assumed to be 215mm.
- All new internal partitions are assumed to be lightweight light gauge steel (Metsec or similar) or timber stud.
- All new external walls to be built up are assumed to be lightweight light gauge steel (Metsec or similar) with a brickslip or Corten finish.

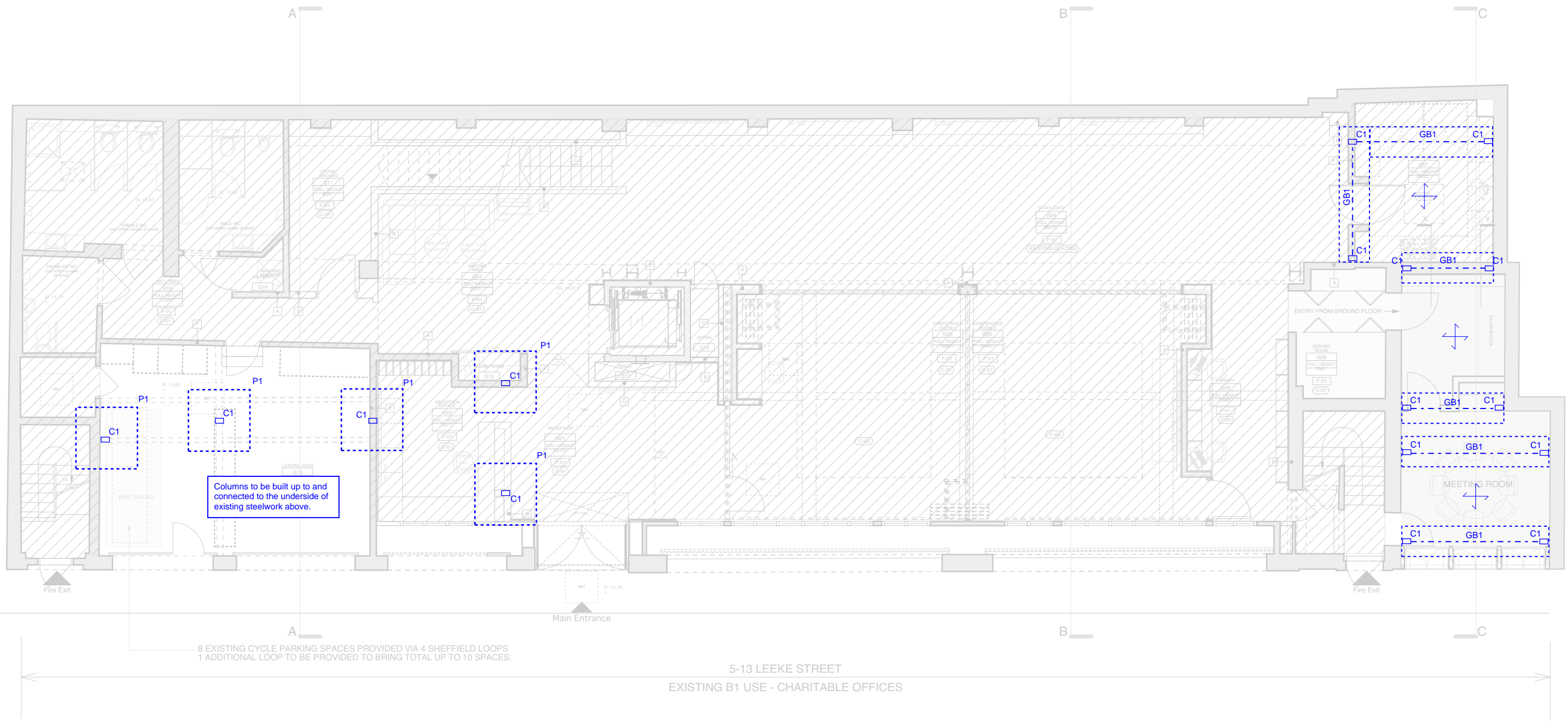

**NOT FOR CONSTRUCTION**

Rev	Date	Description	Drawn	Check
Drawing Status		PRELIMINARY	Project No	
Date		20.08.2019	180832	
Scale		1:100 @ A3	Drawing No	
Engineer		JL	180832-SK-S-100	
Revision		P1	Revision	

**conisbee**  
 Consulting Structural Engineers  
 Consulting Civil Engineers

1-5 Offord St  
 London N1 1DH  
 Tel 020 7700 6666  
 Fax 020 7700 6686  
 design@conisbee.co.uk  
 www.conisbee.co.uk

Project  
**5-13 Leeke Street**

Title  
**GROUND FLOOR PLAN**