

NOTE: ALL interior and exterior aspects, including the windows, the doors, internal surfaces, floorboards, plasterwork, dados, fireplaces, skirting boards, cornices are to remain unaltered

All plasterwork, cornices, etc, will remain unaltered.
Any damaged plaster to be repaired with lime plaster

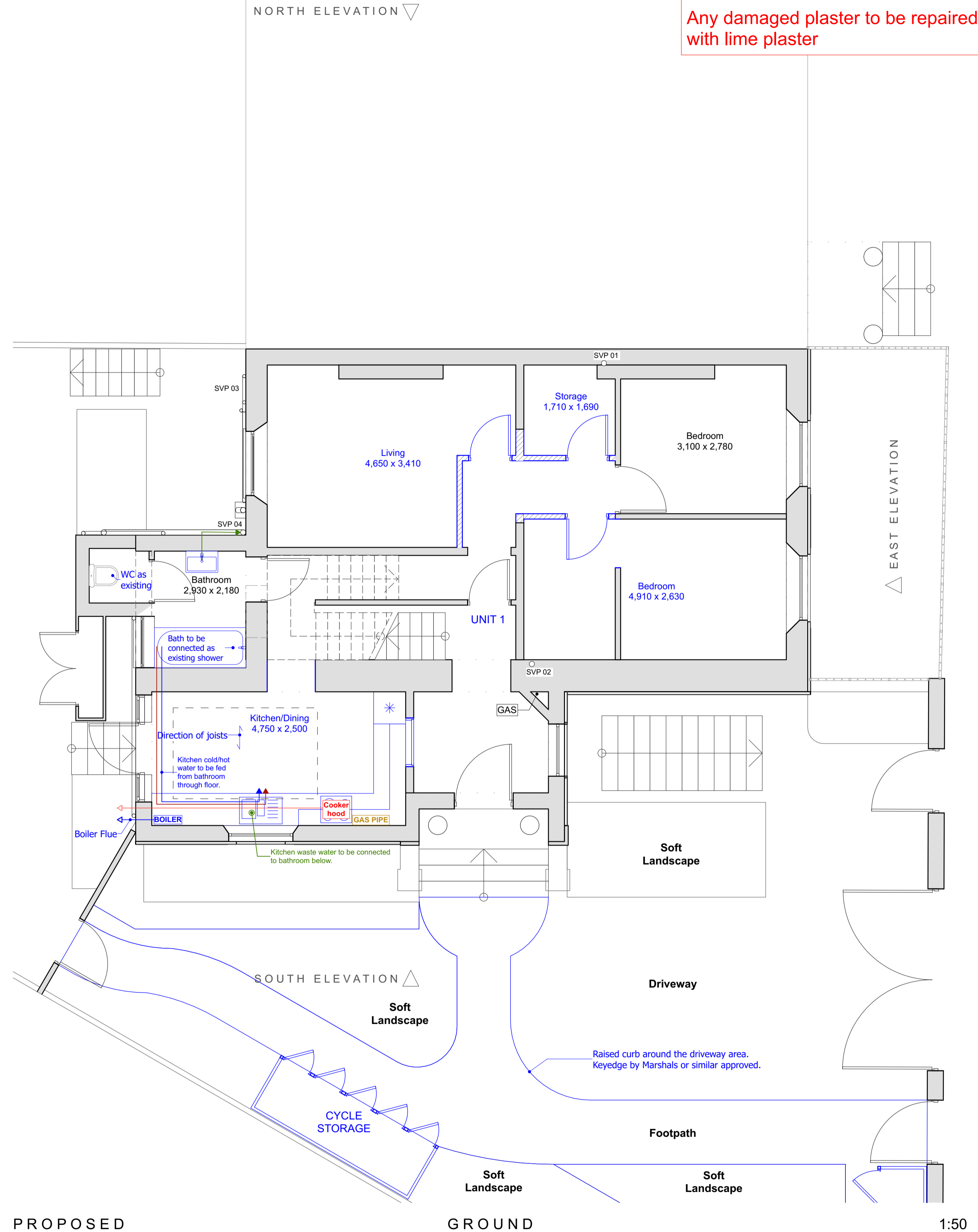
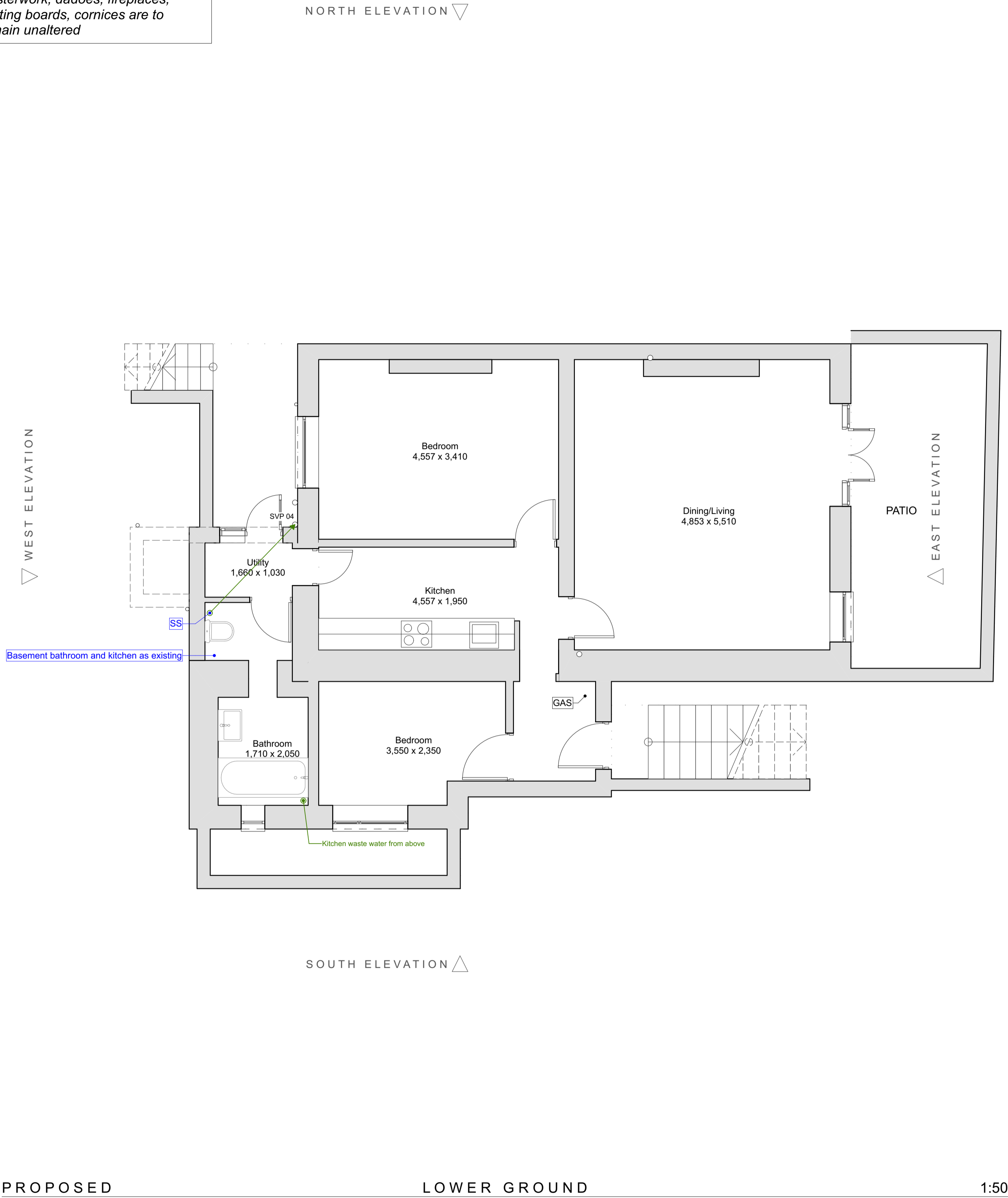

PROPOSED LOWER GROUND 1:50

PROPOSED GROUND 1:50

Looking to extend your home?
Call for a free consultation today;
020 8954 6291
www.yooparchitects.co.uk
YOOP Architects, your local architect

Existing
 To be demolished
 New

	Office 128, 28A Church Road, Stanmore, Middlesex, HA7 4AW, England 020 8954 6291 studio@yooparchitects.co.uk	Notes This drawing is copyright of YOOP Architects. Drawing for planning purposes, not construction	Scale Bar 	Scale 1:50 @ A1 1:100 @ A3	Purpose of Issue FEASIBILITY	Client #Client Full Name	Project 70 OAKLEY SQUARE 70 OAKLEY SQUARE LONDON NW1 1NJ UK	Project No. 2019/	Layout Title PROPOSED BASEMENT & GROUND FLOOR	Drawing Number 000/PL/201	Revision C