

ISO A1 594mm x 841mm
Approved:
Checked:
Designer:
Project Management Initials:
Last saved by: MIKE NEWTON (2019.08.09) Last Picked: 2019.08.09
Filename: U:\2016\MIDDLESEX HOSPITAL ANNEXE\AECOM\ISSUE RECORDS\DATE ISSUED\190809_NORTH HOUSE, SOUTH HOUSE & WORKHOUSE CONSTRUCTION\ISSUE\WORKHOUSE\MHA-ACM-WH-XX-DE-S-00008.DWG



EXTERNAL WORKHOUSE WALL.
REAR ELEVATION.
1:100

NOTE

NON-STRUCTURAL FACADE TREATMENT, INCLUDING MORTAR POINTING BRICKWORK AND STONE CLEANING, IS OUTSIDE AECOM'S REMIT OF RESPONSIBILITY, SINCE IT IS ASSOCIATED WITH THE EXTERNAL ENVELOPE / FACADES. REFER TO THE ARCHITECT'S SPECIFICATION.
NEW OUTER 103mm BRICKWORK SKIN REBUILT IN AN HYDRAULIC LIME MORTAR. PENDING INSPECTION OF THE TRIAL PANEL OPENING, CONFIRMATION FROM CAMDEN PLANNING AND A LIME MORTAR SPECIALIST SUPPLIER AND AGREEMENT ON SITE, ALLOW FOR ;

BED JOINTS, BACKING JOINTS AND PERPENDS - NHL 3.5 (MODERATELY HYDRAULIC) LIME MORTAR. MIX RATIO (LIME / SAND (VOL/VOL)) = 1:2.25.

POINTING - AS PER THE BEDDING MORTAR, PENDING CONFIRMATION FROM LIME MORTAR SPECIALIST SUPPLIER AND CONFIRMATION FROM THE ARCHITECT.

KEY

WALL INFILL. DENOTES INDICATIVE AREAS OF EXISTING VOIDS TO BE INFILLED IN BLOCKWORK. (SEE DETAILS OPPOSITE) REFER TO ARCHITECTS DRAWINGS FOR FURTHER DETAILS.

DENOTES INDICATIVE AREA OF EXISTING BRICKWORK TO BE RE-FACED. (SEE DETAILS BELOW) REFER TO ARCHITECTS DRAWINGS FOR FURTHER DETAILS.

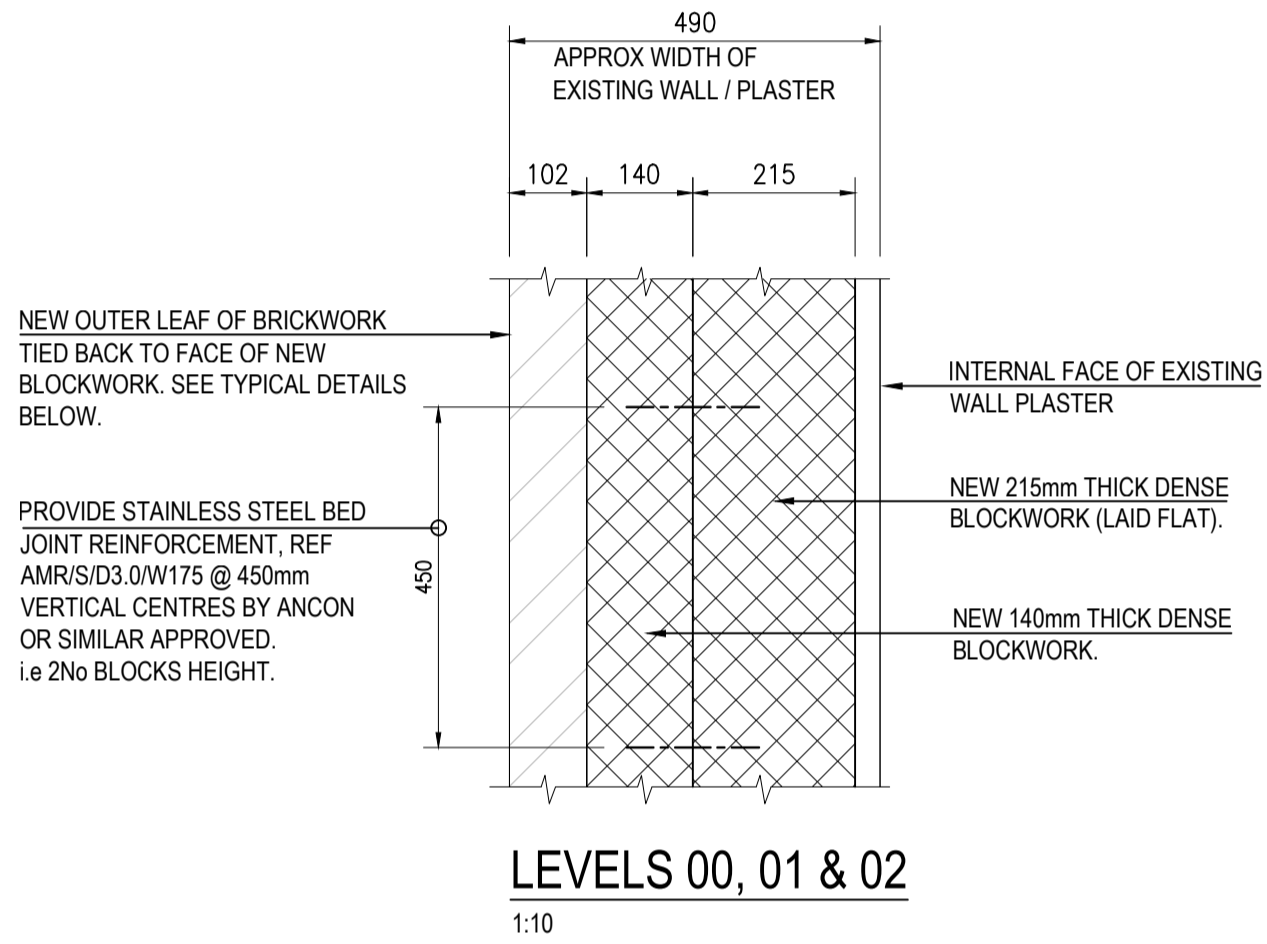
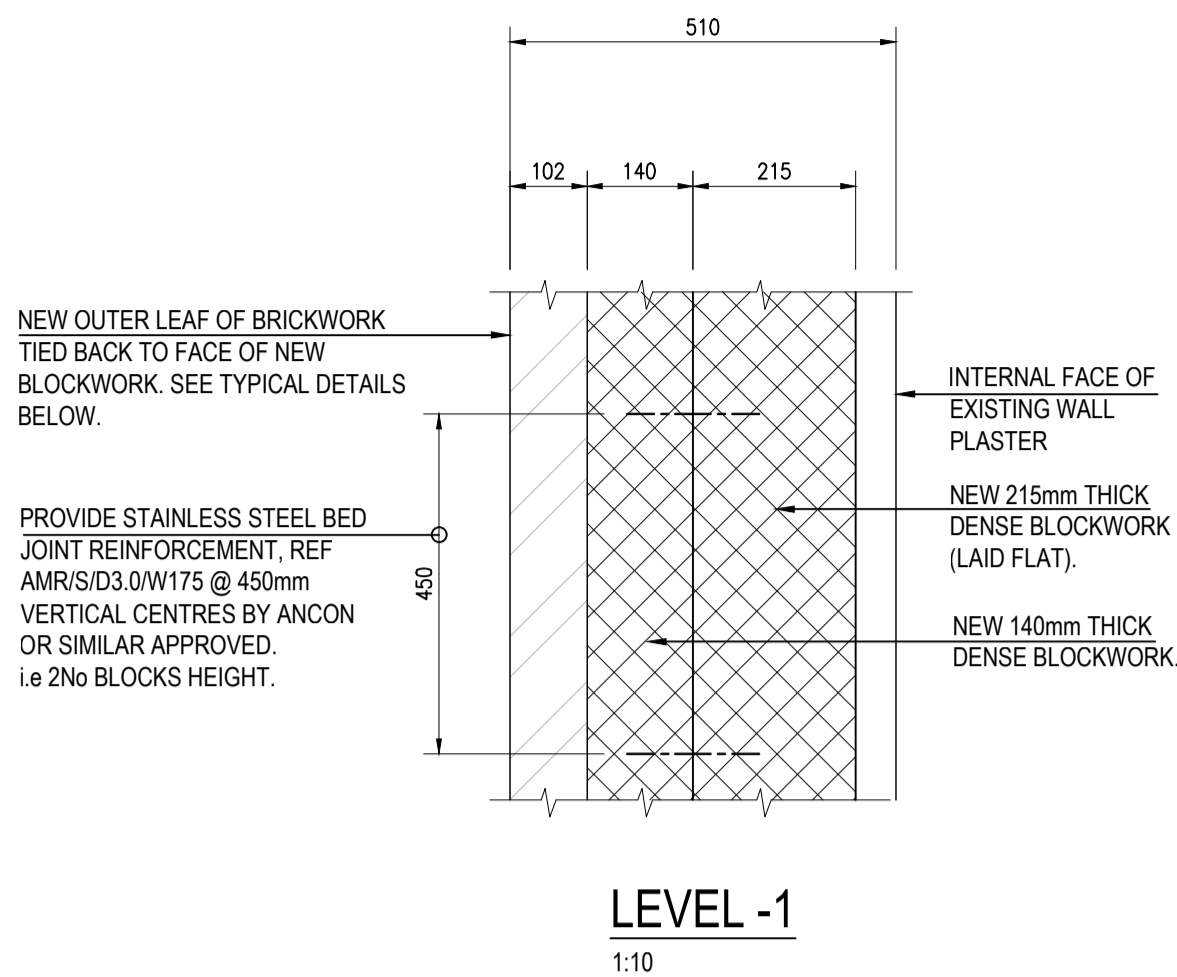
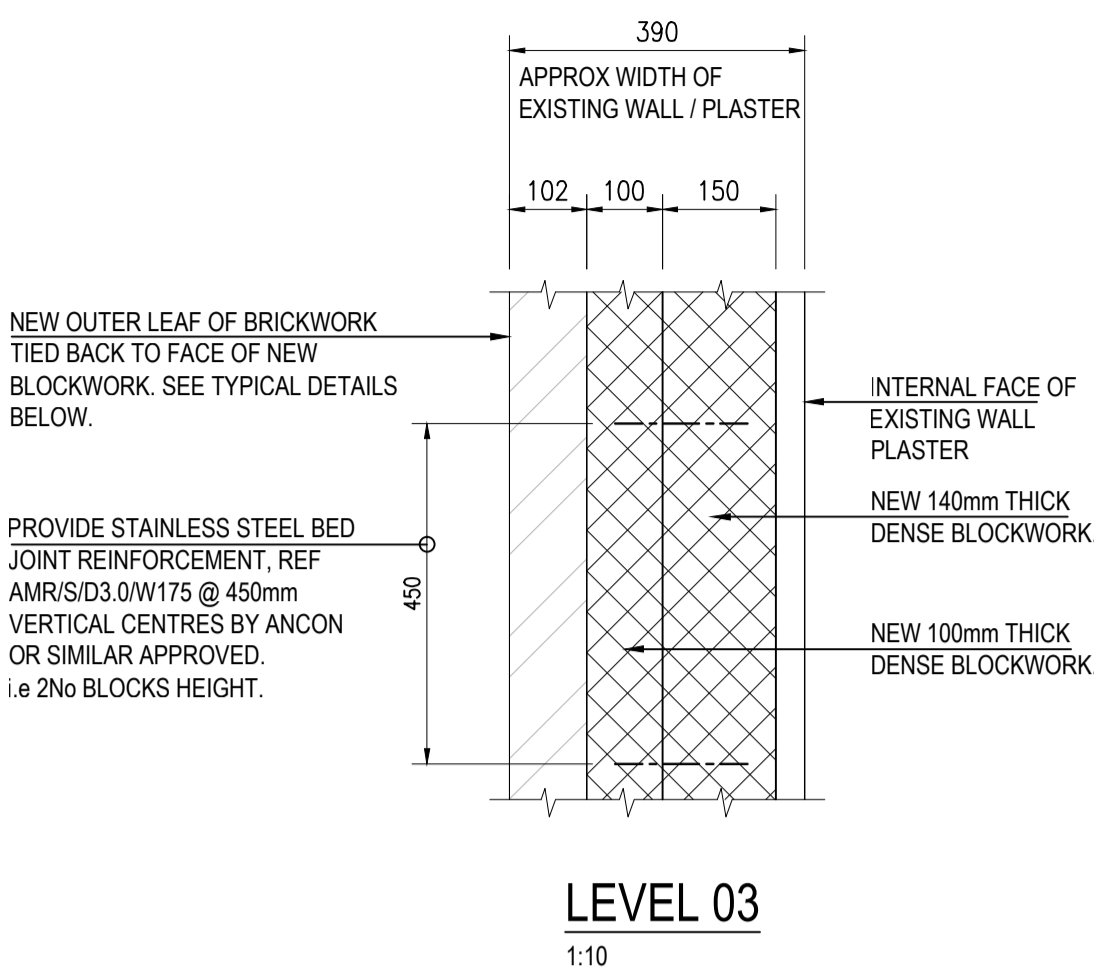

TYPICAL WALL INFILL DETAILS

NOTE.
THE THICKNESS OF THE EXISTING WALLS TO THIS ELEVATION MAY VARY FROM THOSE INDICATED. CONTACT S/ENG. WHERE THICKNESSES ARE DIFFERENT, TO CONFIRM BLOCKWORK SIZES REQUIRED.

NOTE.
ENDS OF NEW BLOCK WALLS TO BE FIXED TO EXISTING MASONRY USING STAIFIX WALL STARTER SYSTEM BY ANCON OR SIMILAR APPROVED

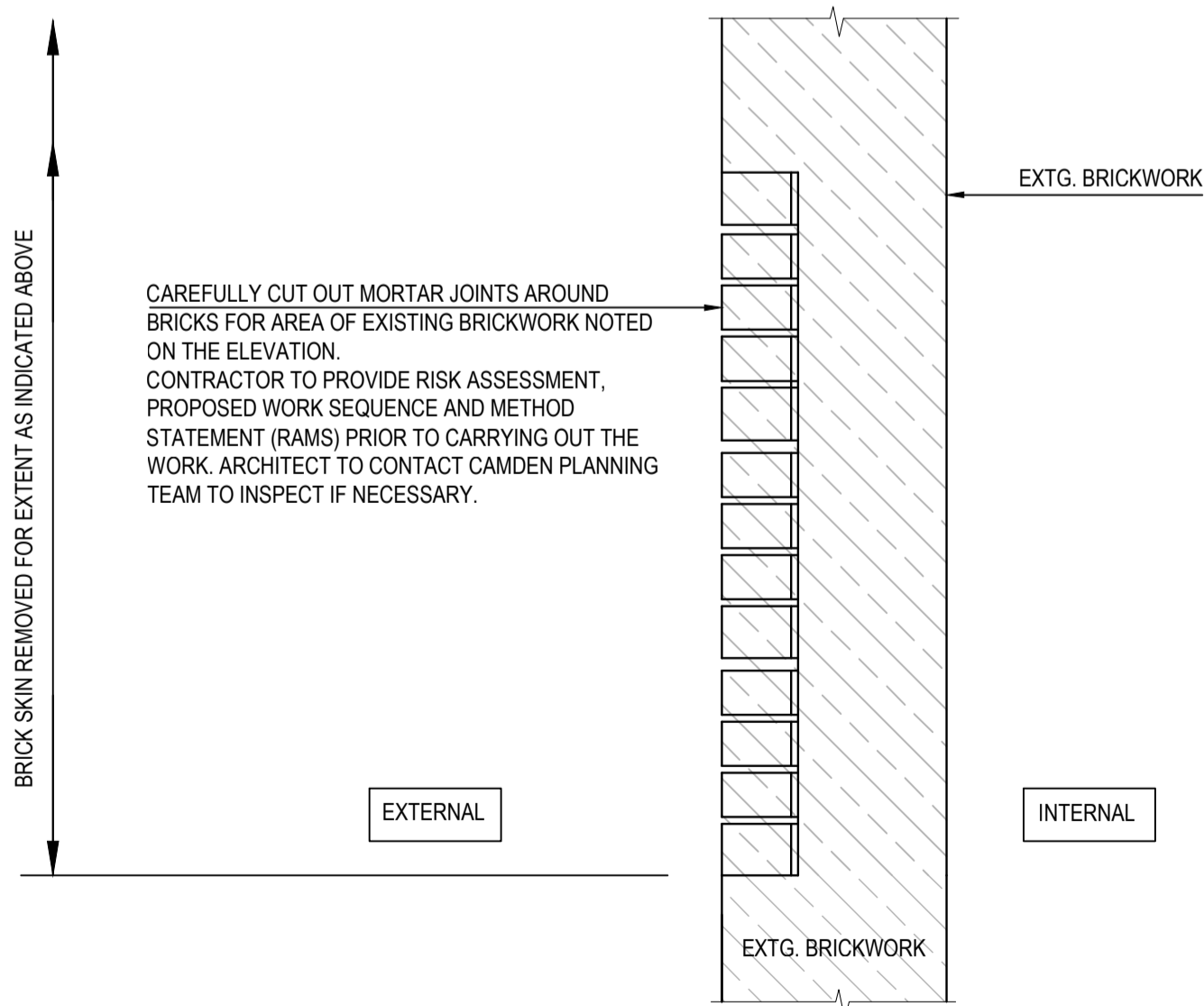

TYPICAL SECTION A - A
THROUGH EXT. WALL
STAGE 1
1:10

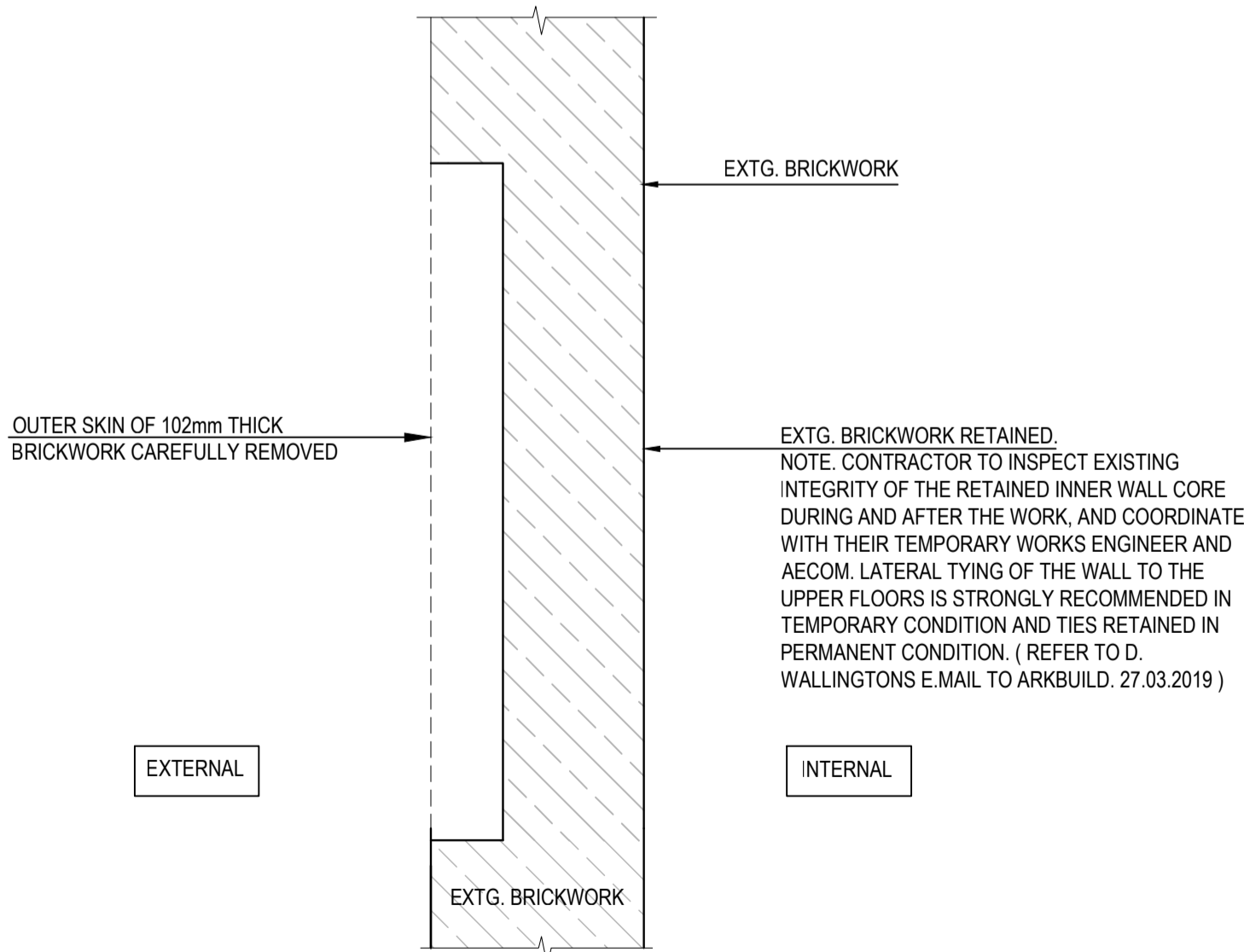

SECTION A - A
STAGE 2
1:10

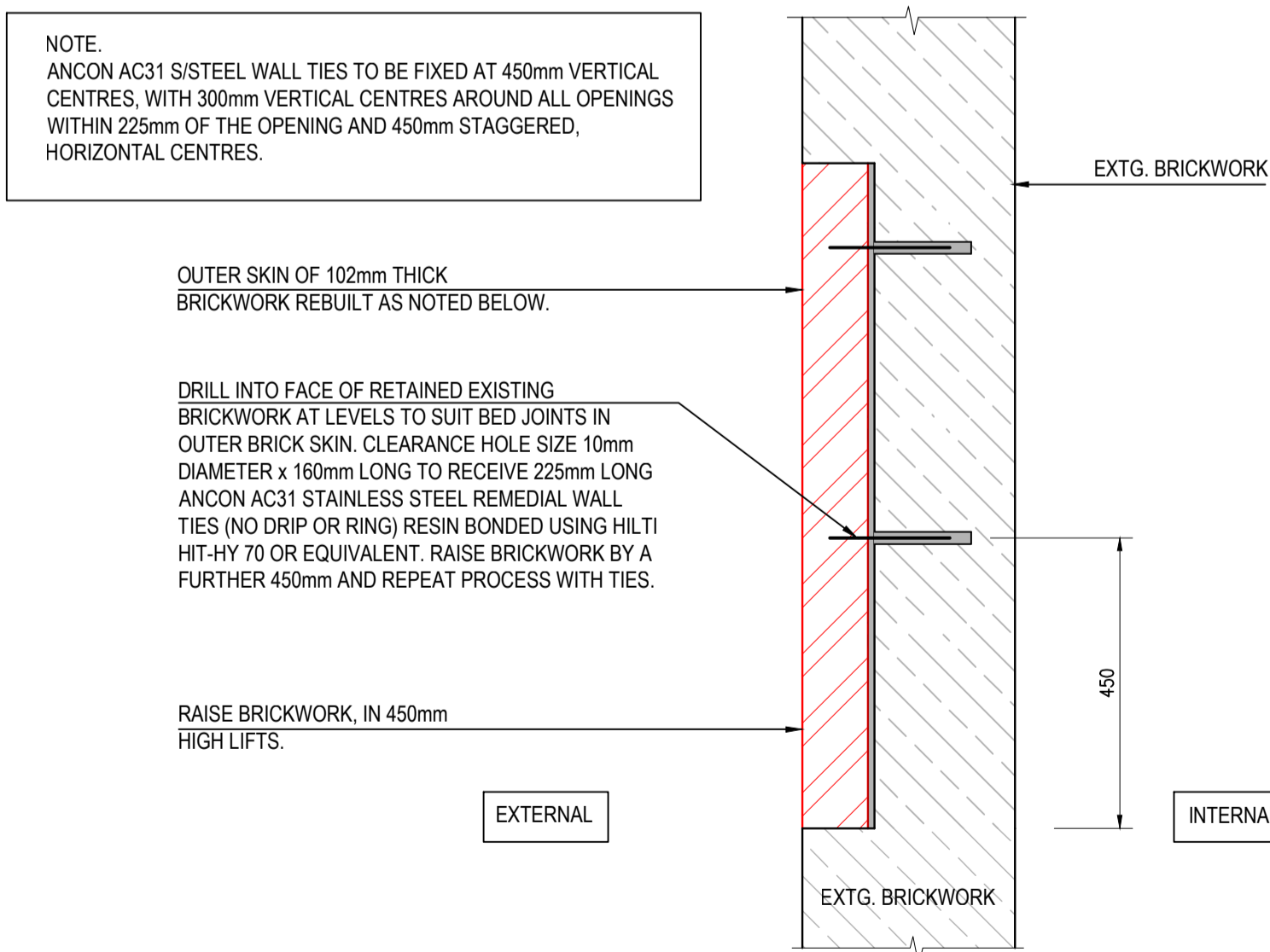

SECTION A - A
STAGE 3
1:10

BRICKWORK RE-FACING DETAILS

AECOM

PROJECT

BEDFORD PASSAGE DEVELOPMENT

CLIENT

MIDDLESEX ANNEXE LLP

CONSULTANT

AECOM
Aldgate Tower
2 Leman Street
London. E1 8FA
www.aecom.com

GENERAL NOTES

1. FOR GENERAL NOTES REFER TO DRAWING No. MHA-ACM-XX-XX-GN-S-00001

ISSUE/REVISION

C/I	DATE	DESCRIPTION
C1	09.08.2019	CONSTRUCTION ISSUE
I/R		

KEY PLAN

PROJECT NUMBER

60516144

SHEET TITLE

EXTERNAL WALL REMEDIAL WORKS TO WORKHOUSE.

SHEET NUMBER

MHA-ACM-WH-XX-DE-S-00008

This drawing has been prepared for the use of AECOM's client. It may not be used, modified, reproduced or relied upon by third parties, except as agreed by AECOM or as required by law. AECOM accepts no responsibility, and denies any liability whatsoever, to any party that uses or relies on this drawing without AECOM's express written consent. All measurements must be obtained from the stated dimensions.