

**GENERAL NOTES AWW:**

**EXTERNAL WALLS:**  
EXISTING EXTERNAL BRICK WALLS TO BE RETAINED, CLEANED AND MADE GOOD. REPLACED WHERE DAMAGED. REFER TO NBS SPEC C41, C40 FOR REPOINTING AND CLEANING OF BRICKWORK AND CONTRACTOR'S METHOD STATEMENT.

ALL GUTTERS AND DOWNPIPES TO BE REMOVED AND REPLACED WITH CAST IRON FIXTURES AND FITTINGS WITH BLACK PROTECTIVE COATING FINISH, HAMMERITE OR EQUAL APPROVED. ALL AS NBS SPECIFICATION R10 AND M60175A.  
REFER TO SCHEDULE AND RECORDS OF WORKS FOR SCOPE OF REPAIRS TO CORNICES, PARAPETS

SILLS AND RENDERED PLINTHS AND DOWNPIPES. M20 AND R10.

**ROOFING:**  
REFER TO SAFE ACCESS STRATEGY DRAWINGS FOR PROPOSED MAINTENANCE ACCESS. REFER TO SE DRAWINGS FOR FULL DETAILS OF ROOF + FLOOR STRUCTURAL CONNECTIONS

**EXTERNAL DOORS:**  
TEMPORARY DOORS TO BE INSTALLED WHERE REQUIRED

**WINDOWS:**  
EXISTING WINDOWS REMOVED AND REPLACED WITH NEW PAINTED TIMBER FRAMED SINGLE OR DOUBLE GLAZED SASH WINDOWS AND SILLS -

TO BE MEASURED ON SITE BY PREFERRED MANUFACTURER TO FIT EXISTING STRUCTURAL OPENINGS. REFER TO WINDOW SCHEDULE SERIES A-25 2000 AND WINDOW DRWG SERIES A-25 3000 FOR DETAILS AND NBS SPEC L10, L40.  
ARCHITECT'S APPROVAL OF APPEARANCE AND QUALITY CONTROL SAMPLE TO BE OBTAINED PRIOR TO PROCEEDING WITH MANUFACTURER OF REMAINING QUANTITY.  
ALL BASEMENT SLABS NEW UNLESS INDICATED ON DRAWINGS. REFER TO STRUCTURAL ENGINEER'S DRAWINGS AND DETAILS.

**Notes**

- All dimensions to be checked on site
- Do not scale off this drawing
- All dimensions are shown in mm unless otherwise stated
- Refer to drawing issue sheet for purpose of issue
- If in doubt ask
- © Llewelyn Davies

**Key plan**

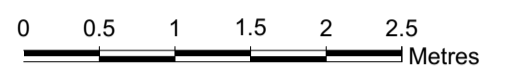
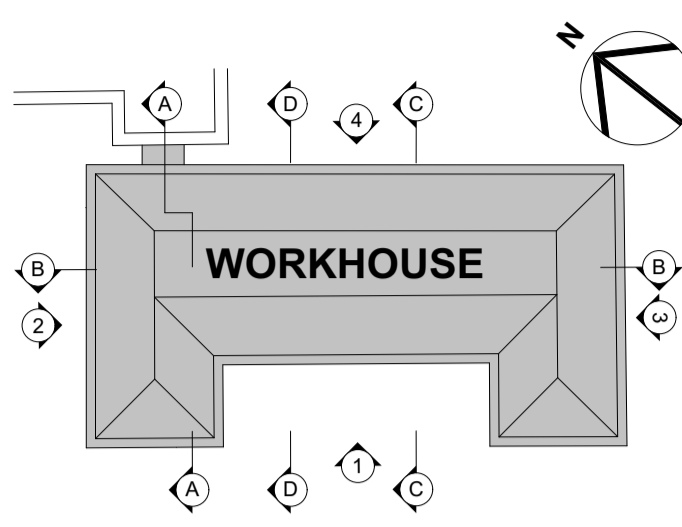

**LEGEND:**

- F10/230A AND F10/315 NEW BRICK INFILLS
- F10/230A NEW BRICKWORK TO SE DESIGN
- RETAINED EXISTING BRICKWORK REFER TO DEMOLITION PACKAGE
- H62/110A ROOF SLATING WITH COUNTERBATTENS
- F30/766 NEW CAST STONE COPING UNITS
- NEW CONCRETE RETAINING WALL TO STRUCTURAL ENGINEER'S DESIGN
- M20/160A RENDER SYSTEM
- F10/255 NEW BLOCKWORK INFILLS
- BUILDING DEMARCATION LINE
- J10/110A LIQUID APPLIED WATERPROOFING MEMBRANE
- J10/110A LIQUID APPLIED WATERPROOFING MEMBRANE: UP TO 1200MM ABOVE EXTERNAL GROUND LEVEL
- J40/290A & 290B WATERPROOFING MEMBRANE
- J40/290A AND 290B WATERPROOFING MEMBRANE: UP TO 1200MM ABOVE EXTERNAL GROUND LEVEL
- M10/110A WATERPROOFING MEMBRANE: UP TO 500MM ABOVE DPC LEVEL
- J31/130 LIQUID APPLIED WATERPROOFING SYSTEM: NORTH HOUSE PODIUM
- J10/110B WATERPROOFING MEMBRANE TO SOUTH HOUSE TUNNEL SLAB
- J40/297A TANKING TO OUTER FACE OF NEW CONCRETE WALL
- R10/390 CAST IRON PIPEWORK
- VENT PIPE FROM BELOW TO ATMOSPHERE. REFER TO ARUP DRAWINGS FOR MORE INFORMATION
- DENOTES LEVEL
- IP CAVITY DRAIN INSPECTION PORT AS J40/290A & B
- DENOTES CHEMICAL INJECTION DPC SYSTEM. (STEPPED DPC BY 75MM RISERS)
- SJ F30/610A SEALANT JOINT
- WB J40/298A+B HYDROPHYLIC WATER BAR

**NOTE:**

- ALL LEADWORK TO BE IN ACCORDANCE WITH LSA PUBLICATION 'ROLLED SHEET LEAD-THE COMPLETE MANUAL'
- DRAWINGS TO BE READ IN CONJUNCTION WITH SPECIFICATION & FINISHES SCHEDULE OF WORKS/ MATERIALS & WORKMANSHIP/ MEP & SE DRAWINGS.
- CONTRACTOR TO CONFIRM ALL (MINIMUM AND MAXIMUM) SITE DIMENSIONS WHERE SHOWN AS "SITE DIM" TO ASSIST WITH SECURING BUILDING CONTROL APPROVAL. FOR ALL STRUCTURAL INFORMATION REFER TO AECOM DRAWING PACKAGE.
- FOR ALL MEP INFORMATION REFER TO ARUP DRAWING PACKAGE.
- LEVELS ARE BASED ON GREENHATCH GROUP'S SURVEYED 'IFL' AND 'FL' LEVELS.
- NO WORKS TO COMMENCE ON SITE WITHOUT NOTIFICATION TO LONDON BOROUGH OF CAMDEN AND RECEIVING WRITTEN APPROVAL.
- REFER TO SURVEY DRAWINGS ETC.
- ALL DIMENSIONS TO BE CHECKED ON SITE.

Rev	Description	Date	By	Chk
C1	For Contract AWW	08/08/19	ZL	JD

Structural Consultant: **AECOM** Services Consultant: **ARUP**

Cost Consultant: **EQUALS CONSULTING**

Project Title: **BEDFORD PASSAGE DEVELOPMENT WORKHOUSE (OLIVER HOUSE)**

Client: **MIDDLESEX ANNEXE LLP**

Drawing Title: **WORKHOUSE AWW - LEVEL 01 PLAN**

Project Number: **LD15 078.00** Revision: **C1**

Drawing Number: **BPD-LDW-WH-01-DR-A-250003**

Scale @ A1: **1:50** Date: **21/08/2018**

Architects: **LLEWELYN DAVIES**

Architects | Planners | Designers  
3rd floor | 3-5 Rathbone Place | London | W1T 1JH  
T +44(0)20 7907 7900 | E london@ldavies.com  
www.ldavies.com

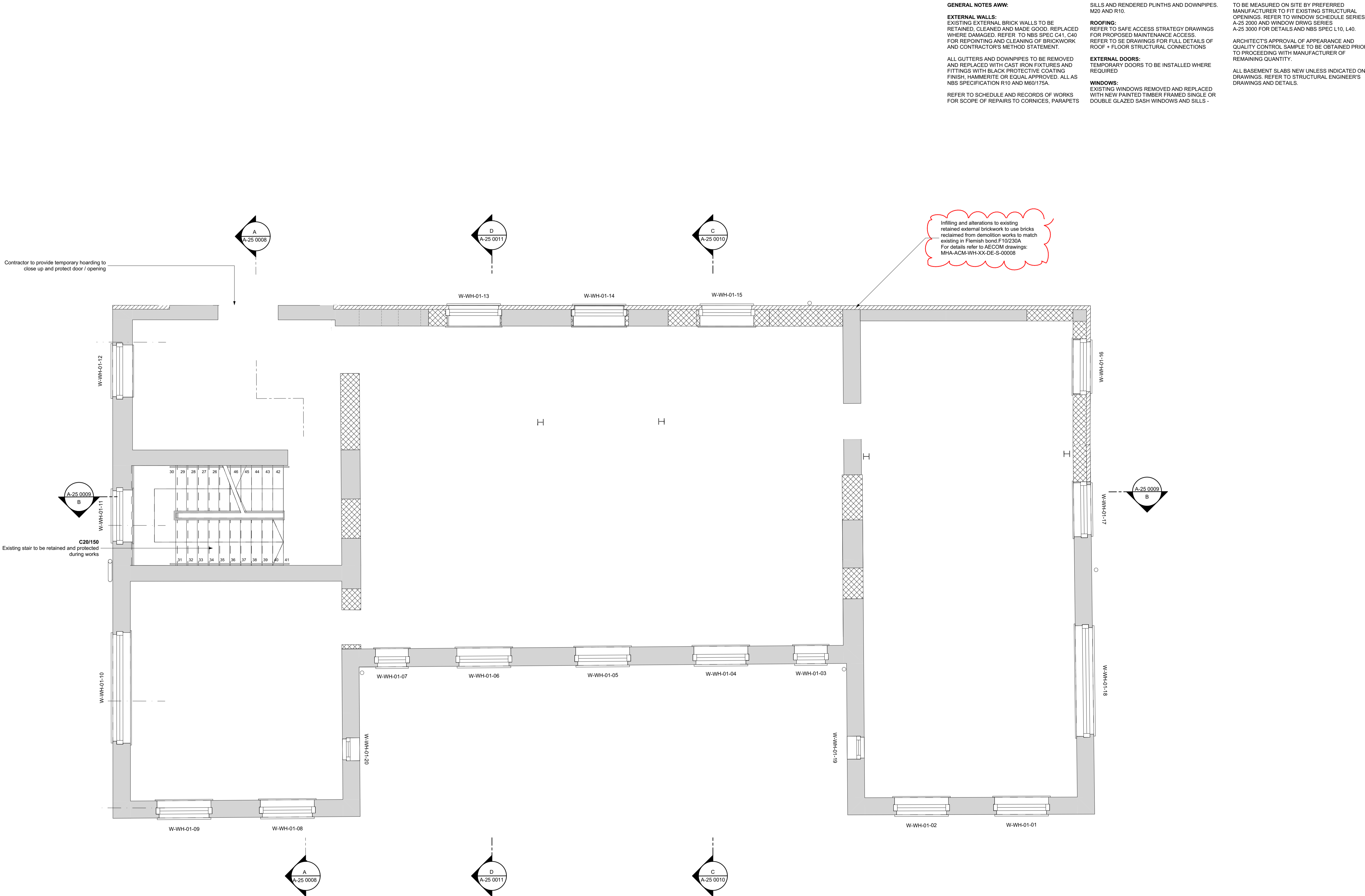

Contractor to provide temporary hoarding to close up and protect door / opening

Existing stair to be retained and protected during works

Infilling and alterations to existing retained external brickwork to use bricks reclaimed from demolition works to match existing in Flemish bond. F10/230A For details refer to AECOM drawings: MHA-ACM-WH-XX-DE-S-00008