

High Holborn House

1 High Holborn House Proposed Basement
Scale: 1:100

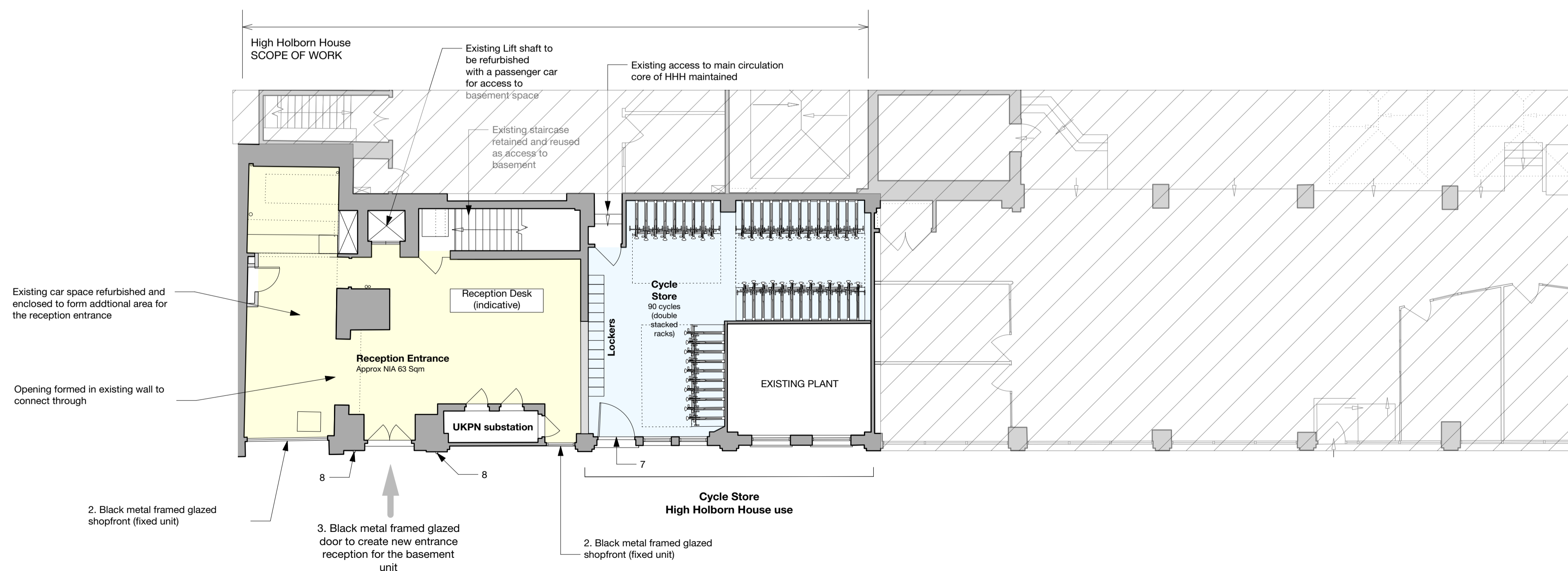

2 High Holborn House Proposed Ground Floor
Scale: 1:100

GENERAL NOTES:

All dimensions to be checked on site prior to commencement of any works, and/or preparation of any shop drawings.

Sizes of and dimensions to any structural elements are indicative only. See structural engineers drawings for actual sizes / dimensions.

Sizes of and dimensions to any service elements are indicative only. See service engineers drawings for actual sizes and dimensions.

This drawing to be read in conjunction with all other Architect's drawings, specifications and other Consultants' information.

All proprietary systems shown on this drawing are to be installed strictly in accordance with the Manufacturers/Suppliers recommended details.

Any discrepancies between information shown on this drawing and any other contract information or manufacturers/suppliers recommendations is to be brought to the attention of the Architect

DO NOT SCALE FROM THIS DRAWING.

NOTES:

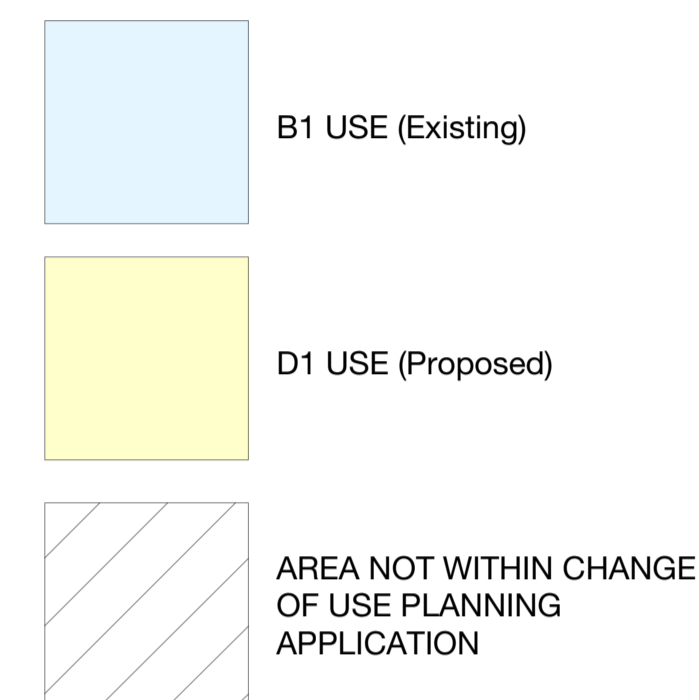

Material Key:

1. Black Metal Stall Riser
2. Black Metal Frame Glazed Shop Front
3. Black Metal Framed Glazed Door
4. Black Metal overpanel to door with signage zone.
5. Wall mounted framed fin signage.
6. Existing wall finish to be overhauled & repainted as existing.
7. New metal door to cycle store.
8. Wall mounted external light .

REVISION DATE

Buckley Gray Yeoman

Studio 4.04 The Tea Building 56 Shoreditch High Street
London E1 6JJ T: 020 7033 9913 F: 020 7033 9914

CLIENT
SRG Holborn Limited

PROJECT
High Holborn House

DRAWING
High Holborn House
Proposed Ground & Basement
Floor Plans

SCALE
1:100 @ A1 (1:200 @ A3)

DATE
Jul 2019

DRAWN BY
JR

DWG No.
975_HHH-GA-00

REVISION
P1

DRAWING STATUS
PLANNING

