

I EXISTING - BASEMENT FLOOR PLAN
01-099 1:100

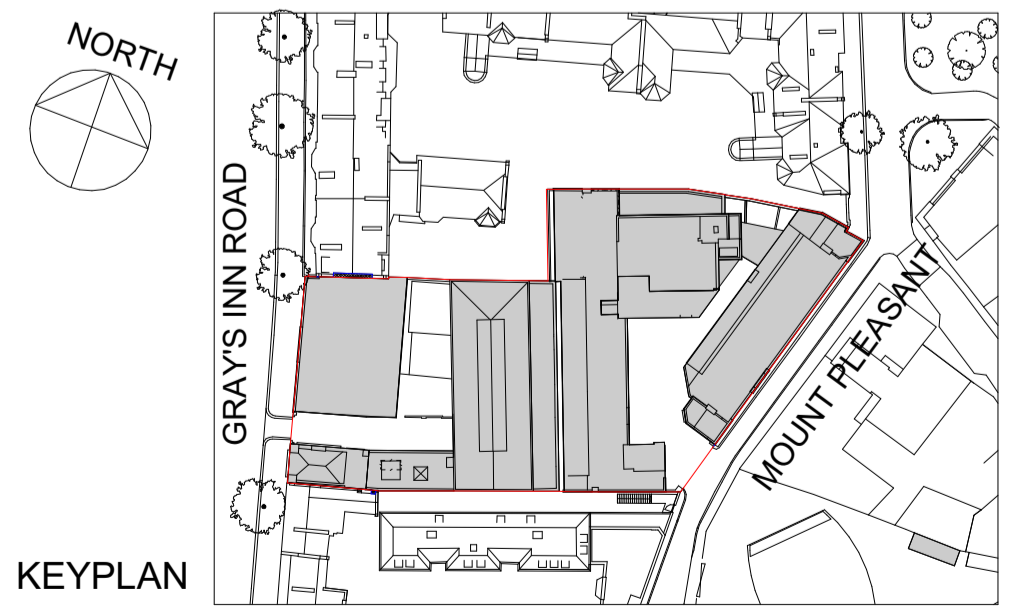
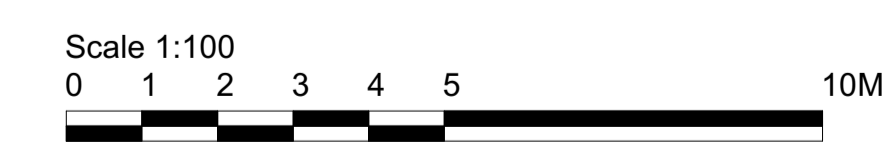

Important note
All dimensions in millimetres. Where dimensions are not given, drawings must not be scaled and the matter referred back to Veretec Limited.
All dimensions and conditions are to be checked on site by the contractor prior to preparing drawings or commencing any work. The contractor is responsible for checking that there is no conflict between site dimensions and drawn dimensions.
In the event of any detail or dimensional conflict between Veretec Limited drawings, the matter must be referred back to Veretec Limited for clarification.

A	12-08-2019	FOR PLANNING	AA/SM	RM
Rev	Date	Issued for	By	Authorised

ESTUDIO CANO LASSO
ARQUITECTOS
Guecho, 29 Madrid 28023
estudio@canolasso.com
tel +34 91 307 70 73
mov +34 606 34 93 64
www.canolasso.com

Veretec Ltd
10 Bonhill Street
London EC2A 4PE
+44 (0)20 7843 3199
london@veretec.co.uk
www.veretec.co.uk



Client
PANTHER HOUSE DEVELOPMENTS LTD
Project
PANTHER HOUSE
Date
12/08/19
Drawn
AA
Checked
RM
Authorised
JA

Title
EXISTING - BASEMENT FLOOR PLAN
Scale
1:100@A1

Issue Status
FOR PLANNING
Drawing Number
21835-01-099
Client Drawing Number
Rev
A

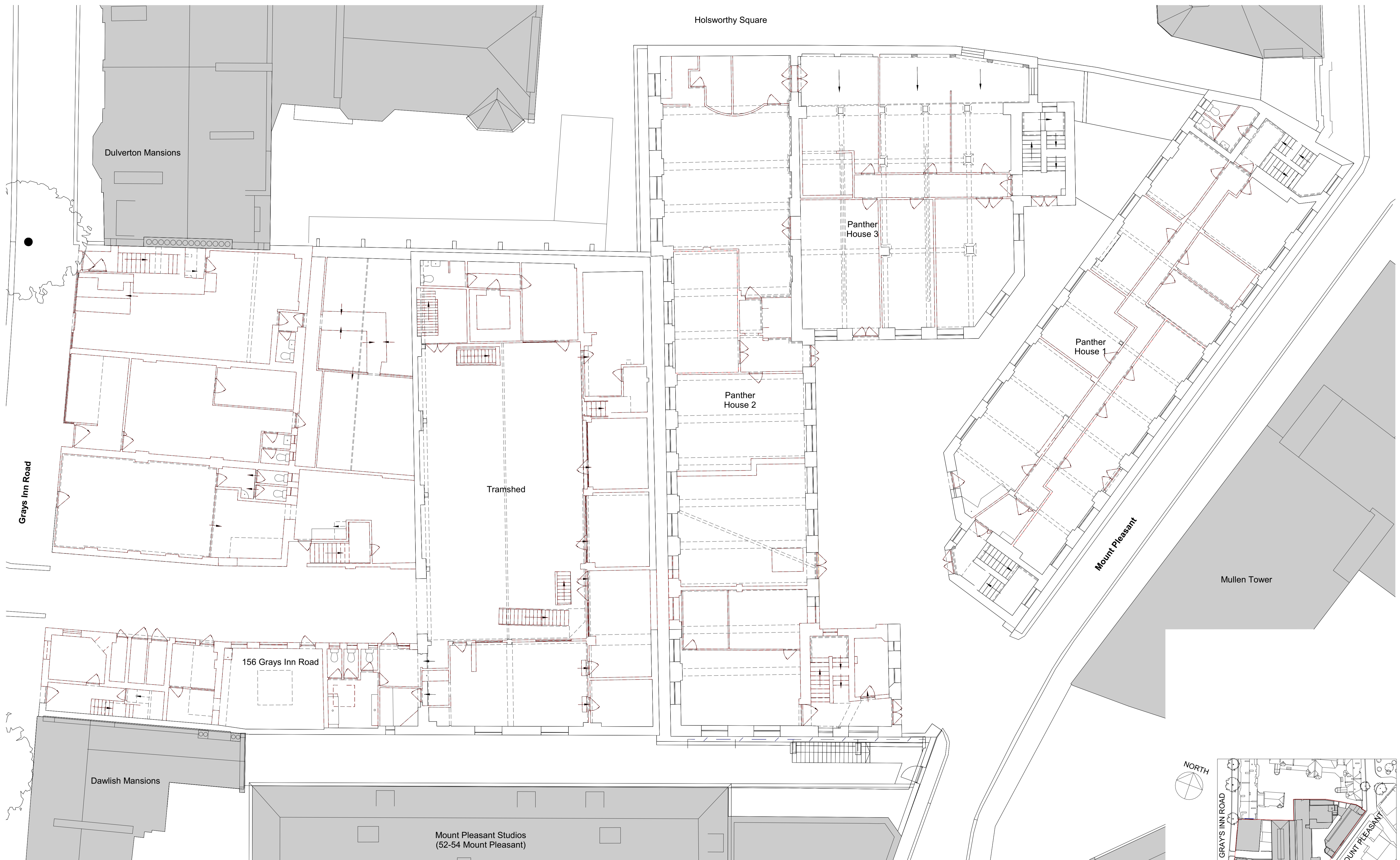

1 EXISTING - GROUND FLOOR PLAN
01-100 1:100

Scale 1:100
0 1 2 3 4 5 10M
KEYPLAN

Important note
All dimensions in millimetres. Where dimensions are not given, drawings must not be scaled and the matter referred back to Veretec Limited.
All dimensions and conditions are to be checked on site by the contractor prior to preparing drawings or commencing any work. The contractor is responsible for checking that there is no conflict between site dimensions and drawn dimensions.
In the event of any detail or dimensional conflict between Veretec Limited drawings, the matter must be referred back to Veretec Limited for clarification.

A	12-08-2019	FOR PLANNING	AA/SM	RM
Rev	Date	Issued for	By	Authorised

ESTUDIO CANO LASSO
ARQUITECTOS
Guecho, 29 Madrid 28023
estudio@canolasso.com
tel +34 91 307 70 73
mov +34 606 34 93 64
www.canolasso.com

Veretec Ltd
10 Bonhill Street
London EC2A 4PE
+44 (0)20 7843 3199
london@veretec.co.uk
www.veretec.co.uk

veretec
ESTUDIO CANO LASSO
ARQUITECTOS

Client
PANTHER HOUSE DEVELOPMENTS LTD
Project
PANTHER HOUSE
Date
12/08/19
Drawn
AA
Checked
RM
Authorised
JA

Title
EXISTING - GROUND FLOOR PLAN
Scale
1:100@A1

Issue Status
FOR PLANNING
Drawing Number
21835-01-100
Client Drawing Number

Rev
A

Holworthy Square

Dulverton Mansions

Panther House 3

Panther House 1

Panther House 2

Tramshed

Mullen Tower

156 Grays Inn Road

Dawlish Mansions

Mount Pleasant Studios
(52-54 Mount Pleasant)

1 EXISTING - FIRST FLOOR PLAN

01-101 1:100

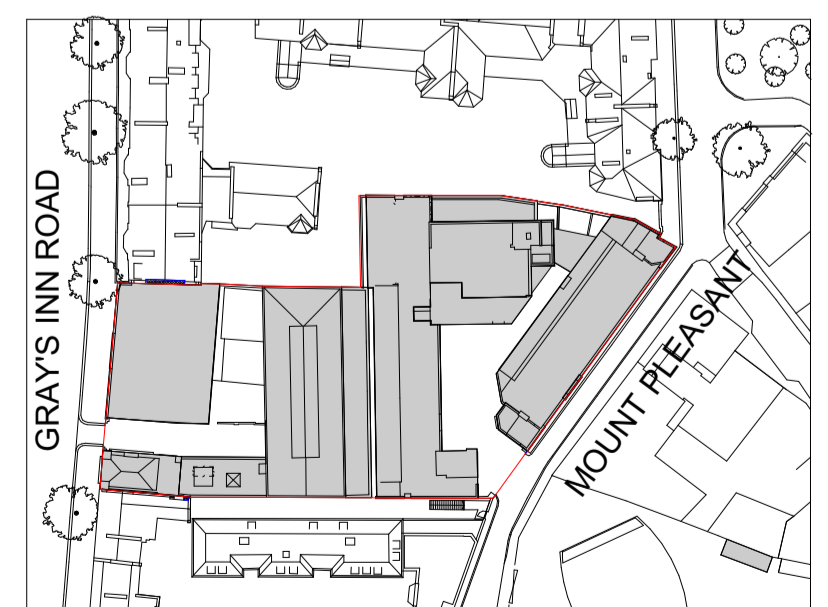
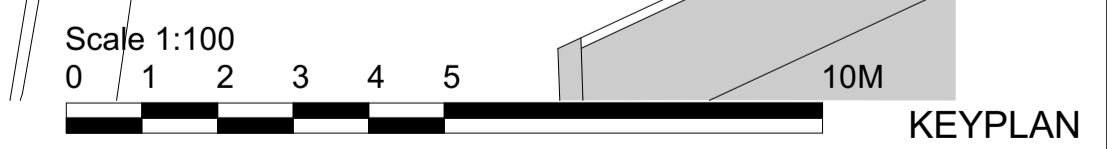

Important note
All dimensions in millimetres. Where dimensions are not given, drawings must not be scaled and the matter referred back to Veretec Limited.
All dimensions and conditions are to be checked on site by the contractor prior to preparing drawings or commencing any work. The contractor is responsible for checking that there is no conflict between site dimensions and drawn dimensions.
In the event of any detail or dimensional conflict between Veretec Limited drawings, the matter must be referred back to Veretec Limited for clarification.

A	12-08-2019	FOR PLANNING	AA/SM	RM
Rev	Date	Issued for	By	Authorised

ESTUDIO CANO LASSO
ARQUITECTOS
Guecho, 29 Madrid 28023
estudio@canolasso.com
tel +34 91 307 70 73
mov +34 606 34 93 64
www.canolasso.com

Veretec Ltd
10 Bonhill Street
London EC2A 4PE
+44 (0)20 7843 3199
london@veretec.co.uk
www.veretec.co.uk

veretec
ESTUDIO CANO LASSO
ARQUITECTOS

Client
PANTHER HOUSE DEVELOPMENTS LTD
Project
PANTHER HOUSE
Date
12/08/19
Drawn
AA
Checked
RM
Authorised
JA

Title
EXISTING - FIRST FLOOR PLAN
Scale
1:100@A1

Issue Status
FOR PLANNING
Drawing Number
21835-01-101
Client Drawing Number

Rev A



1 EXISTING - SECOND FLOOR PLAN
1:100

Important note
All dimensions in millimetres. Where dimensions are not given, drawings must not be scaled and the matter referred back to Veretec Limited.
All dimensions and conditions are to be checked on site by the contractor prior to preparing drawings or commencing any work. The contractor is responsible for checking that there is no conflict between site dimensions and drawn dimensions.
In the event of any detail or dimensional conflict between Veretec Limited drawings, the matter must be referred back to Veretec Limited for clarification.

A	12-08-2019	FOR PLANNING	AA/SM	RM
Rev	Date	Issued for	By	Authorised

ESTUDIO CANO LASSO
ARQUITECTOS
Guecho, 29 Madrid 28023
estudio@canolasso.com
tel +34 91 307 70 73
mov +34 606 34 93 64
www.canolasso.com

Veretec Ltd
10 Bonhill Street
London EC2A 4PE
+44 (0)20 7843 3199
london@veretec.co.uk
www.veretec.co.uk



Client
PANTHER HOUSE DEVELOPMENTS LTD
Project
PANTHER HOUSE
Date
12/08/19
Drawn
AA
Checked
RM
Authorised
JA

Title
EXISTING - SECOND FLOOR PLAN
Scale
1:100@A1

Issue Status FOR PLANNING
Drawing Number 21835-01-102
Client Drawing Number
Rev A



1 EXISTING - THIRD FLOOR PLAN
01-103 1:100

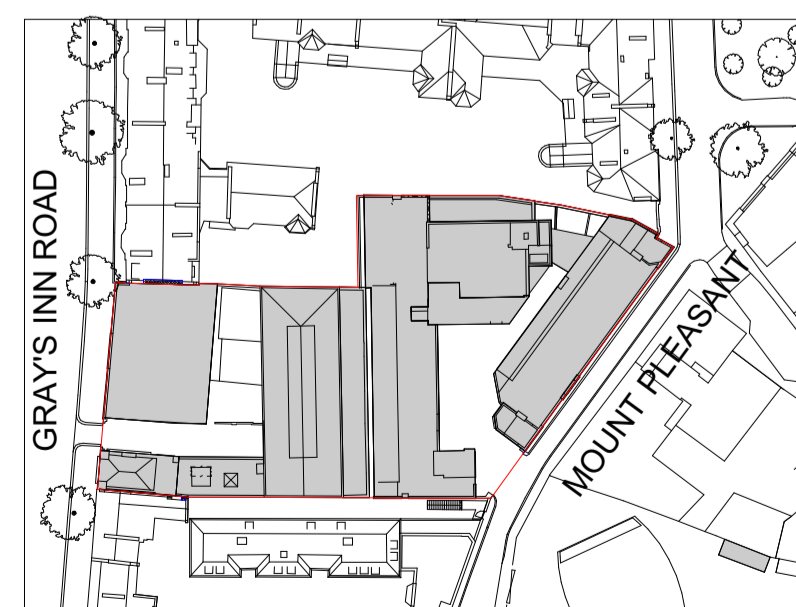

Important note
All dimensions in millimetres. Where dimensions are not given, drawings must not be scaled and the matter referred back to Veretec Limited.
All dimensions and conditions are to be checked on site by the contractor prior to preparing drawings or commencing any work. The contractor is responsible for checking that there is no conflict between site dimensions and drawn dimensions.
In the event of any detail or dimensional conflict between Veretec Limited drawings, the matter must be referred back to Veretec Limited for clarification.

A	12-08-2019	FOR PLANNING	AA/SM	RM
Rev	Date	Issued for	By	Authorised

ESTUDIO CANO LASSO
ARQUITECTOS
Guecho, 29 Madrid 28023
estudio@canolasso.com
tel +34 91 307 70 73
mov +34 606 34 93 64
www.canolasso.com

Veretec Ltd
10 Bonhill Street
London EC2A 4PE
+44 (0)20 7843 3199
london@veretec.co.uk
www.veretec.co.uk



Client
PANTHER HOUSE DEVELOPMENTS LTD
Project
PANTHER HOUSE
Date
12/08/19
Drawn
AA
Checked
RM
Authorised
JA

Title
EXISTING - THIRD FLOOR PLAN
Scale
1:100@A1

Issue Status
FOR PLANNING
Drawing Number
21835-01-103
Client Drawing Number
Rev
A

Holworthy Square

Dulverton Mansions

Panther House 3

Panther House 1

Panther House 2

Tramshed

Mullen Tower

156 Grays Inn Road

Dawlish Mansions

Mount Pleasant Studios
(52-54 Mount Pleasant)

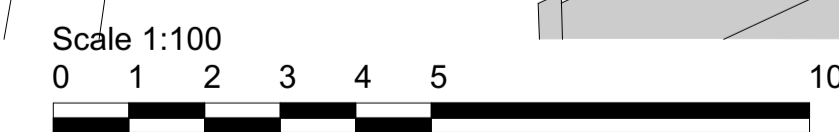
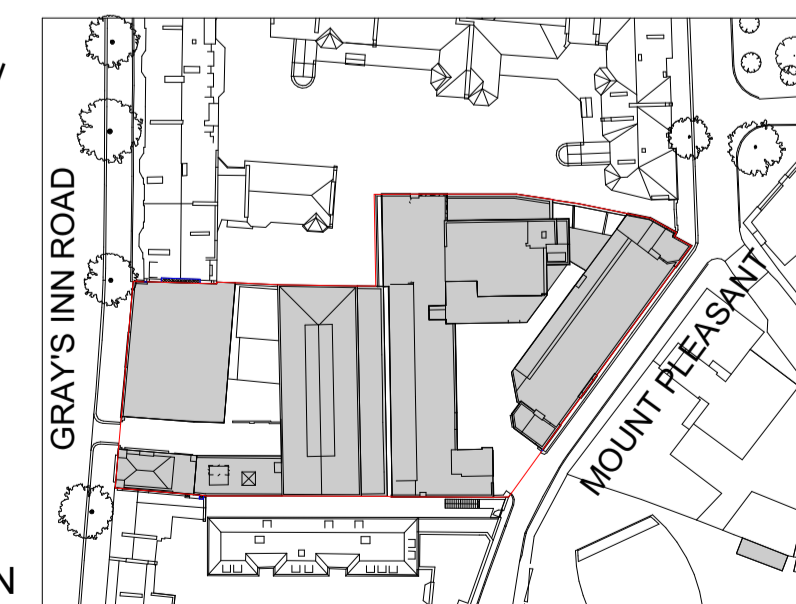

KEYPLAN

1 EXISTING - FOURTH FLOOR PLAN
01-104 1:100

Important note

All dimensions in millimetres. Where dimensions are not given, drawings must not be scaled and the matter referred back to Veretec Limited.
All dimensions and conditions are to be checked on site by the contractor prior to preparing drawings or commencing any work. The contractor is responsible for checking that there is no conflict between site dimensions and drawn dimensions.
In the event of any detail or dimensional conflict between Veretec Limited drawings, the matter must be referred back to Veretec Limited for clarification.

A	12-08-2019	FOR PLANNING	AA/SM	RM
Rev	Date	Issued for	By	Authorised

ESTUDIO CANO LASSO
ARQUITECTOS
Guecho, 29 Madrid 28023
estudio@canolasso.com
tel +34 91 307 70 73
mov +34 606 34 93 64
www.canolasso.com

Veretec Ltd
10 Bonhill Street
London EC2A 4PE
+44 (0)20 7843 3199
london@veretec.co.uk
www.veretec.co.uk



ESTUDIO CANO LASSO
ARQUITECTOS

Client
PANTHER HOUSE DEVELOPMENTS LTD
Project
PANTHER HOUSE
Date
12/08/19
Drawn
AA
Checked
RM
Authorised
JA

Title
EXISTING - FOURTH FLOOR PLAN
Scale
1:100@A1

Issue Status
FOR PLANNING
Drawing Number
21835-01-104
Client Drawing Number

Rev
A

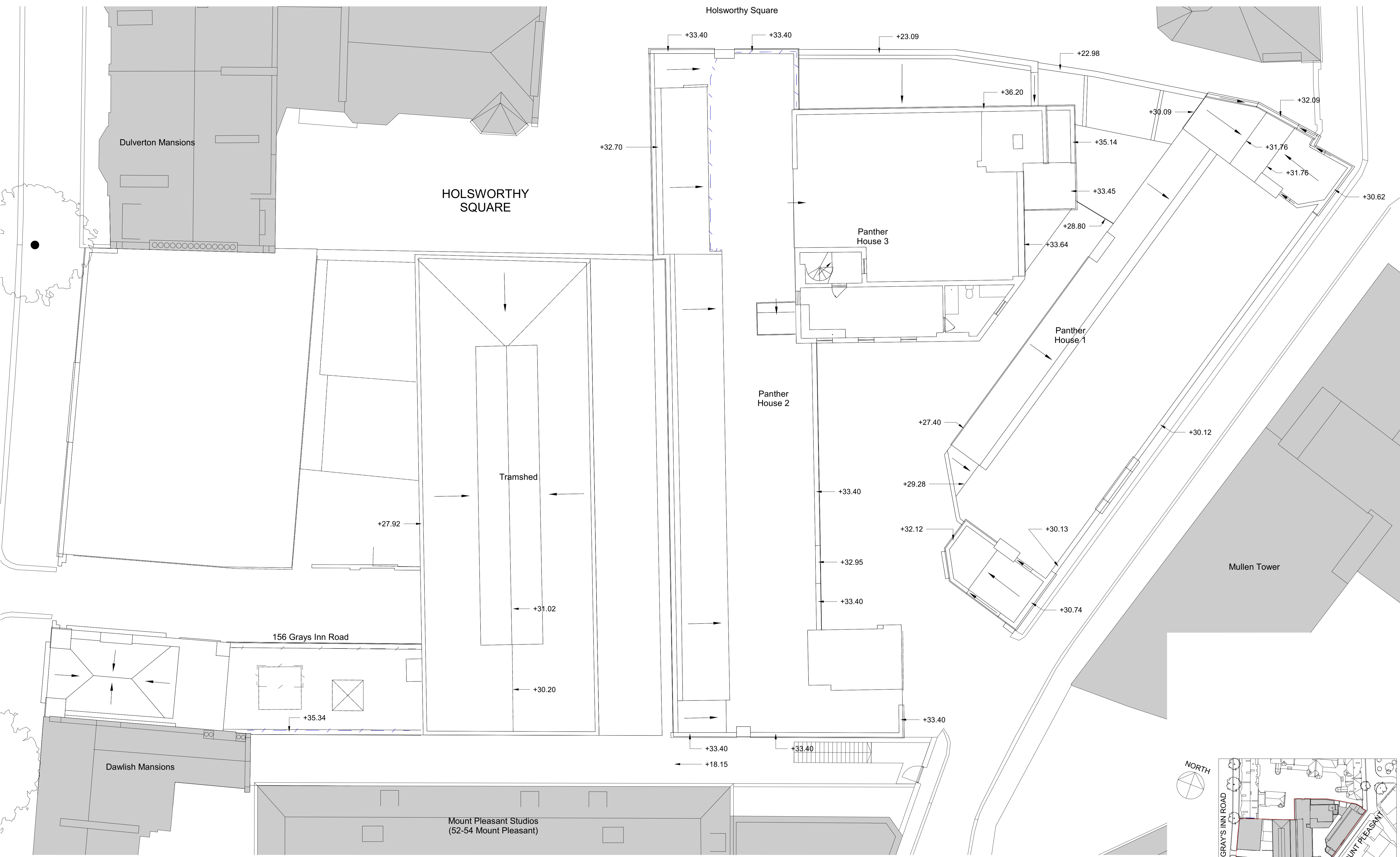

1 EXISTING - FIFTH FLOOR PLAN
01-105 1:100

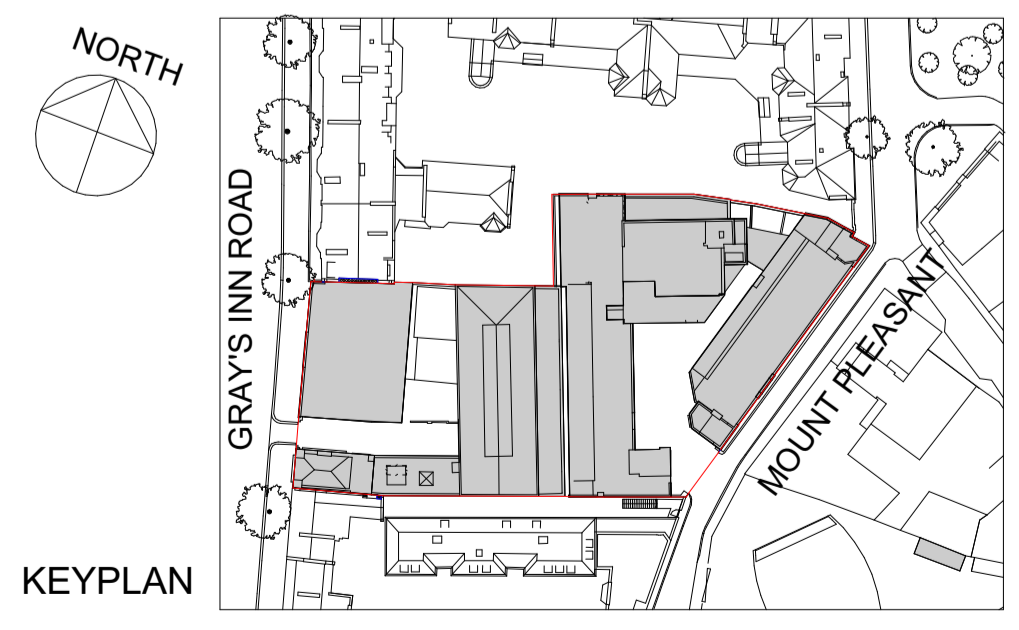
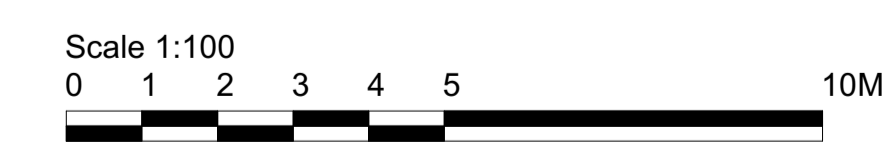

Important note
All dimensions in millimetres. Where dimensions are not given, drawings must not be scaled and the matter referred back to Veretec Limited.
All dimensions and conditions are to be checked on site by the contractor prior to preparing drawings or commencing any work. The contractor is responsible for checking that there is no conflict between site dimensions and drawn dimensions.
In the event of any detail or dimensional conflict between Veretec Limited drawings, the matter must be referred back to Veretec Limited for clarification.

A	12-08-2019	FOR PLANNING	AA/SM	RM
Rev	Date	Issued for	By	Authorised

ESTUDIO CANO LASSO
ARQUITECTOS
Guecho, 29 Madrid 28023
estudio@canolasso.com
tel +34 91 307 70 73
mov +34 606 34 93 64
www.canolasso.com

Veretec Ltd
10 Bonhill Street
London EC2A 4PE
+44 (0)20 7843 3199
london@veretec.co.uk
www.veretec.co.uk



Client
PANTHER HOUSE DEVELOPMENTS LTD
Project
PANTHER HOUSE
Date
12/08/19
Drawn
AA
Checked
RM
Authorised
JA

Title
EXISTING - FIFTH FLOOR PLAN
Scale
1:100@A1

Issue Status
FOR PLANNING
Drawing Number
21835-01-105
Client Drawing Number
Rev
A