

new IQ Glass Mondrian
single glazed entrance doors
and screen. RAL 8022

existing piers / columns to be
retained, made good and
redecorated to match existing
adjacent

new automated door to
Japanese Garden
through the Bernard Katz
Building

underside of Bernard Katz concrete slab behind

WILKINS BUILDING
THE BERNARD KATZ BUILDING

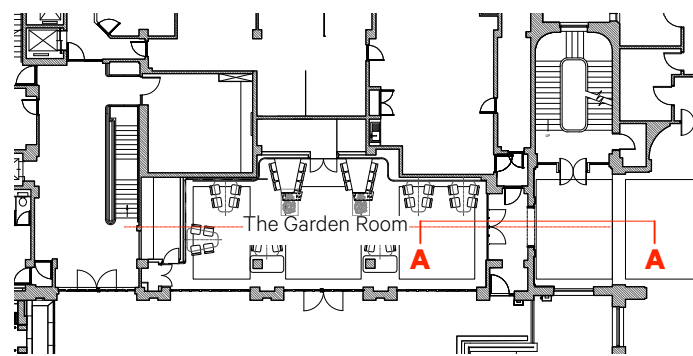

Location Plan 1:200.



Revision	Date	Amendment	Notes					Client	University College London	Burwell Deakins
P1	11.12.18	Planning issue						Project	Wilkins Building Core Areas - The Garden Room	
P2	17.04.19	Planning issue - Area of demolition added to create access through the Bernard Katz Building to the Japanese Garden						Drawing	Section - As Proposed	
				Scale	1:20 @ A1	Drawn	CL	info@burwellarchitects.com		
				Date	November 2018			www.burwellarchitects.com		
				Project N°	791	Drawing N°	791/PL/013	Revision	P2	
				NO DIMENSIONS ARE TO BE SCALED FROM THIS DRAWING. THE CONTRACTOR/MANUFACTURER IS RESPONSIBLE FOR CHECKING ALL DIMENSIONS AND QUERYING ANY DISCREPANCIES. THIS DRAWING IS THE PROPERTY OF BDA ARCHITECTS LTD. COPYRIGHT IS RESERVED BY THEM AND THE DRAWING IS ISSUED ON CONDITION THAT IT IS NOT COPIED, REPRODUCED, RETAINED OR DISCLOSED TO ANY UNAUTHORISED PERSON, EITHER WHOLLY OR IN PART, WITHOUT WRITTEN CONSENT.		Unit 001 California Building London SE13 7SF +44 (0) 2083 056010		First Floor 6 Southernhay West Exeter EX1 1JG +44 (0) 1392 423981		