

existing downstand beam & cornice to be retained, made good and redecorated to match existing adjacent

new piers to match existing relocated to allow for larger single arch due to location of concrete column

fluted plasterwork "frieze" detail at high level over opening

new IQ Glass Mondrian single glazed entrance doors and screen. RAL 8022

location of existing concrete column behind

new skirting to match exiting

area of new floor to be black limestone to match existing

underside of Bernard Katz concrete slab behind

underside of Bernard Katz suspended ceiling

Elevation

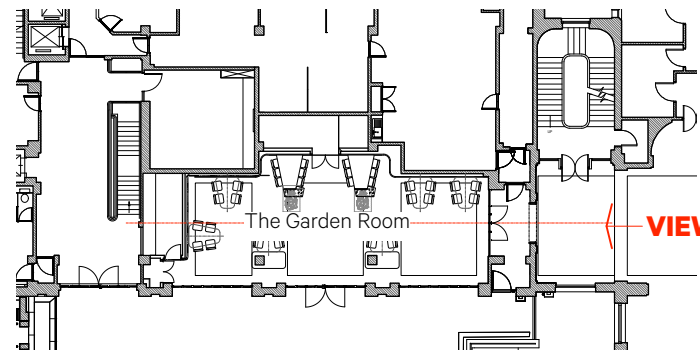

Location Plan 1:200.

new doorway through the Bernard Katz Building

concrete column

Fire lobby

Plan

Revision	Date	Amendment	Notes					Client	University College London	Burwell Deakins
P1	11.12.18	Planning issue					Project	Wilkins Building Core Areas - The Garden Room		
P2	17.04.19	Planning issue - Area of demolition added to create access through the Bernard Katz Building to the Japanese Garden					Drawing	Internal Plan / Elevation - As Proposed		
P3	06.08.19	Planning issue - Elevation updated showing an arched arrangement.					Scale	1:20 @ A1	Drawn	CL
P4	14.08.19	Planning issue - Elevation updated showing additional plasterwork details in response to planners' comments.					Date	November 2018		
P5	20.08.19	Planning issue - Elevation updated showing a single archway due to location of structural concrete column.					Project N°	791	Drawing N°	791/PL/012
								Revision	P5	Info@burwellarchitects.com www.burwellarchitects.com
								Unit 001 California Building London SE13 7SF +44 (0) 2083 056010	First Floor 6 Southernhay West Exeter EX1 1JG +44 (0) 1392 423981	

NO DIMENSIONS ARE TO BE SCALED FROM THIS DRAWING. THE CONTRACTOR/MANUFACTURER IS RESPONSIBLE FOR CHECKING ALL DIMENSIONS AND QUERYING ANY DISCREPANCIES. THIS DRAWING IS THE PROPERTY OF BDA ARCHITECTS LTD. COPYRIGHT IS RESERVED BY THEM AND THE DRAWING IS ISSUED ON CONDITION THAT IT IS NOT COPIED, REPRODUCED, RETAINED OR DISCLOSED TO ANY UNAUTHORISED PERSON, EITHER WHOLLY OR IN PART, WITHOUT WRITTEN CONSENT.