

rLG.02 Fireplace A Plan

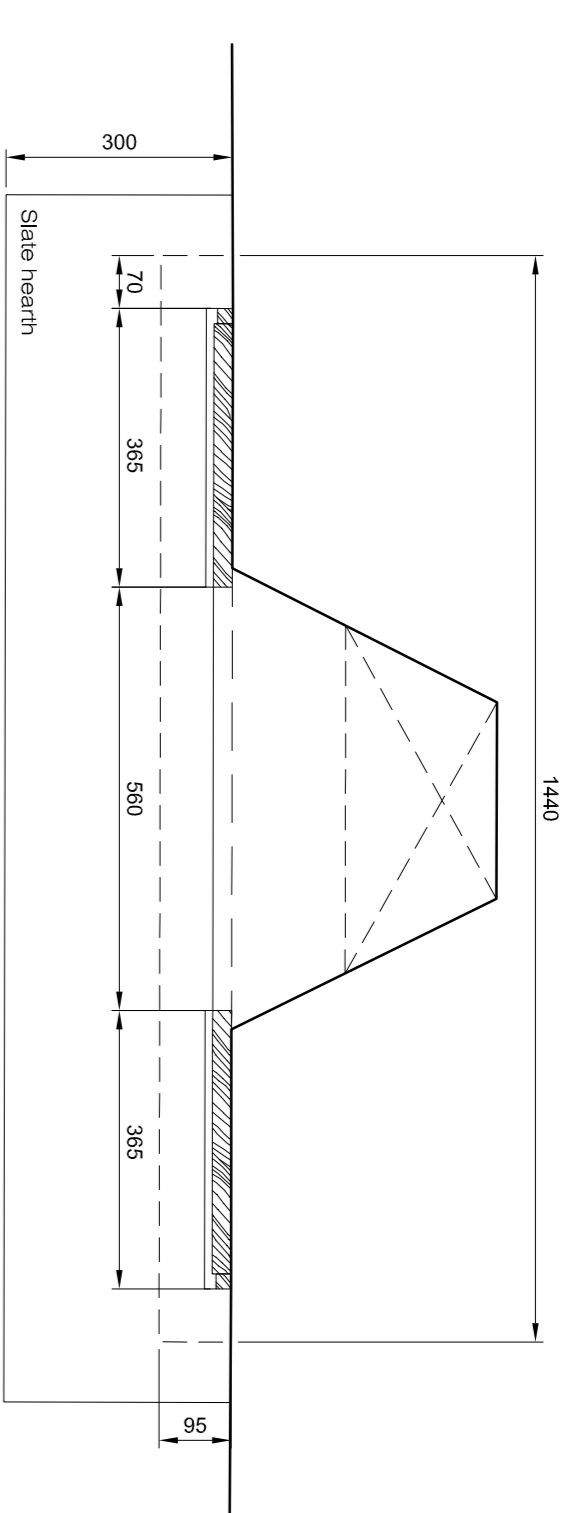

rLG.04 Fireplace B Plan

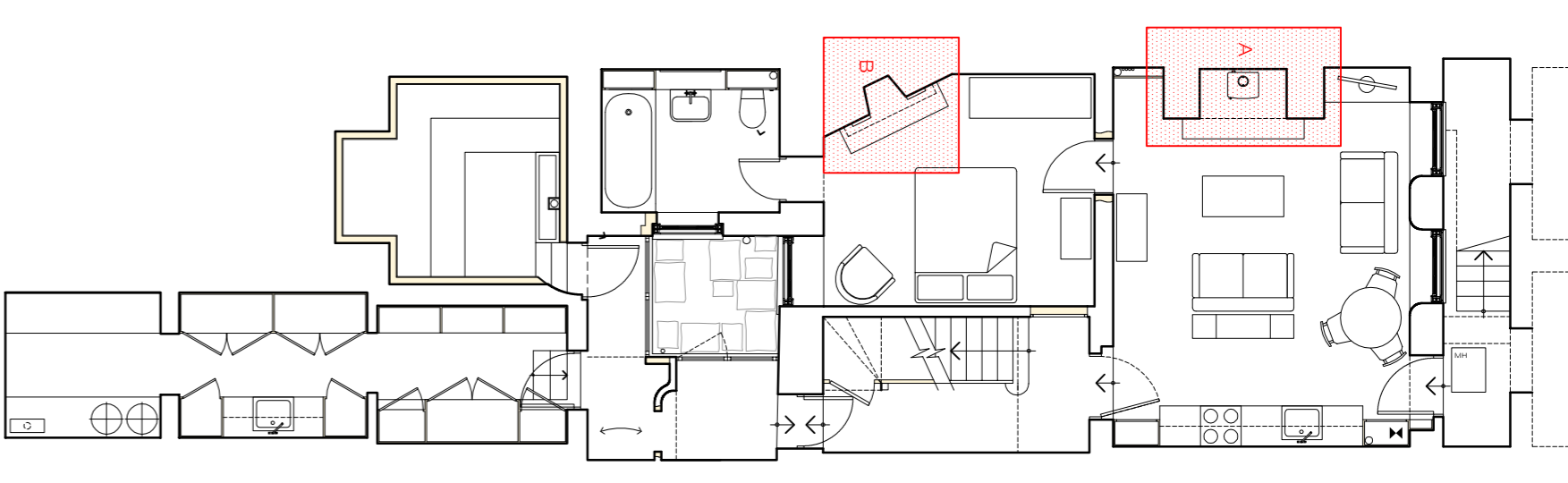

Key Plan

Note: Existing fireplace opening to be raised to existing original dresser level
Simple limestone surround with marble shelf, segmental arch and keystone

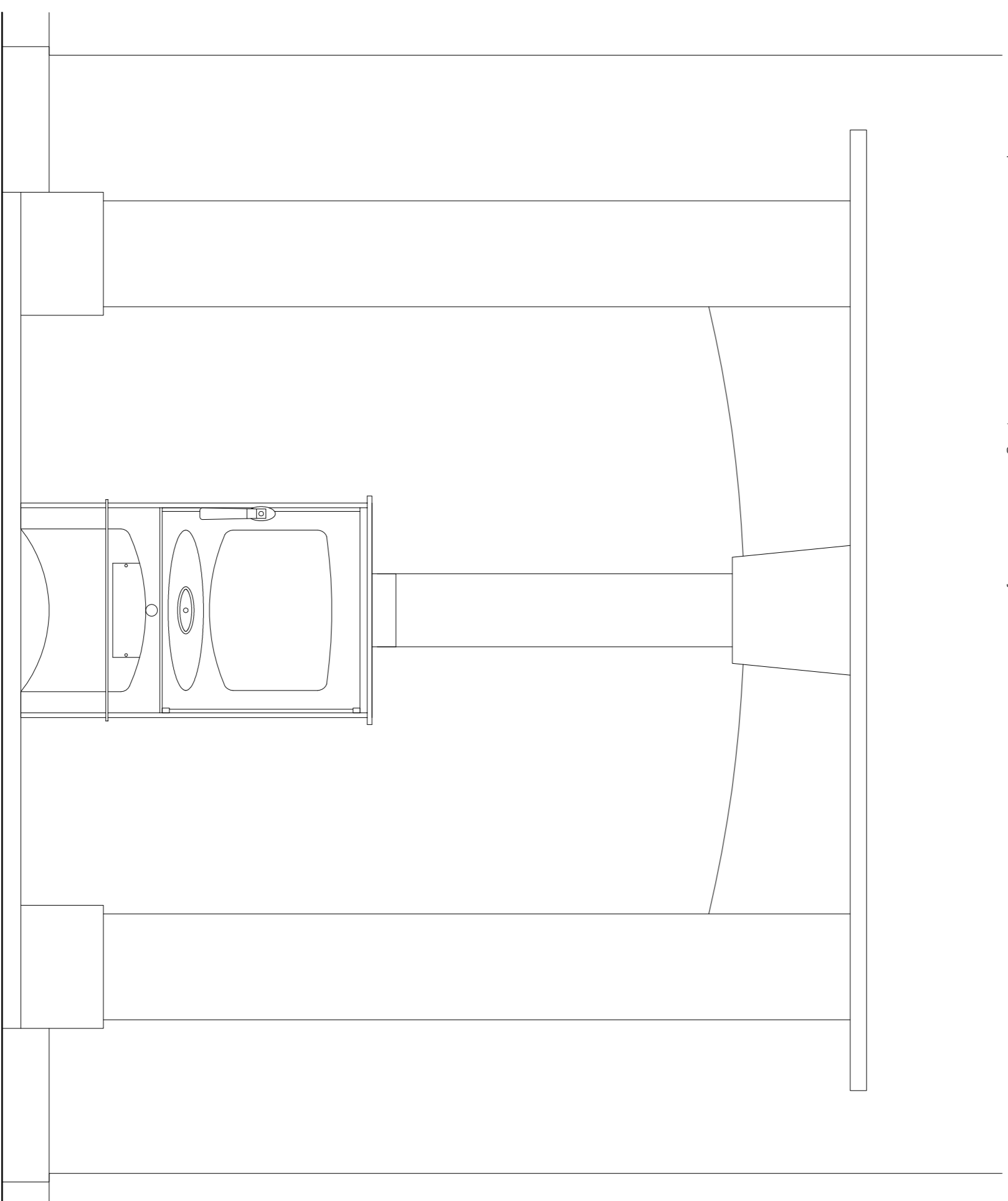

rLG.02 Fireplace A Elevation

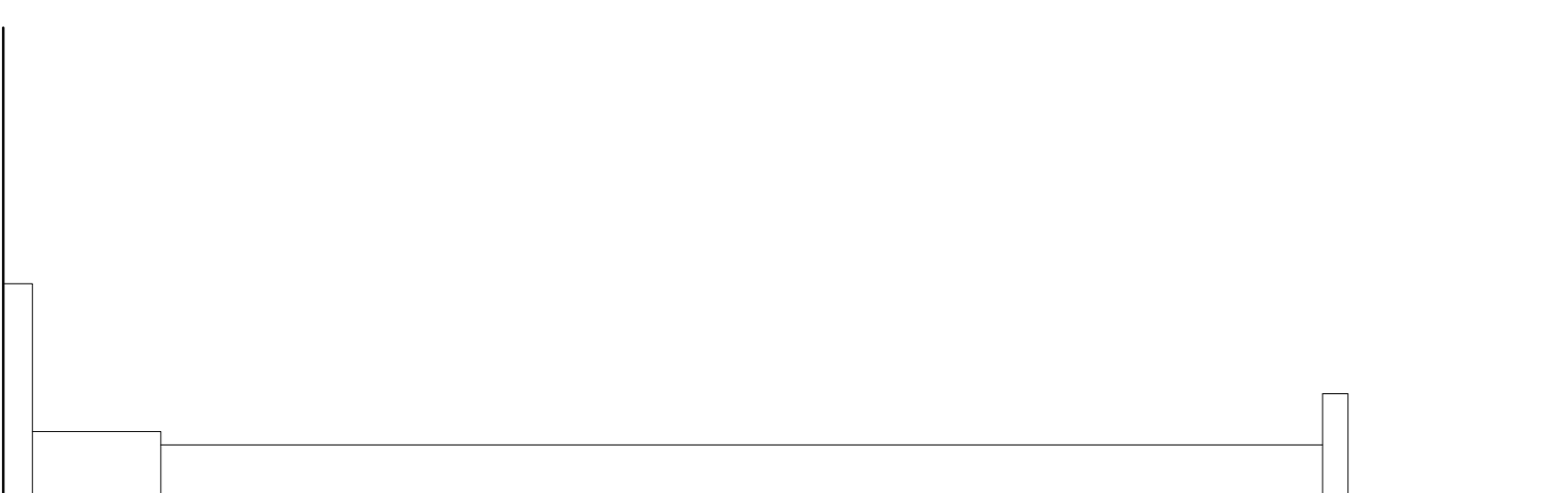

rLG.02 Fireplace A Side Elevation

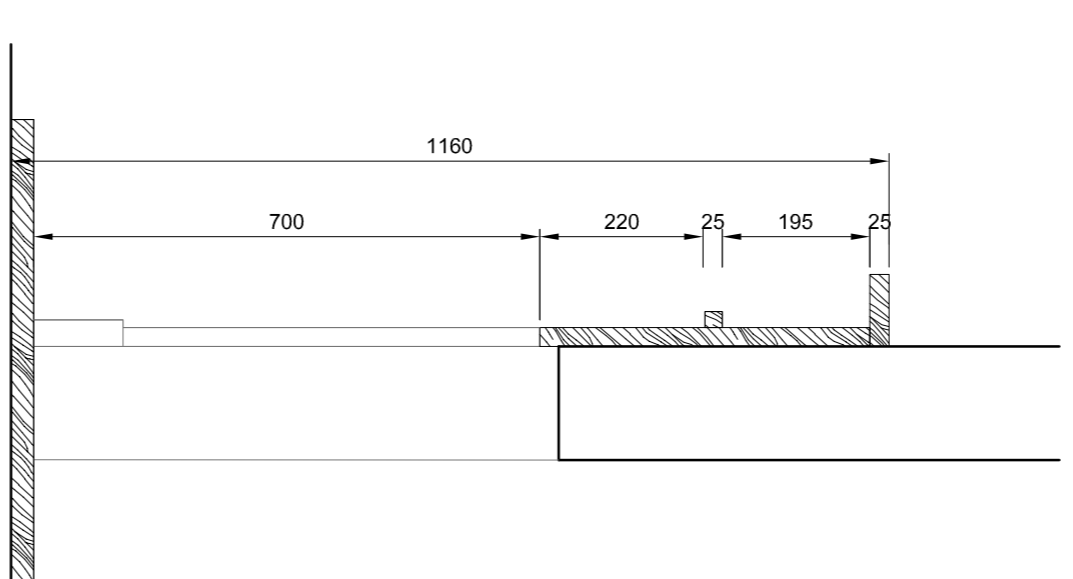

rLG.04 Fireplace B Section

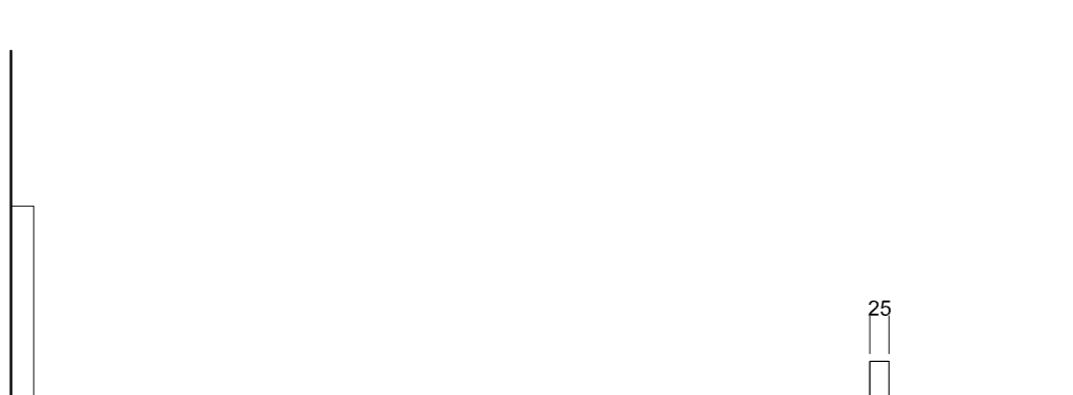

rLG.04 Fireplace B Side Elevation

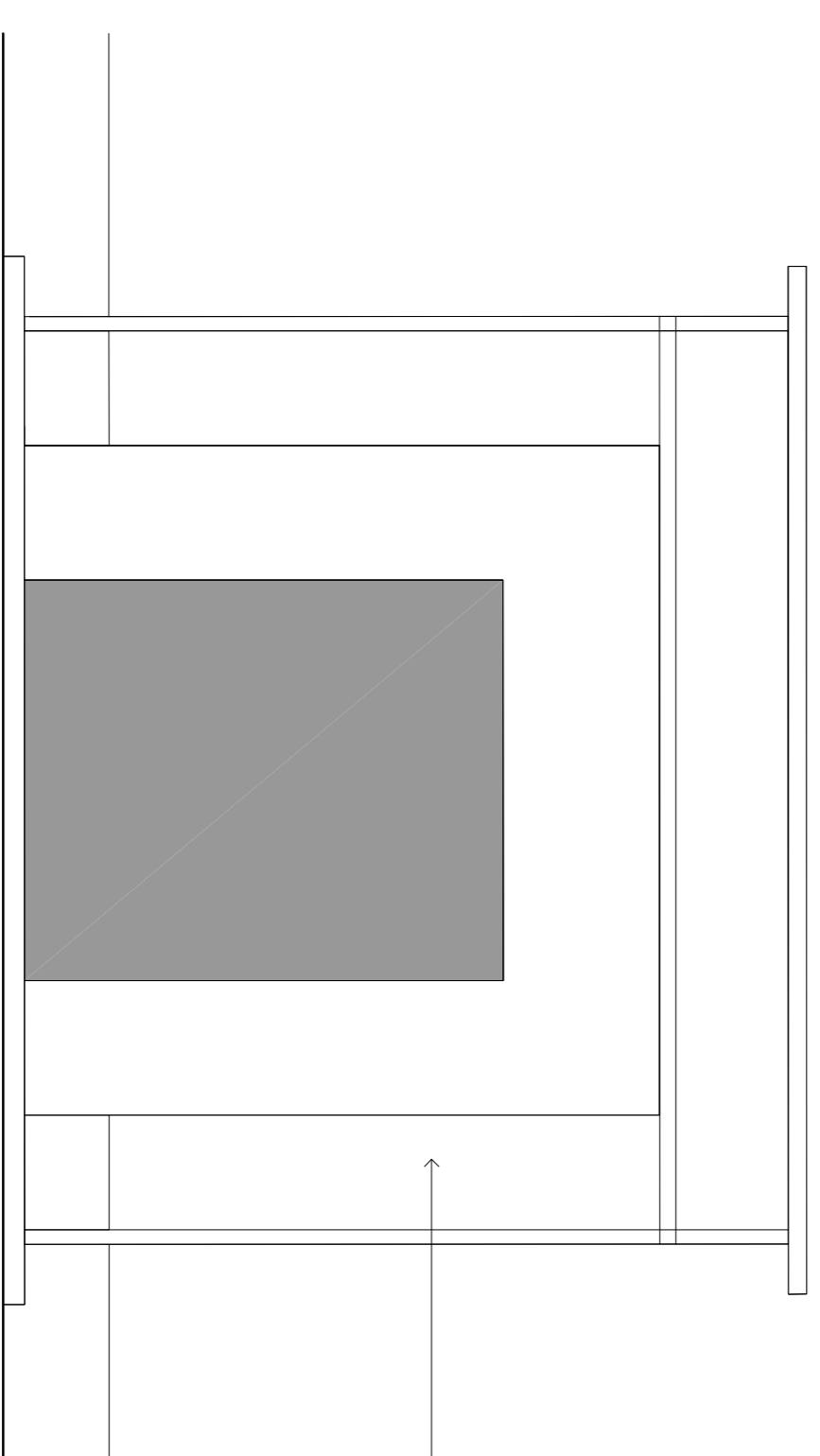

rLG.04 Fireplace B Elevation

Timber surround and mantel shelf

Lower Ground Floor Fireplaces

Client: Mr R Crowley
Project: 34 Great James Street
Drawing: Proposed Fireplaces



ETCHINGHAM MORRIS
ARCHITECTS
ARCHITECTS
www.etchingham-morris.co.uk

The Studio
Rear of 43 / 45 High Street
Ringwood
Hampshire BH24 1AD
E: frontdesk@etchingham-morris.co.uk
T: 01425 483155 F: 01425 483156
Date: Jun 2019 Dwg No: ST711-95
Scale: 1:10 (GA)

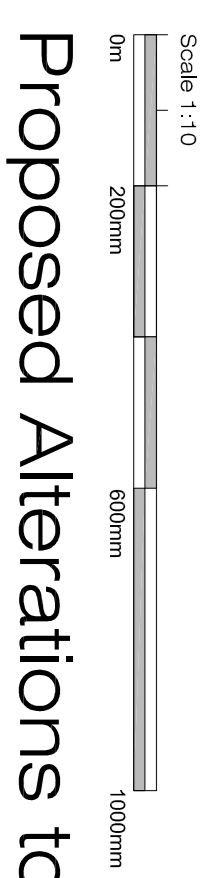

Proposed Alterations to 34 Great James Street, Bloomsbury, London, WC1N 3HB

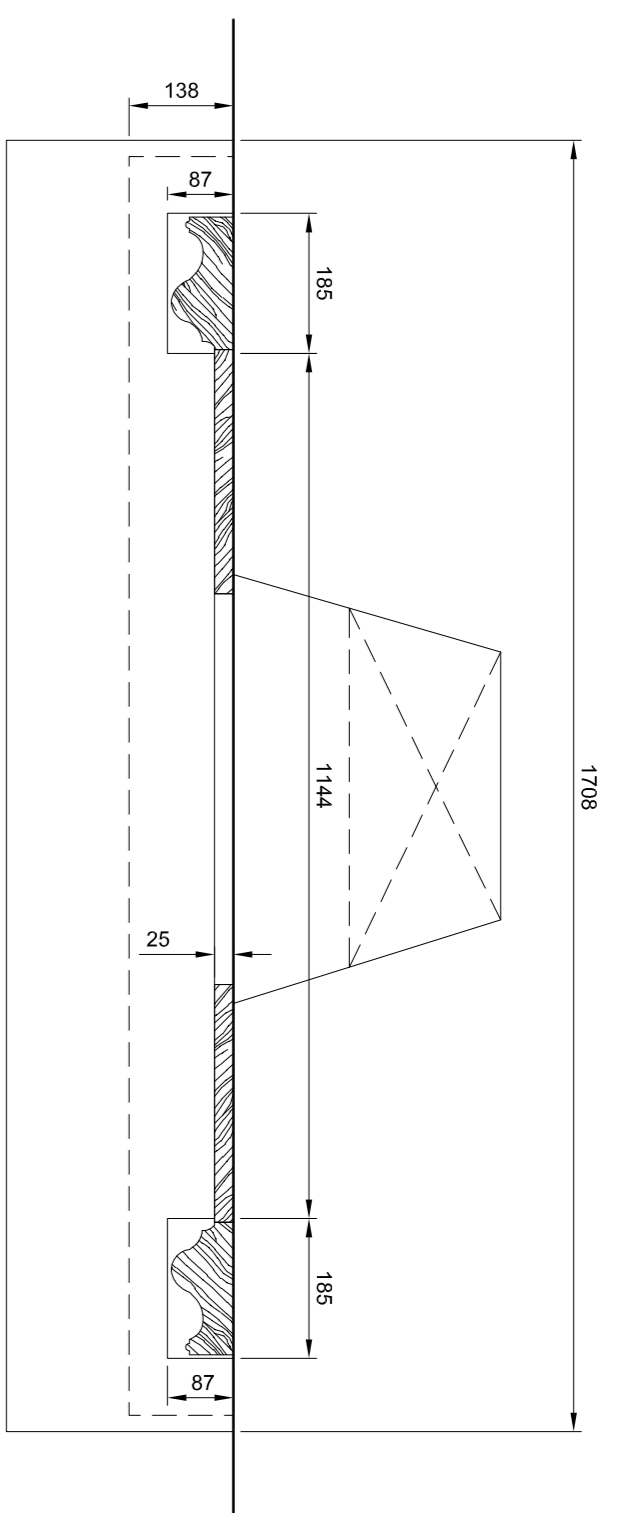

rG.02 Fireplace C Plan

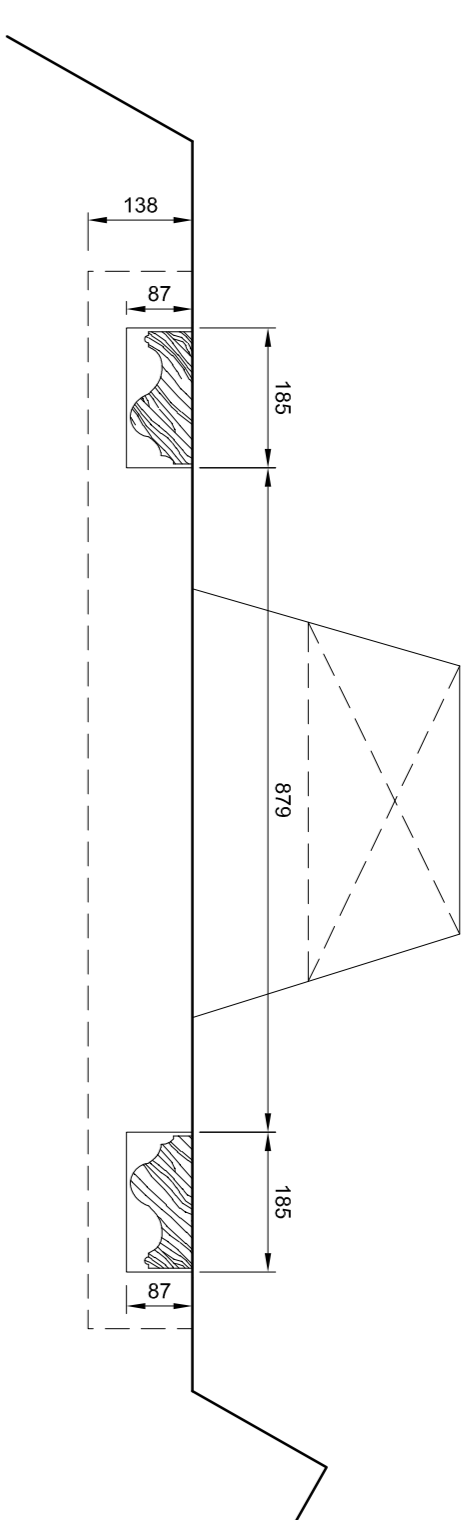

rG.03 Fireplace D Plan

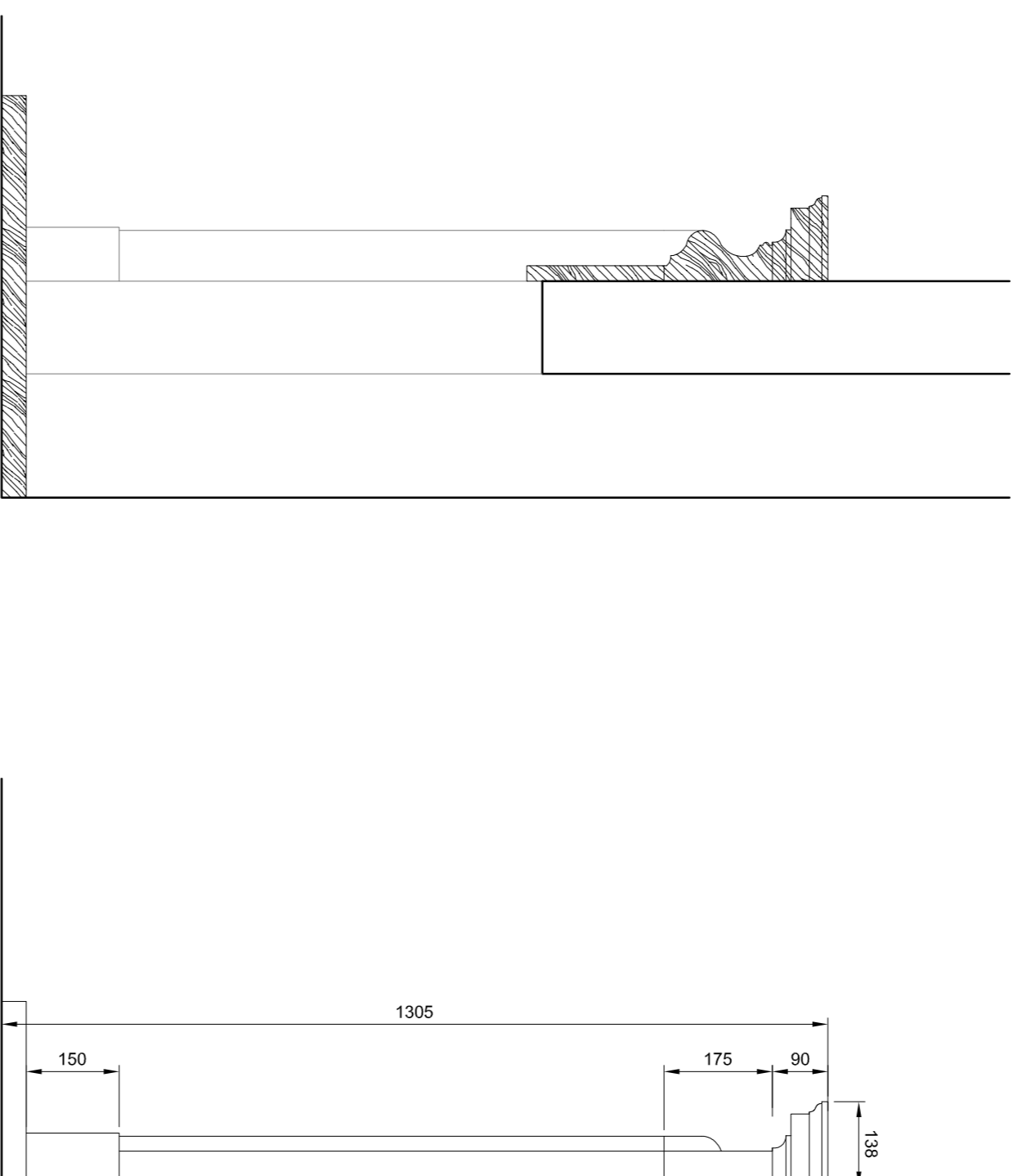

rG.02 Fireplace C Section

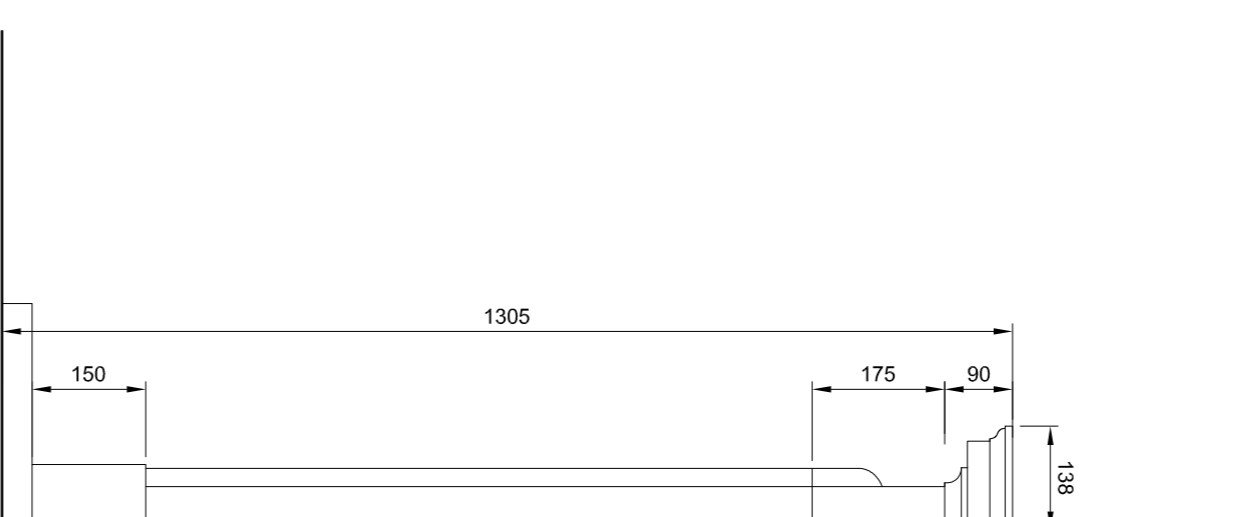

rG.02 Fireplace C Side Elevation

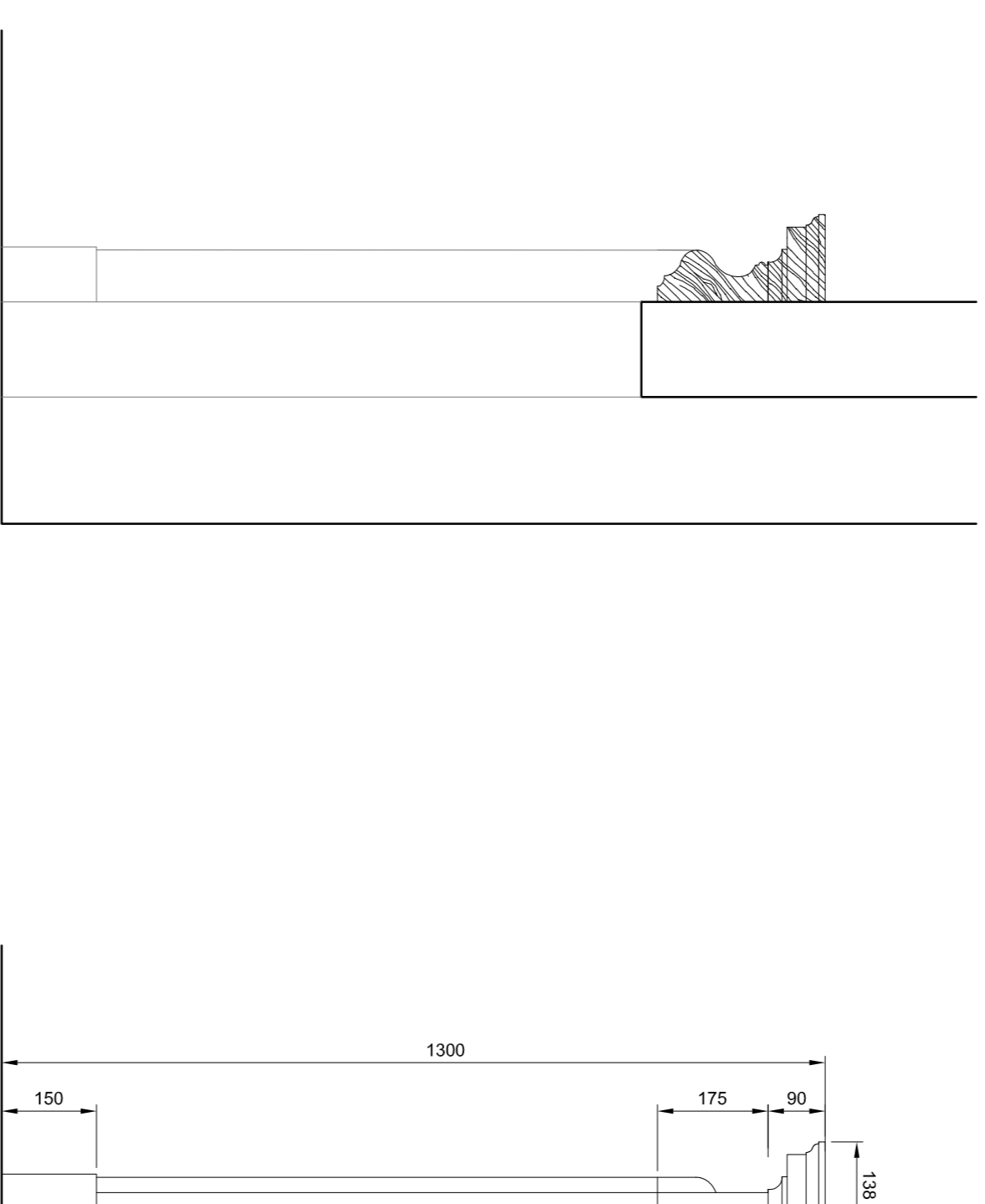

rG.03 Fireplace D Section

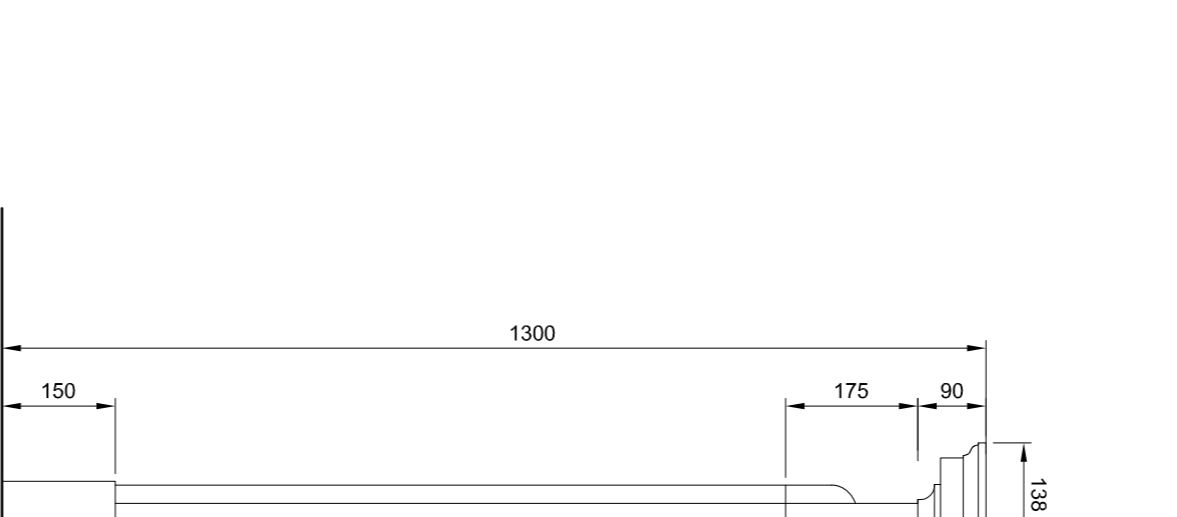

rG.03 Fireplace D Side Elevation

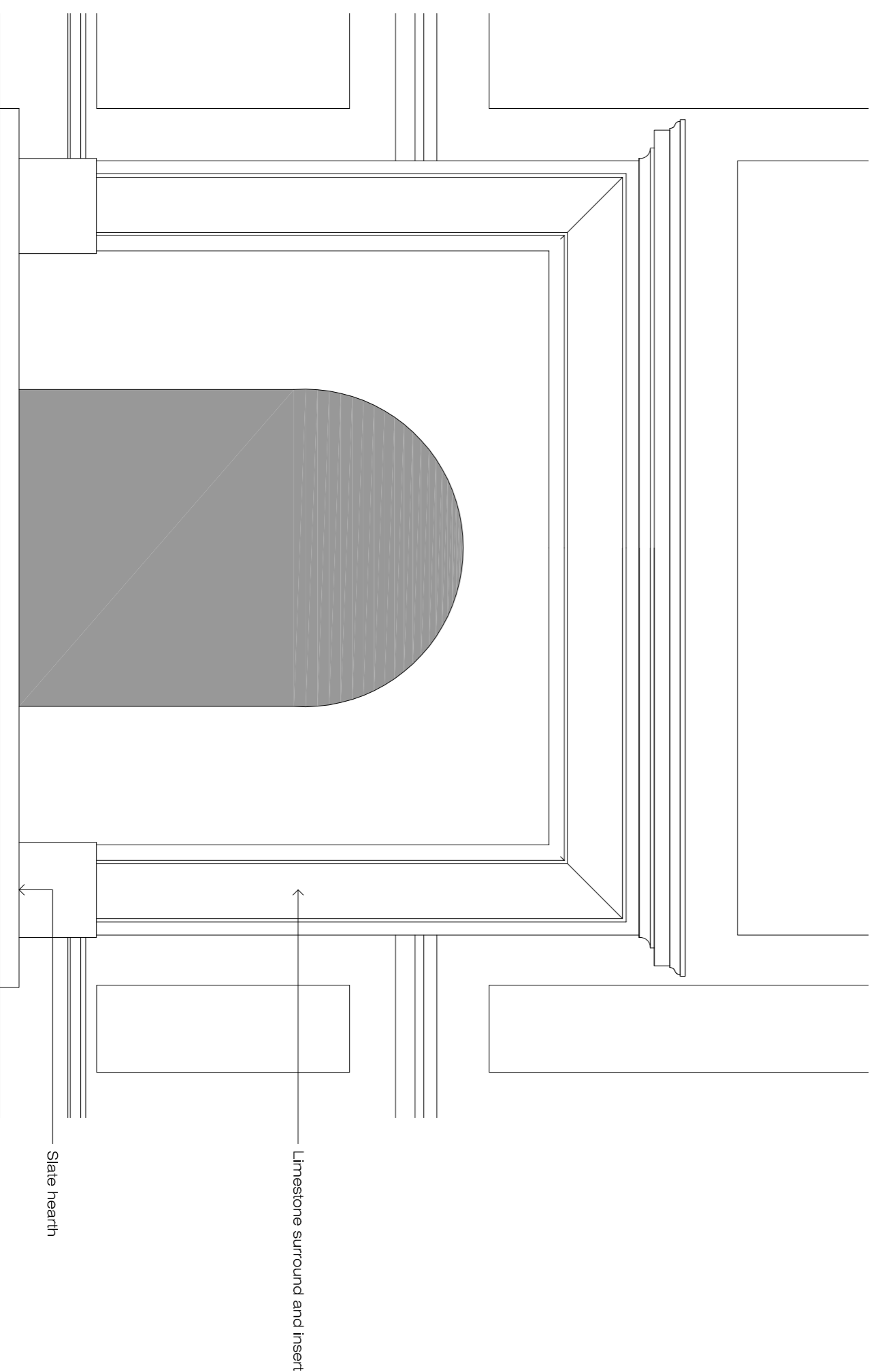

rG.02 Fireplace C Elevation - Bolection

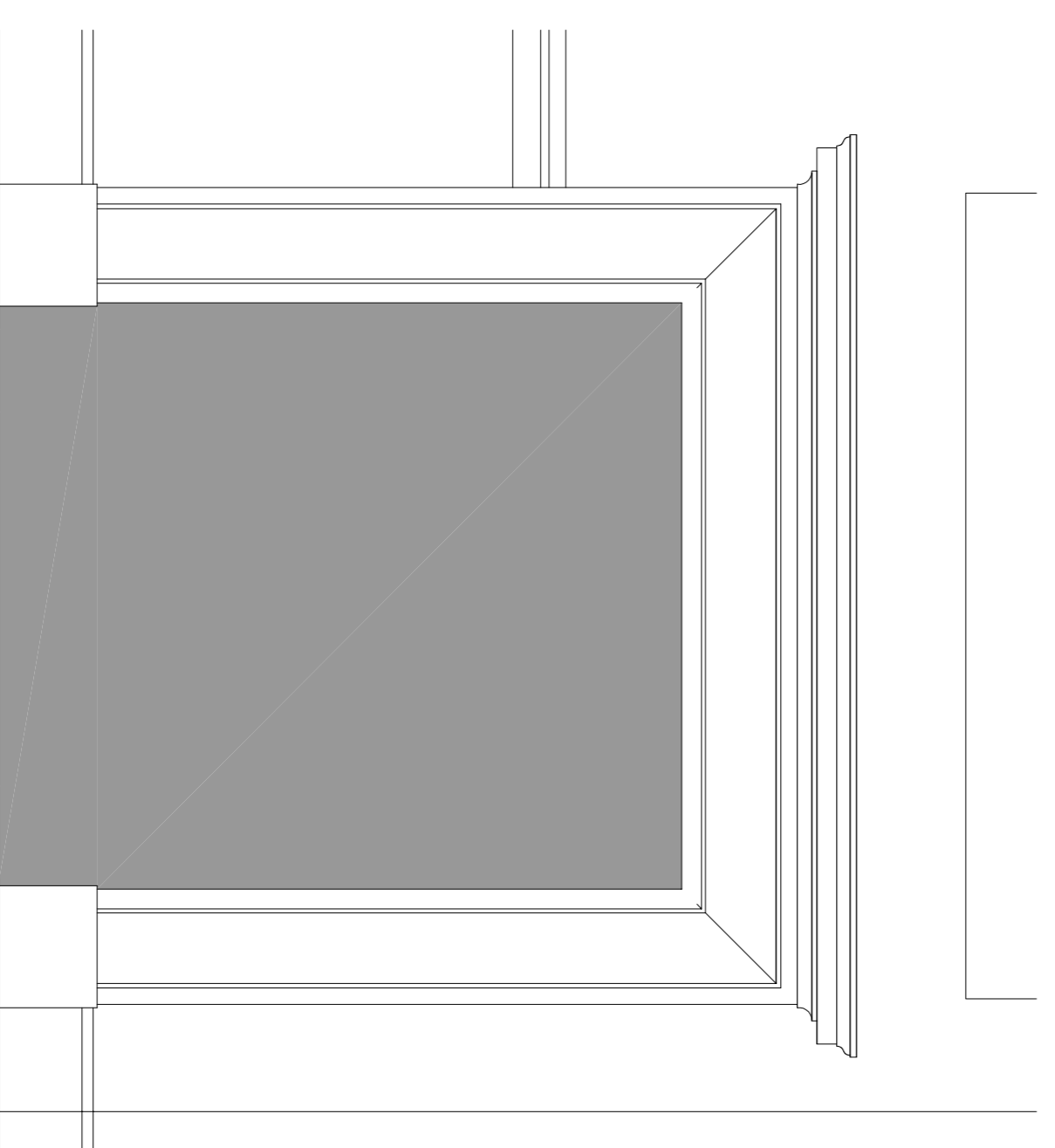

rG.03 Fireplace D Elevation - Bolection

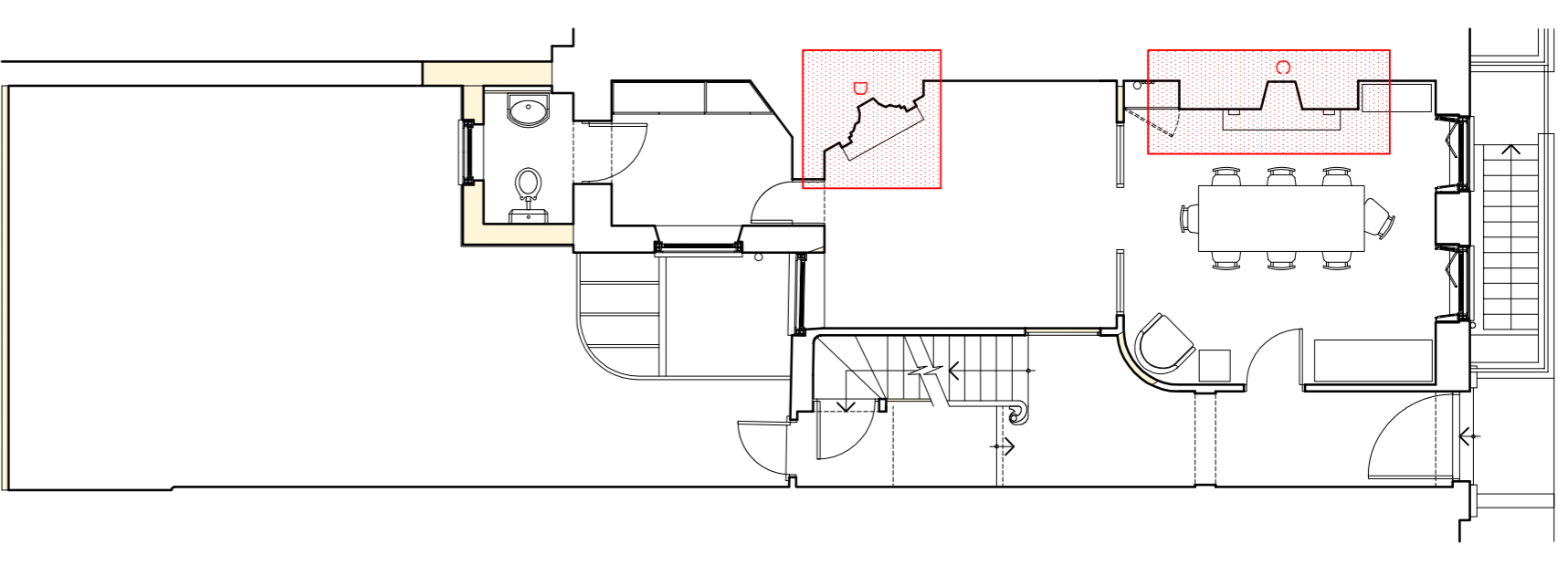

Key Plan

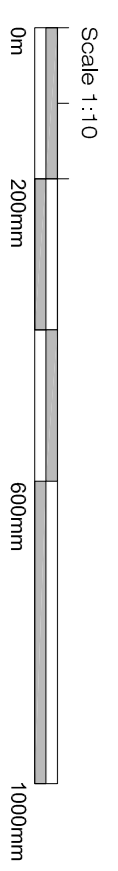

Proposed Alterations to 34 Great James Street, Bloomsbury, London, WC1N 3HB

Ground Floor Fireplaces

Client: Mr R Crowley

Project: 34 Great James Street

Drawing: Proposed Fireplaces

**ETCHINGAM MORRIS**
ARCHITECTURE LTD
www.etchingham-morris.co.ukThe Studio
Rear of 43 / 45 High StreetRingswood
Hampshire BH24 1ADT: 01425 483155 F: 01425 483156
E: frontdesk@etchingham-morris.co.uk

Date: Jun 2019

Dwg No: ST711-96

Scale: 1:10 (GA)

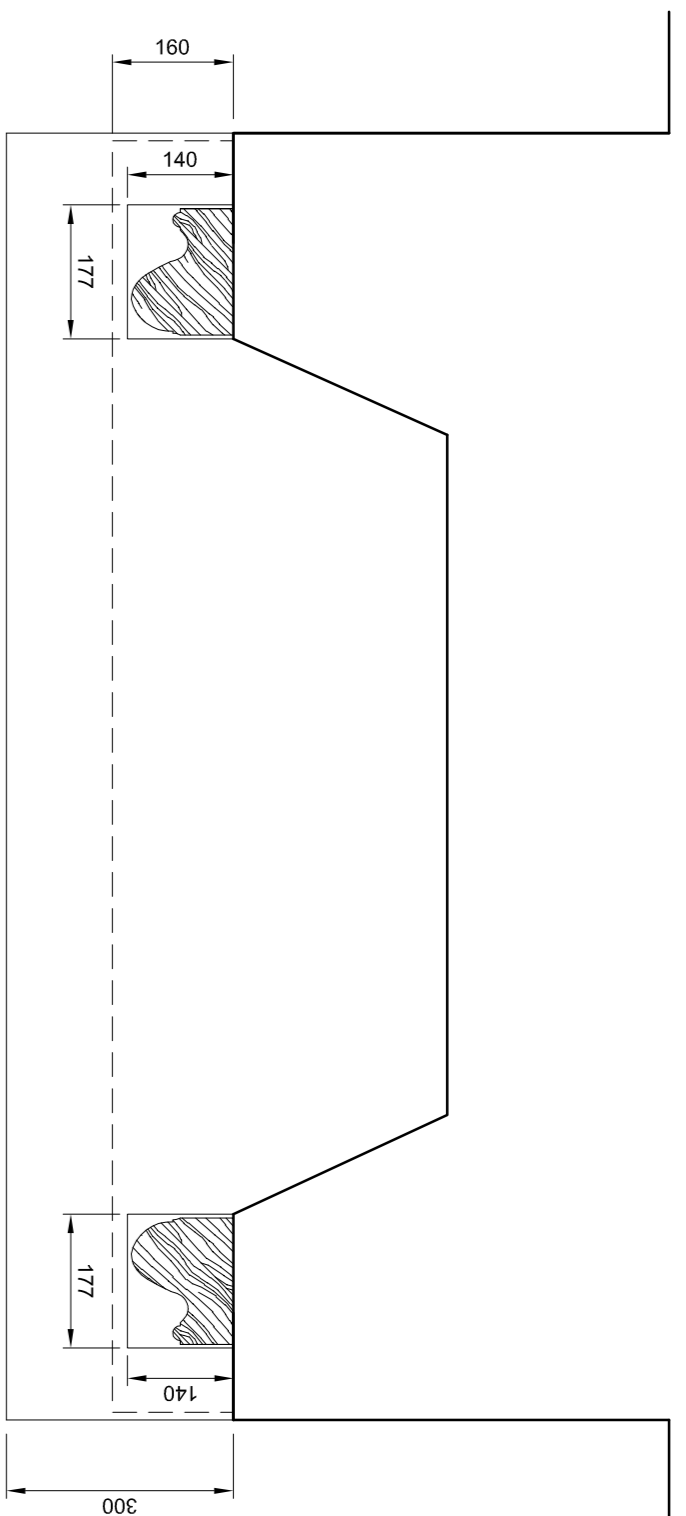

r1.02 Fireplace E Plan

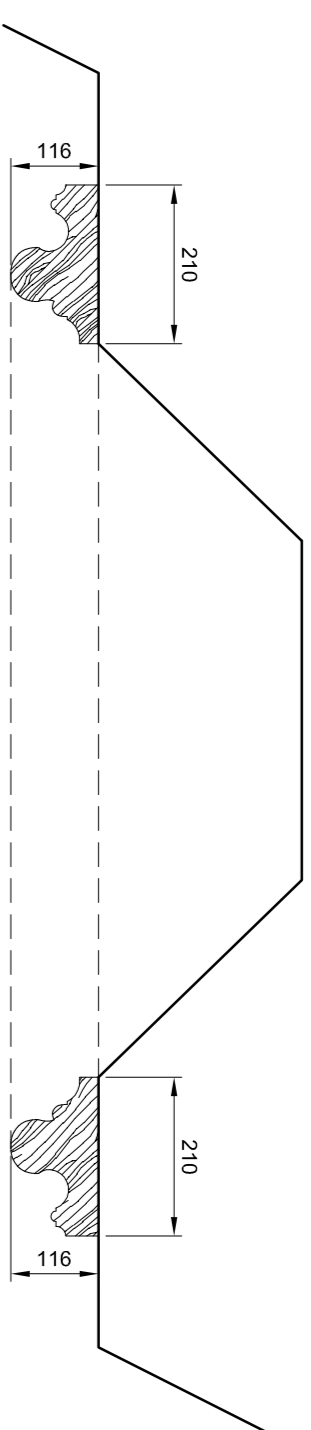

r1.03 Fireplace F Plan

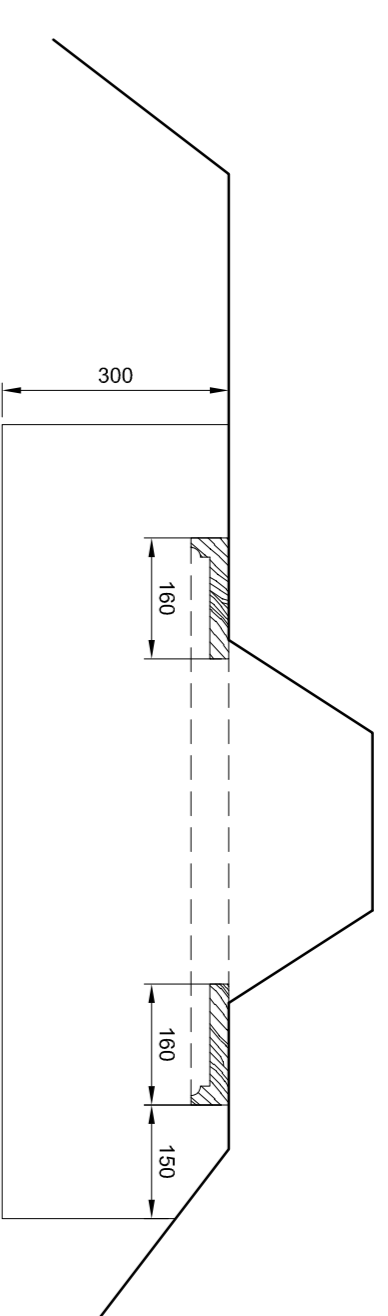

r1.04 Fireplace G Plan

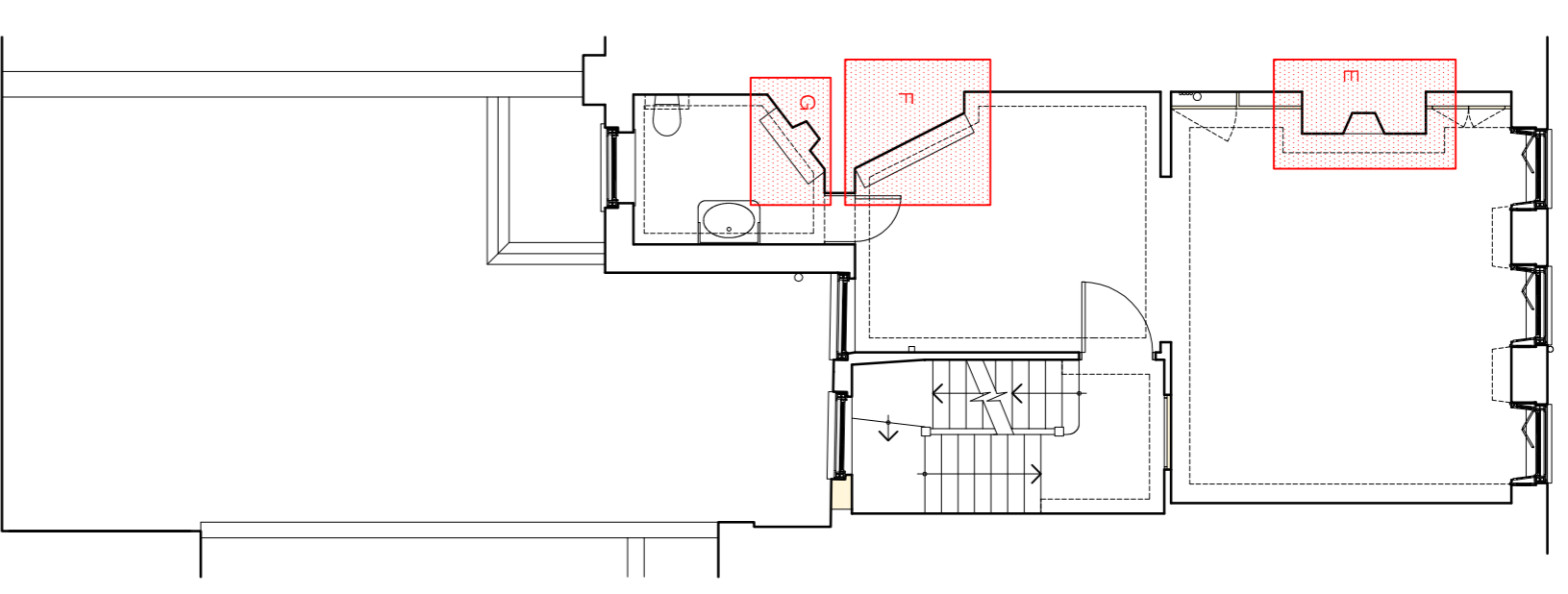

Key Plan

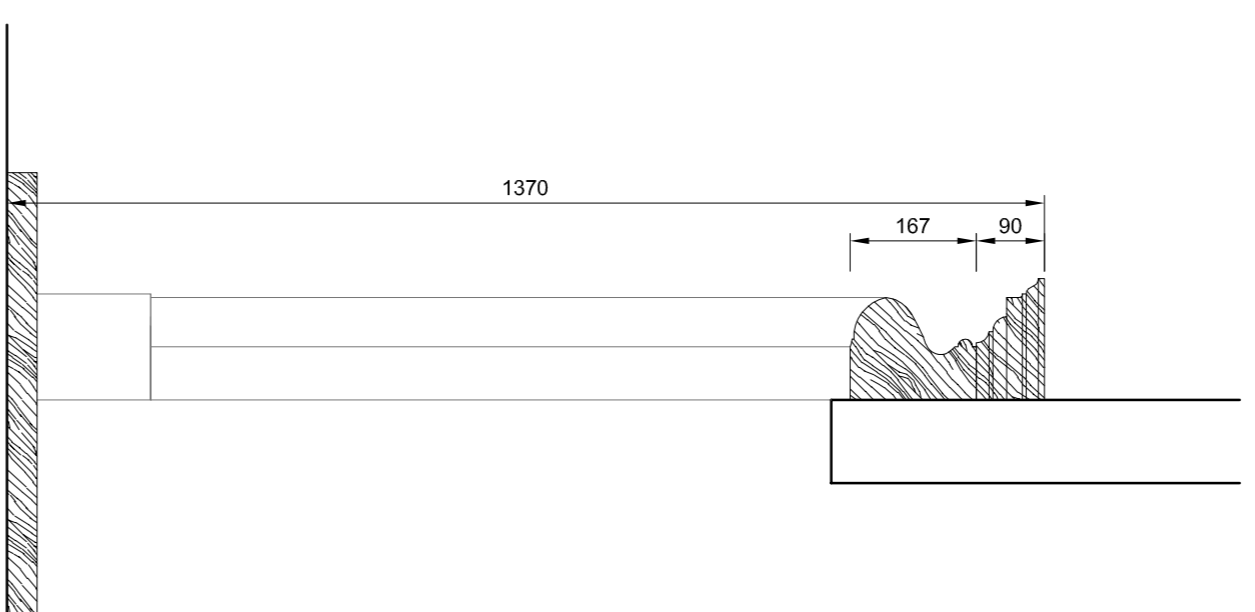

r1.02 Fireplace E Section

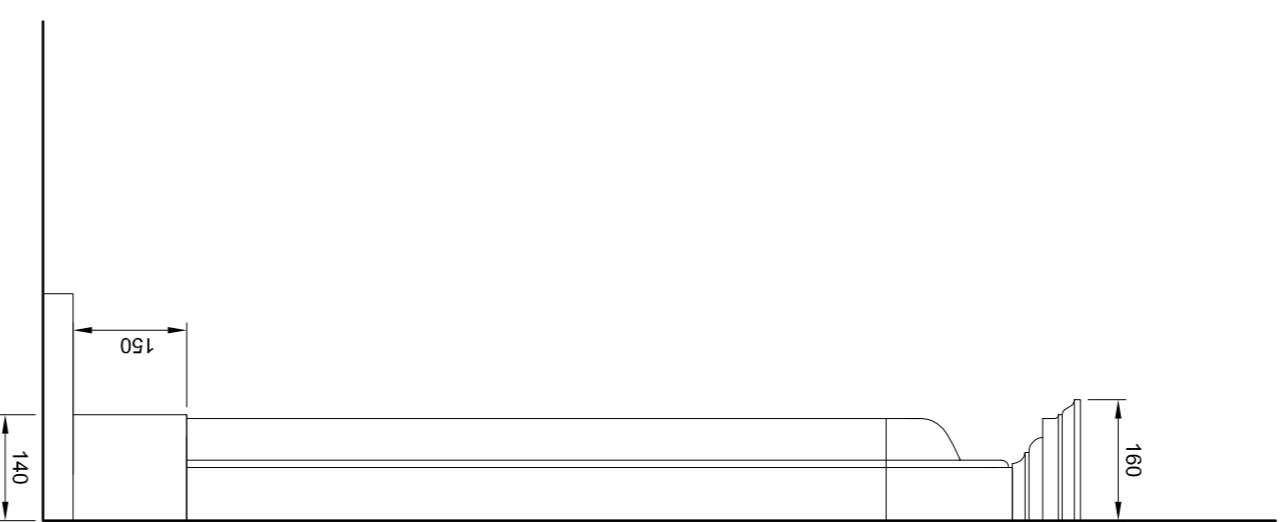

r1.02 Fireplace E Side Elevation

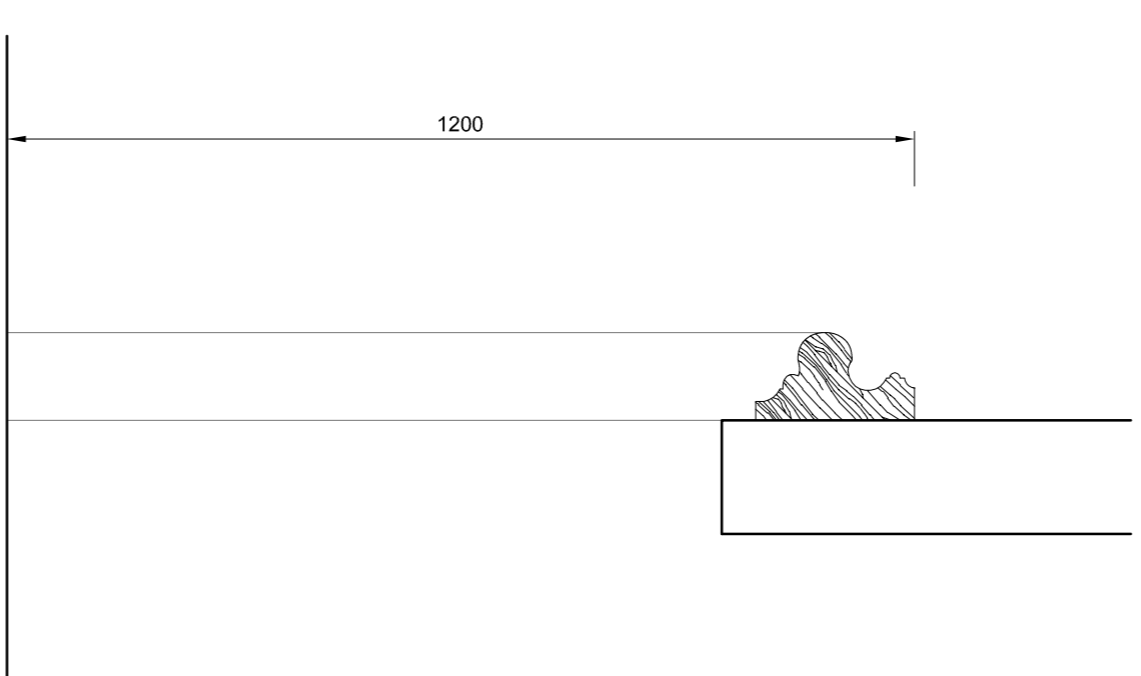

r1.03 Fireplace F Section

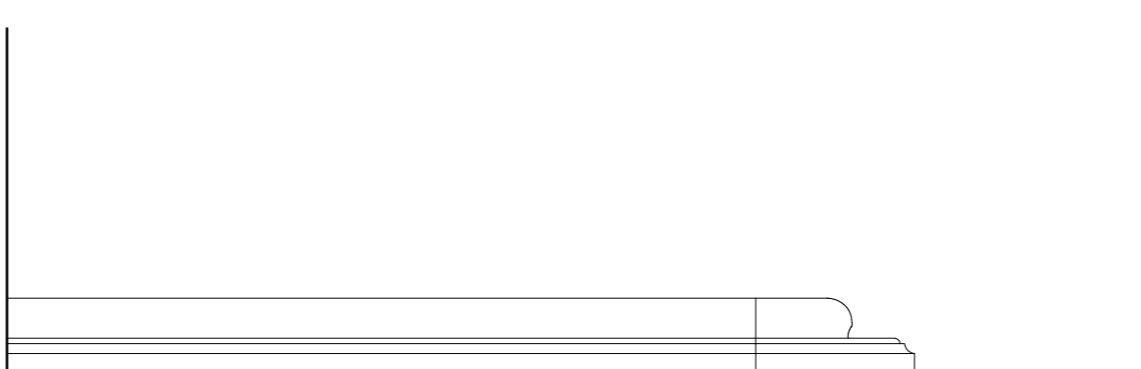

r1.03 Fireplace F Side Elevation

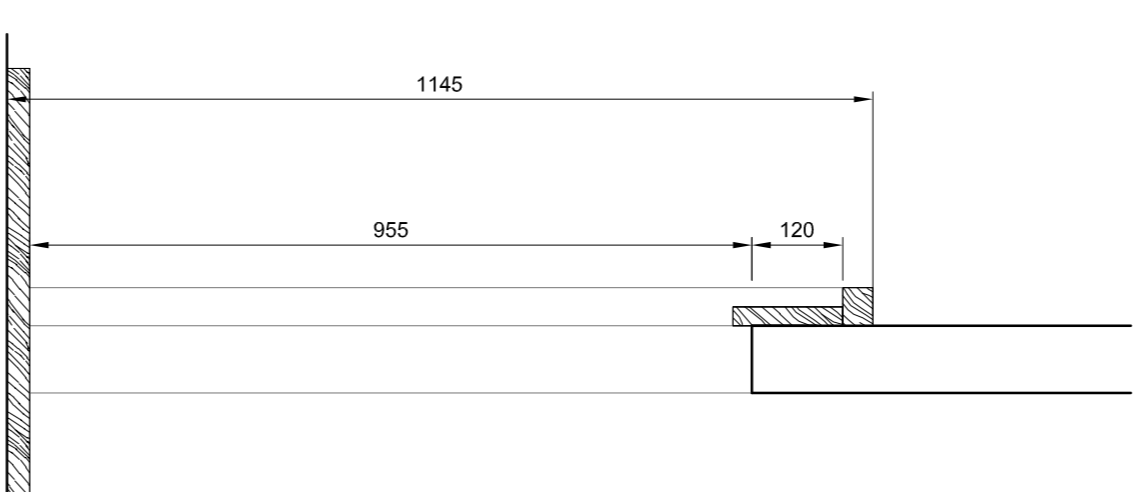

r1.04 Fireplace G Section

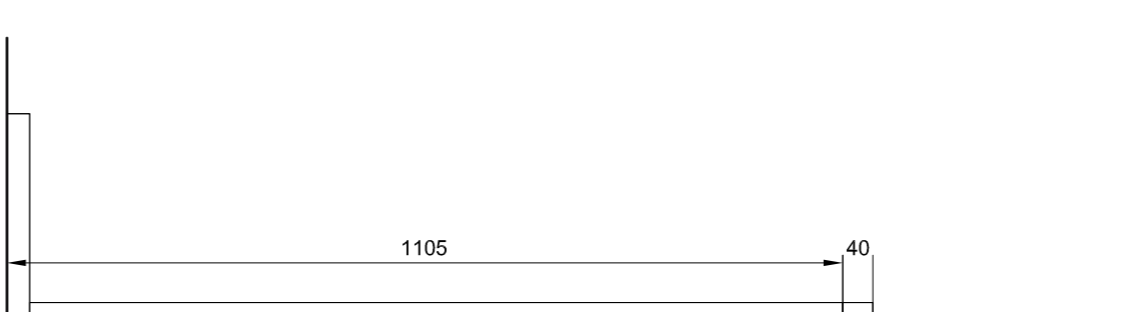

r1.04 Fireplace G Side Elevation

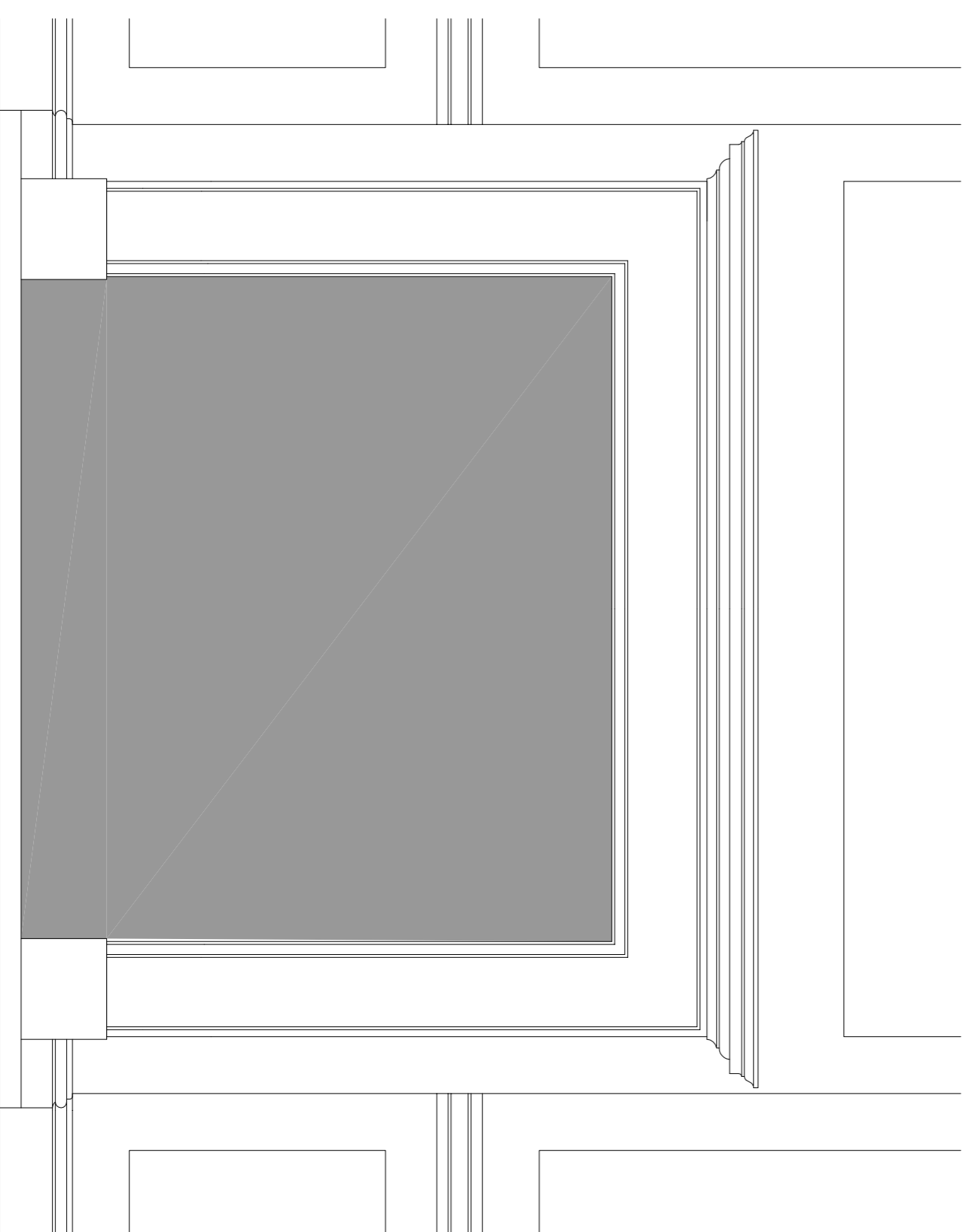

r1.02 Fireplace E Elevation - Burnley

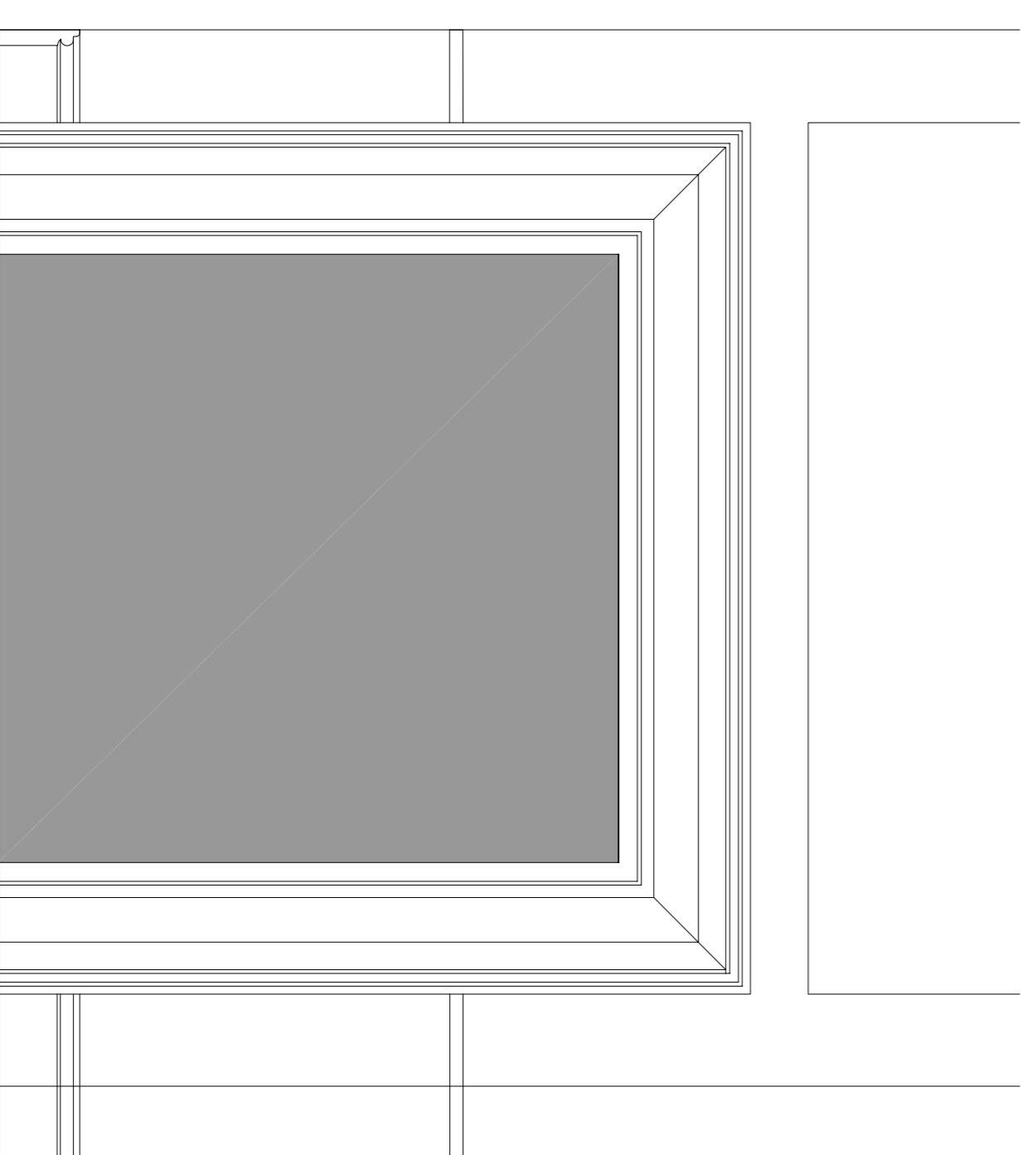

r1.03 Fireplace F Elevation - Ruppell

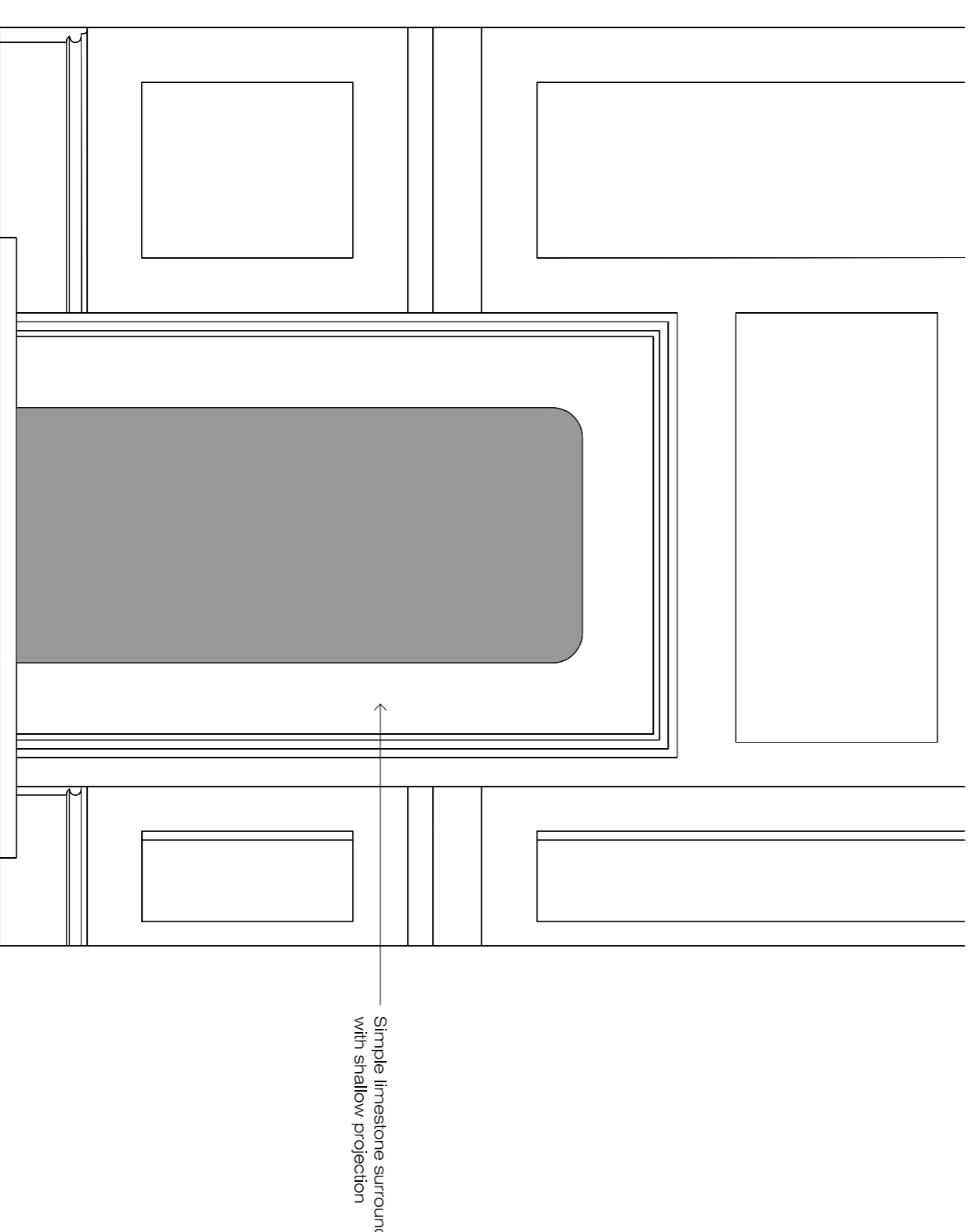

r1.04 Fireplace G Elevation

Simple limestone surround with shallow projection

First Floor Fireplaces

Client: Mr R Crowley
Project: 34 Great James Street
Drawing: Proposed Fireplaces



ETCHINGAM MORRIS
 ARCHITECTURE LTD
 www.etchingham-morris.co.uk

The Studio
 Rear of 43 / 45 High Street
 Ringwood
 Hampshire BH24 1AD
T: 01428 483155 **F:** 01428 483156
E: fordesk@etchingham-morris.co.uk

Date: Jun 2019 **Dwg No:** ST711-97
Scale: 1:10 (A1)

Proposed Alterations to 34 Great James Street, Bloomsbury, London, WC1N 3HB

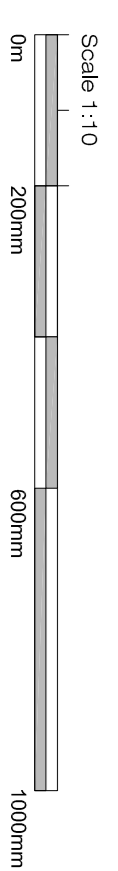

Scale 1:10

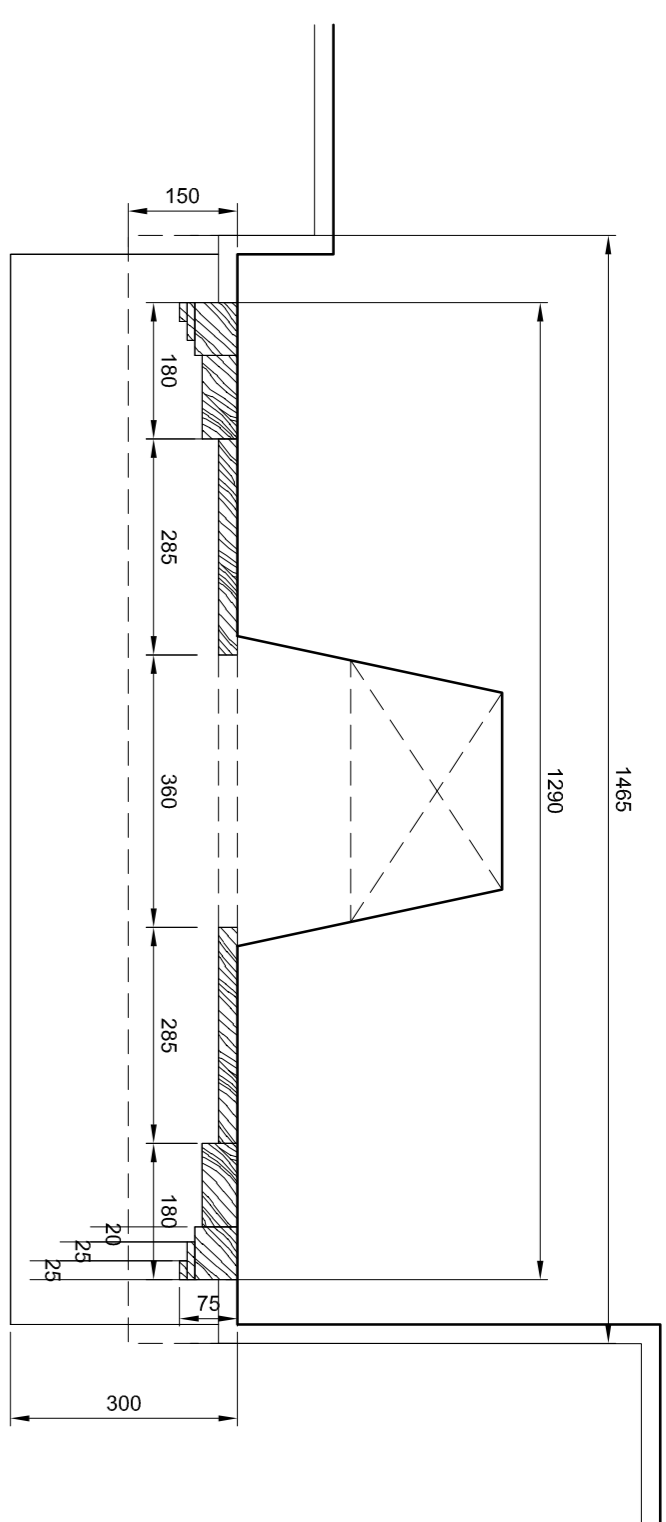

r2.03 Fireplace H Plan

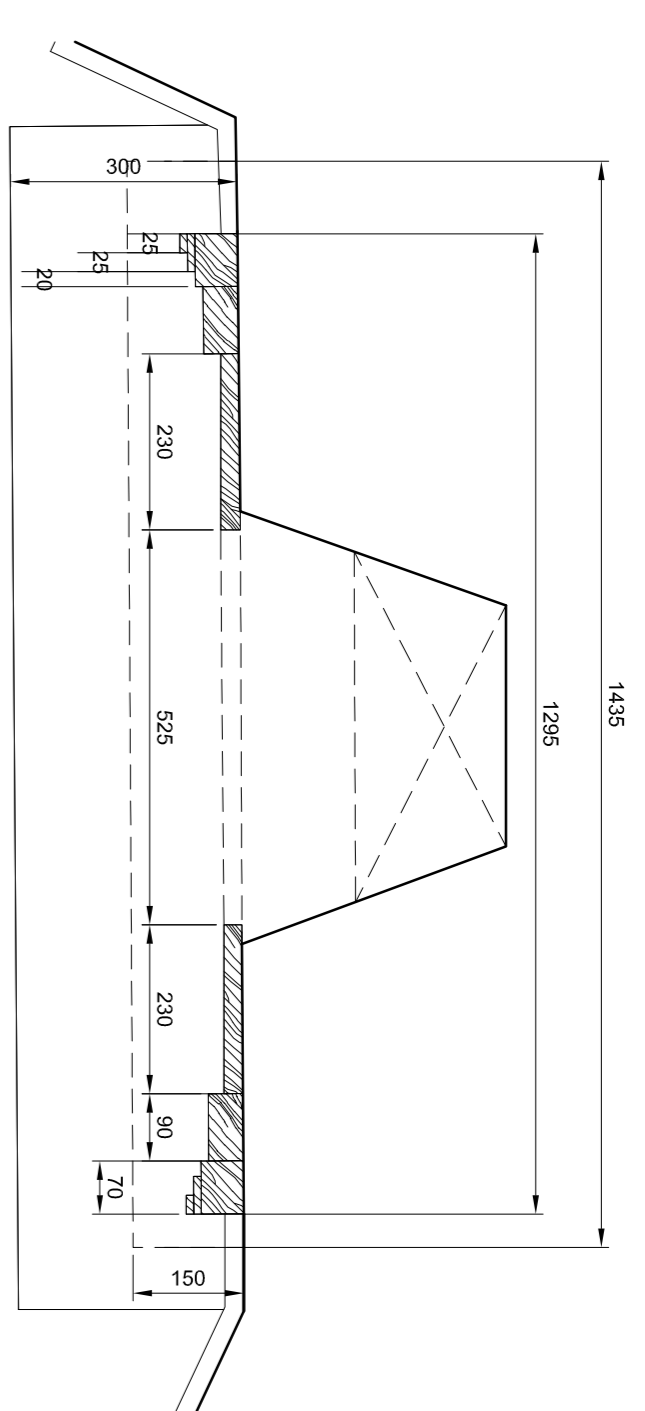

r2.05 Fireplace I Plan

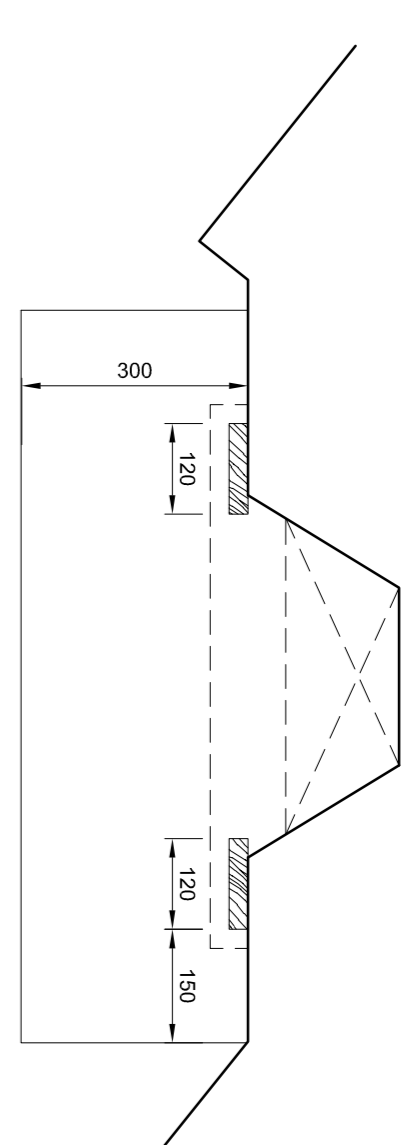

r2.06 Fireplace J Plan

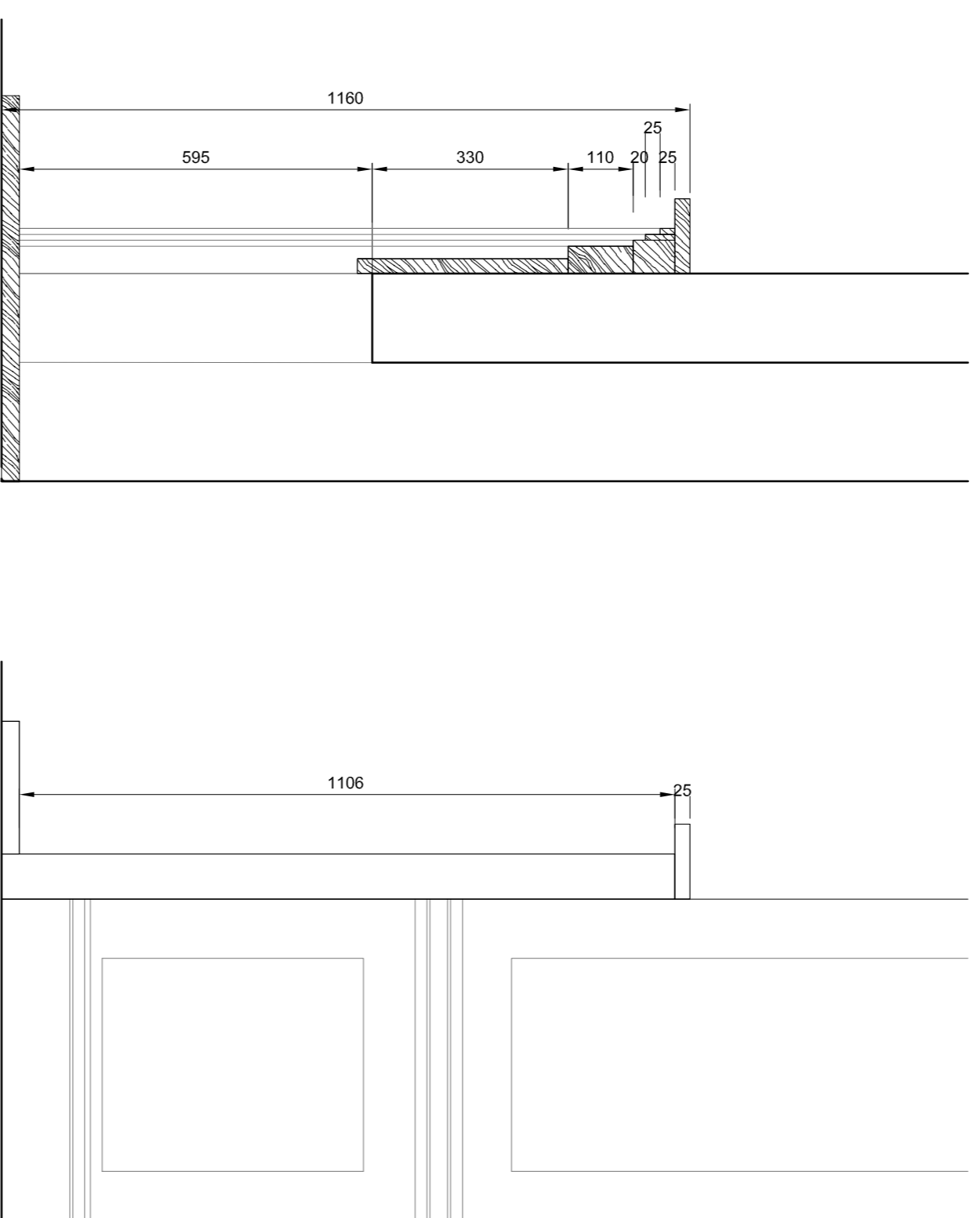

r2.03 Fireplace H Section

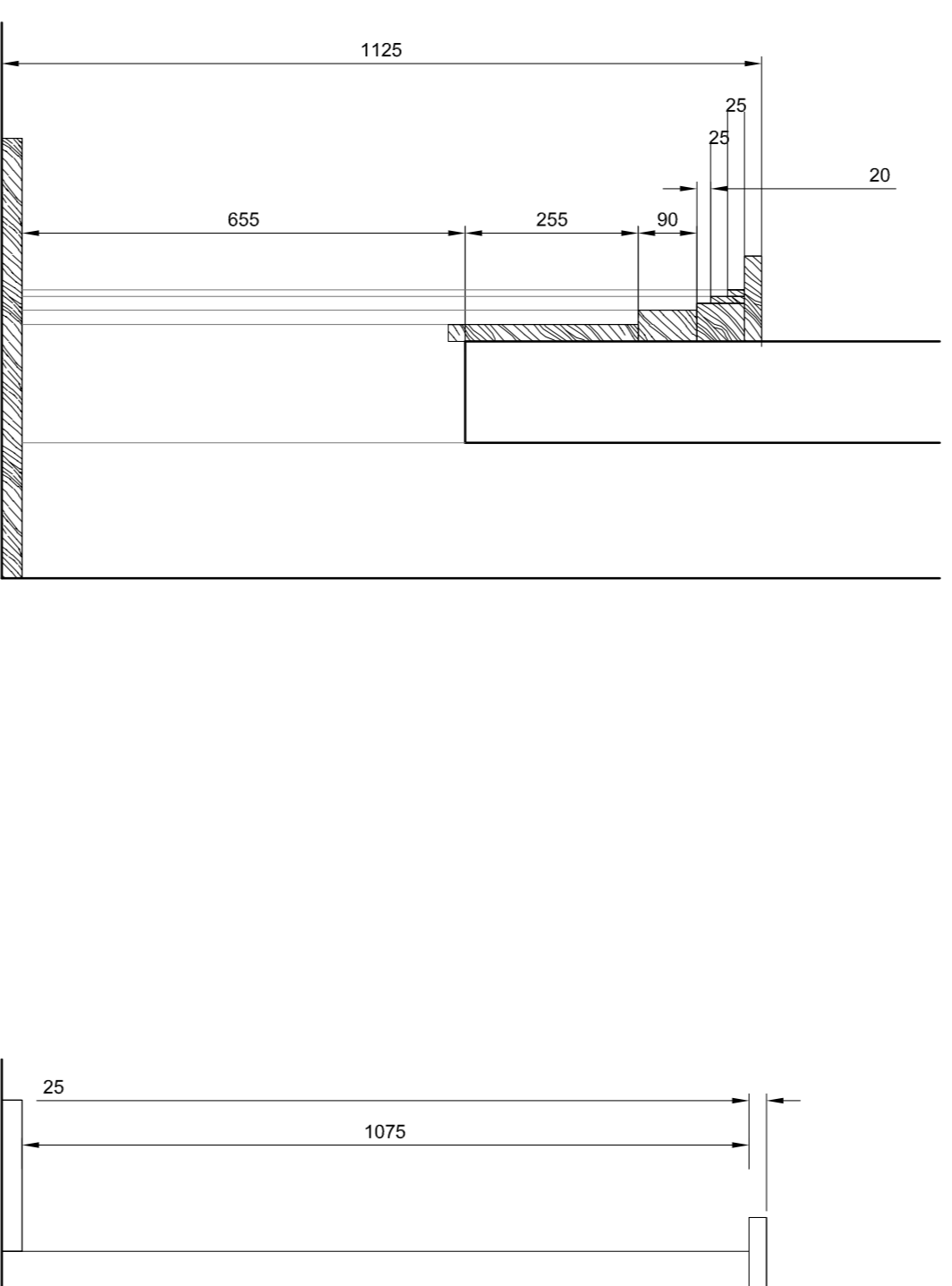

r2.05 Fireplace I Section

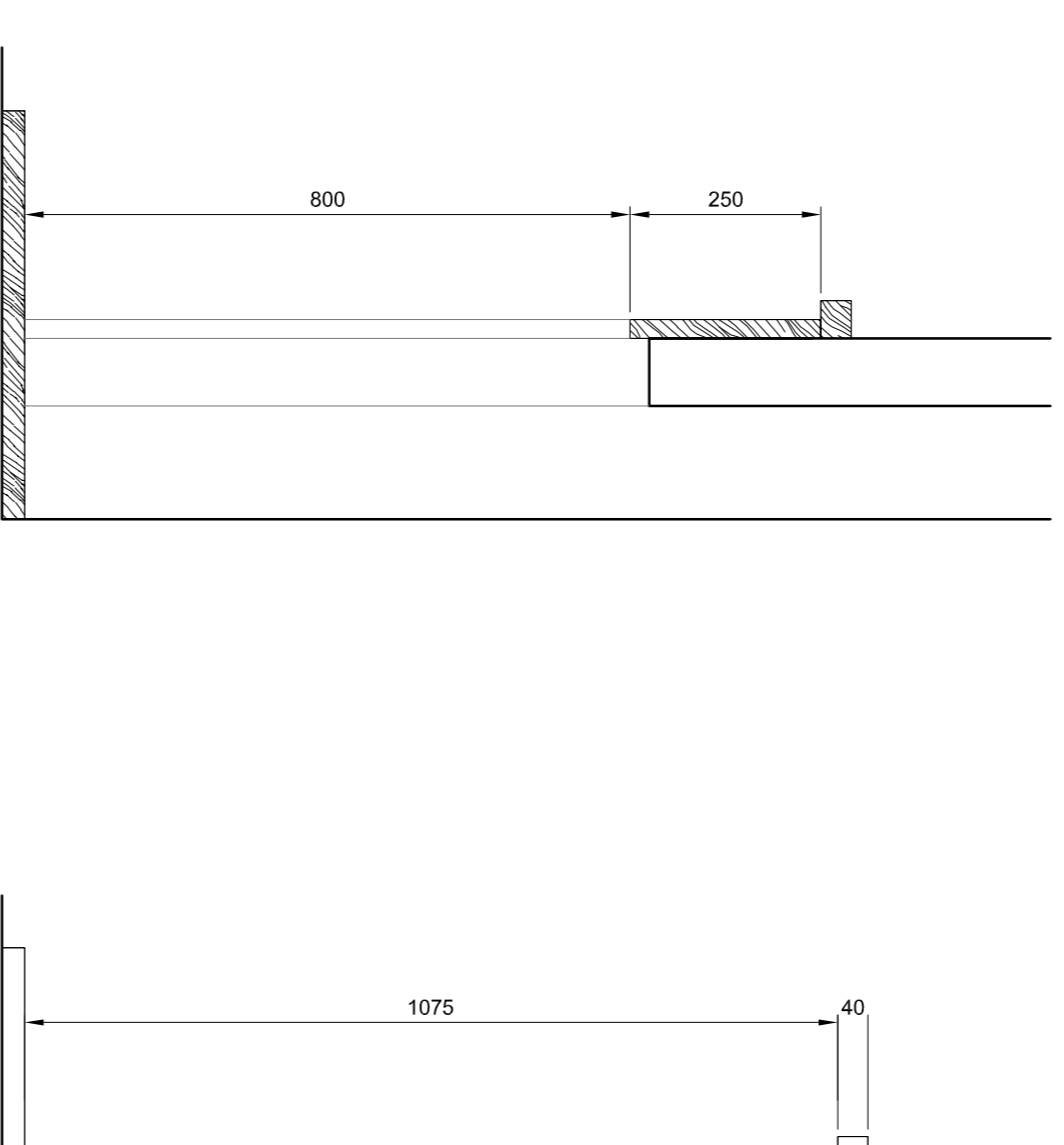

r2.06 Fireplace J Section

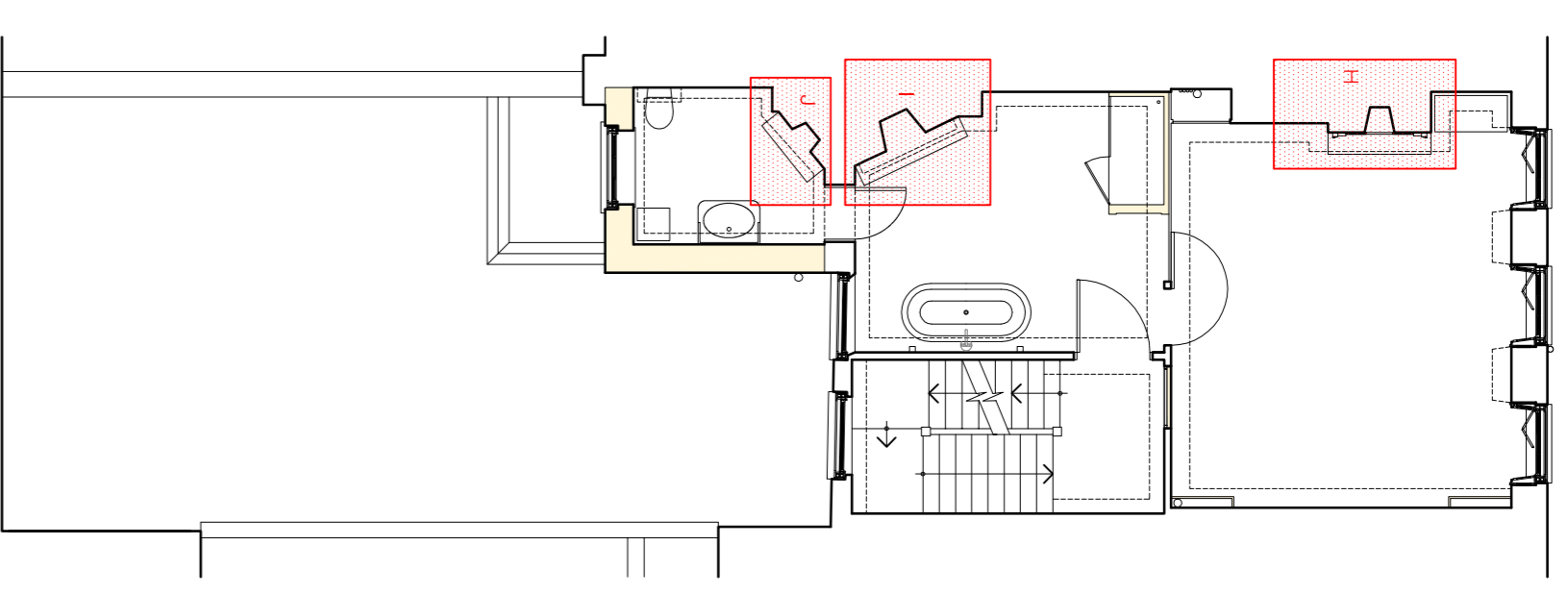

Key Plan

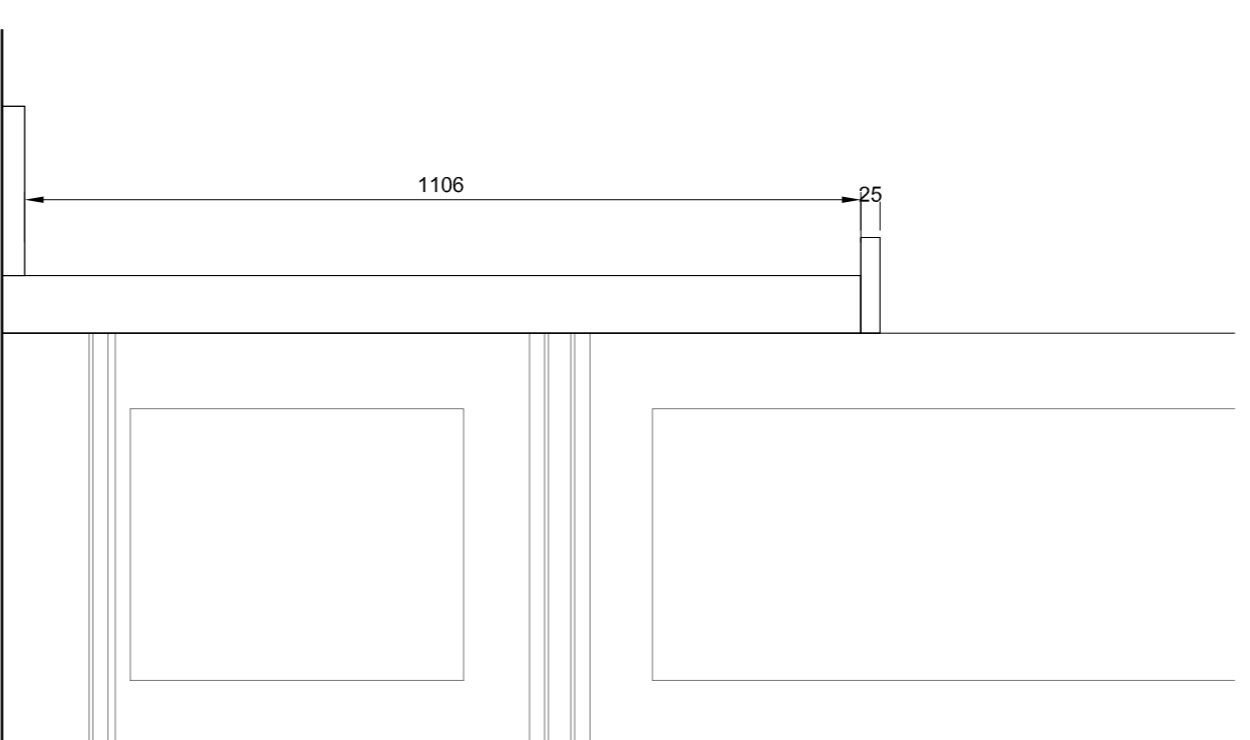

r2.03 Fireplace H Side Elevation

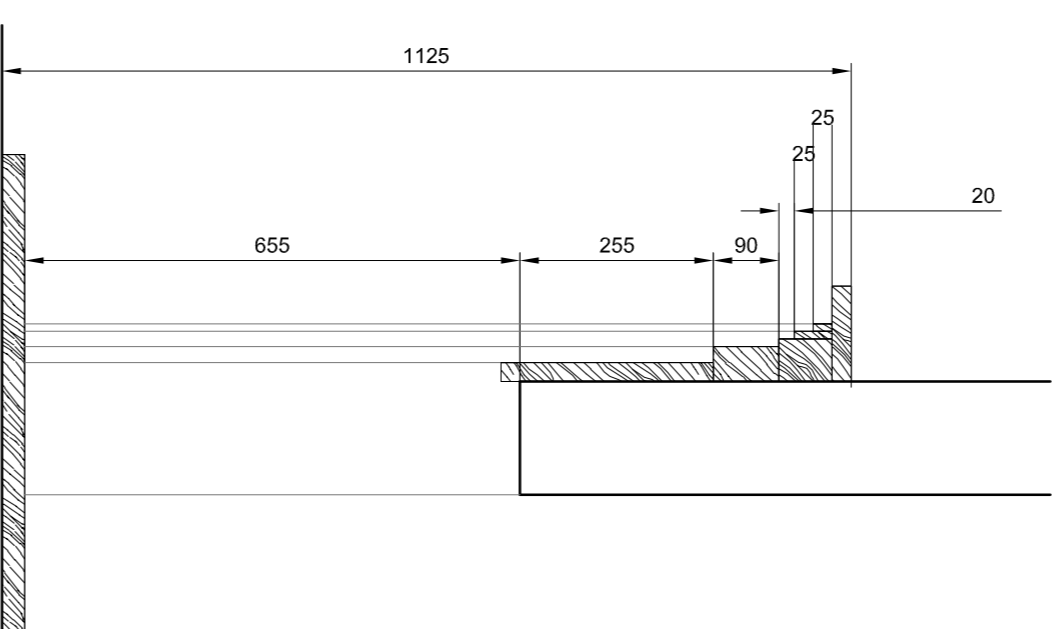

r2.05 Fireplace I Side Elevation

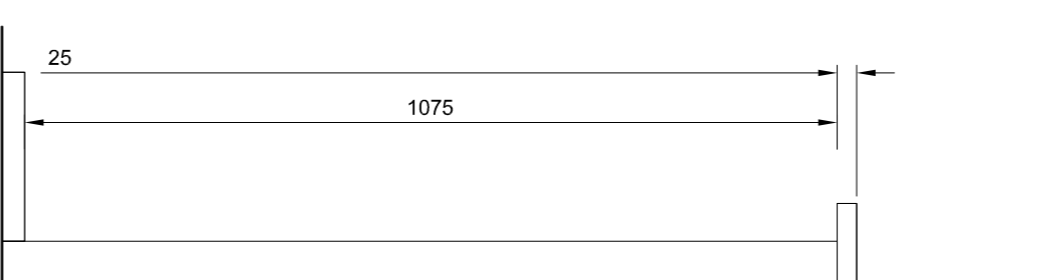

r2.06 Fireplace J Side Elevation

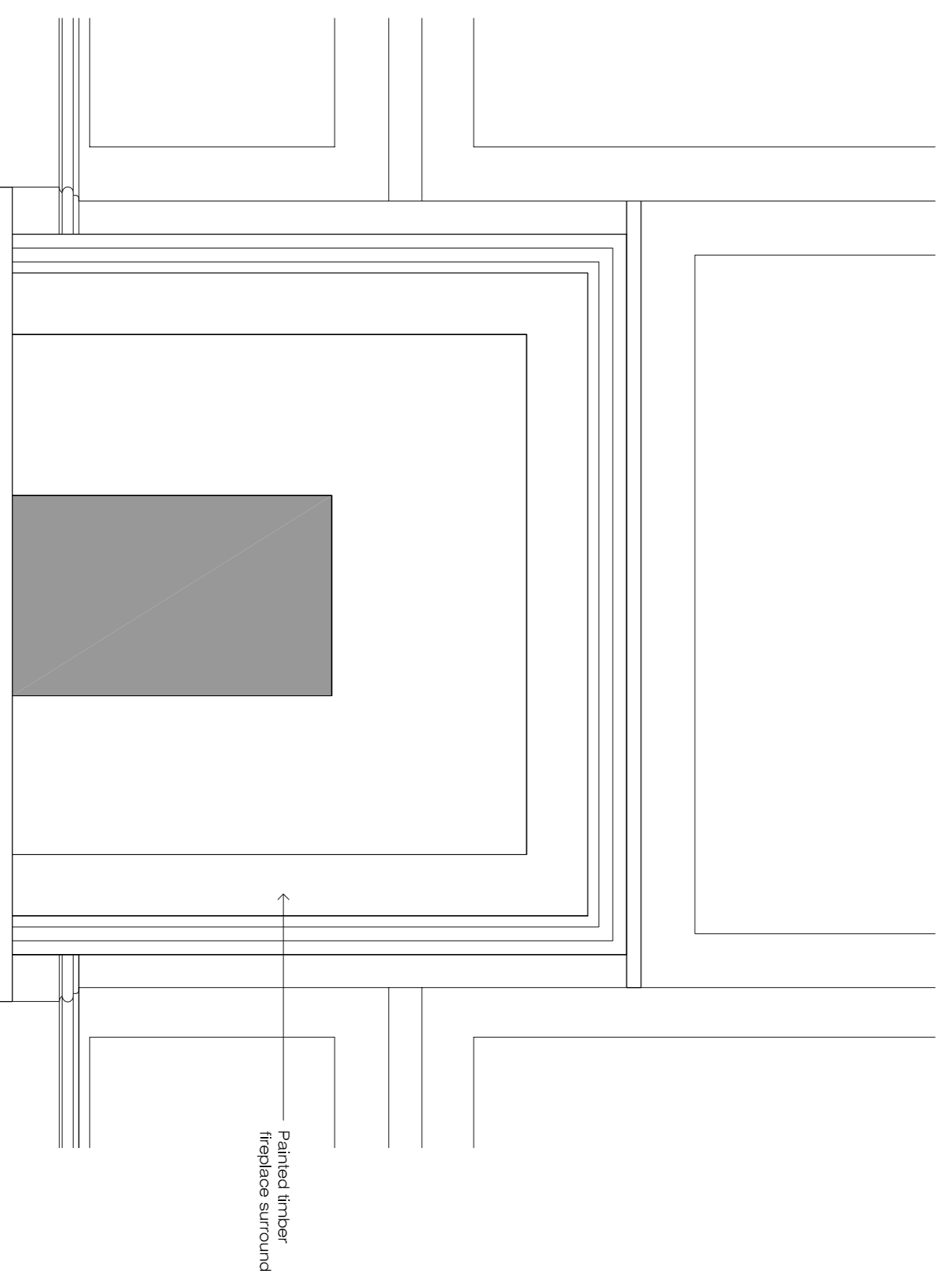

r2.03 Fireplace H Elevation

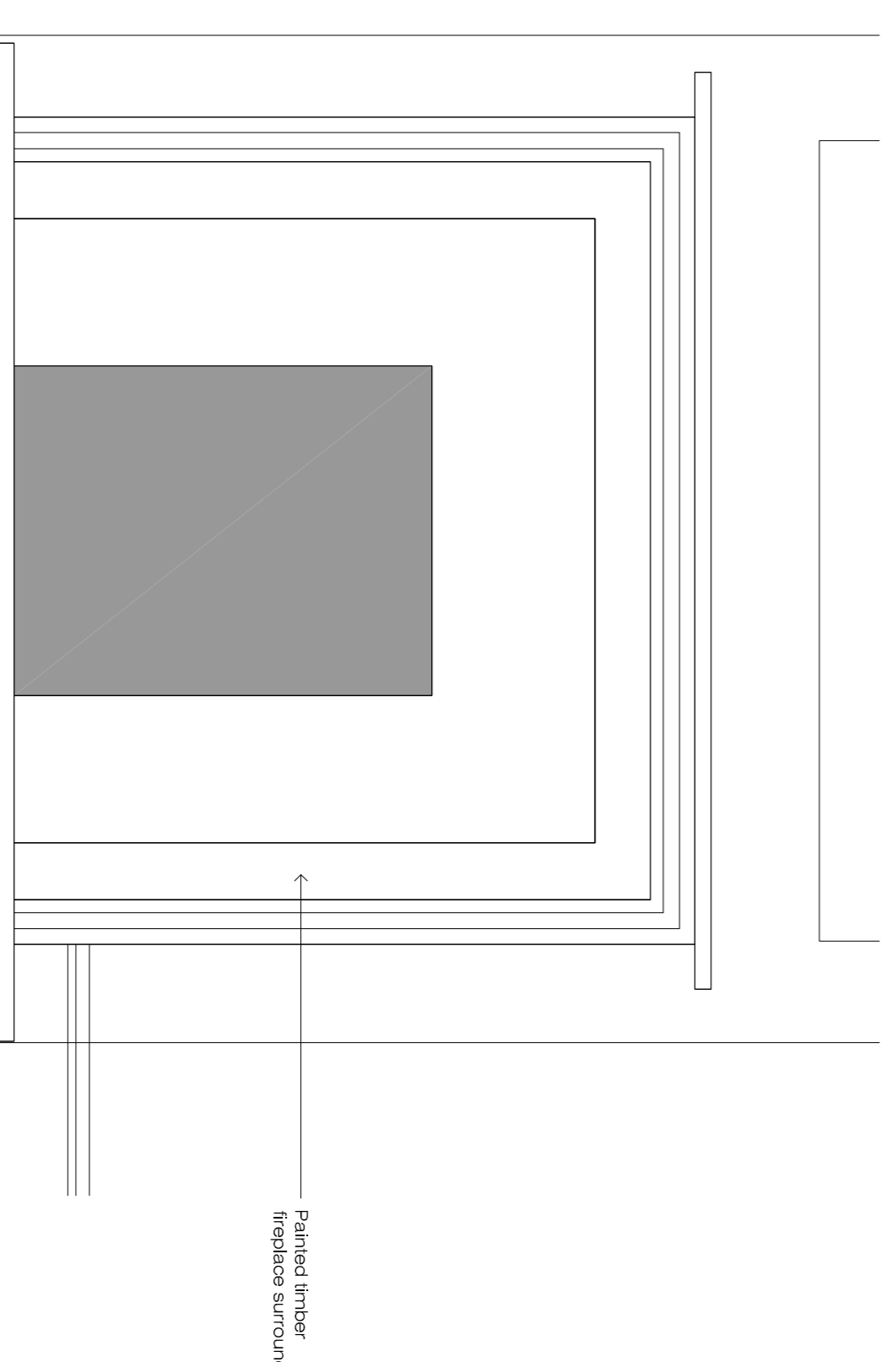

r2.05 Fireplace I Elevation

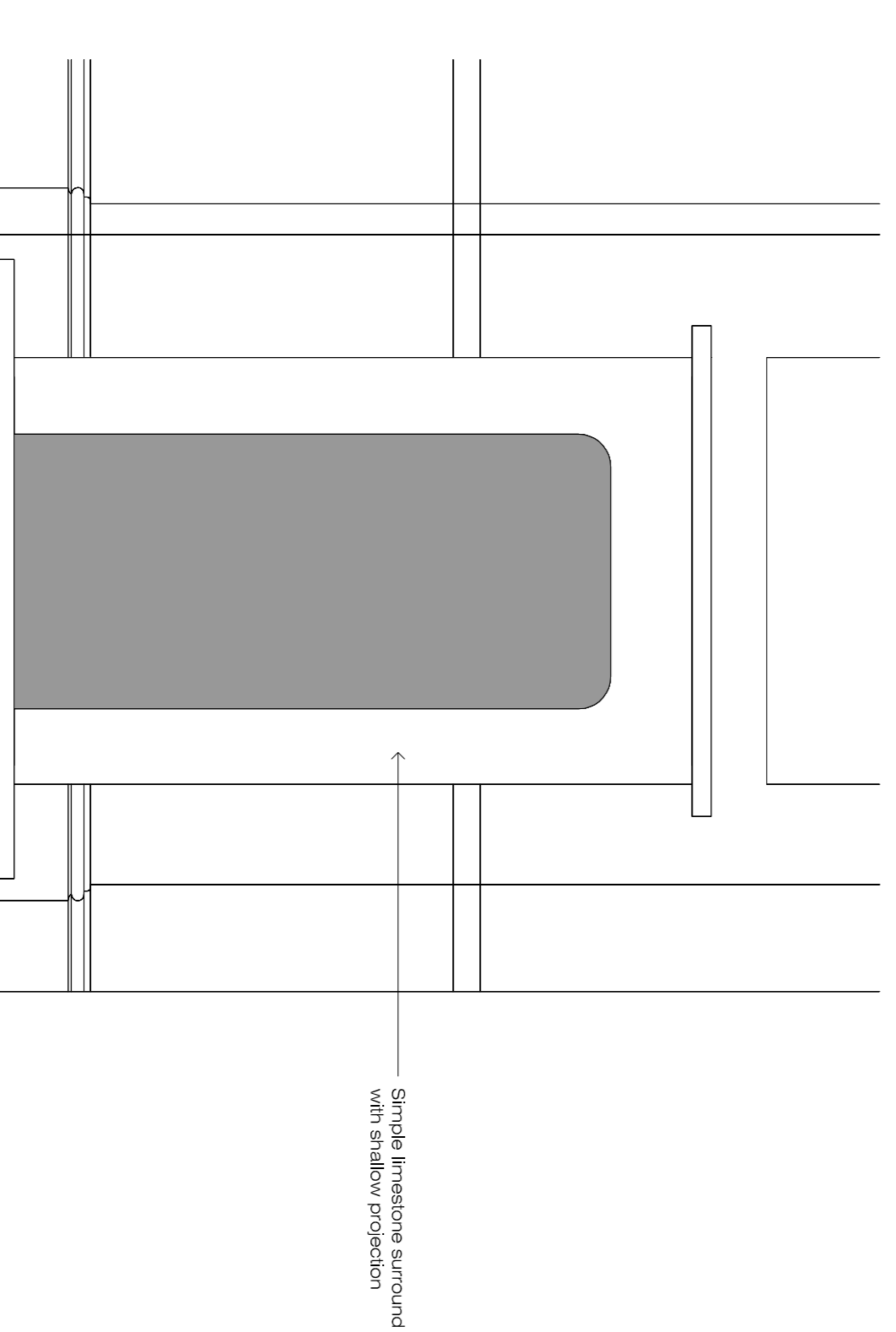

r2.06 Fireplace J Elevation

Second Floor Fireplaces

Client: Mr R Crowley
 Project: 34 Great James Street
 Drawing: Proposed Fireplaces



ETCHINGAM MORRIS
 ARCHITECTS
 www.etchingham-morris.co.uk

The Studio
 Rear of 43 / 45 High Street
 Ringwood
 Hampshire BH24 1AD
 T: 01428 483155 F: 01428 483156
 E: frontdesk@etchingham-morris.co.uk

Date: Jun 2019 Dwg No: ST711-98
 Scale: 1:10 (A1)

Proposed Alterations to 34 Great James Street, Bloomsbury, London, WC1N 3HB

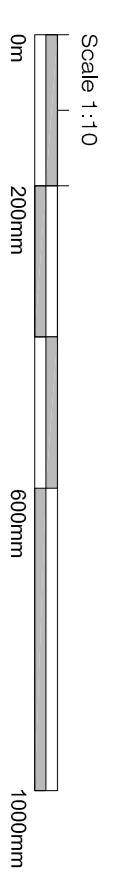

Scale 1:10

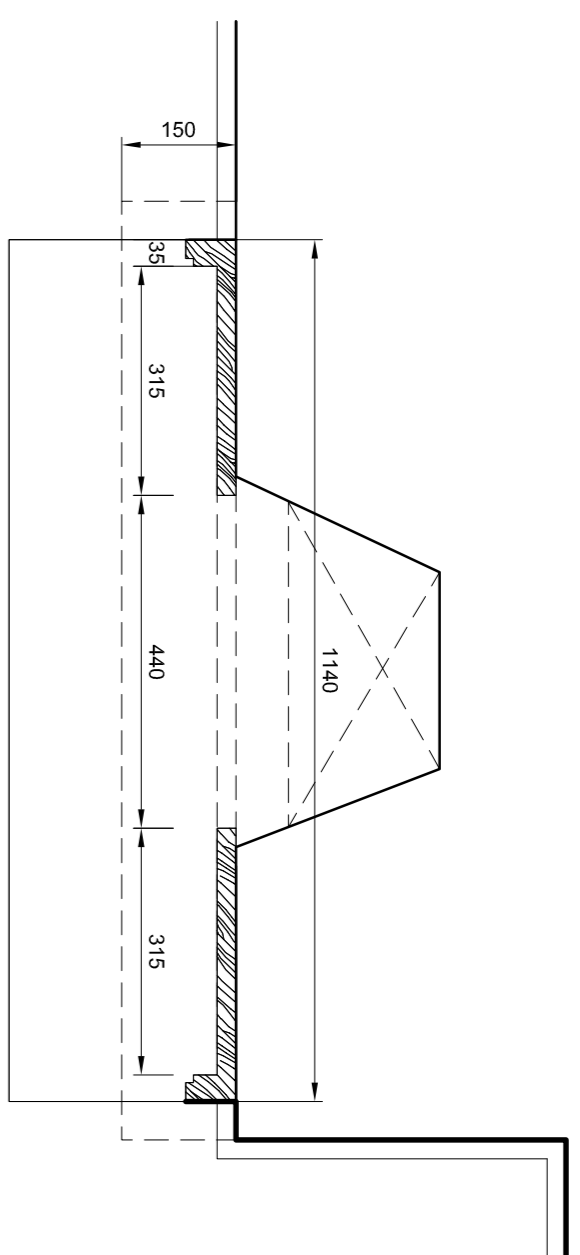

r3.02 Fireplace K Plan

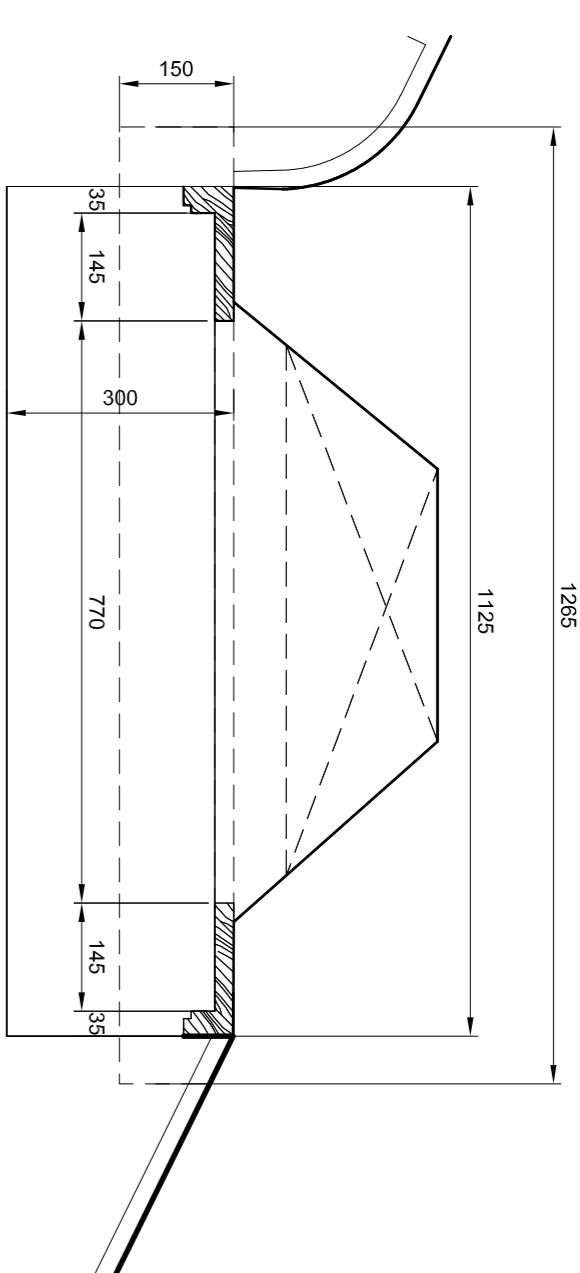

r3.05 Fireplace L Plan

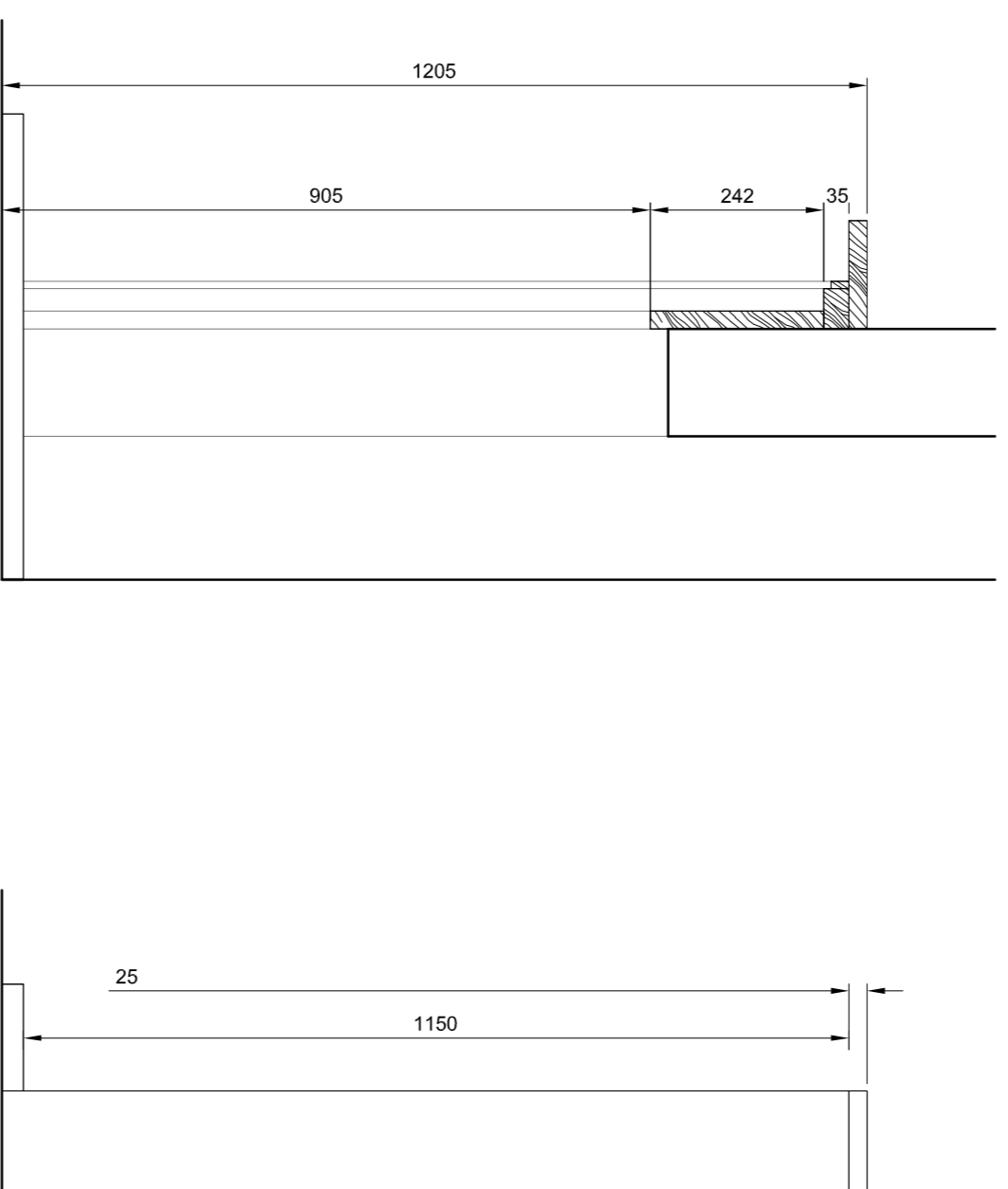

r3.02 Fireplace K Section

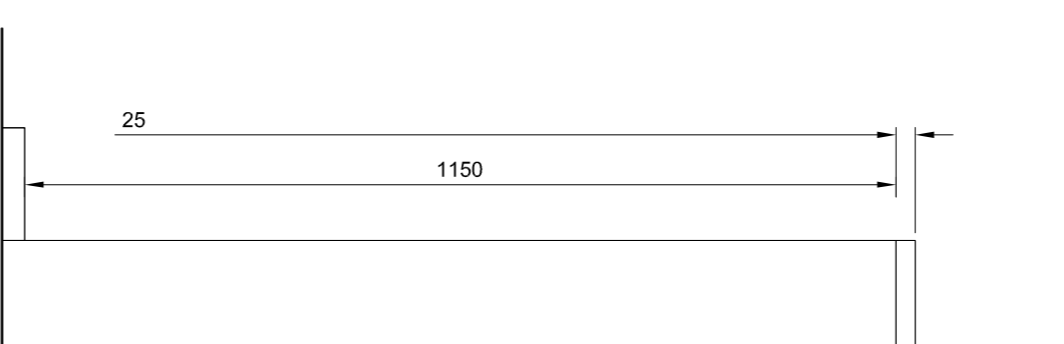

r3.02 Fireplace K Side Elevation

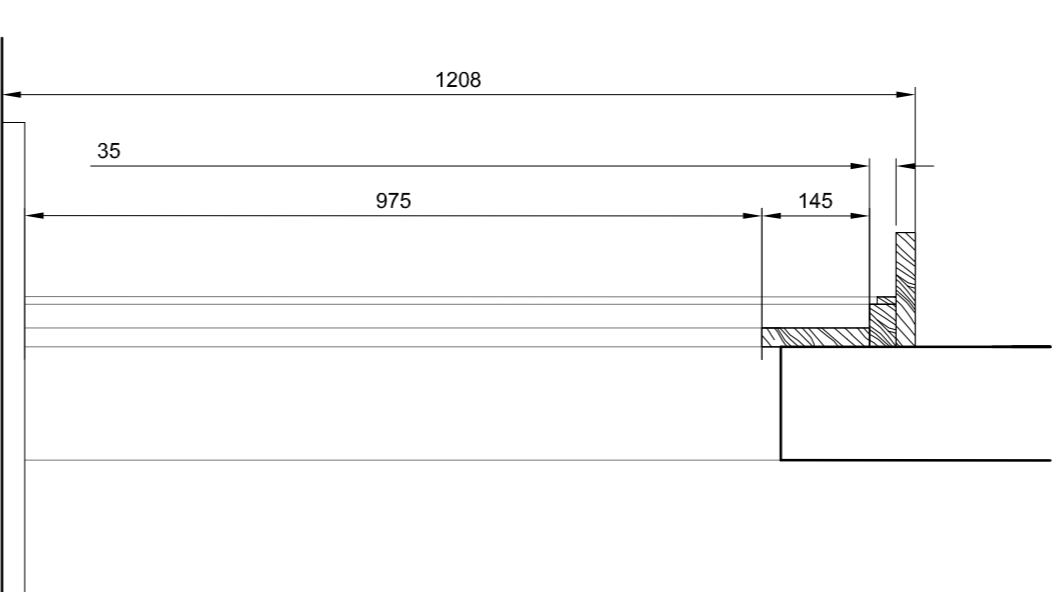

r3.05 Fireplace L Section

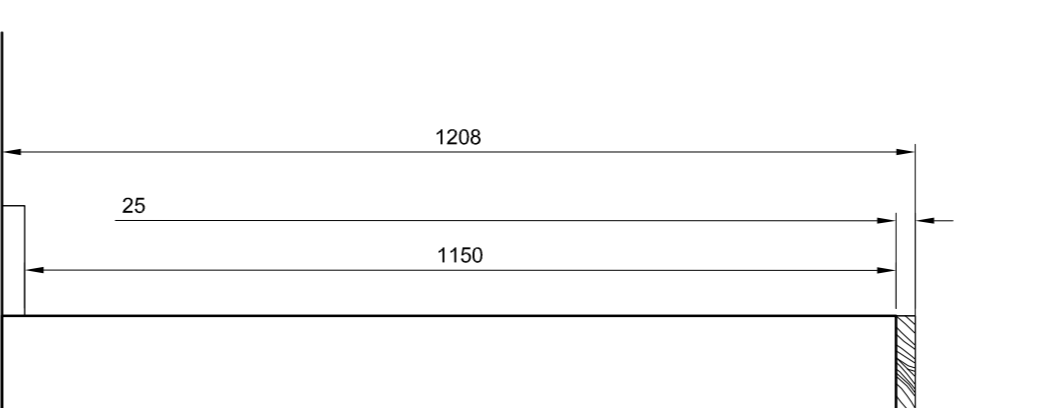

r3.05 Fireplace L Side Elevation

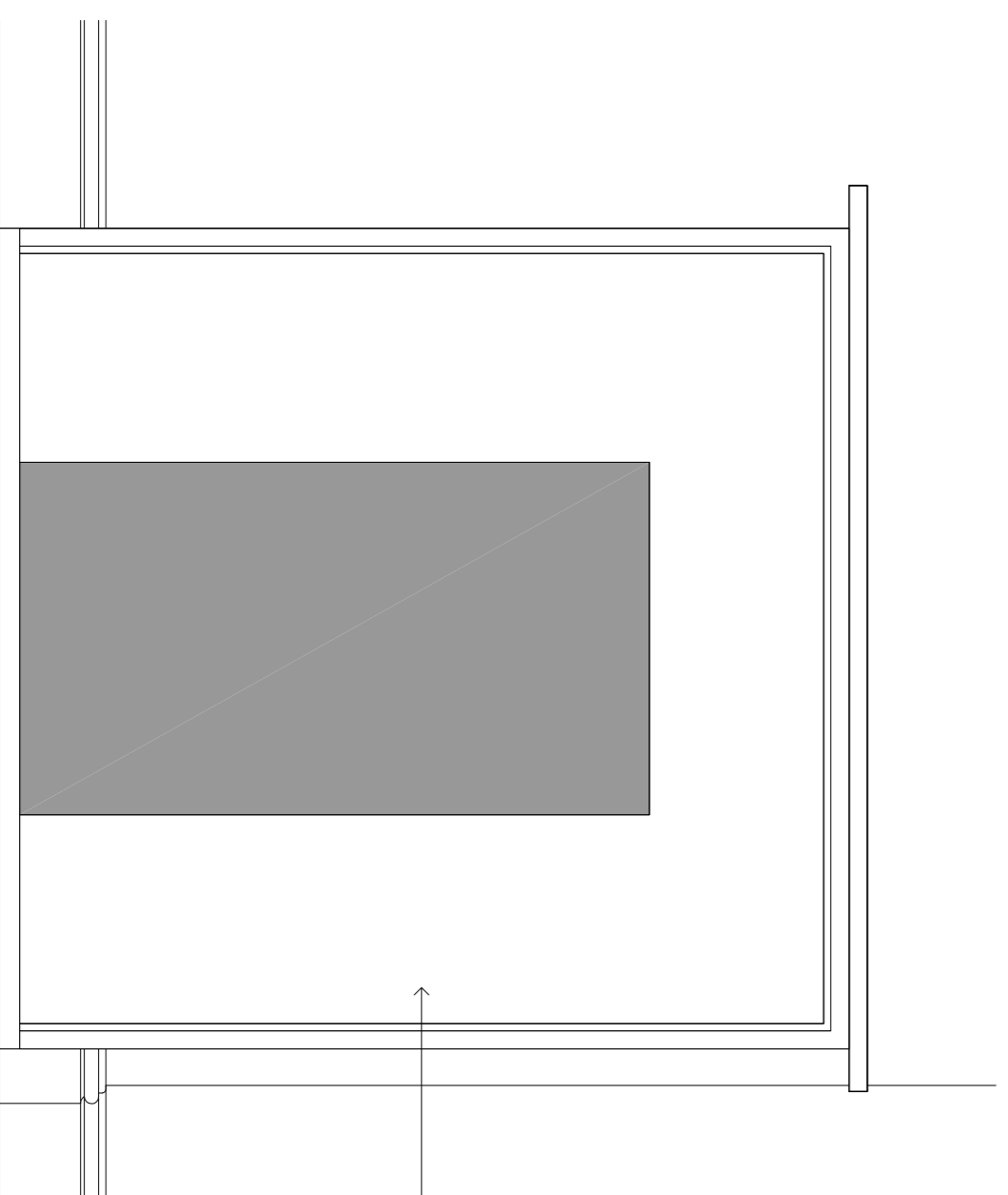

r3.02 Fireplace K Elevation

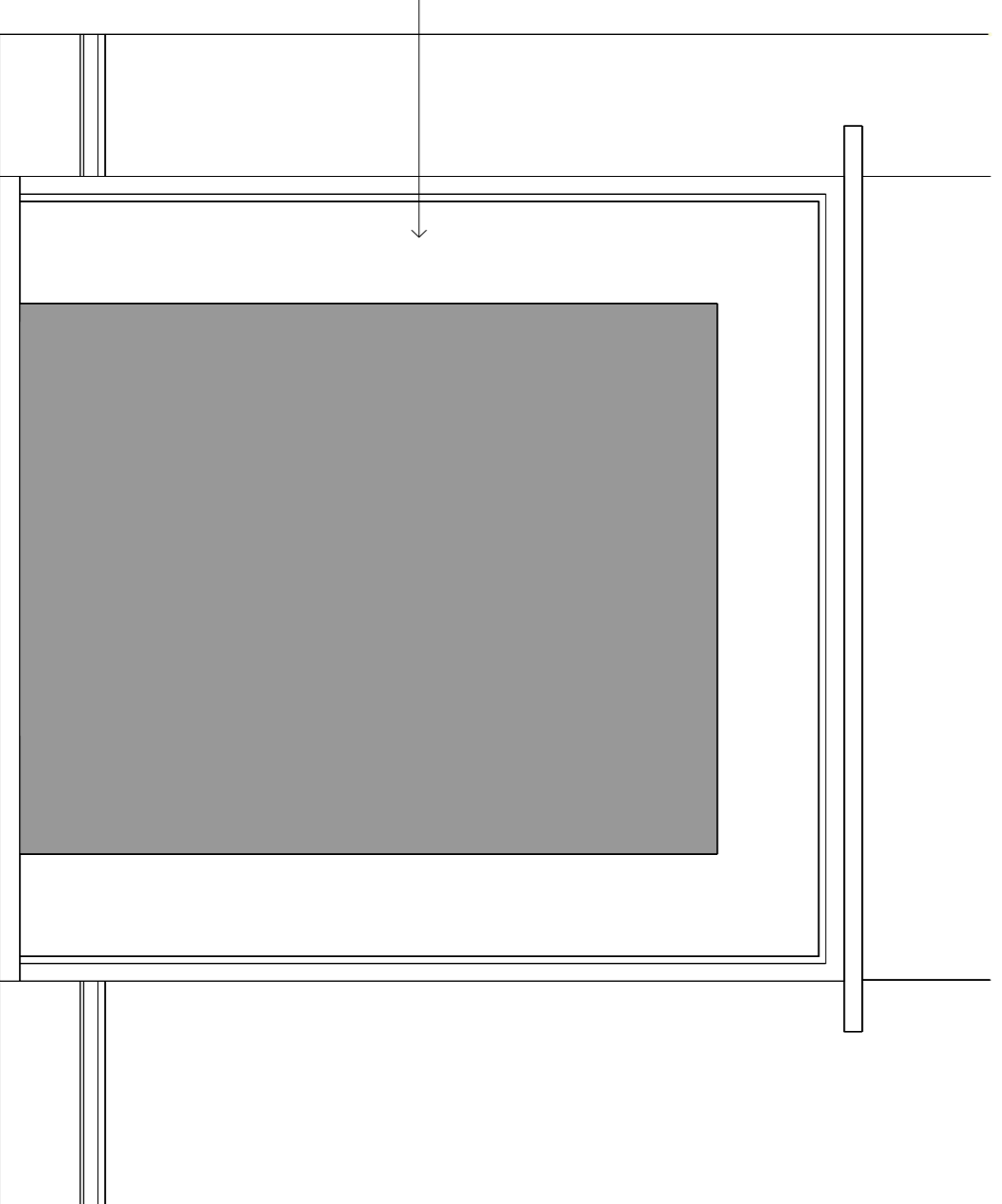

r3.05 Fireplace L Elevation

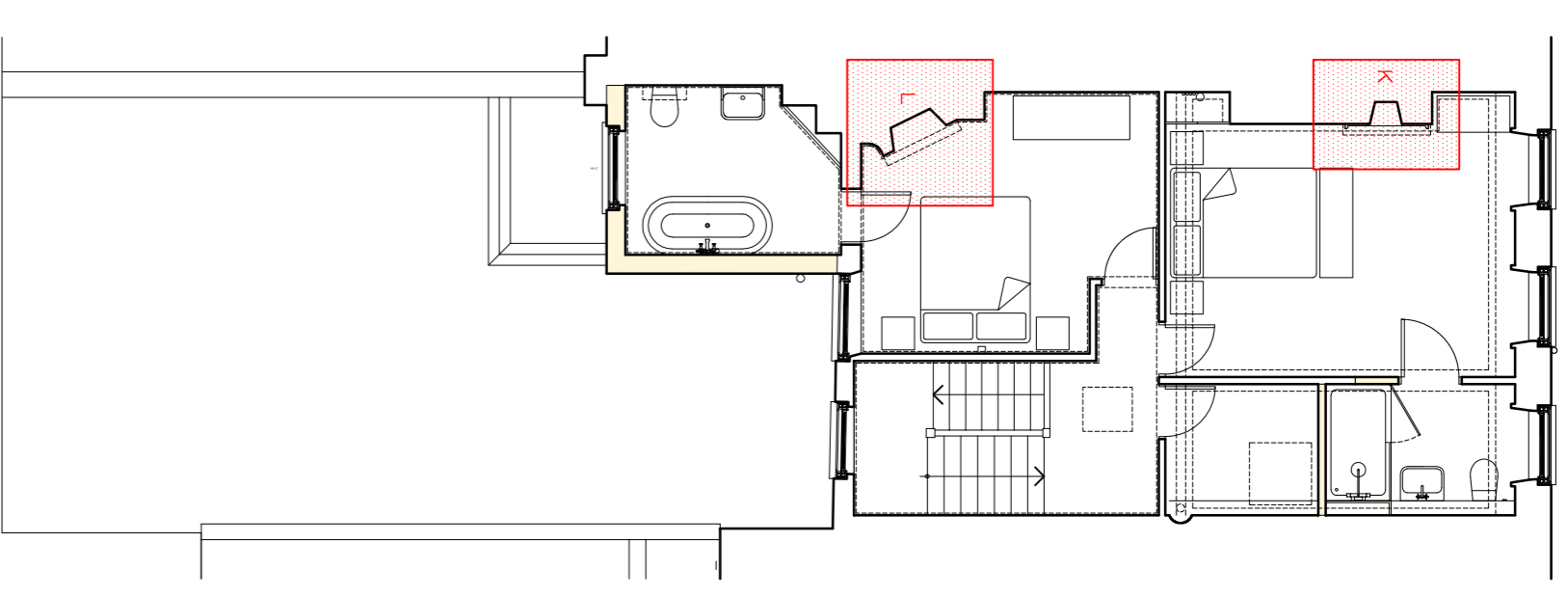

Key Plan

Painted timber surround

Third Floor Fireplaces

Client: Mr R Crowley
Project: 34 Great James Street
Drawing: Proposed Fireplaces

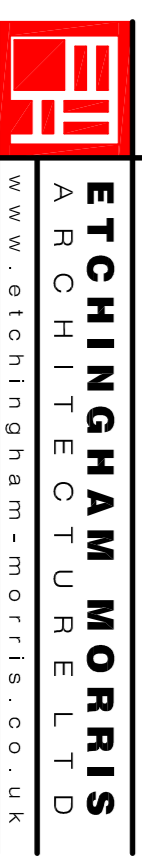

ETCHINGAM MORRIS
 ARCHITECTS LTD
 www.etchingham-morris.co.uk

The Studio
 Rear of 43 / 45 High Street
 Ringwood
 Hampshire BH24 1AD
T: 01428 483155 **F:** 01428 483156
E: frontdesk@etchingham-morris.co.uk

Date: Jun 2019 **Dwg No:** ST711-99
Scale: 1:10 (A1)

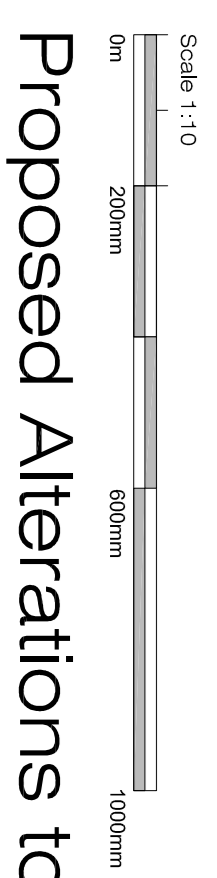

Proposed Alterations to 34 Great James Street, Bloomsbury, London, WC1N 3HB