



# GLACIER

## Coldrooms



# Welcome to Glacier Coldrooms

▶ **GLACIER Coldrooms** employs designers with many years' of completing successful projects within the cold store and refrigerated controlled environment sector. We are reputable and innovative in providing optimal ranges of coldrooms such as Modular Coldrooms, Bespoke Coldrooms, Modular Freezers, Bespoke Freezers, Commercial and Industrial Refrigeration to cater for any kind of industry from food storage to laboratories.

We understand that a service is important to our valued customers, which is why our emphasis is on providing a friendly, professional and an efficient service ensuring that projects are completed on time with 100% reliability and full co-operation.



With our certified engineers and enthusiastic team, we are always ready to assist and to make things easier, we will manage the entire process of your project from start to finish at no extra cost.

Whatever the customers' requirements are, we will provide consultation as well as design, offering an 'Off the Shelf' service which will reduce costs and advise on practical solutions if it is needed. We make sure that our customers get the best quality products which will not only be efficient but also provide longevity. For customers who require a more specialist solution, we will provide a bespoke package that will meet your requirements.

Nationwide coverage: We operate and supply solutions in any location in the UK from our London and Manchester office.

**GLACIER** Coldroom shelving is strong and robust made from a polished nickel chrome finish. It is able to hold up to 300kg per shelf.

- Quick and easy to assemble – no tools needed.
- Heights can be adjusted easily at different positions to suit the customers' requirements.
- A variety of combinations available to maximise customer storage.
- Food safe



Energy Saving LED lighting Supplied As Standard

# Why Glacier Coldrooms?

- ▶ The **GLACIER** range of coldrooms is comprised of prefabricated sandwich type high density injected polyurethane foam modular panels with a unique joint configuration in male-female style.

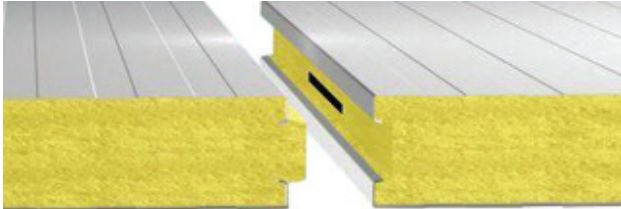

The assembly of the panels is carried out through an eccentric hook (stainless steel AISI 430), which when turned  $\frac{3}{4}$  of a turn will lock onto the female side of the panel, locking both panels together tightly and aesthetically.



Assembly is fast thanks to a fastening system which Glacier has developed, besides being quick and simple, guarantees perfect adjustment between vertical panels, as well as between vertical and ceiling panels. Due to that, the insulation which the cold room offers is complete, complying with its function with the best results. The Glacier joint system is as simple to loosen as to adjust, which facilitates dismantling the panel quickly if required.

## Interchangeable Panels

Cold room assembly has been made simpler by unifying panel design, making them interchangeable. Any panel can be used for a wall or ceiling, as they all incorporate an exclusive system whereby then can be assembled in any vertical panel, giving total stability to the ceiling.

Glacier Coldrooms offers a range of thicknesses adaptable to different insulation; 60mm, 80mm and 100mm.



Wall Mounted Unit

Total Insulation: All joints, instead of being plane, are any position.



Remote Mounted Unit

- 100's of 'Off-the-Shelf' sizes from 2m<sup>3</sup> to 50m<sup>3</sup> capacities in each thickness and heights.
- Cold (-2/+12°C) and Freezer (-18/-21°C) temperature ranges from the same refrigeration module for added flexibility.
- Wall mounted, roof mounted and remote units available.
- Suitable for ambient operation up to +28°C (please call us for higher ambients).
- Overall height starting from 1820mm all the way up to 3220mm.
- Floored and floorless models available; standard non slip, reinforced and stainless steel finished.
- White, foodsafe laminate finish to the exterior and interior. Other finishes also available, such as stainless steel.
- Lockable, right or left hand hinged door as standard complete with keylock and emergency release.
- Door comes with internal safety release handle for added safety in use.
- Internal light as standard
- Digital temperature display with easy to adjust controls.
- Heavy duty, 3 tier, nylon coated racking available.

# Glacier Flexible Storage

▶ Below are a very small selection of sizes

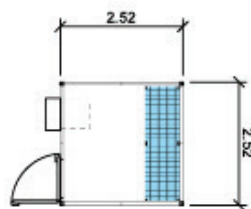

GL2525

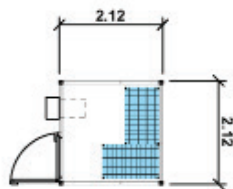

GL2121

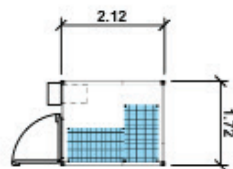

GL1721

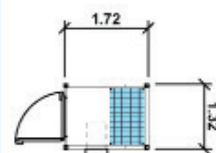

GL1317



GL2529

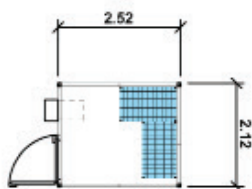

GL2125

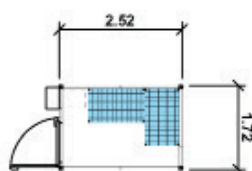

GL1725

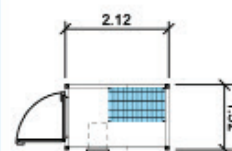

GL1321

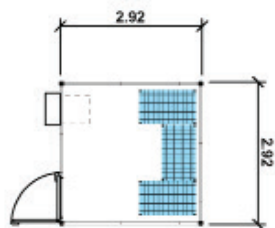

GL2929

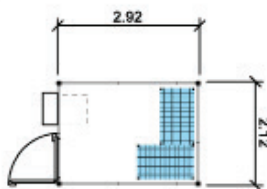

GL2129

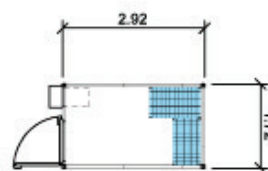

GL1729

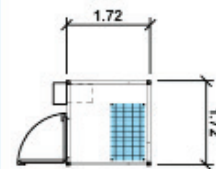

GL1717



## Nationwide Free Delivery

Glasgow Contact Number: 0141 648 8770

Birmingham Contact Number: 0121 796 4451

London Contact Number: 0203 640 5889

Manchester Contact Number: 0161 667 0704