

**SETTING OUT NOTE A:**  
 Setting Out of Entire Terrace Decking and Cladding is Dictated by the Existing Main Transfer Beams. New 100 x 50 RHS Rectangular Frame fixed on Main Transfer Beams as per S.E. Specifications. The Rooflights are also to be aligned with each other, and square with the decking planks.

See Drawings: 862/A/202, 862/A/203 & 862/A/204 for

**SETTING OUT NOTE B:**  
 Planters shown are readily available standard sizes, and have been arranged as such that there are no large gaps. They should sit circa 100mm back from the rear terrace railings, and line up with the vertical cladding along both partywall lines.

(Contractor to mark out on terrace future planter locations for review and approval with the Client Design Team prior to placing order).

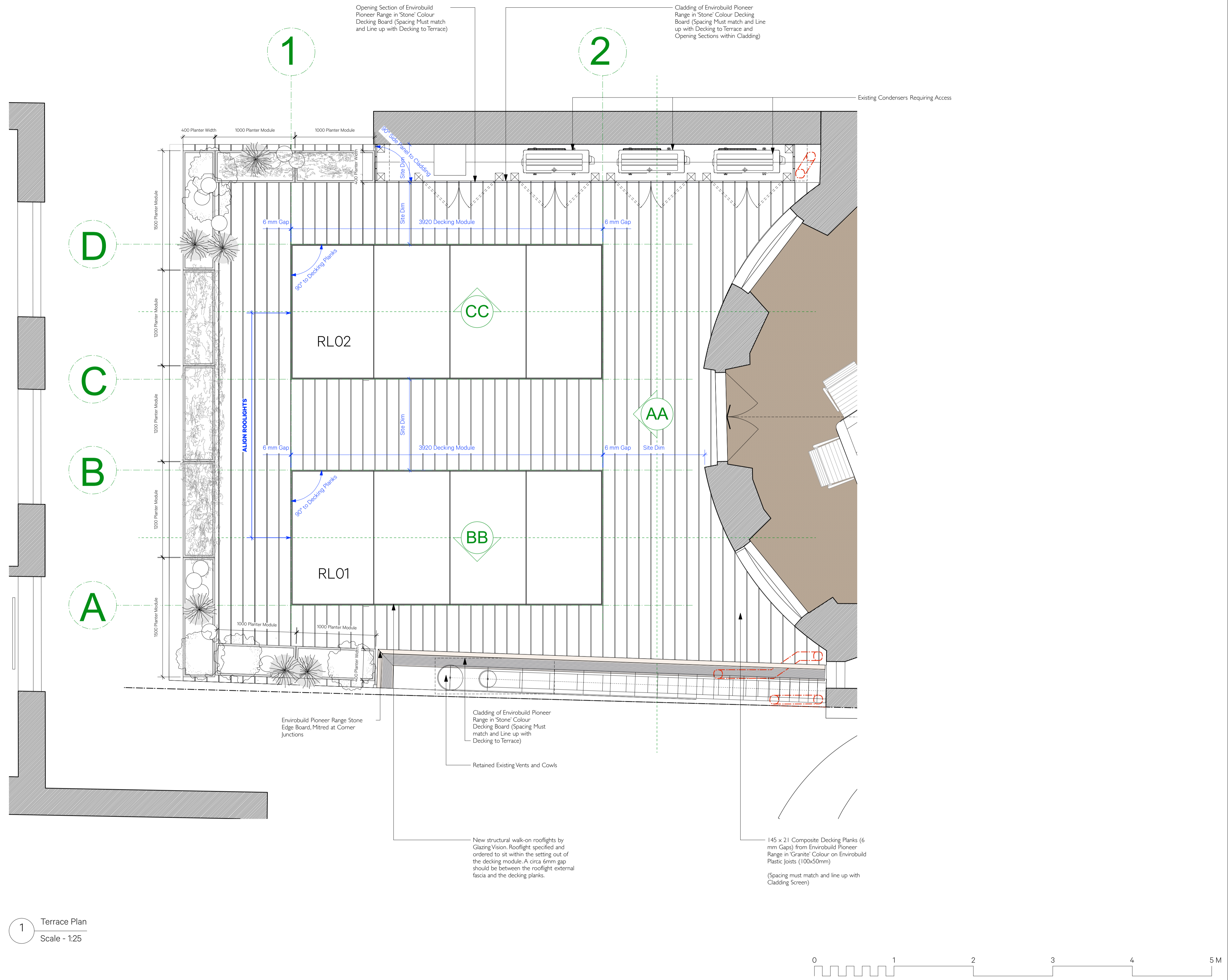

1 Terrace Plan  
 Scale - 1:25

| Revision | Date       | Amendment          | Notes |  |  |  |  | Client     | UCL Institute of Innovation & Public Purpose |  |           |
|----------|------------|--------------------|-------|--|--|--|--|------------|--|--|-----------|
| C1       | 12.08.2019 | Construction Issue |       |  |  |  |  | Project    | 11 Montague Street                           |  |           |
|          |            |                    |       |  |  |  |  | Drawing    | Terrace/Rooflight Plan                       |  |           |
|          |            |                    |       |  |  |  |  | Scale      | 1:25 @ A1 / 1:50 @ A3                        | Drawn  | GB        |
|          |            |                    |       |  |  |  |  | Date       | August 2019                                  |  |           |
|          |            |                    |       |  |  |  |  | Project N° | 862  | Drawing N°   | 862/A/201 |
|          |            |                    |       |  |  |  |  |            |  | Revision   | C1        |
|          |            |                    |       |  |  |  |  |            |  | <b>Burwell Architects</b><br><small>info@burwellarchitects.com<br/>         www.burwellarchitects.com</small>          |           |
|          |            |                    |       |  |  |  |  |            |  | <small>Unit 001<br/>         California Building<br/>         London SE13 7SF<br/>         +44 (0) 2083 056010</small> |           |

NO DIMENSIONS ARE TO BE SCALED FROM THIS DRAWING. THE CONTRACTOR/MANUFACTURER IS RESPONSIBLE FOR CHECKING ALL DIMENSIONS AND QUERYING ANY DISCREPANCIES. THIS DRAWING IS THE PROPERTY OF BURWELL ARCHITECTS. LTD. COPYRIGHT IS RESERVED BY THEM AND THE DRAWING IS ISSUED ON CONDITION THAT IT IS NOT COPIED, REPRODUCED, RETAINED OR DISCLOSED TO ANY UNAUTHORIZED PERSON, EITHER WHOLLY OR IN PART, WITHOUT WRITTEN CONSENT.