

SIDE ELEVATION AS PROPOSED

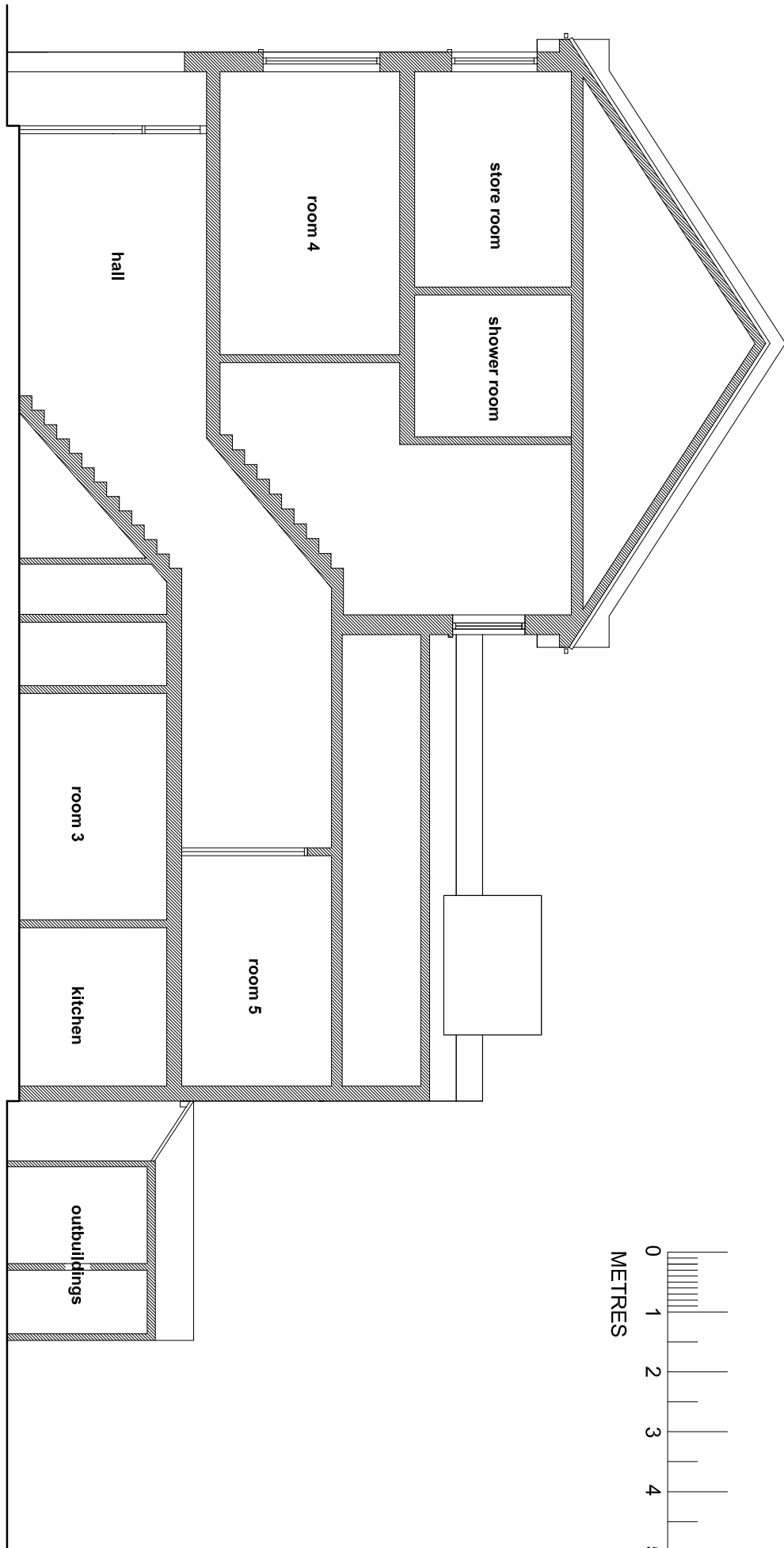
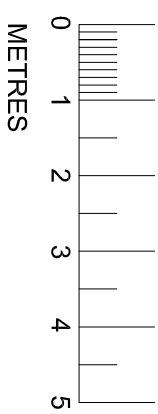

LONG SECTION AS EXISTING

REV C - LOFT CHANGED TO COMMUNAL ROOM  
 RR JULY 19TH 2019  
 REV B - ROOFLIGHT ADDED  
 RR JULY 8TH 2019  
 REV A - GF EXTENSION AND DORMERS CHANGED  
 RR JUNE 14TH 2019

PROPOSED WORKS AT  
 17 FORDWYCH ROAD  
 LONDON NE2 3TN  
 DRAWING NO. 14 REV C

LONG SECTIONS  
 AS EXISTING AND AS PROPOSED  
 1:100 @ A3  
 DRAWN RR 25.03.19

RICHARD ROBINSON RIBA  
 RR ARCHITECTS  
 3 PACIFIC COURT  
 RIVERSIDE  
 SHOREHAM BY SEA BN43 5RW  
 01273 452 634 07860 632 542  
 E-MAIL richard@rr-architects.co.uk

