

revision / date / amendments

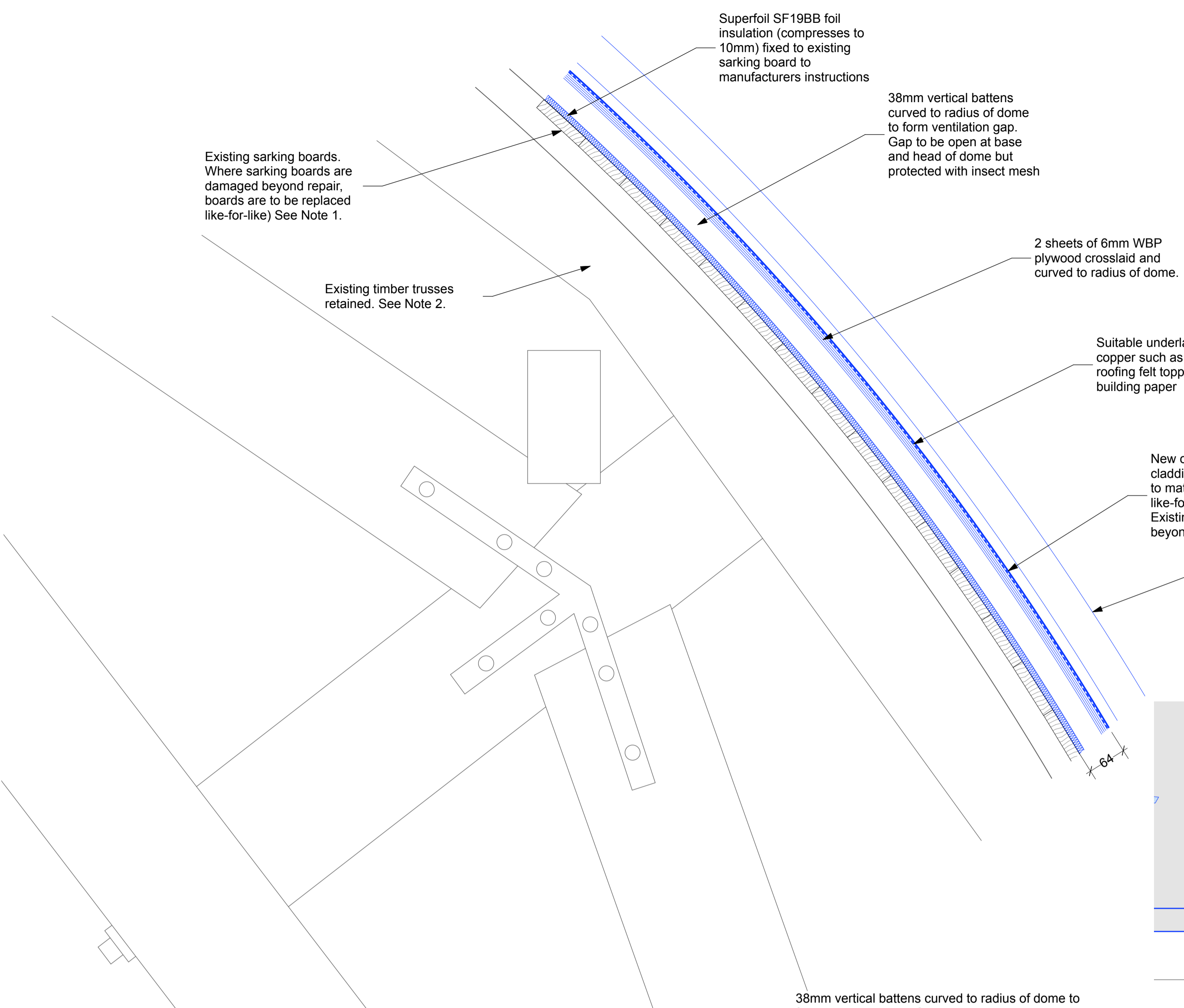

1. SECTION THROUGH DOME GENERALLY

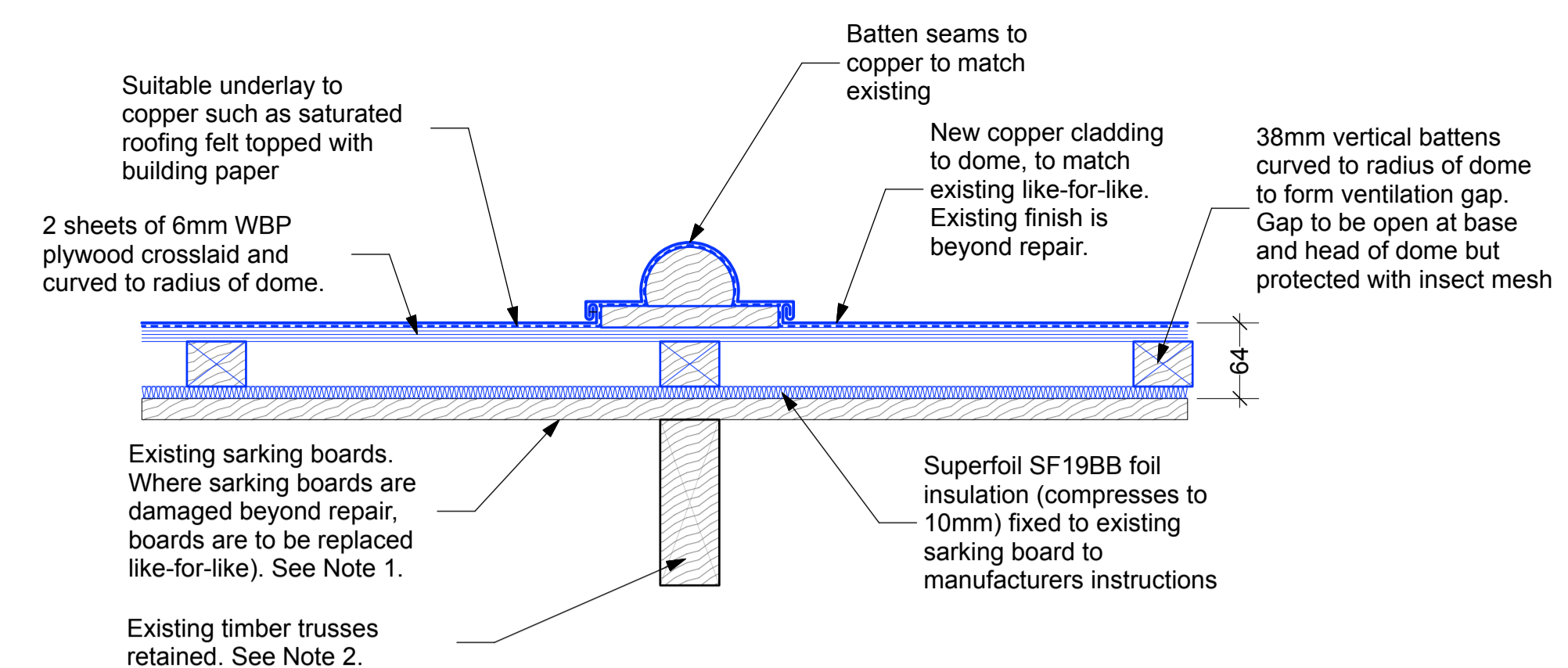

2. SECTION THROUGH BATTEN SEAM

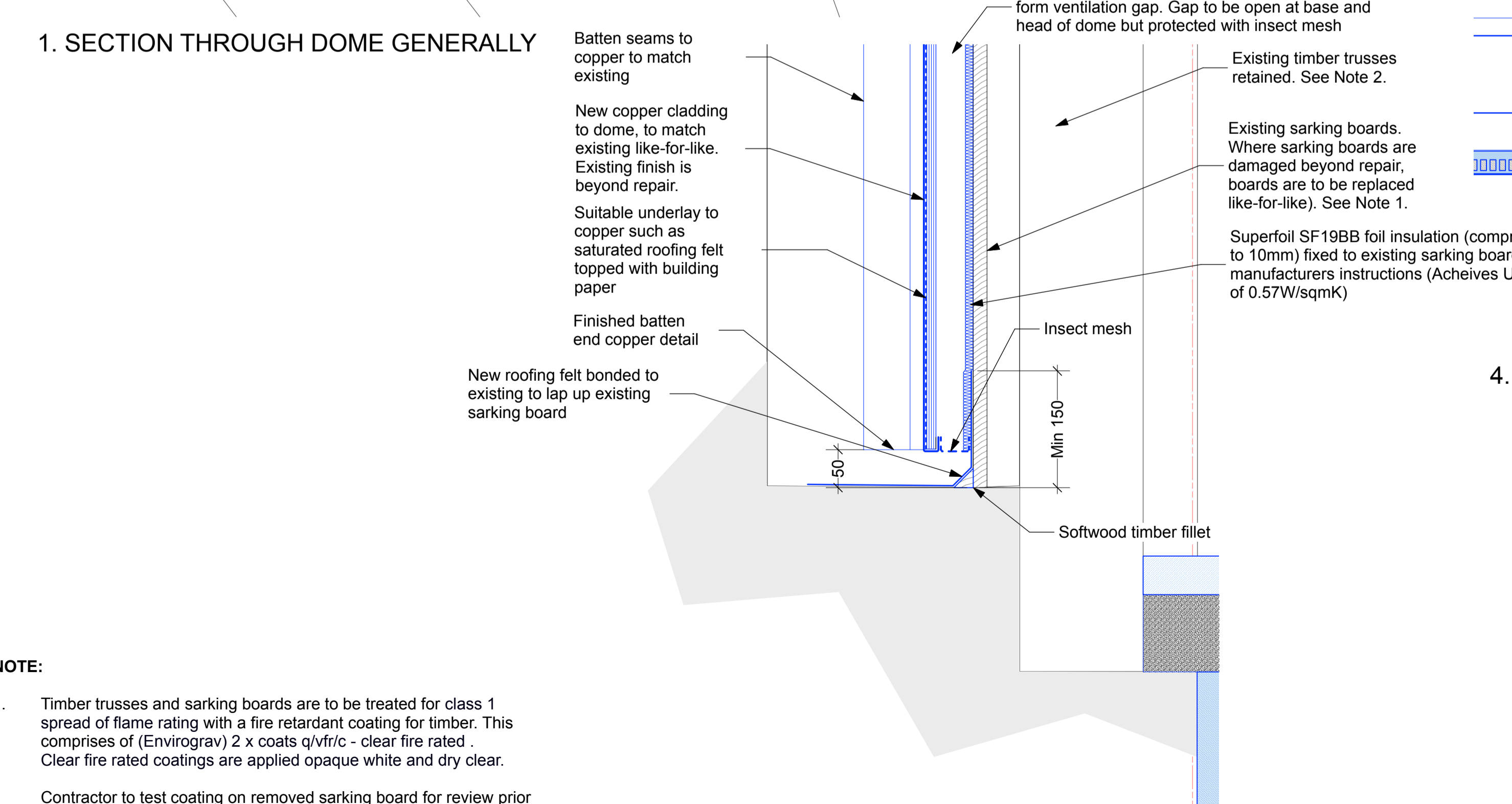

3. SECTION THROUGH DOME BASE

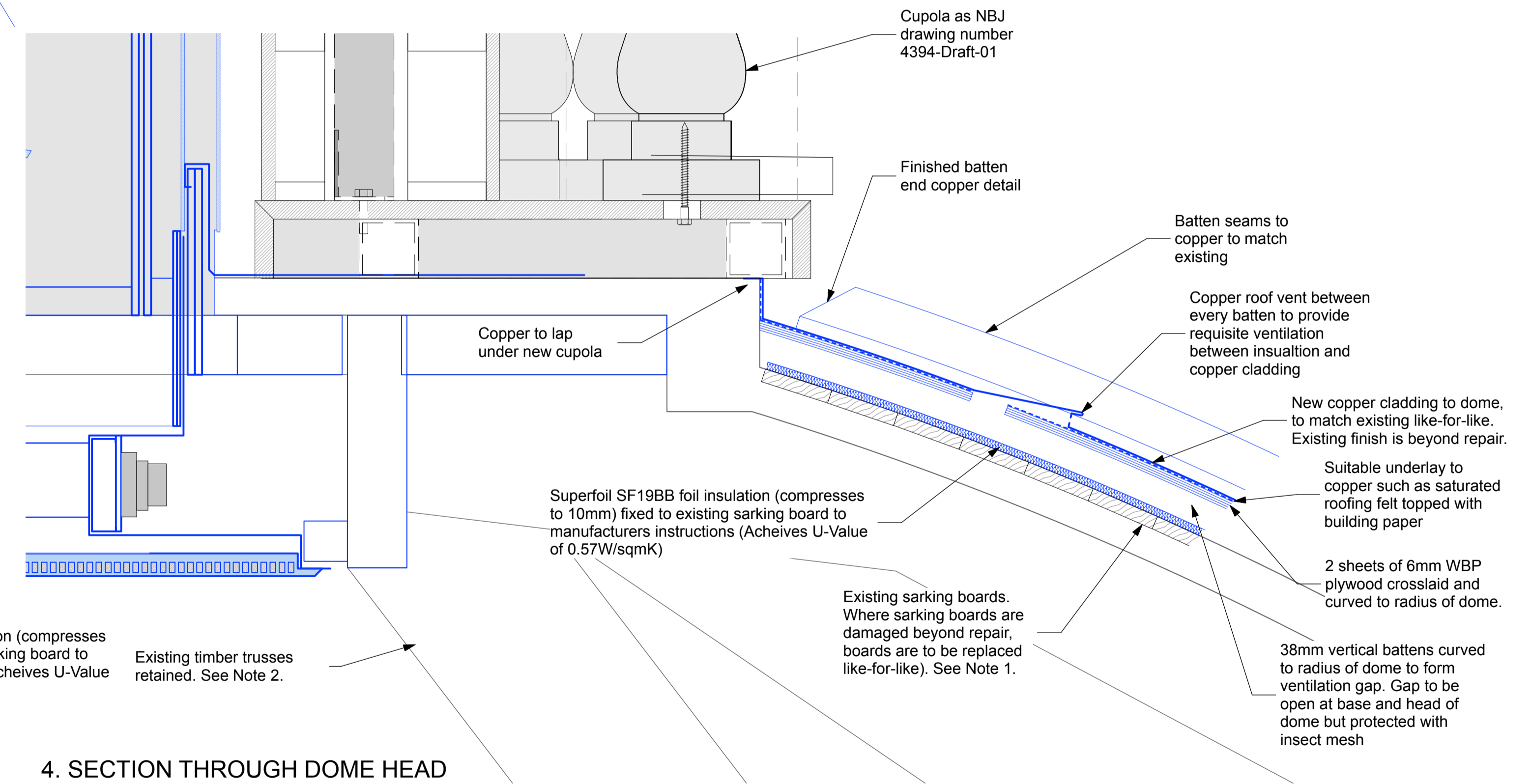

4. SECTION THROUGH DOME HEAD

- NOTE:**
- Timber trusses and sarking boards are to be treated for class 1 spread of flame rating with a fire retardant coating for timber. This comprises of (Envirograv) 2 x coats q/vfr/c - clear fire rated. Clear fire rated coatings are applied opaque white and dry clear.
Contractor to test coating on removed sarking board for review prior to full application.
 - Existing timber trusse to be adjusted only where the new door opening will be formed as per structural engineer's proposal.

For Information
 Archer Humphryes Architects
 Basement
 Central House
 142 Central Street
 London, United Kingdom
 EC1V 8AR
 T: +44 (0) 20 7251 8555

project title		KOKO + Hope & Anchor + Bayham Place Camden, London	
drawing title	scale	date	12.07.19
Dome copper cladding details	1:5	drawn	HJ
		checked	DA
drawing number	revision		
AHA/KKC/DEI/601	-		