

Revision
 A - LICENSING LINE AMENDED TO SUIT COMMENTS. OFFICE LABEL REMOVED. RAISED AREAS SPECIFIED
 B - LICENSING KEY AMENDED TO SUIT COMMENTS.

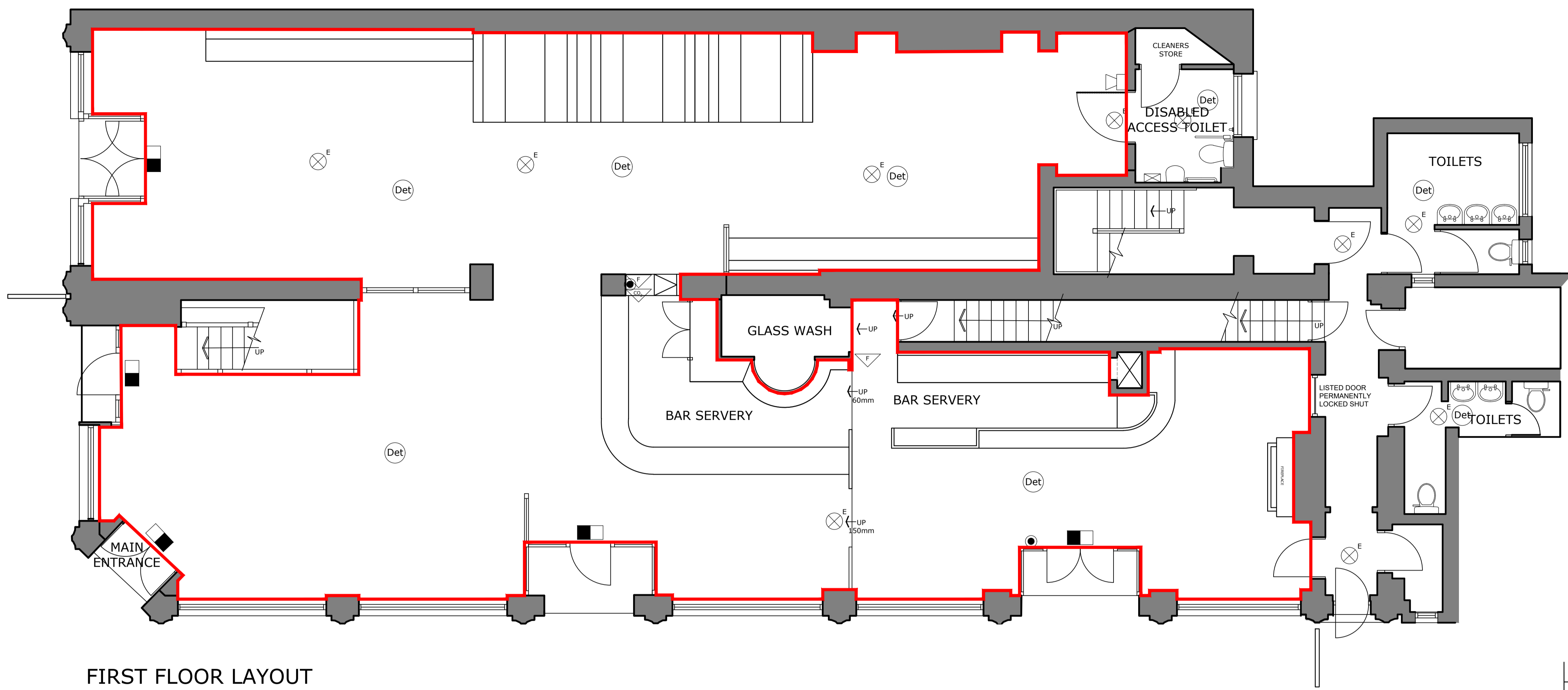

FIRST FLOOR LAYOUT

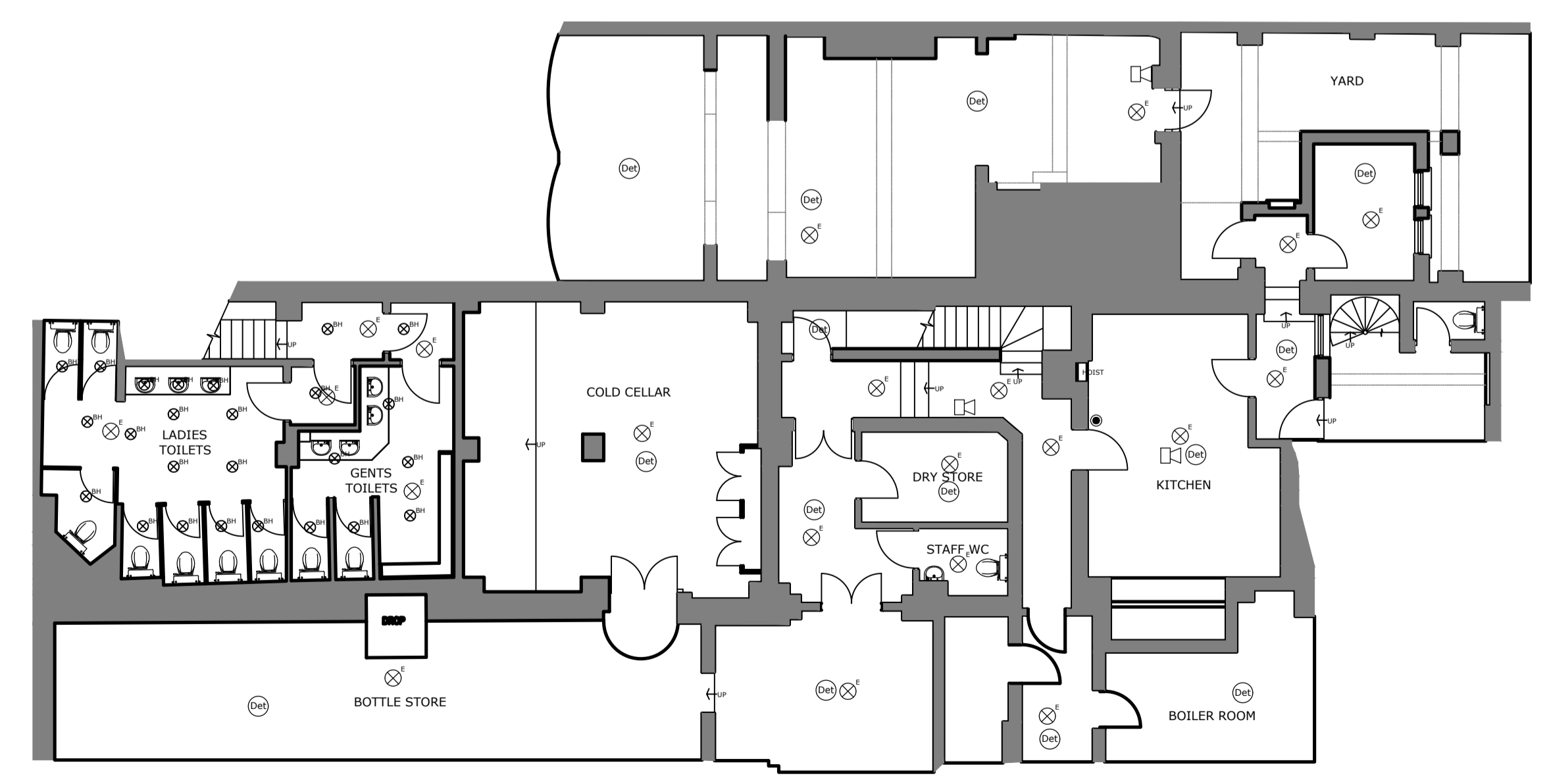

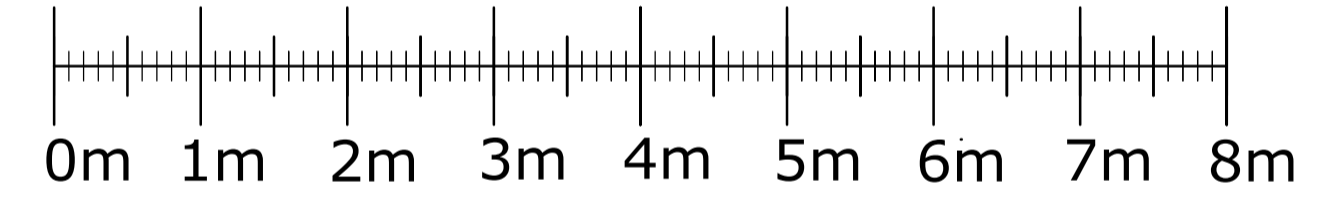



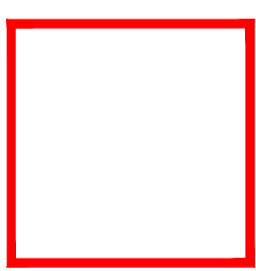







BASEMENT LAYOUT

LICENSING KEY

Licensable Activity 

NOTES:
 Items shown on this plan which are not part of the statutory requirements are shown for indicative purposes only. This would include loose or fixed furniture in certain circumstances, the position of toilet cubicles, CCTV cameras and fire safety equipment not specified in the Regulations. These are shown upon the plans for illustrative purposes only and may be moved at the discretion of the license holder.

The current location of fire safety equipment and other safety equipment is shown. These may be subject to variation in the future as necessary and where applicable in liaison with the Fire Officer and after a fire risk assessment.

-  Fire Alarm Panel
-  Automatic fire detector
-  Manual Call Point
-  Sounder beacon
-  Emergency light-fitting (Fluorescent Downlight or luminaire)
-  Emergency Exit Light c/w legend (directional)
-  9-litre water fire extinguisher
-  Dry powder fire extinguisher
-  Carbon Dioxide fire extinguisher
-  Foam fire extinguisher
-  Wet chemical extinguisher
-  Fire Blanket



Tel: 01924 252482
 Email: studio@spatialized.com
 Web: www.spatialized.com

1 NAVIGATION COURT
 CALDER PARK
 WAKEFIELD
 WF2 7BJ

MITCHELLS & BUTLERS PLC
 27 FLEET STREET
 BIRMINGHAM
 B3 1UP

Mitchells & Butlers

Title: GROUND FLOOR/ BASEMENT LICENSING LAYOUT

Address: THE ROCKET
 120 EUSTON ROAD
 LONDON
 NW1 2AL

Date: JULY '19	Revision: B
Drawn: LH	Job No: 15-19-1020
Scale: 1:50 @ A1	Dwg No: L1

Copyright - This drawing & design and all the information contained therein is the sole copyright of Spatialized Ltd - and reproduction in any form is forbidden unless permission is obtained in writing.
 CONTRACTORS PLEASE NOTE:
 1. Warning: no dimensions are to be scaled from this drawing. All Contractors must visit site and be responsible for taking & checking all dimensions relative to this work. The designer must be advised of any discrepancies in writing.
 2. Any discrepancies between drawings & specification should be reported to the Designer prior to any work commencing.
 3. All fixtures and fittings should be fitted/installed in line with industry standards and comply with HSE, CDM, CQC and the regulations outlined by any other regulatory body applicable.