

EXISTING SASH WINDOW
 PROPOSED SECONDARY GLAZING
 SELECTAGLAZE - SERIES 20 - FRICTION SLIDER
 (NOT COUNTERBALANCED)
 68x32 SW SECTION
 FINISH PAINT TO MATCH WINDOW SURROUNDS

PLAN

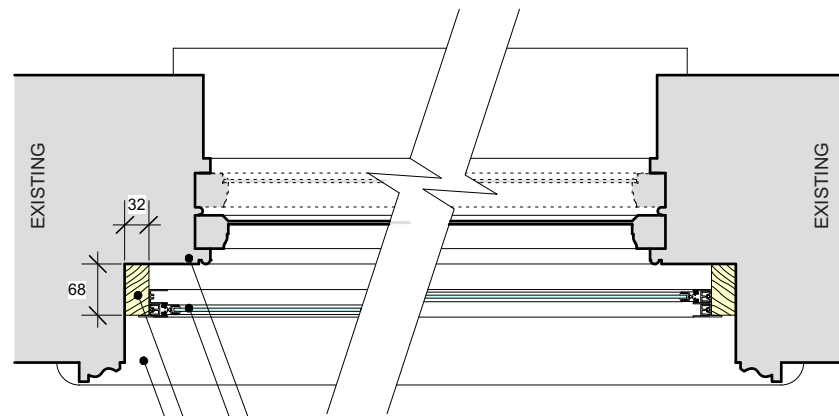

EXISTING SASH WINDOW
 PROPOSED SECONDARY GLAZING
 SELECTAGLAZE - SERIES 20 - FRICTION SLIDER
 (NOT COUNTERBALANCED)
 68x32 SW SECTION
 FINISH PAINT TO MATCH WINDOW SURROUNDS
 TIMBER CILL

PLAN

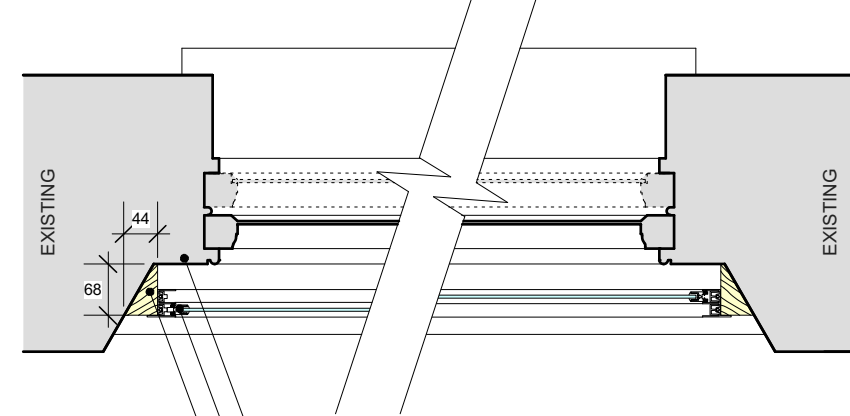

EXISTING SASH WINDOW
 PROPOSED SECONDARY GLAZING
 SELECTAGLAZE - SERIES 20 - FRICTION SLIDER
 (NOT COUNTERBALANCED)
 68x44 SW SECTION CHAMFERED TO SUIT SPLAY
 FINISH PAINT TO MATCH WINDOW SURROUNDS

PLAN

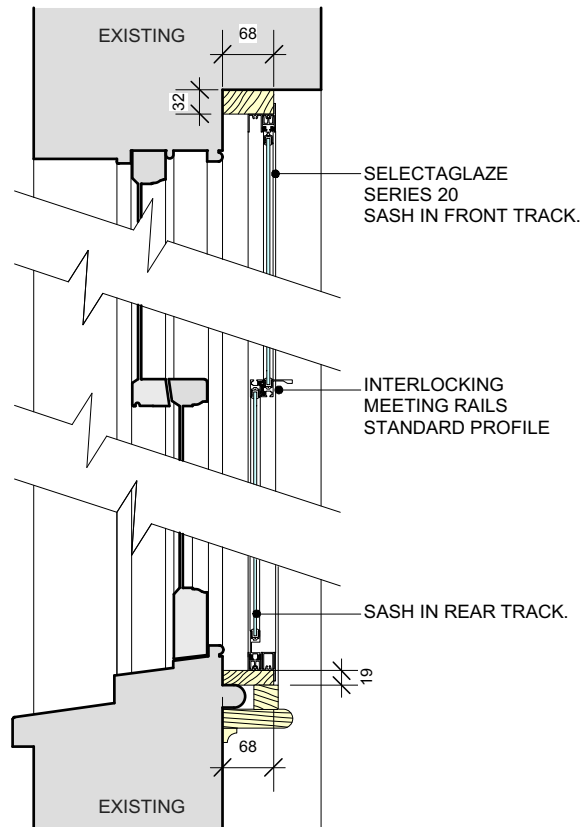

SECTION

SQUARE, PLASTERED
 REVEALS WITHOUT
 ARCHITRAVES

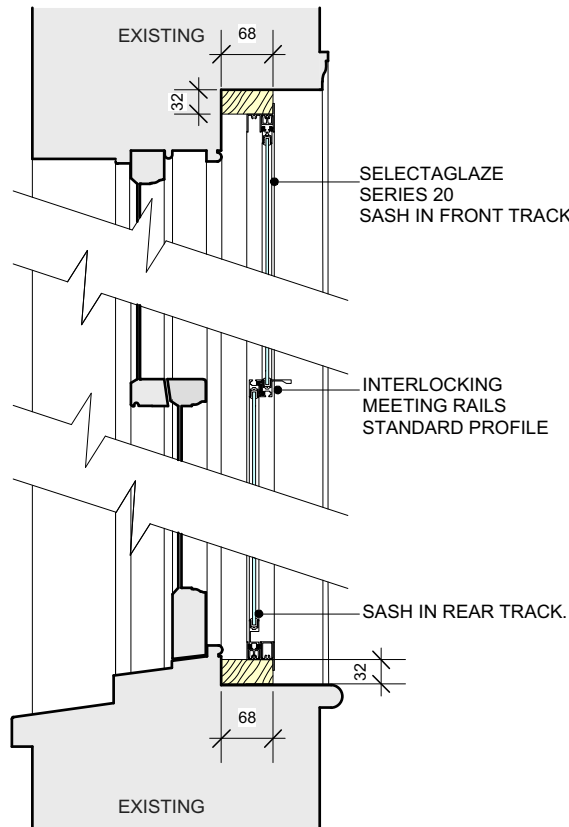

SECTION

SQUARE, TIMBER
 REVEALS WITH
 ARCHITRAVES

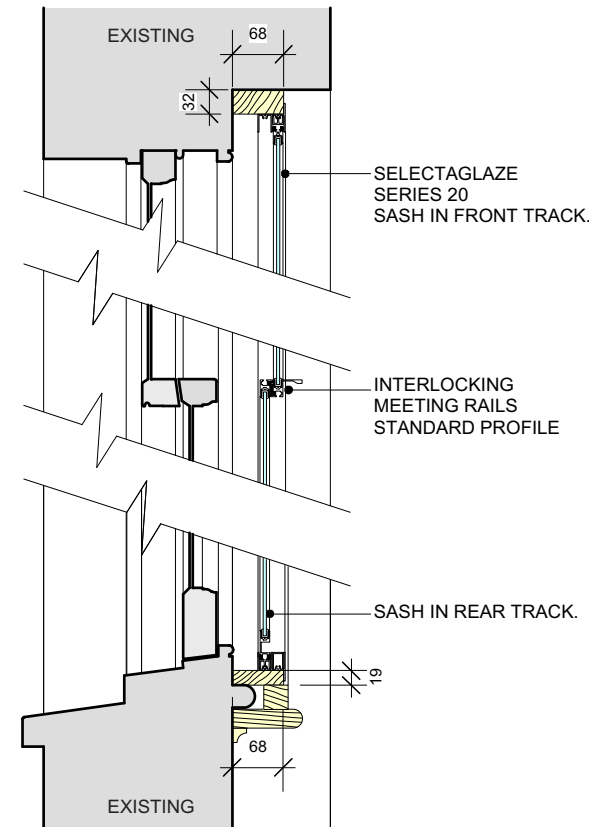

SECTION

SPLAYED, PLASTERED
 REVEALS WITHOUT
 ARCHITRAVES

drawing no.

6214-FS3-7-D01

drawn

CS

checked

PS

scale

1:10 @ A3

date

MARCH 2019

job title
 3-7 FREDERICK STREET, LONDON WC1X 0NG

drawing
 PROPOSED SECONDARY GLAZING

PROJECT 5
 ARCHITECTURE LLP
 8 Waterson Street
 London E2 8HL

T: +44 (0)20 7739 9131
 F: +44 (0)20 7739 9607
 E: info@psa.co.uk