

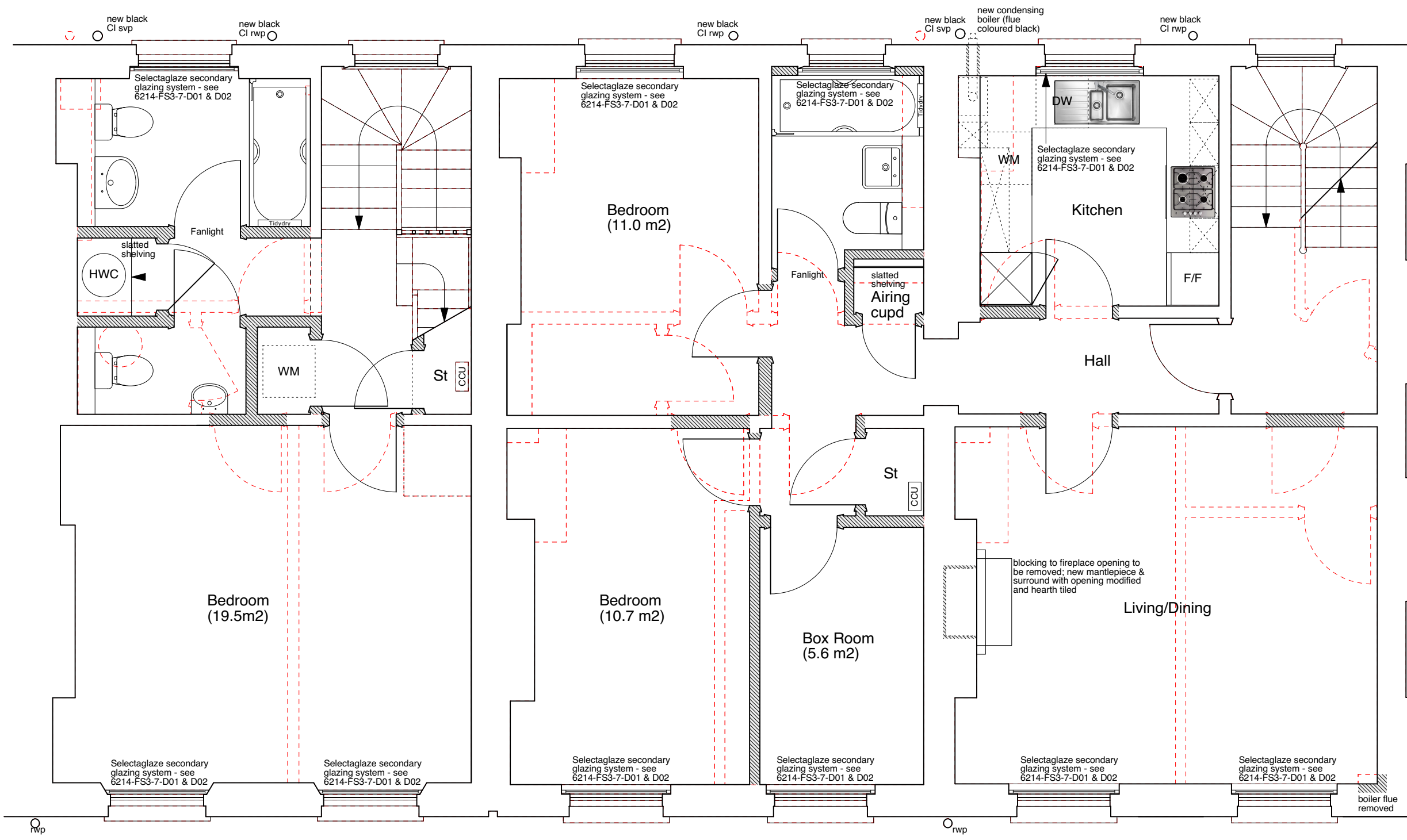

SECTION

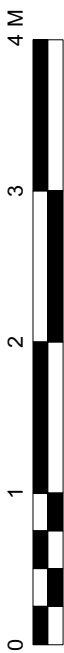
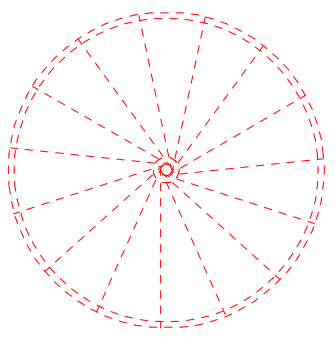

**NOTES:**

- Existing floorboards overlaid with soundproofing: Reduc Micro (21mm) in front room of 3FS, Reduc Strata (35mm) throughout lateral flat in 5&7FS.
- Existing non-original plasterboard wall linings to communal hall, stair walls and spine wall to be replaced (1 hour fire resisting).
- All stud partitions within flats to contain 25mm Isover Acoustic Partition Roll (APR 1200) insulation.
- Existing non-original ceilings in 5 & 7 to be replaced (1 hour fire resisting) on resilient bars.
- Existing, flush internal doors to be replaced with solid timber flush fire doors.
- Defective, non-original sash windows to be replaced like-for-like but without horns and using stretched ovolo mouldings/glazing bars & hardwood cills.

**CONSTRUCTION KEY**

	existing retained
	line over/under/behind
	demolished
	new construction
	28mm thick drylining (Newton 503 mesh & 12.5mm plasterboard)

Rev.A - 190723 - gas riser omitted

drawing no.	6214-FS3-7-P04A	
	drawn	checked
scale	1:50 @ A3	date
job title	3-7 FREDERICK STREET, LONDON WC1X 0NG	
PROJECT 5	ARCHITECTURE LLP	
	8 Waterson Street	
	London E2 8HL	
	T: +44 (0)20 7739 9131	
	F: +44 (0)20 7739 3667	
	E: info@p5a.co.uk	
drawing	SECOND FLOOR PLAN - AS PROPOSED	

