

PROPOSED DOOR SPECIFICATION

Proposed Heritage style steel frame single swing door with fanlight and double glazed panes to existing opening of main entrance to the Seven Dials Club. Ref: Janisol / W50 thermally broken steel door finished in Graphite Matt Black (RAL 9011) with 10% sheen to match all existing door and window frames.

Hardware:
Automatic door gearing from Dorma for single swing inward opening door, 2 x deadlocks and euro profile cylinders to match existing, 1 x pair of standard door push pad openers, double ramped threshold for accessibility with single swing door automation package.

Automated door to be linked to building management access control and entry system in accordance with M&E Engineer's specification.

Alterations To Facade
624-PL-10

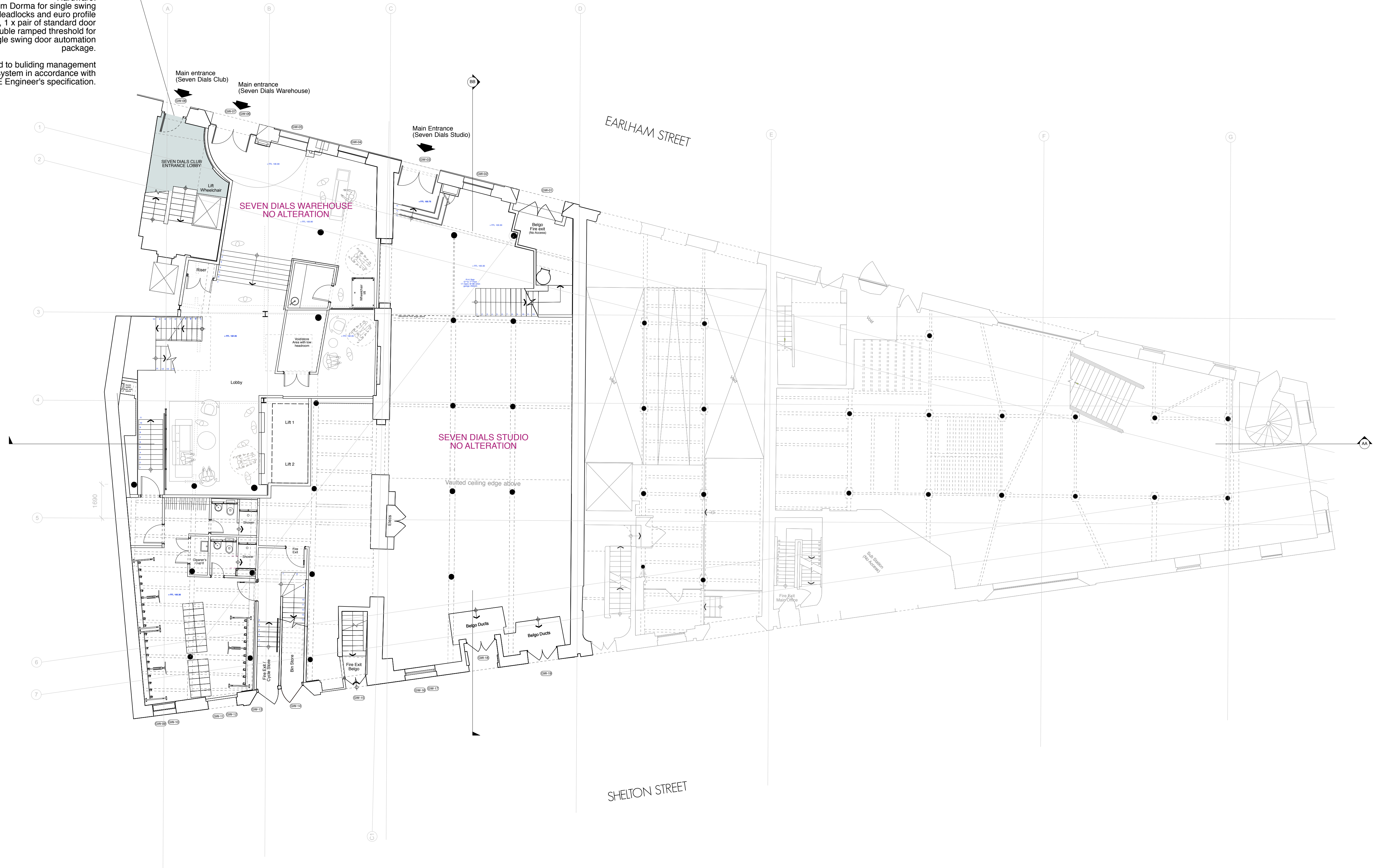

PROPOSED GROUND FLOOR PLAN

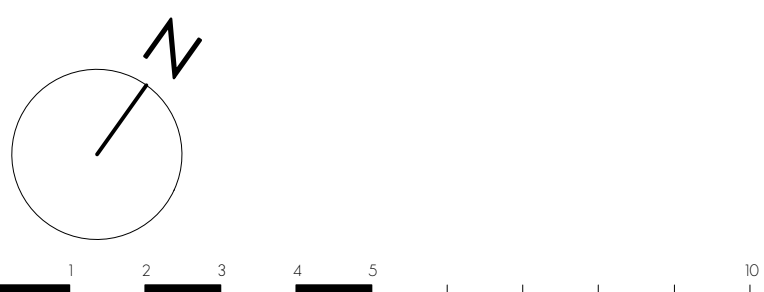

PLANNING

<table border="1"> <tr> <td>rev.</td> <td>date</td> <td>notes</td> </tr> <tr> <td>A</td> <td>30.05.19</td> <td>Revised door specification</td> </tr> </table>			rev.	date	notes	A	30.05.19	Revised door specification	<p>PROJECT SEVEN DIALS WAREHOUSE LONDON WC2</p> <p>CLIENT CBRE c/o ASSET SERVICES UK</p>				<p>DRAWING TITLE PROPOSED GROUND FLOOR PLAN</p>	
rev.	date	notes												
A	30.05.19	Revised door specification												
<p>The drawing is the copyright of gpad london ltd. Not to be reproduced, retained or disclosed to any unauthorised person without written permission. Do not scale the drawing. All indicated dimensions to be checked and verified on site by the contractor before commencement of any fabrication drawings or work whatsoever on site. Report any discrepancies to the Architect immediately. Drawings to be read in conjunction with relevant drawings and specification.</p>			<p>SCALE 1:100 @ A1</p>	<p>DATE JAN 19</p>	<p>DWG BY SF</p>	<p>REV. A</p>	<p>T: 020 7549 2133 E: info@gpadlondonltd.com W: www.gpadlondonltd.com</p>							
<p>© gpad london ltd.</p>			<p>CHKD. 624-PL-08</p>	<p>DWG NO. 624-PL-08</p>			<p>2nd Floor 130 Old Street London EC1V 9BD</p>							