

LEGEND (ALL CHANGES TO ALL LEVELS)

- 01 Stair 2 omitted, and glazed entrance enclosure enlarged
- 02 Window added
- 03 New steps to base of external spiral stair
- 04 Stair 3 roof and gable end arrangement revised.
- 05 Level 3 accommodation mansarded
- 06 Roof light size, height and position adjusted, and smoke vents added.
- 07 Louvres omitted.
- 08 Roof light size, height and position adjusted.
- 09 External ramp adjusted, and railings added.
- 10 West stair core glazing fenestration adjusted to suit amended stair landing levels.
- 11 External paving levels in courtyard raised to achieve required paving falls.
- 12 Low brick plinth added to base of external walls to TP2.
- 13 Brick plinth added to base of existing buildings within courtyard.
- 14 New steps and landing added outside room G1, and internal steps omitted.
- 15 Bin store enlarged and repositioned.
- 16 Gallery passageway to TP2: finishes revised.
- 17 Gallery passageway: entrance gates design revised.
- 18 Window on north elevation of TP2 reduced in length.
- 19 Revised turn-table size and position
- 20 Entrance ramp gradient and levels adjusted.
- 21 External levels adjusted
- 22 TP1 west door ramp omitted
- 23 Fall restraint added
- 24 Gates removed
- 25 Maintenance access door added
- 26 Parapet revised
- 27 Roof/wall shape adjusted
- 28 TP1 reception relocated, and associated internal alterations
- 29 Revised door design
- 30 Modifications to windows, doors and facades facing into courtyard.
- 31 Gate details revised
- 32 Revised proposal for bike storage replacing existing bike racks in Dairy shed.
- 33 Gate retained and modified
- 34 Bike canopy detail revised (typical condition highlighted)
- 35 Sub-station & LV switch-room revised including external doors, and adjoining internal alterations.
- 36 Steps adjusted
- 37 Cladding changed to brass finish
- 38 Wall mounted planters revised (typical condition highlighted)
- 39 Steel posts added to boundary wall (typical condition highlighted)
- 40 Height of glazed entrance roof increased to suit required pitch.
- 41 Glazed entrance roof and canopy revised
- 42 New roof guarding to existing flat roof
- 43 Screening fins and cladding added
- 44 Louvres added
- 45 Ramp omitted
- 46 Door removed and infilled
- 47 Access hatch adjusted.
- 48 Depth of green/blue roof build-up adjusted.
- 49 Blue roof incorporated into green roof and gravel margins added.
- 50 Cladding build-up adjusted
- 51 Orientation of brass seams adjusted
- 52 Roof gutters revised.
- 53 Means of escape revisited and exit door added to TP1
- 54 Spiral staircase landings added at each floor
- 55 Door modified
- 56 Basement louvers to external metal staircase landings
- 57 Revised proposal for mean of escape in TP1
- 58 Revised proposal for window and door
- 59 Revised proposal for door to be left as current
- 60 Gate to be removed
- 61 Capping width adjusted and roof planters shown indicatively.
- 62 Door to be replaced
- 63 Revised proposal for the entrance
- 64 Gates and Entrance door in TP1 to be replaced
- 65 Existing stair to be demolished
- 67 Existing window and door to be replaced
- 68 New reconfiguration for new spiral stair, WCs and adjoining internal spaces.
- 69 Staircase partially demolished
- 70 Level adjusted
- 71 Lift pit adjusted
- 72 Level updated
- 73 Red line extended to include South Crescent Mews
- 74 Red line extended to include new ramp and frontage
- 75 Ladder added
- 76 Works to Mews paving/kerbs added
- 77 Minor adjustment to ridge, and eaves line, (not affecting ridge level noted on consented drawings).

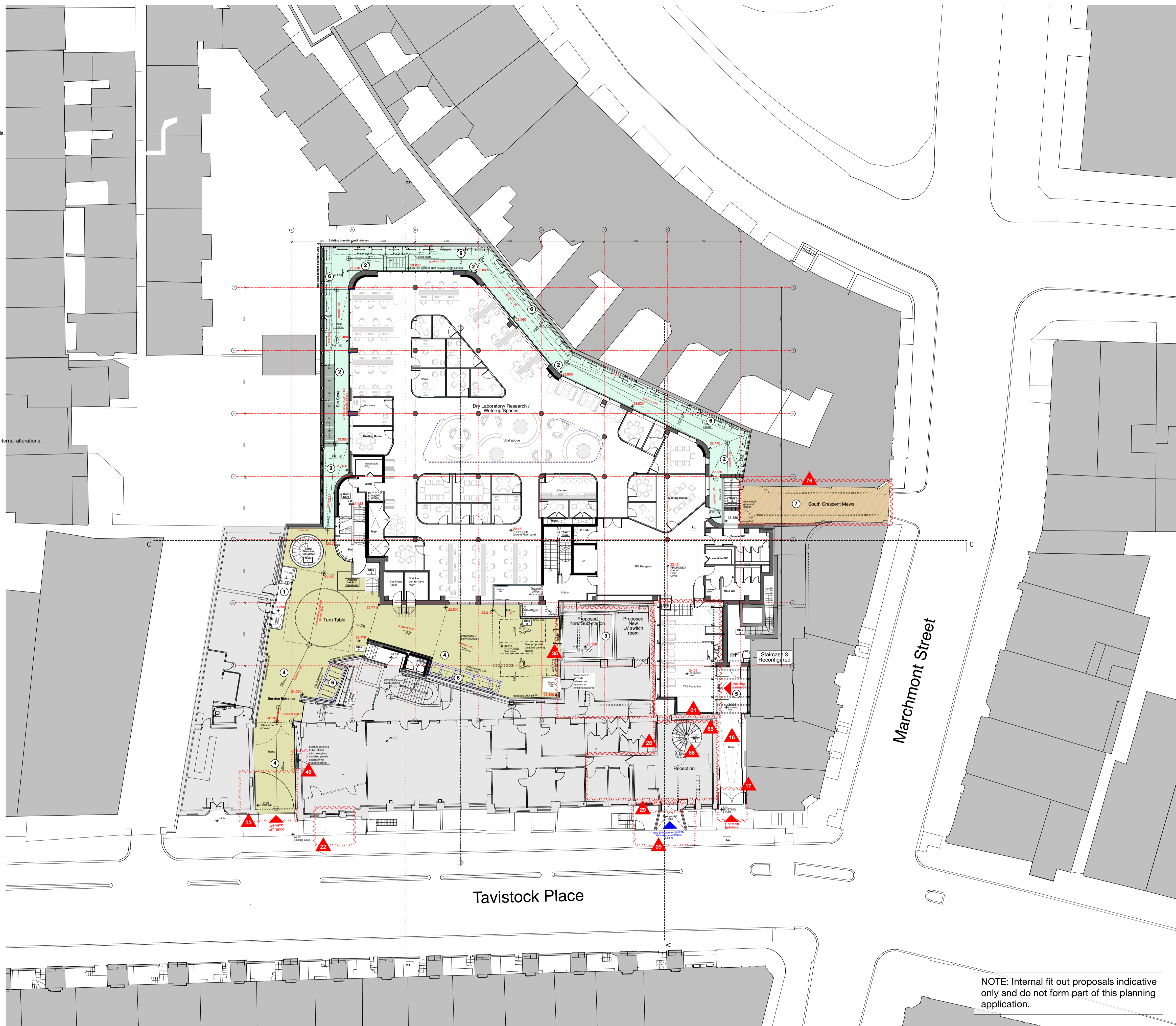

NOTE: Internal fit out proposals indicative only and do not form part of this planning application.

- Key**
- ① New Means of Escape to existing building
 - ② Precast Concrete Paving to Pathways and Pedestrian Circulation
 - ③ New substation & New LV Switch Room
 - ④ Small Unit Precast Concrete Block Paving to Courtyard
 - ⑤ Slate Paving Slabs
 - ⑥ New 'Sheffield Hoop' cycle stands (40 single sided + 2 double sided: total 44 cycle spaces)
 - ⑦ Existing kerbs removed and levels adjusted, with new stone cobbles and flag paving surface to Mews.