

| KEY | |
|-----|---|
| 1 | EXISTING BLACKTOP SURFACING |
| 2 | EXISTING ROAD KERBS |
| 3 | EXISTING SURFACING TO QUEENS YARD |
| 4 | PROPOSED YORKSTONE PAVING |
| 5 | PROPOSED YORKSTONE SETTS |
| 6 | YORKSTONE FLUSH KERBS |
| 7 | ART STONE |
| 8 | TACTILE PAVING |
| 9 | ALUMINIUM GLAZED ROOFLIGHT |
| 10 | STAINLESS STEEL AIR EXTRACTION VENT |
| 11 | LINEAR SLOT DRAIN |
| 12 | |
| 13 | EXISTING CONCRETE WALL TO BE RETAINED |
| 14 | EXISTING MILD STEEL RAILINGS TO BE RETAINED |
| 15 | EXISTING LAMP POSTS RETAINED |
| 16 | PROPOSED CYCLE STANDS |

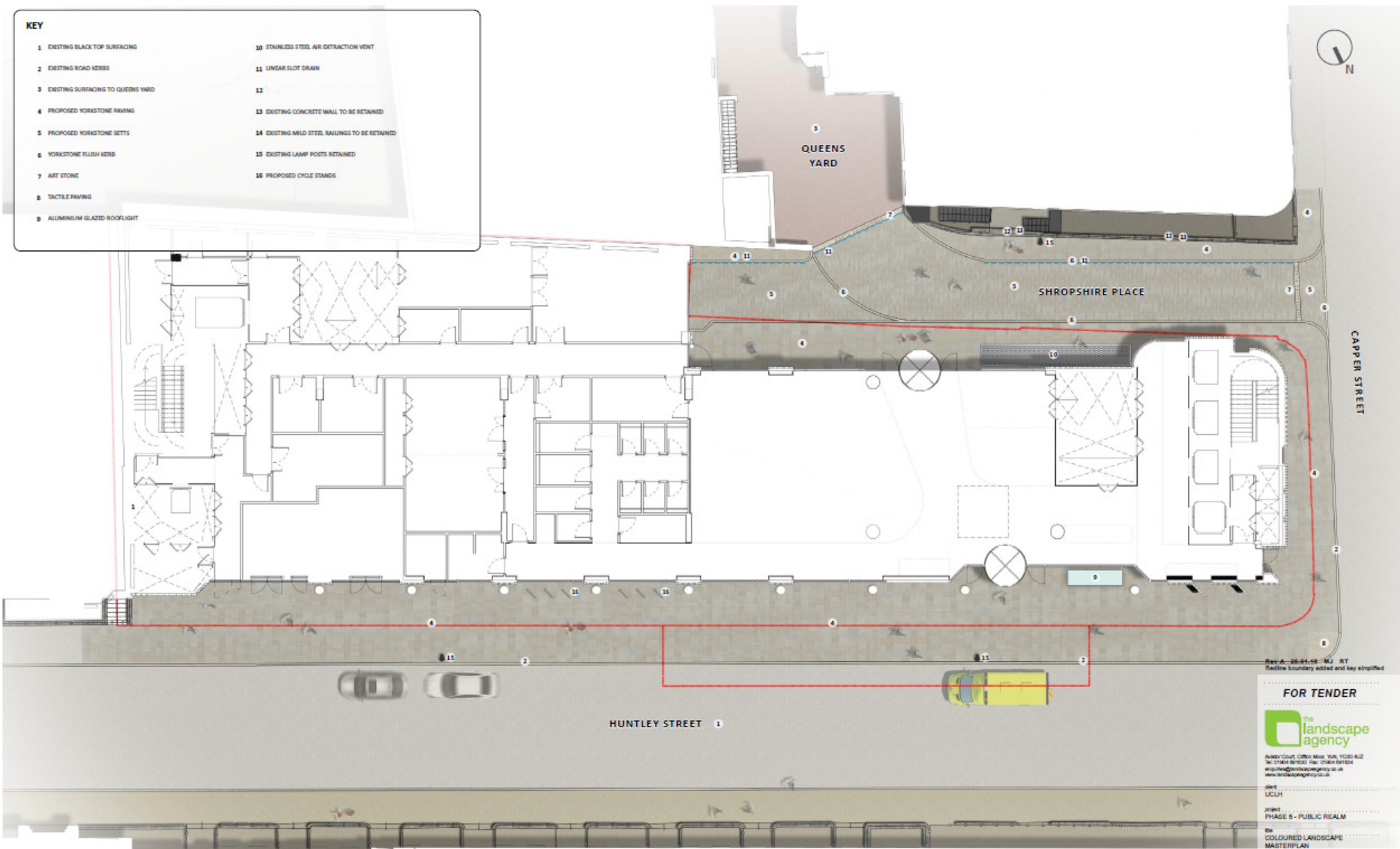

Rev. A - 20.04.16 - MJ RT
 Redline boundary added and key stripped

FOR TENDER

the landscape agency
 Amber Court, Colton Moor, York, YO20 4JZ
 Tel: 01904 878223 Fax: 01904 878224
 email: info@landscapeagency.co.uk
 www.landscapeagency.co.uk

client: UCLH
 project: PHASE 5 - PUBLIC REALM
 title: COLOURED LANDSCAPE MASTERPLAN

scale: 1:5000@A1
 date: 06.01.16
 drawn: JG
 checked: MJ
 reviewed: JG
 1042-003 A
 DO NOT SCALE FROM THIS DRAWING
 © The Landscape Agency

