

# GEOTECHNICAL

## for Subsidence Management Services

55 Albert Street, London, NW1 7LX

Client: Subsidence Management Services  
Client Contact: Robert Kelso  
Client Ref: [REDACTED]  
Policy Holder: Mr Marios Stergides  
Report Date: 19 February 2019  
Our Ref: [REDACTED]

### Site Plan

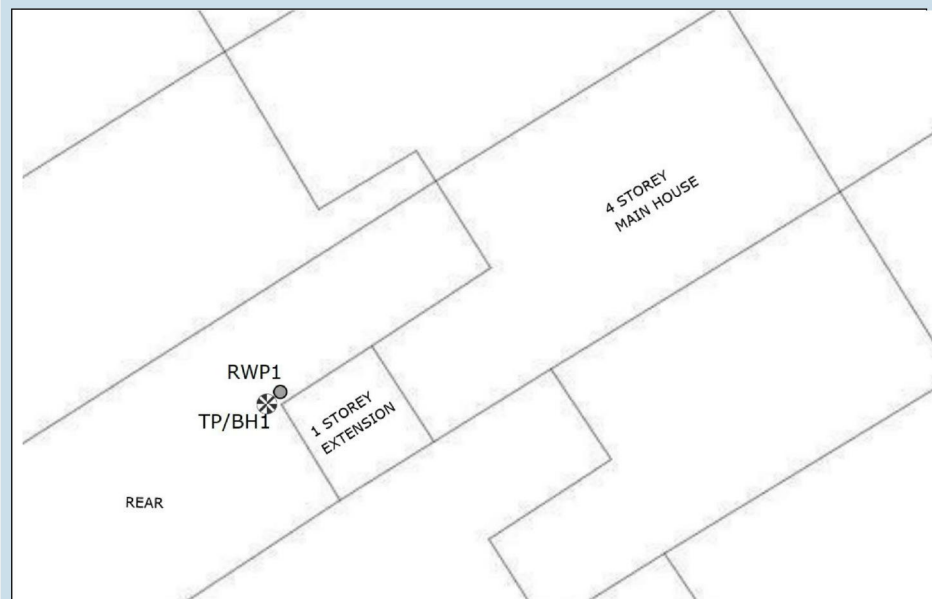

	Borehole		Foul Water Drain		Foul Manhole		Foul Rodding Point		Foul Vent Pipe
	Trial Pit / Borehole		Surface Water Drain		Rain Water Manhole		Surface Rodding Point		Rain Water Gully
	Trial Pit		Combined Drain		Combined Manhole				

TP/BH1 Foundation Detail and Borehole Log

Foundation Detail

Extension foundation comprised of brick wall to 500mm bgl, bearing on brickwork to 800mm bgl, with a total projection of 100mm from the elevation. Underside of foundation (USF) was exposed to 100mm back from the face of the foundation and probed 300mm back from the face of the foundation.

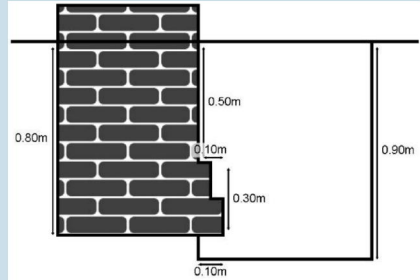

WS	Sample		Test		Legend	Stratum Description and Observations	
	Type	Depth (m)	Type	Depth (m)			Result
						0 TOPSOIL	
						0.5	
	D	0.80 - 1.30	PEN	0.80	HP=3.0 (3.0,3.0,3.0,3.0,3.0)		1.0 Firm dark brown CLAY
	R	0.80 - 1.30	SV	0.80	120		at 0.80m bgl UNDERSIDE OF EXTENSION FOUNDATION
							at 0.80m to 1.30m bgl numerous roots of live appearance encountered and sampled.
							at 0.90m bgl base of hand excavated trial pit.
	R	1.30 - 1.80	PEN	1.30	HP=3.0 (3.0,3.0,3.0,3.0,3.0)		1.5
	D	1.30 - 1.80	SV	1.30	120		at 1.30m bgl becoming brown
							at 1.30m to 1.60m bgl numerous roots of live appearance encountered and sampled.
	D	1.80 - 2.30	PEN	1.80	HP=3.5 (3.5,3.5,3.5,3.5,3.5)		2.0
	R	1.80 - 2.30	SV	1.80	120		at 1.80m to 2.30m bgl numerous roots of live appearance encountered and sampled.
	D	2.30 - 2.80	PEN	2.30	HP=3.5 (3.5,3.5,3.5,3.5,3.5)		2.5
	R	2.30 - 2.80	SV	2.30	120		at 2.30m to 2.80m bgl numerous roots of live appearance encountered and sampled.
	D	2.80 - 3.30	PEN	2.80	HP=3.5 (3.5,3.5,3.5,3.5,3.5)		3.0
	R	2.80 - 3.30	SV	2.80	120		at 2.80m to 3.30m bgl numerous roots of live appearance encountered and sampled.
	D	3.30 - 3.80	PEN	3.30	HP=3.5 (3.5,3.5,3.5,3.5,3.5)		3.5
	R	3.30 - 3.80	SV	3.30	120		at 3.30m to 4.00m bgl no roots encountered. Extensive inspection of soil samples encountered no roots.
	D	3.80 - 4.00	PEN	3.80	HP=3.5 (3.5,3.5,3.5,3.5,3.5)		4.0
	R	3.80 - 4.00	SV	3.80	120		at 4.00m bgl target depth achieved.

-- End of borehole at 4.00m --  
 Trial pit excavated to 0.90m bgl. Borehole completed by hand held percussive window sampler. Roots encountered to 3.30m bgl. Groundwater tables not encountered.

## Site Observations

### GENERAL:

Site Investigation works (TP/BH 1) undertaken on 5 February 2019 during dry weather (i.e. no rain).

### HEALTH AND SAFETY:

Negative signal obtained in Power and Radio and Genny mode on the Cable Avoidance Tool (CAT) (TP/BH 1).

### DRAINAGE:

The rainwater downpipe (RWP1) was encountered not connected to the sub-surface drainage system and discharging to below ground surface.

### FOUNDATIONS:

Extension foundation was exposed and the underside of foundation (USF) recorded to be 0.80m bgl (TP/BH 1).

### ROOTS:

Roots encountered to 3.30m bgl (TP/BH 1).

### IN SITU TESTING:

Hand Penetrometer (PEN) undertaken at 0.80m bgl (TP/BH 1) within the hand excavated trial pit and thereafter in the window sample borehole at maximum 0.50m intervals.

Hand Shear Vane (SV) undertaken at 0.80m bgl (TP/BH 1) within the hand excavated trial pit and thereafter in the window sample borehole at maximum 0.50m intervals.

### WATER STRIKES:

No water strikes (NWS) encountered (TP/BH 1).

The groundwater observations do not necessarily indicate equilibrium conditions. It should be appreciated that groundwater levels are subject to both seasonal and weather induced variations. Other effects such as construction activities may also change groundwater levels.