

SECTION (1:10)

Angle support at joint of slabs. Typical. Two additional angles may be needed to support the rest of the balcony to 114.

50x50 Tee cast into 225x225x225 concrete

Stucco removed to expose Lintel/arch over window. Lintel repaired or replaced. Stucco redone and painted.

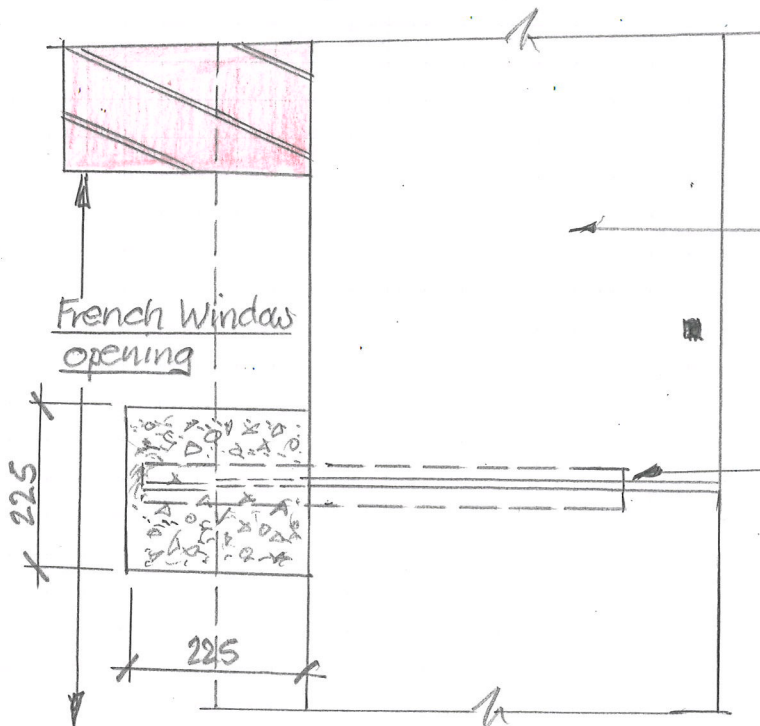

PLAN (1:10)

This slab has dropped, and is now temporarily supported.

Tee centred on joint between stone balcony slabs